

# NEW MEXICO OIL CONSERVATION COMMISSION

NO. OF COPIES RECEIVED	
NO. OF COPIES RETURNED	
DATE	
FILE	
U.S.G.S.	
LAND OFFICE	
OPERATOR	

1. Name of Operator  
 2. Name of Well  
 3. Name of Well  
 4. Name of Well

## APPLICATION FOR PERMIT TO DRILL, DEEPEN, OR PLUG BACK

1. Type of Work: DRILL ☒ DEEPEN ☐ PLUG BACK ☐  
 2. Name of Operator: El Paso Natural Gas Company  
 3. Address of Operator: PO Box 990, Farmington, NM 87401  
 4. Location of Well: UNIT LETTER B LOCATED 1050 FEET FROM THE North LINE  
 AND 1750 FEET FROM THE East LINE OF SEC. 25 T. 30N R. 9W NAME San Juan  
 5. Proposed Depth: 2550'  
 6. Formation: Pictured Cliffs  
 7. History of Well: Rotary  
 8. Name of Well: 5721'GL  
 9. Field & Status: statewide  
 10. Drilling Contractor:   
 11. Approx. Photo Work:

## PROPOSED CASING AND CEMENT PROGRAM

SIZE OF HOLE	SIZE OF CASING	WEIGHT PER FOOT	SETTING DEPTH	AMOUNT OF CEMENT	EST. TOP
12 1/4"	8 5/8"	24.0#	120'	100 cu. ft.	circulate
6 1/2"	2 7/8"	6.4#	2550'	325 cu. ft.	to cover Ojo
					Alamo

Selectively perforate and sandwater fracture the Pictured Cliffs formation.

The NE/4 of Section 25 is dedicated to this well.

**ILLEGIBLE**

IN ABOVE WHICH DESCRIBE PROPOSED PROGRAM IS TO DRILL, DEEPEN, OR PLUG BACK, GIVE DATA OF PROPOSED SELECTIVE PERFORATION AND PROPOSED SAND FILLING.

I hereby certify that the information above is true and complete to the best of my knowledge and belief.

Signed [Signature] Title Drilling Clerk Date May 30, 1974

APPROVED [Signature] TITLE  DATE 5-31-74

COMMISSIONER [Signature] TITLE  DATE

# WELL LOCATION AND ACREAGE DEDICATION PLAT

Form C-107  
Supersedes C-128  
Effective 1-1-65

All distances must be from the outer boundaries of the Section.

Operator <b>EL PASO NATURAL GAS COMPANY</b>		Lease <b>LAWSON</b>		(PBM)		Well No. <b>2</b>
Unit Letter <b>B</b>	Section <b>25</b>	Township <b>30-N</b>	Range <b>9-N</b>	County <b>SAN JUAN</b>		
Actual Footage Location of Well:						
1050 feet from the		<b>NORTH</b> line and		1750 feet from the		<b>EAST</b> line
Ground Level Elev. <b>5721</b>	Producing Formation <b>PICTURED CLIFFS</b>		Pool <b>PIANCO PICTURED CLIFFS MT.</b>		Dedicated Acreage: <b>160.00</b> Acres	

1. Outline the acreage dedicated to the subject well by colored pencil or hatchure marks on the plat below.
2. If more than one lease is dedicated to the well, outline each and identify the ownership thereof (both as to working interest and royalty).
3. If more than one lease of different ownership is dedicated to the well, have the interests of all owners been consolidated by communitization, unitization, force-pooling, etc?

☒ Yes ☐ No If answer is "yes," type of consolidation Communitization

If answer is "no," list the owners and tract descriptions which have actually been consolidated. (Use reverse side of this form if necessary.)

No allowable will be assigned to the well until all interests have been consolidated (by communitization, unitization, forced-pooling, or otherwise) or until a non-standard unit, eliminating such interests, has been approved by the Commission.

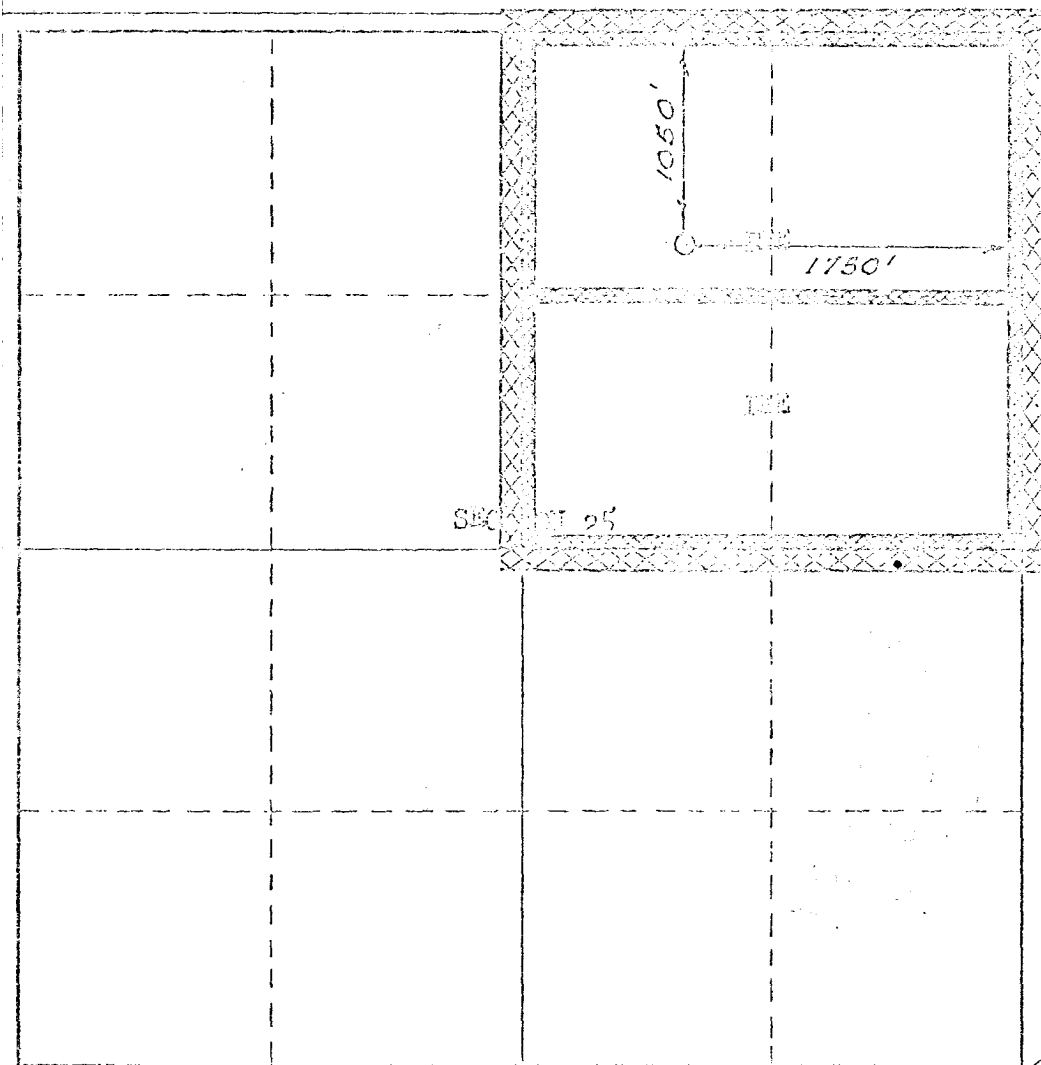

## CERTIFICATION

I hereby certify that the information contained herein is true and complete to the best of my knowledge and belief.

*[Signature]*

Name

Drilling Clerk

Position

El Paso Natural Gas Co.

Company

May 30, 1974

Date

I hereby certify that the well location shown on this plat was plotted from field notes of actual surveys made by me or under my supervision, and that the same is true and correct to the best of my knowledge and belief.

Date Surveyed

FEBRUARY 13, 1973

Registered Professional Engineer and/or Land Surveyor

*[Signature]*

Certificate No.

1760

0 350 600 900 1200 1600 1900 2300 2540 2800 3100 3400 3700 4000 4300 4600 4900 5200 5500 5800 6100 6400 6700 7000 7300 7600 7900 8200 8500 8800 9100 9400 9700 10000