



June 12, 1996

Mr. William J. LeMay, Director
New Mexico Oil Conservation Division
2040 S. Pacheco Street
P. O. Box 6429
Santa Fe, NM 87505

Southern

Rockies

Business

Unit

Application for Exception to Rule 303-C - Downhole Commingling
Florance Gas Com E #9A Well
Unit J Section 13-T30N-R9W
Blanco Pictured Cliffs and Blanco Mesaverde Pools
San Juan County, New Mexico

RECEIVED
JUN 17 1996
OIL CON. DIV.
DIST. 3

Enclosed please find an administrative application form (C-107-A) and attachments for downhole commingling for the captioned well. By copy of this application by certified mail, return receipt requested, Amoco is notifying all offset operators in the formations captioned above as well as all affected interest owners if the ownership of those formations is not common. The Division Director may approve the proposed downhole commingling in the absence of a valid objection from any offset operator or any interest owner in those instances where ownership is not common in the zones to be commingled within 20 days after the receipt of the application if, in his opinion, waste will not result thereby, and correlative rights will not be violated.

Should there be questions concerning this matter, please contact me at (303) 830-5344.

Sincerely,

Pamela W. Staley

Enclosures

cc: Hiep Vu
Patty Haelele
Wellfile
Proration File
Frank Chavez, Supervisor
NMOCD District III
1000 Rio Brazos Road
Aztec, NM 87410

Duane Spencer
Bureau of Land Management
1235 La Plata Hwy.
Farmington, NM 87401

DISTRICT I
P.O. Box 1980, Hobbs NM 88241-1980

State of New Mexico
Energy, Minerals and Natural Resources Department

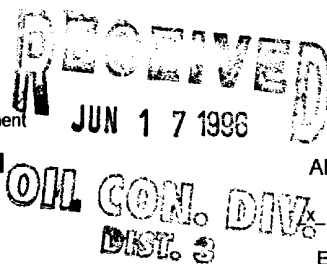

Form C-107-A
New 3-12-96

DISTRICT II
811 South First St., Artesia, NM 88210-2835

OIL CONSERVATION DIVISION

2040 S. Pacheco
Santa Fe, New Mexico 87505-6429

APPROVAL PROCESS:

☒ Administrative ☐ Hearing

DISTRICT III
1000 Rio Brazos Rd. Aztec, NM 87410-1003

APPLICATION FOR DOWNHOLE COMMINGLING

EXISTING WELLBORE
☒ YES ☐ NO

Amoco Production Company		P.O. Box 800	Denver, CO 80201
Operator	Lease	Address	County
Florance Gas Com E	#9A	J-13-30N-9W	San Juan
Well No.		Unit Ltr. - Sec Twp - Rge	

OGRID NO. 000778 Property Code 000536 API NO. 30-045-21882
Spacing Unit Lease Types: (check 1 or more)
Federal ☒ State ☐ (and/or) Fee ☐

The following facts are submitted in support of downhole commingling:	Upper Zone	Intermediate Zone	Lower Zone
1. Pool Name and Pool Code	Blanco Pictured Cliffs 72359		BLANCO MESAVERDE 72319
2. Top and Bottom of Pay Section (Perforations)	2570'-2642'		4229'-5012'
3. Type of production (Oil or Gas)	GAS		GAS
4. Method of Production (Flowing or Artificial Lift)	FLOWING		FLOWING
5. Bottomhole Pressure Oil Zones - Artificial Lift: Gas & Oil - Flowing: All Gas Zones: Estimated Current Measured Current Estimated or Measured Original	a. (Current) 137 PSI b. (Original) 1047 PSI	a. b.	a. 136 PSI b. 1302 PSI
6. Oil Gravity (* API) or Gas BTU Content	1140 BTU		1220 BTU/MMCF 53.8 API
7. Producing or Shut-In?	PRODUCING		PRODUCING
Production Marginal? (yes or no)	YES		NO
• If Shut-In, give data and oil/gas/water rates of last production Note: For new zones with no production history, applicant shall be required to attach production estimates and supporting data	Date: Rates:	Date: Rates:	Date: Rates:
• If Producing, give date and oil/gas/water rates of recent test (within 60 days)	Date: Rates: 04/03/96 54 MCFD 0.38 BWPD	Date: Rates:	Date: Rates: 04/03/96 440 MCFD, 0.33 BWPD 0.68 BCPD
8. Fixed Percentage Allocation Formula -% for each zone	Oil: 0 % Gas 11 %	Oil: % Gas %	Oil: 100 % Gas 89 %

9. If allocation formula is based upon something other than current or past production, or is based upon some other method, submit attachments with supporting data and/or explaining method and providing rate projections or other required data.
10. Are all working, overriding, and royalty interests identical in all commingled zones? ☒ Yes ☐ No
If not, have all working, overriding, and royalty interests been notified by certified mail? ☐ Yes ☐ No
Have all offset operators been given written notice of the proposed downhole commingling? ☒ Yes ☐ No
11. Will cross-flow occur? ☐ Yes ☒ No If yes, are fluids compatible, will the formations not be damaged, will any cross-flowed production be recovered, and will the allocation formula be reliable. ☐ Yes ☐ No (If No, attach explanation)
12. Are all produced fluids from all commingled zones compatible with each other? ☒ Yes ☐ No
13. Will the value of production be decreased by commingling? ☐ Yes ☒ No (If Yes, attach explanation)
14. If this well is on, or communitized with, state or federal lands, either the Commissioner of Public Lands or the United States Bureau of Land Management has been notified in writing of this application. ☒ Yes ☐ No SF-081001 SF-080004
15. NMOCD Reference Cases for Rule 303(D) Exceptions: ORDER NO(S) _____
16. ATTACHMENTS:
- C-102 for each zone to be commingled showing its spacing unit and acreage dedication.
 - Production curve for each zone for at least one year. (If not available, attach explanation.)
 - For zones with no production history, estimated production rates and supporting data.
 - Data to support allocation method or formula.
 - Notification list of all offset operators.
 - Notification list of working, overriding, and royalty interests for uncommon interest cases.
 - Any additional statements, data, or documents required to support commingling.

I hereby certify that the information above is true and complete to the best of my knowledge and belief.

SIGNATURE Pamela W. Staley TITLE Regulatory Affairs Engineer DATE 6/10/96
TYPE OR PRINT NAME Pamela W. Staley TELEPHONE NO. (303) 830-5344

NEW MEXICO OIL CONSERVATION COMMISSION WELL LOCATION AND ACREAGE DEDICATION PLAT

Form C-103
Supersedes C-128
Effective 1-1-61

All distances must be from the outer boundaries of the Section

Lessor		Lessee		Well No.	
Tenneco Oil Company		Florance		9-A	
Section	Location	Tract No.	Range	County	
13	30-N	9-W	San Juan		

1850	Feet from the	South	Line and	1650	Feet from the	East	Line
5017'	Producing Formation	Mesa Verde-Pictured Cliffs	Pool	Mesa Verde-Pictured Cliffs	Dedicated Acreage	SEA/160	Acres

- Outline the acreage dedicated to the subject well by colored pencil or hatchure marks on the plat below.
- If more than one lease is dedicated to the well, outline each and identify the ownership thereof (both as to working interest and royalty).
- If more than one lease of different ownership is dedicated to the well, have the interests of all owners been consolidated by communitization, unitization, force pooling, etc?
☒ One lease
☐ Yes ☐ No If answer is "yes" type of consolidation

If answer is "no," list the owners and tract descriptions which have actually been consolidated. (Use reverse side of this form if necessary.)
 No allowable well is assigned to the well until all interests have been consolidated (by communitization, unitization, force pooling, or otherwise) or until a non standard unit, eliminating such interests, has been approved by the Commission.

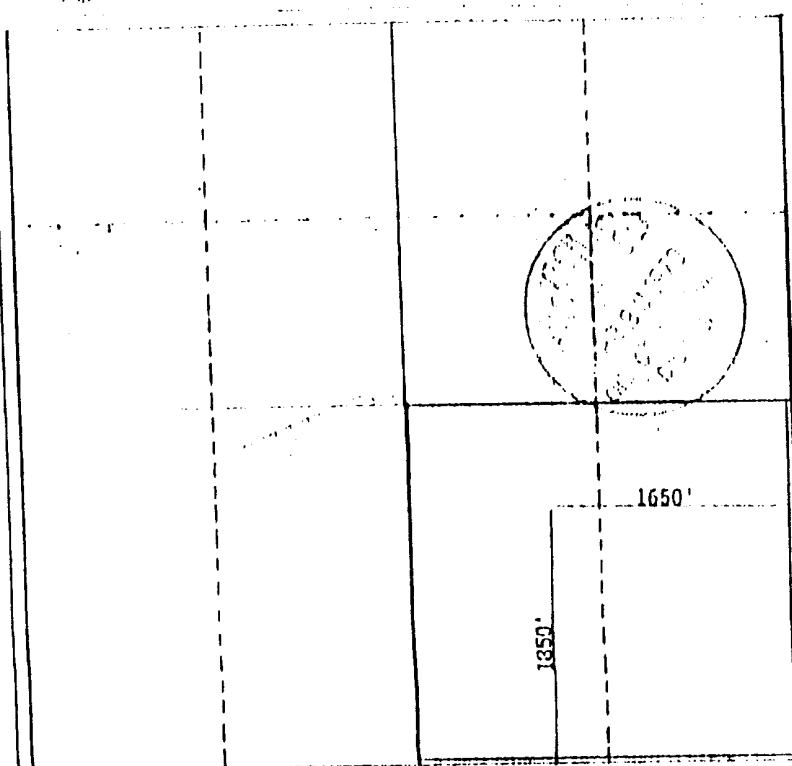

CERTIFICATION

I hereby certify that the information contained herein is true and complete to the best of my knowledge and belief.

Signature
R.C. Smith
 Position
 Production Analyst
 Company
 Tenneco Oil Company
 Date
 4/16/79

I hereby certify that the well location shown on this plat was plotted from field notes of actual surveys made by me or under my supervision, and that the same is true and correct to the best of my knowledge and belief.

Date Surveyed

Registered Professional Engineer
 and/or Licensed Surveyor

Certificate No.

Dwights

1000 Lease: FLORANCE GAS COM E 00009A

Retrieval Code: 251,045,30N09W13J00M

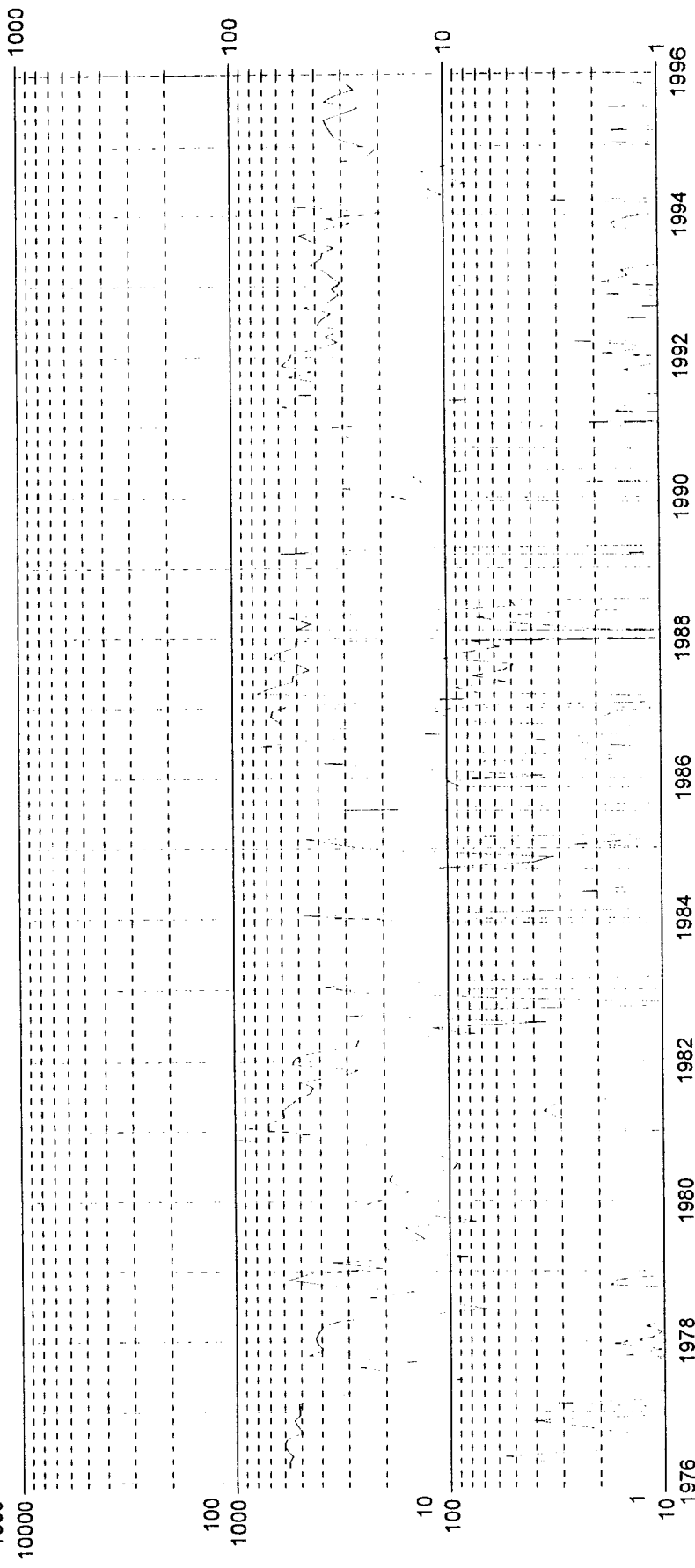

County: SAN JUAN	State: NM	F.P. Date: 03/76	Date: 03/27/96
Field: BLANCO (MESAVERDE) MV	Oil Cum: 8052 bbl		
Reservoir: MESAVERDE	Gas Cum: 1929 mmcf	Water (bbl/day)	----
Operator: AMOCO PRODUCTION CO	Location: 13J 30N 9W	Gas (mcf/day)	---
		Oil (bbl/day)	---

Dwights

1000 Lease: FLORANCE GAS COM E 00009A

Retrieval Code: 251,045,30N09W13J00P

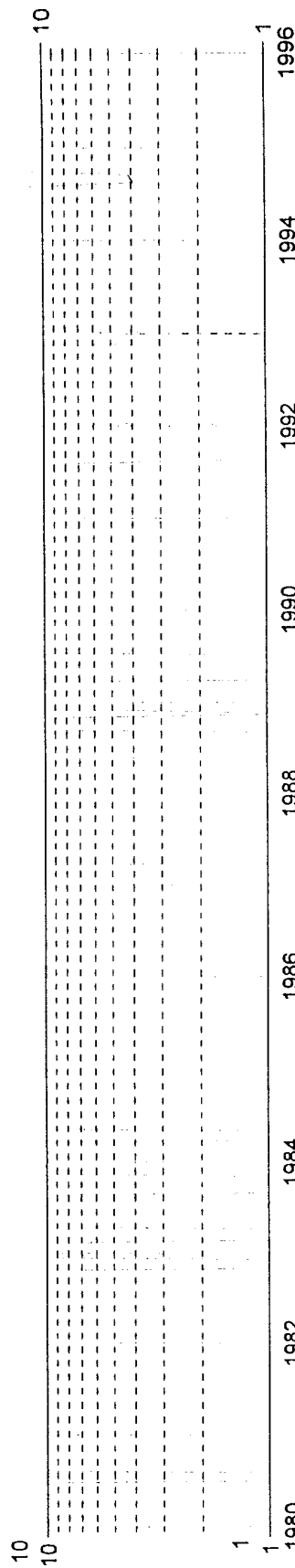
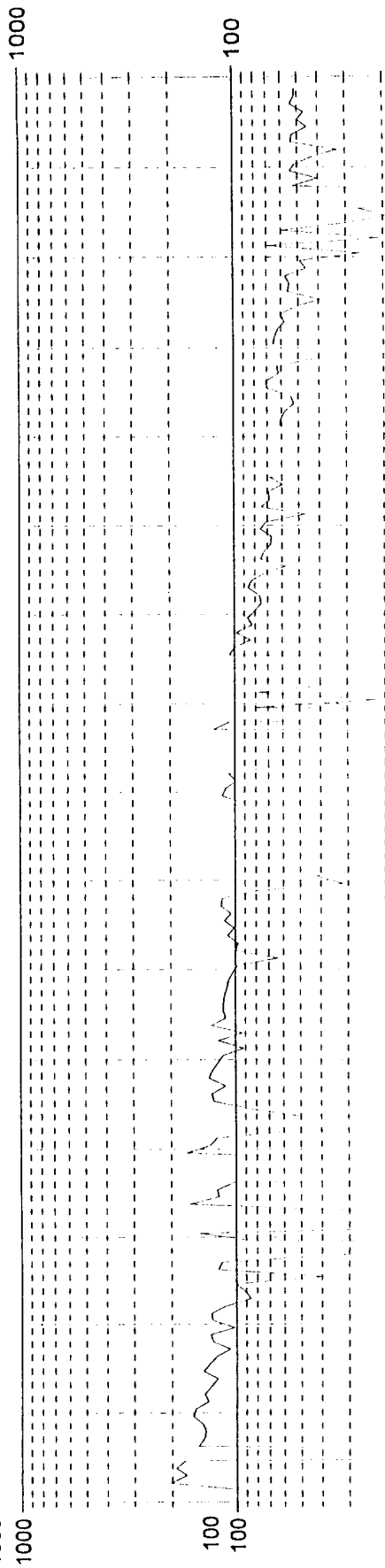

County: SAN JUAN

State: NM

F.P. Date: 02/80

Date: 03/27/96

Field: BLANCO (PICTURED CLIFFS) PC

Oil Cum: 0 bbl

Reservoir: PICTURED CLIFFS

Gas Cum: 423905 mcf

Water (bbl/day)

Operator: AMOCO PRODUCTION CO

Location: 13J 30N 9W

Gas (mcf/day)

Oil (bbl/day)

OFFSET OPERATORS

Meridian Oil, Inc.
P.O. Box 4289
Farmington, NM 87499