

EL PASO FIELD SERVICES PRODUCTION PIT CLOSURE

Risk
EX

Florance No. 2A FT
Meter/Line ID – 95257

SITE DETAILS

Legals - Twn: 30N	Rng: 9W	Sec: 20	Unit: O
NMOCD Hazard Ranking: 10		Land Type: BLM	
Operator: Amoco		Pit Closure Date: 05/17/94	

RATIONALE FOR RISK-BASED CLOSURE

The pit noted above was assessed and ranked according to the criteria in the New Mexico Oil Conservation Division's (NMOCD) Unlined Surface Impoundment Closure Guidelines.

A test pit was excavated to twelve feet and a soil sample was collected for field headspace analysis and laboratory analysis for TPH. Groundwater was not encountered in the test pit. The pit was backfilled and graded in a manner to direct surface runoff away from the pit area. Headspace analysis indicated an organic vapor content of 170 ppm; laboratory analysis indicated a TPH concentration of 868 mg/kg. This site was re-assessed on April 9, 1998, because the initial assessment incorrectly included washes as a surface water body.

El Paso Field Services Company (EPFS) requests closure of the above mentioned production pit location for the following reasons:

- The primary source, discharge to the pit, has been removed for over six years.
- The test pit was backfilled and the former pit area graded to direct surface runoff away from the former pit.
- Groundwater was not encountered in the test excavation.
- There are no water supply wells or other sources of fresh water extraction within 1,000 feet of the site.
- Residual hydrocarbons in the soil will degrade naturally with minimal risk to the environment.
- Based on the Hazard Ranking Score, TPH concentrations were below required remediation levels.

ATTACHMENT

Revised Field Pit Assessment Form
Field Pit Remediation/Closure Form

Field Pit Assessment Form
Laboratory Analytical Results

GENERAL	Meter: <u>95257</u> Location: <u>Florange #2A FT</u> Operator #: _____ Operator Name: _____ P/L District: _____ Coordinates: Letter: <u>0</u> Section <u>20</u> Township: <u>30</u> Range: <u>9</u> Or Latitude _____ Longitude _____ Pit Type: Dehydrator _____ Location Drip: _____ Line Drip: _____ Other: _____ Site Assessment Date: <u>4/9/98</u> Area: _____ Run: _____		
	<div style="display: flex; justify-content: space-between;"> <div style="width: 45%;"> NMOCD Zone: (From NMOCD Maps) </div> <div style="width: 45%;"> Land Type: <div style="display: flex; justify-content: space-between;"> <div style="width: 45%;"> <input type="checkbox"/> Inside <input type="checkbox"/> Outside </div> <div style="width: 45%;"> <input type="checkbox"/> (1) <input checked="" type="checkbox"/> (2) </div> </div> </div> </div> <div style="display: flex; justify-content: space-between; margin-top: 10px;"> <div style="width: 45%;"> Depth to Groundwater Less Than 50 Feet (20 points) <input type="checkbox"/> (1) 50 Ft to 99 Ft (10 points) <input checked="" type="checkbox"/> (2) Greater Than 100 Ft (0 points) <input type="checkbox"/> (3) </div> <div style="width: 45%;"> BLM <input checked="" type="checkbox"/> (1) State <input type="checkbox"/> (2) Fee <input type="checkbox"/> (3) Indian _____ </div> </div> <div style="margin-top: 10px;"> Wellhead Protection Area Is it less than 1000 ft from wells, springs or other sources of fresh water extraction?, or; Is it less than 200 ft from a private domestic water source? <div style="display: flex; justify-content: space-around; margin-top: 5px;"> <input type="checkbox"/> (1) YES (20 points) <input checked="" type="checkbox"/> (2) NO (0 points) </div> </div> <div style="margin-top: 10px;"> Horizontal Distance to Surface Water Body Less Than 200 Ft (20 points) <input type="checkbox"/> (1) 200 Ft to 1000 Ft (10 points) <input type="checkbox"/> (2) Greater Than 1000 Ft (0 points) <input checked="" type="checkbox"/> (3) </div> <div style="margin-top: 10px;"> Name of Surface Water Body _____ (Surface Water Body: Perennial Rivers, Streams, Creeks, Irrigation Canals, Ditches, Lakes, Ponds) </div> <div style="margin-top: 10px;"> Distance to Nearest Ephemeral Stream <input type="checkbox"/> (1) < 100' (Navajo Pits Only) <input type="checkbox"/> (2) > 100' </div> <div style="margin-top: 10px;"> TOTAL HAZARD RANKING SCORE: <u>10</u> POINTS </div>		
SITE ASSESSMENT			
REMARKS	Remarks : <u>Site has been re-assessed, due to initial assessment including washes as a Surface Water Body. Site is <100' vertical from center of Pemada Canyon.</u>		

FIELD PIT SITE ASSESSMENT FORM

GENERAL	Meter: <u>95257</u> Location: <u>FLORENCE #2A FT</u> Operator #: <u>0203</u> Operator Name: <u>AMOCO</u> P/L District: <u>BLOOMFIELD</u> Coordinates: Letter: <u>O</u> Section <u>20</u> Township: <u>30</u> Range: <u>9</u> Or Latitude _____ Longitude _____ Pit Type: Dehydrator _____ Location Drip: <u>X</u> Line Drip: _____ Other: _____ Site Assessment Date: <u>4-19-94</u> Area: <u>10</u> Run: <u>43</u> <u>33</u> ⁴⁻²⁴⁻⁹⁴ RT
	<p>NMOCD Zone: (From NMOCD Maps) Inside <input checked="" type="checkbox"/> (1) Outside <input type="checkbox"/> (2)</p> <p>Land Type: BLM <input checked="" type="checkbox"/> (1) State <input type="checkbox"/> (2) Fee <input type="checkbox"/> (3) Indian _____</p> <p>Depth to Groundwater Less Than 50 Feet (20 points) <input type="checkbox"/> (1) 50 Ft to 99 Ft (10 points) <input type="checkbox"/> (2) Greater Than 100 Ft (0 points) <input checked="" type="checkbox"/> (3)</p> <p>Wellhead Protection Area : Is it less than 1000 ft from wells, springs, or other sources of fresh water extraction? , or ; Is it less than 200 ft from a private domestic water source? <input type="checkbox"/> (1) YES (20 points) <input checked="" type="checkbox"/> (2) NO (0 points)</p> <p>Horizontal Distance to Surface Water Body Less Than 200 Ft (20 points) <input type="checkbox"/> (1) 200 Ft to 1000 Ft (10 points) <input type="checkbox"/> (2) Greater Than 1000 Ft (0 points) <input checked="" type="checkbox"/> (3) Name of Surface Water Body _____ (Surface Water Body : Perennial Rivers,Major Wash,Streams,Creeks, Irrigation Canals,Ditches,Lakes,Ponds) Distance to Nearest Ephemeral Stream <input type="checkbox"/> (1) < 100'(Navajo Pits Only) <input type="checkbox"/> (2) > 100'</p> <p>TOTAL HAZARD RANKING SCORE: <u>0</u> POINTS</p>
SITE ASSESSMENT	
REMARKS	Remarks : <u>FOUR PITS ON LOCATION. WILL CLOSE ONLY ONE PIT IS DRY. DO NOT KNOW WHY LOCATION IS IN THE WATER VULNERABLE ZONE.</u>

ORIGINAL PIT LOCATION

ORIGINAL PIT LOCATION

Original Pit : a) Degrees from North 99° Footage from Wellhead 37'
b) Length : 19' Width : 18' Depth : 4'

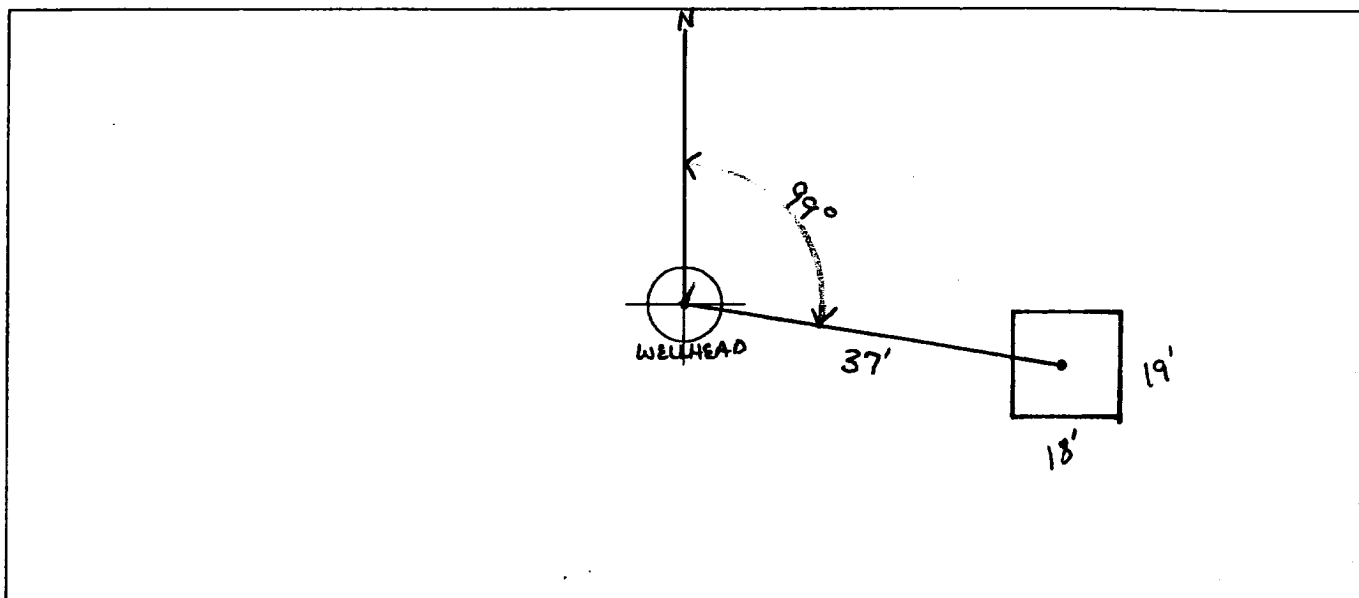

REMARKS

Remarks :

STARTED TAKING PICTURES AT 12:20 P.M.

END DUMP

Completed By:

Robert Thompson
Signature

4.19.94
Date

ORIGINAL PIT LOCATION

ORIGINAL PIT LOCATION

Original Pit : a) Degrees from North 99° Footage from Wellhead 37'
b) Length : 19' Width : 18' Depth : 4'

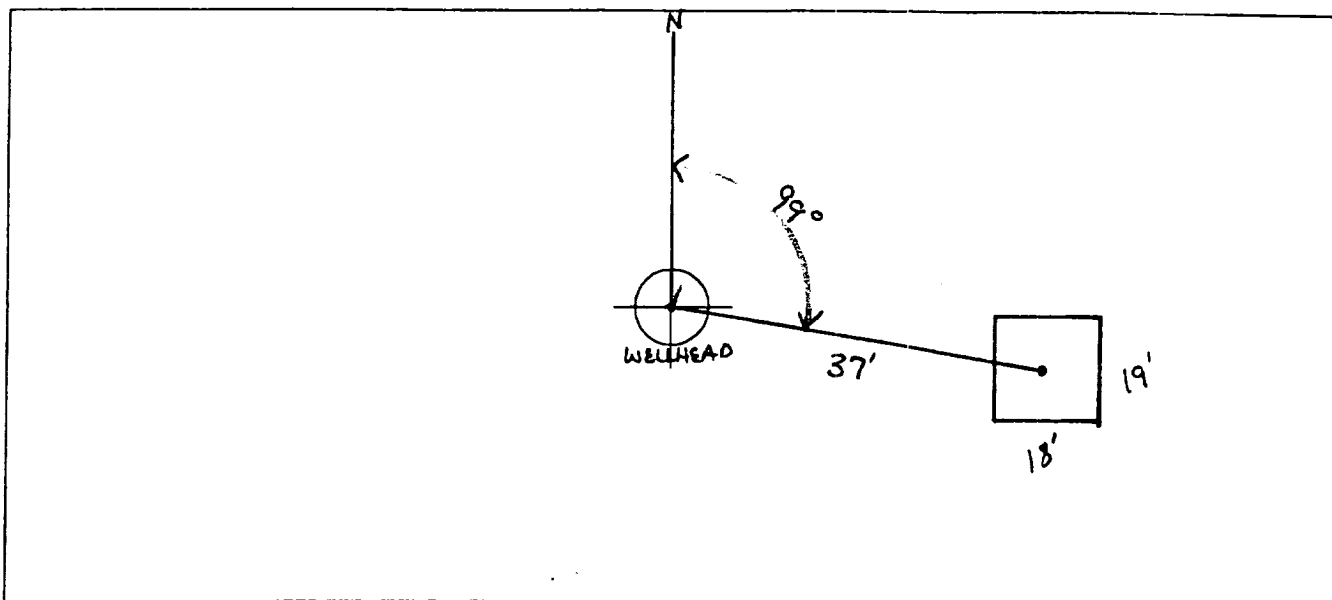

REMARKS

Remarks :

STARTED TAKING PICTURES AT 12:20 P.M.

END DUMP

Completed By:

Robert Thompson

Signature

4.19.94

Date

4-28-94

RT

FIELD PIT SITE ASSESSMENT FORM

GENERAL	Meter: <u>95252</u> Location: <u>FLORENCE #2A FT</u> Operator #: _____ Operator Name: _____ P/L District: _____ Coordinates: Letter: _____ Section: _____ Township: _____ Range: _____ Or Latitude: _____ Longitude: _____ Pit Type: Dehydrator _____ Location Drip: _____ Line Drip: _____ Other: _____ Site Assessment Date: _____ Area: <u>10</u> Run: <u>43</u>
SITE ASSESSMENT	<div> <div>NMOCD Zone: (From NMOCD Maps)</div> <div> Inside <input type="checkbox"/> (1) Outside <input checked="" type="checkbox"/> (2) </div> </div> <div> <div>Land Type:</div> <div> BLM <input type="checkbox"/> (1) State <input type="checkbox"/> (2) Fee <input type="checkbox"/> (3) Indian _____ </div> </div> <div> <div>Depth to Groundwater</div> <div> Less Than 50 Feet (20 points) <input type="checkbox"/> (1) 50 Ft to 99 Ft (10 points) <input checked="" type="checkbox"/> (2) Greater Than 100 Ft (0 points) <input type="checkbox"/> (3) </div> </div> <div> <div>Wellhead Protection Area :</div> <div> Is it less than 1000 ft from wells, springs, or other sources of fresh water extraction? , or ; Is it less than 200 ft from a private domestic water source? <input type="checkbox"/> (1) YES (20 points) <input type="checkbox"/> (2) NO (0 points) </div> </div> <div> <div>Horizontal Distance to Surface Water Body</div> <div> Less Than 200 Ft (20 points) <input type="checkbox"/> (1) 200 Ft to 1000 Ft (10 points) <input type="checkbox"/> (2) Greater Than 1000 Ft (0 points) <input type="checkbox"/> (3) </div> </div> <div> <div>Name of Surface Water Body _____</div> <div> (Surface Water Body : Perennial Rivers, Major Wash, Streams, Creeks, Irrigation Canals, Ditches, Lakes, Ponds) </div> </div> <div> <div>Distance to Nearest Ephemeral Stream</div> <div> <input type="checkbox"/> (1) < 100' (Navajo Pits Only) <input type="checkbox"/> (2) > 100' </div> </div> <div> <div>TOTAL HAZARD RANKING SCORE: <u>10</u> POINTS</div> </div>
MARKS	Remarks : _____ _____ _____

FIELD PIT REMEDIATION/CLOSURE FORM

GENERAL	<p>Meter: <u>95257</u> Location: <u>Florence #2A FT</u></p> <p>Coordinates: Letter: <u>0</u> Section <u>20</u> Township: <u>30</u> Range: <u>9</u></p> <p>Or Latitude _____ Longitude _____</p> <p>Date Started : <u>5-17-94</u> Area: <u>10</u> Run: <u>33</u></p>
FIELD OBSERVATIONS	<p>Sample Number(s): <u>VW88</u></p> <p>Sample Depth: <u>12'</u> Feet</p> <p>Final PID Reading <u>170</u> PID Reading Depth <u>12'</u> Feet</p> <p style="text-align: center;">Yes No</p> <p>Groundwater Encountered <input type="checkbox"/> (1) <input checked="" type="checkbox"/> (2) Approximate Depth _____ Feet</p>
CLOSURE	<p>Remediation Method :</p> <p>Excavation <input type="checkbox"/> (1) Approx. Cubic Yards _____</p> <p>Onsite Bioremediation <input type="checkbox"/> (2)</p> <p>Backfill Pit Without Excavation <input checked="" type="checkbox"/> (3)</p> <p>Soil Disposition:</p> <p>Envirotech <input type="checkbox"/> (1) <input type="checkbox"/> (3) Tierra</p> <p>Other Facility <input type="checkbox"/> (2) Name: _____</p> <p>Pit Closure Date: <u>5-17-94</u> Pit Closed By: <u>BEI</u></p>
REMARKS	<p>Remarks : <u>Line marks.</u></p> <p>_____</p> <p>_____</p>
	<p>Signature of Specialist: <u>Vale Wilson</u></p>



FIELD SERVICES LABORATORY

ANALYTICAL REPORT

PIT CLOSURE PROJECT - Soil

SAMPLE IDENTIFICATION

	Field ID	Lab ID
SAMPLE NUMBER:	VW88	945205
MTR CODE SITE NAME:	95257	N/A
SAMPLE DATE TIME (Hrs):	5-17-94	1020
SAMPLED BY:	N/A	
DATE OF TPH EXT. ANAL.:	5-18-94	5/18/94
DATE OF BTEX EXT. ANAL.:	N/A	N/A
TYPE DESCRIPTION:	VG	Brown/grey coarse sand

REMARKS:

RESULTS

PARAMETER	RESULT	UNITS	QUALIFIERS			
			DF	Q	M(g)	V(ml)
BENZENE		MG/KG				
TOLUENE		MG/KG				
ETHYL BENZENE		MG/KG				
TOTAL XYLENES		MG/KG				
TOTAL BTEX		MG/KG				
TPH (418.1)	870 868 5/17/94	MG/KG			1.98	2.8
HEADSPACE PID	170	PPM				
PERCENT SOLIDS	94.7	%				

-- TPH is by EPA Method 418.1 and BTEX is by EPA Method 8020 --

The Surrogate Recovery was at _____ % for this sample All QA/QC was acceptable.
Negative:

DF = Dilution Factor Used

Approved By:

John Saville

Date:

5/21/94

CHAIN OF CUSTODY RECORD

PROJECT NUMBER				PROJECT NAME				REQUESTED ANALYSIS				CONTINUED LABORATORY P. O. NUMBER			
Pit Closure Project # 24324															
SAMPLERS: (Signature)				DATE:											
Vale Wilson				5/17/94											
LAB ID	DATE	TIME	MATRIX	SAMPLE NUMBER	TOTAL NUMBERS OF CONTAINERS	SAMPLE TYPE	EPA 418.1	BTX	EPA 8020					REMARKS	
5202	5-17-94	840	Soil	VW85	1	V6	X							76	
5203	5-17-94	930	Soil	VW86	1	V6	X							77	
5204	5-17-94	955	Soil	VW87	1	V6	X							78	
5205	5-17-94	1020	Soil	VW88	1	V6	X							79	
5206	5-17-94	1100	Soil	VW89	1	V6	X							80	
5207	5-17-94	1115	Soil	VW90	1	V6	X							81	
5208	5-17-94	1115	Soil	VW91	1	D	X								
5209	5-17-94	1120	Soil	VW92	1	B	X								
5210	5-17-94	1200	Soil	VW93	1	V6	X							82	
5211	5-17-94	1300	Soil	VW94	1	V6	X							83	
5212	5-17-94	1330	Soil	VW95	1	V6	X							84	
5213	5-17-94	1415	Soil	VW96	1	V6	X							85	
RELINQUISHED BY: (Signature)				RECEIVED BY: (Signature)				RELINQUISHED BY: (Signature)				RECEIVED BY: (Signature)			
Vale Wilson				35 Brenda Lee				32 Brenda Lee				5/18/94 0953			
RELINQUISHED BY: (Signature)				RECEIVED BY: (Signature)				RELINQUISHED BY: (Signature)				RECEIVED BY: (Signature)			
												Kim B			
REQUESTED TURNAROUND TIME:				SAMPLE RECEIPT REMARKS				RESULTS & INVOICES TO:							
<input type="checkbox"/> ROUTINE <input type="checkbox"/> RUSH															
CARRIER CO.															
BILL NO.:				CHARGE CODE											

FIELD SERVICES LABORATORY
EL PASO NATURAL GAS COMPANY
P.O. BOX 4990
FARMINGTON, NEW MEXICO 87499

FAX: 505-599-2261

505-599-2144