

UNITED STATES  
DEPARTMENT OF THE INTERIOR  
GEOLOGICAL SURVEY

20-045-2-453

APPLICATION FOR PERMIT TO DRILL, DEEPEN, OR PLUG BACK

1. TYPE OF WORK  
DRILL  DEEPEN  PLUG BACK

2. TYPE OF WELL  
OIL WELL  GAS WELL  OTHER   
SINGLE ZONE  MULTIPLE ZONE

3. NAME OF OPERATOR  
Tenneco Oil Company

4. ADDRESS OF OPERATOR  
1360 Lincoln St., Suite 1200, Denver, Colorado 80203

5. LOCATION OF WELL (Report location clearly and in accordance with any State requirements.)  
At surface 1065' FNL, and 1740' FWL, Unit C  
At proposed prod. zone

5. LEASE DESIGNATION AND SERIAL NO.

SF- 045646-A

6. IF INDIAN, ALLOTTEE OR TRIBE NAME

7. UNIT AGREEMENT NAME

8. FARM OR LEASE NAME

GIOMI

9. WELL NO.

1-A

10. FIELD AND POOL, OR WILDCAT

Blanco Mesa Verde

11. SEC., T., R., M., OR BLK. AND SURVEY OR AREA

Sec 28, T 30N, R 9W

12. COUNTY OR PARISH 13. STATE

San Juan New Mexico

14. DISTANCE IN MILES AND DIRECTION FROM NEAREST TOWN OR POST OFFICE\*  
12 miles East of Aztec, N.M. on highway 173. Turn left on lease road for 1/4 mile. Location is 250' South of there.

15. DISTANCE FROM PROPOSED LOCATION TO NEAREST PROPERTY OR LEASE LINE, FT. (Also to nearest drlg. unit line, if any)

16. NO. OF ACRES IN LEASE

320  
19. PROPOSED DEPTH  
± 5070'

17. NO. OF ACRES ASSIGNED TO THIS WELL

W/320  
20. ROTARY OR CABLE TOOLS  
Rotary

21. ELEVATIONS (Show whether DF, RT, GR, etc.)  
5883' GL

22. APPROX. DATE WORK WILL START\*  
September, 1976

23. PROPOSED CASING AND CEMENTING PROGRAM

SIZE OF HOLE	SIZE OF CASING	WEIGHT PER FOOT	SETTING DEPTH	QUANTITY OF CEMENT
12 1/4"	9 5/8"	36#	± 200'	Suff. to circulate to surface.
8 3/4"	7"	23#	± 2815	Suff. to cement back to surface csg.
6 1/8"	4 1/2"	10.5#	± 2615'-5070'	Suff. to cement back to 7" csg.

- Plan to drill well as follows:
1. MIRURT, drill 12 1/4" hole to +200'.
  2. Set and cement 9 5/8" casing to + 200' & cement with suff. cement to circ. to surface.
  3. Drill out with 8 3/4" bit to +2815 feet.
  4. Run 7" casing and cement back to surface casing.
  5. Drill out of 7" using gas as the circulating fluid, do not drill more than 10' below the 7" casing shoe until the hole has dried up completely and is dusting.
  6. Drill the hole to T.D., log the hole dry as requested by drillsite geologist.
  7. Run 4 1/2" liner to T.D., load hole with mud and cement liner back to top of 4 1/2". Set liner hanger and POH w/drill pipe.
  8. This well will be completed through casing perforations and stimulated as necessary to establish commercial production.
  9. Clean up area.
  10. Approximately 11 days will be required to drill this well.
  11. The gas is dedicated to Southern Union Gathering Co.
- SEE PAGE 2

IN ABOVE SPACE DESCRIBE PROPOSED PROGRAM: If proposal is to deepen or plug back, give data on present productive zone and proposed new productive zone. If proposal is to drill or deepen directionally, give pertinent data on subsurface locations and measured and true vertical depths. Give blowout preventer program, if any.

24. SIGNED A. H. Myers TITLE Div Production Manager DATE 7/30/76

(This space for Federal or State office use)

PERMIT NO.

APPROVED BY \_\_\_\_\_ TITLE \_\_\_\_\_ DATE \_\_\_\_\_

CONDITIONS OF APPROVAL, IF ANY:

*Okal*

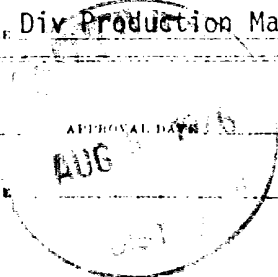

**NEW MEXICO OIL CONSERVATION COMMISSION  
WELL LOCATION AND ACERAGE DEDICATION PLAT**

All distances must be from the outer boundaries of the Section

Operator <b>TENNECO OIL COMPANY</b>			Lease <b>GIOMI</b>		Well No. <b>1-A</b>
Unit Letter <b>C</b>	Section <b>28</b>	Township <b>30 NORTH</b>	Range <b>9 WEST</b>	County <b>SAN JUAN</b>	
Actual Footage Location of Well: <b>1065</b> feet from the <b>NORTH</b> line and <b>1740</b> feet from the <b>WEST</b> line					
Ground Level Elev. <b>5883</b>	Producing Formation <b>Blanco Mesa Verde</b>		Producing Formation <b>Blanco Mesa Verde</b>		Recorded Average: <b>W/320</b>
					Acres

1. Outline the acreage dedicated to the subject well by colored pencil or hachure marks on the plat below.
2. If more than one lease is dedicated to the well, outline each and identify the ownership thereof (both as to working interest and royalty).
3. If more than one lease of different ownership is dedicated to the well, have the interests of all owners been consolidated by communitization, unitization, force-pooling, etc?

**Communitization**

(  ) Yes ( ) No If answer is "yes," type of consolidation .....

If answer is "no," list the owners and tract descriptions which have actually consolidated. (Use reverse side of this form if necessary.) .....

No allowable will be assigned to the well until all interests have been consolidated (by communitization, unitization, forced-pooling, or otherwise) or until a non standard unit, eliminating such interests, has been approved by the Commission.

**CERTIFICATION**

I hereby certify that the information contained herein is true and complete to the best of my knowledge and belief.

Name *Tom P. Deady*  
 Position **Production Clerk**  
 Company **Tenneco Oil Co.**

July 29, 1976

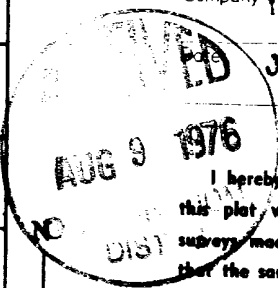
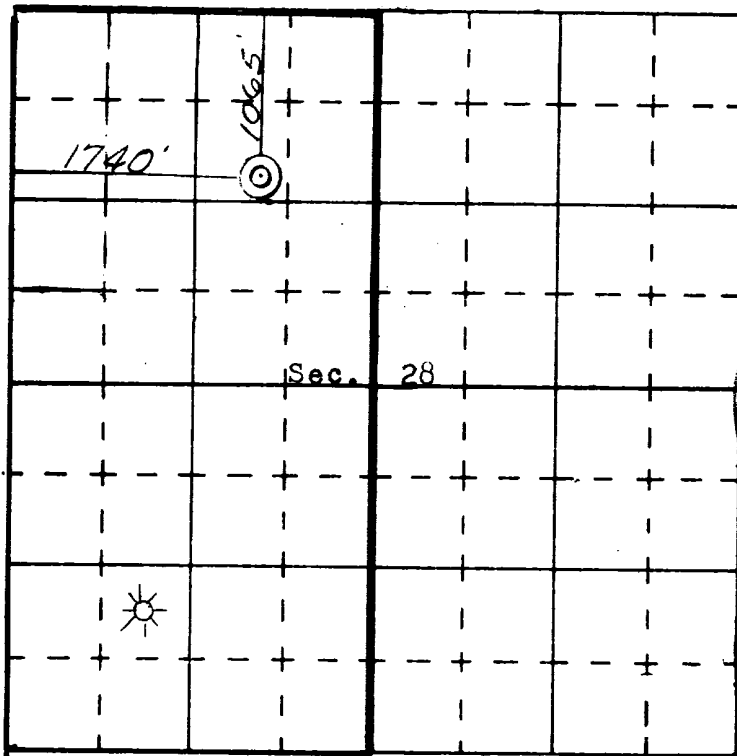

I hereby certify that this plat was plotted from notes of surveys made by me under my supervision, and that the same is true and correct to the best of my knowledge and belief.

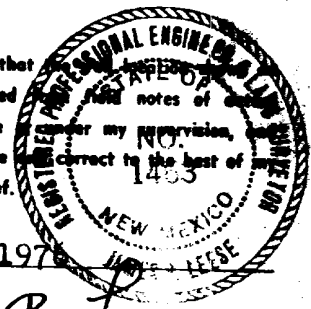

25 June, 1976  
Date Surveyed

*James P. Leese*  
Registered Professional Engineer  
and/or Land Surveyor

**James P. Leese**

1463  
Certificate No

APPLICATION FOR PERMIT TO DRILL, DEEPEN, OR PLUG BACK

( PAGE 2 ) for Giomi 1A

12. SURFACE FORMATION IS Nacimiento

13. FORMATION TOPS (Estimated)

Pictured Cliffs	2565	possible oil or gas producer
Cliff House	4210	possible oil or gas producer
Menefee	4380	possible oil or gas producer
Point Lookout	4775	possible oil or gas producer
Mancos Shale	4950	

14. Mud program : see point 7 of 7 point well control plan

15. No coring or drill stem tests will be taken

16. Logs to be taken= Density  
Gamma Ray  
Caliper and temperature logs  
Deviation surveys will also be taken



GIOMI 1 A  
7 POINT WELL CONTROL PLAN

1. Surface casing: 9 5/8", 24#, approximately 200, grade K-55, new condition.
2. Casinghead will be 10", 900 Series, 3,000 psi rating.
3. Intermediate casing - 7", 20#, K-55, will be set at +2815' and cemented to surface casing.
4. Blowout preventors: Hydraulic, double ram, 10". One set of rams will be provided for each size drill pipe in the hole. One set of blind rams at all times. Fill line will be 2", kill line will be 2", choke relief line will be 2" with variable choke.
5. Auxiliary equipment:
  - (1) Kelly cock will be in use at all times.
  - (2) Stabbing valve to fit drill pipe will be present on floor at all times.
  - (3) Mud monitoring will be visual, no abnormal pressures are anticipated in this area.
  - (4) Rotating head will be used when drilling with gas.
6. Anticipated bottom-hole pressure:

This is an area of known pressure. Maximum anticipated pressure at TD is 1200 psi. Anticipate no H<sub>2</sub>S gas.
7. Drilling Fluids:

0 - 200'	Spud mud
200- <u>2815'</u>	Gel water - low solids as needed to maintain good conditions.
<u>2815'</u> T.D.	Compressed gas

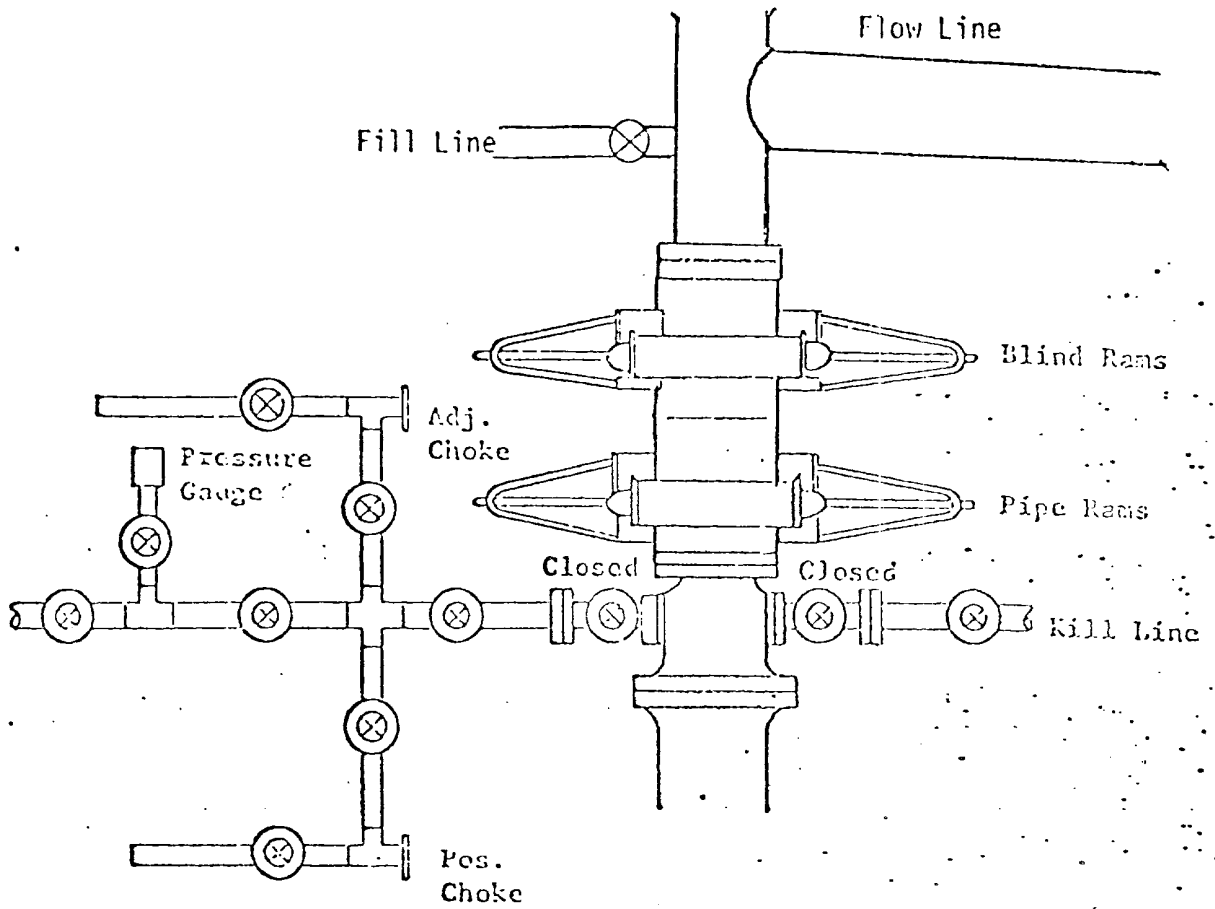

All valves 2"

All BOP's, flanges, spools, valves & lines must be series 900 or 3000 psi working press.

Choke manifold must be at ground level and extended out from under substructure.

TENNECO OIL COMPANY

REQUIRED MINIMUM BLOWOUT PREVENTOR

HOOKUP

Denver, Colorado

BLM SEEDING REQUIREMENTS  
IN THE FARMINGTON RESOURCE AREA

1. SEED MIXTURE 2

2. TIME:

All seeding will take place between July 1 and September 15.

3. EQUIPMENT:

Seeding will be done with a disc-type drill with two boxes for various seed sizes. The drill rows will be eight to ten inches apart. The seed will be planted not less than one-half inch deep or more than one inch deep. The seeder will be followed with a drag, packer, or roller to insure uniform coverage of the seed, and adequate compaction. Drilling will be done on the contour where possible, not up and down the slope. Where slopes are too steep for contour drilling, a "cyclone" hand seeder or similar broadcast seeder will be used. Seed will then be covered to the depth described above by whatever means is practical.

4. SPECIES TO BE PLANTED IN POUNDS PURE-LIVE-SEED PER ACRE:

CRESTED WHEATGRASS (Agropyron desertorum) - 3½ lbs.

FOURWING SALTBUUSH (dewinged) (Atriplex canescens) - ½ lb.

SAND DROPSEED (Sporobolus cryptandrus) - ¾ lb.

WINTERFAT (Eurotia lanata) - ½ lb.

ALKALI SACATON (Sporobolus airoides) - ¾ lb.

BLM COLOR REQUIREMENTS  
IN THE FARMINGTON RESOURCE AREA

1. All equipment shall be painted green to match the surrounding area. (The exception to this is the Florance 30 A which has to be painted gray)

## SURFACE USE PLAN

TENNECO OIL COMPANY'S  
Giomi 1A, 1065' FNL and 1740' FWL of  
Sec. 28, T30N, R9W, Lease SF 045646-A,  
San Juan County, New Mexico

This plan is to accompany "Application for Permit to Drill" for the above mentioned well.

The following is a discussion of pertinent information concerning possible effect which the proposed drilling of the well may have on the environment of the well and road sites and surrounding acreage. A copy will be posted on the derrick floor so that all contractors and subcontractors will be aware of all items of this plan.

1. AREAL ROAD MAP - Exhibit "A" is a portion of a USGS topographic map, San Juan County, New Mexico, showing existing black top roads. Approximately 12 miles from Aztec, New Mexico on Highway 173. Turn left on a lease road for 1/4 of a mile. Location is 250' South of there.
2. LOCATION OF EXISTING WELLS - Several MV, Dak., and P.C. have been drilled in a two mile radius and are shown on Exhibit "B".
3. PROPOSED WELL MAT AND IMMEDIATE AREA - Refer to Exhibit "C" for direction orientation and road access.
  - a. Mat size - 130' x 300'
  - b. Surface - Will be native soil, bladed, watered and capped with clay only when necessary.
  - c. Reserve pit - 150' x 150' unlined pit, joining mat to the
  - d. Cut & Fill - 3' cut on the North side.
  - e. Drill Site Layout - Exhibit "C" shows position of mat, reserve pits, burn pits, trash pits, and mud pits in relation to the well bore. Rig will be erected with the V-Door to the West.
  - f. Setting & Environment -
    - (1) Terrain - Gently sloping to wash South of location. See Exhibit "A", topographic map of area.
    - (2) Soil - Extremely sandy soil
    - (3) Vegetation - Sparse grass, predominately sagebrush with a few scrub cedars.
    - (4) Surface Use - Unknown, possibly used for grazing.

(5) Other - Drill site, which is sloping to the South in semi-arid desert country, is in a low environmental risk area. The total effect of drilling this and other wells in this area would be minimal.

g. Distances to:

- (1) Ponds and Streams - There are no surface waters within 1/2 mile.
- (2) Water Wells - No water well or windmill could be seen within 1/2 mile.
- (3) Residences and Buildings - There are no houses or buildings within 1/2 mile.
- (4) Arroyos, Canyons, etc. - See Exhibit "A". A wash is setting 100' South of reserve pit.

h. Well Sign - Sign identifying and locating well will be maintained at drill site with the spudding of the well.

i. Open Pits - All pits containing mud or other liquids will be fenced.

4. ROADS

a. Existing roads - All existing roads within one mile of the location are shown on Exhibit "A" and Exhibit "D".

b. Planned roads - Plan to construct 250' of new 14 foot wide road.

c. Fences, Gates and Cattleguards - None

5. TANK BATTERY - This is expected to be a dry gas well, therefore, a tank battery will not be required.

6. LEASE PIPELINES

a. Existing - Not furnished by the Operator, to be connected by Southern Union Gathering Co.

b. Planned - If production is encountered, all lease lines are to be constructed on a well mat.

7. WASTE DISPOSAL - Well cuttings will be disposed in reserve pit. Barrel trash containers to be in accessible locations within drill site area during drilling and completion procedures. All detrimental waste will be hauled away, burned or buried with a minimum cover of 24" dirt. See Exhibit "C" for location of pits. If well is productive, maintenance waste will be placed in special trash cans and hauled away periodically. No produced water is anticipated.



8. WATER SUPPLY - Supply water will be hauled from the San Juan River or nearest wash.
9. ARCHAEOLOGICAL RESOURCES - Report will be furnished by Nancy Hewitt from Salamon Ruins, Bloomfield, New Mexico.
10. RESTORATION OF SURFACE - If well is productive, pits will be backfilled and leveled as soon as practical to original condition.
11. OPERATOR'S REPRESENTATIVE - Field personnel who can be contacted concerning compliance of this Surface Use Plan are as follows:

Production & Drilling

Darrell Brown  
1860 Lincoln St., Suite 1200  
Denver, Colorado 80203

Office Phone: (303) 292-9920 Ext. 254  
Home Phone: (303) 771-8297

12. CERTIFICATION

I hereby certify that I, or persons under my direct supervision, have inspected the proposed drill site and access route; that I am familiar with the conditions as they actually exist; that the statements made in this plan are, to the best of my knowledge, true and correct; and that the proposed work performed by Terneco Oil Company and its contractors and sub-contractors will conform to this plan.

Date

8-4-76

D. E. Brown

D. E. Brown  
Div. Drilling Engineer

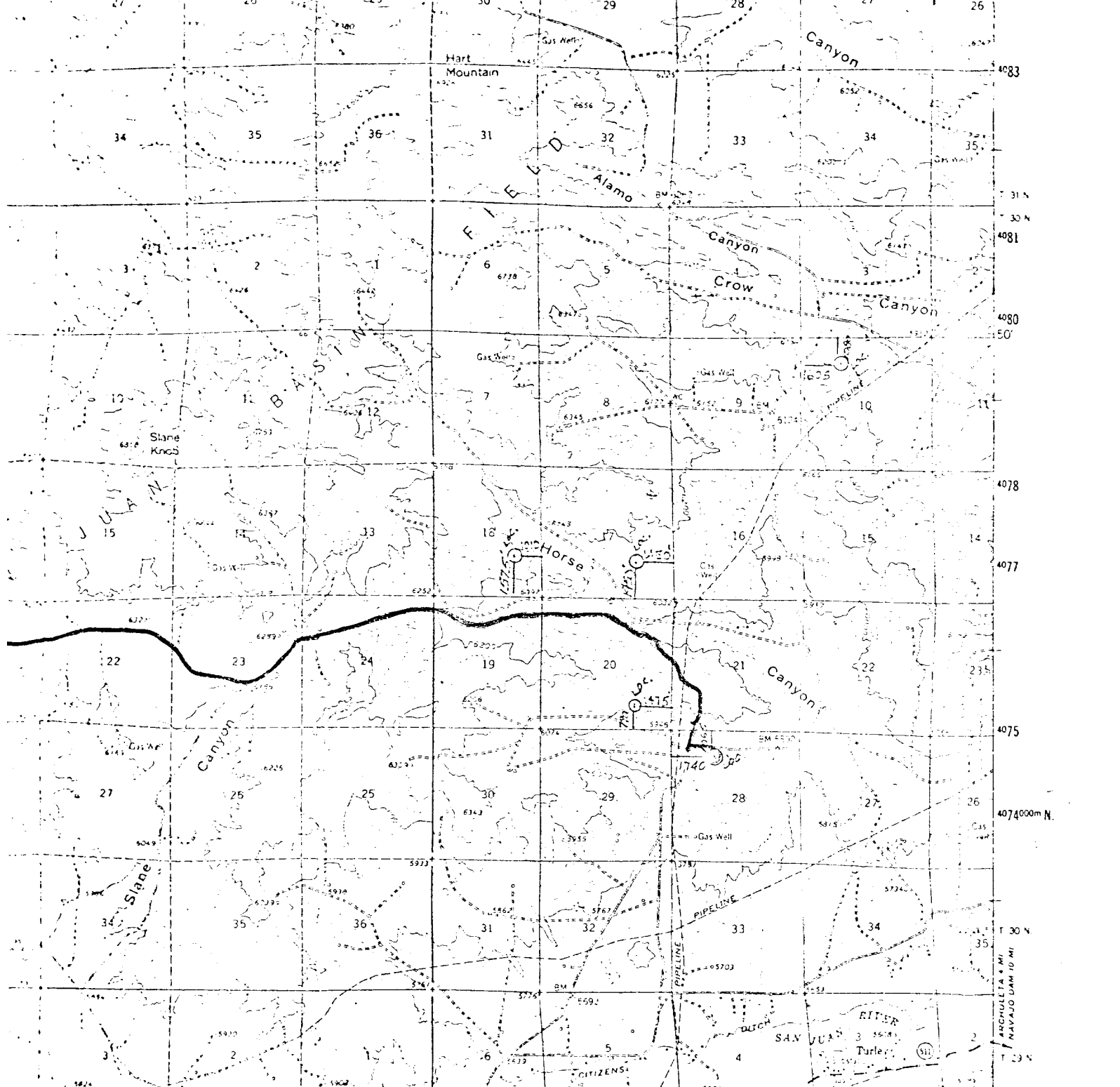

SCALE 1:62500

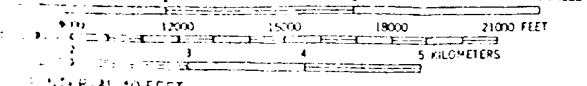

VERTICAL 40 FEET



QUADRANGLE LOCATION

ROAD CLASSIFICATION  
 Medium duty ——— Light duty - - - -  
 Unimproved dirt .....  
 U.S. Route (circle with number)  
 State Route (circle with number)

AZTEC, N. MEX.  
 N3645-W10745/15

1959

AMS 4457 IV SERIES V781

NATIONAL MAP ACCURACY STANDARDS  
 CENTER COLORADO 80225 OR WASHINGTON, D. C. 2024  
 MAPS AND SYMBOLS IS AVAILABLE ON REQUEST

EXHIBIT "A"

Tenneco Oil  
A Tenneco Company

Exhibit "B"

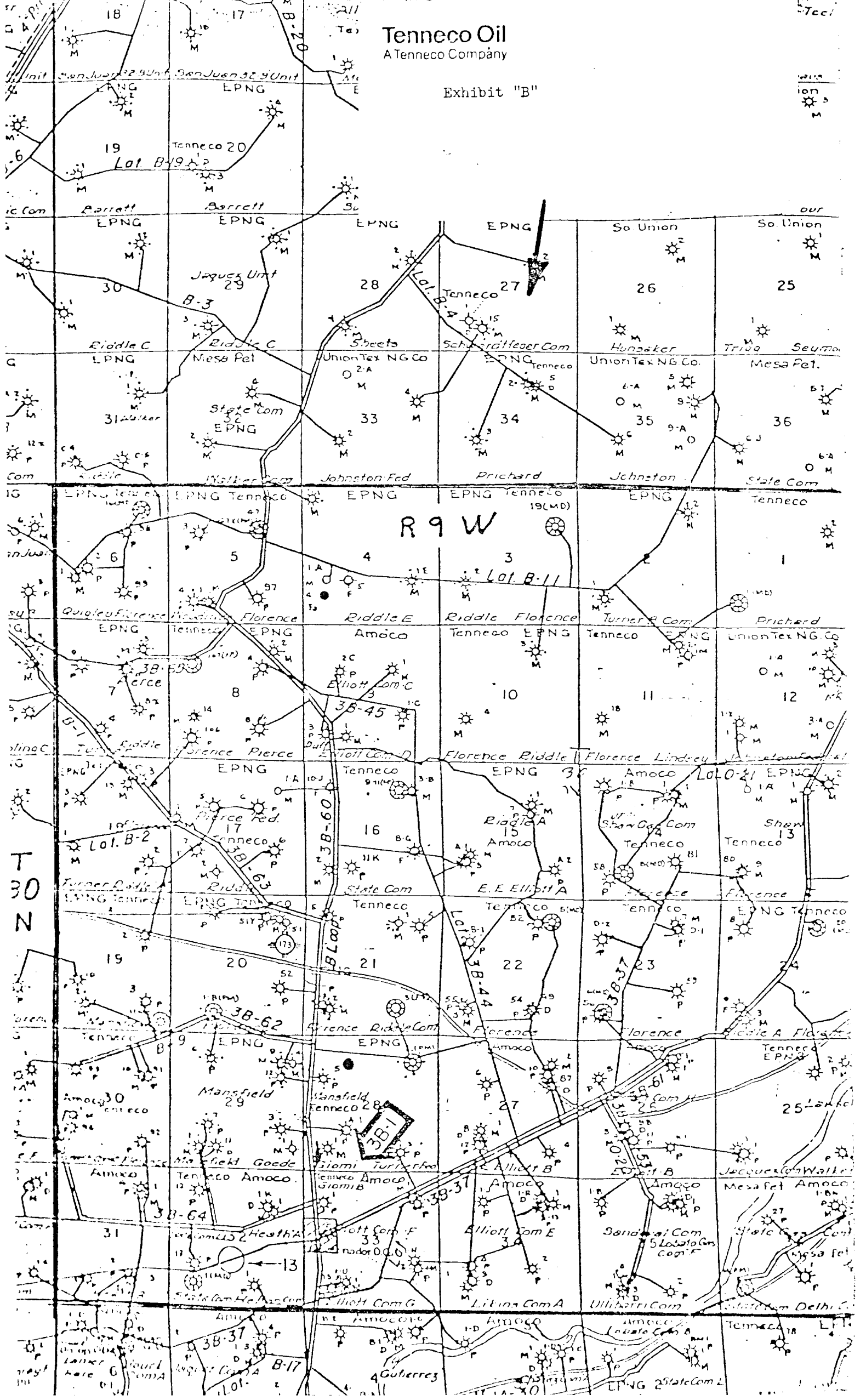

T  
30  
N

R 9 W

Lot B-11

Lot B-2

Lot B-45

Lot B-60

Lot B-62

Lot B-64

Lot B-66

Lot B-68

Lot B-44

Lot B-37

Lot B-31

Lot B-33

Lot B-35

Lot B-21

Lot B-13

Lot B-15

Lot B-17

Lot B-19

Lot B-37

Lot B-39

Lot B-41

Lot B-43

Lot B-45

Lot B-47

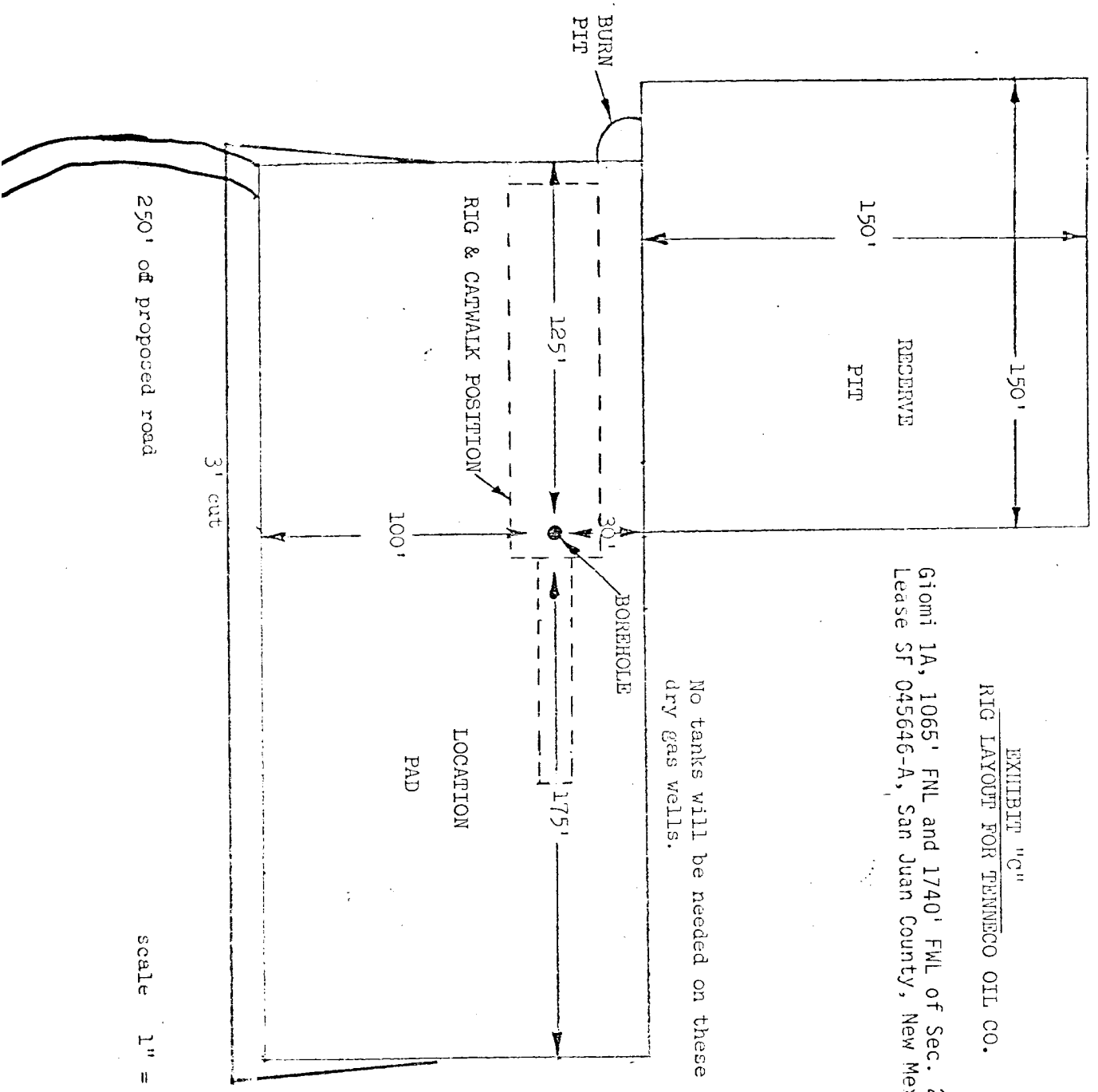
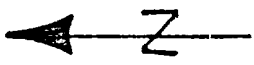

EXHIBIT "C"  
RIG LAYOUT FOR TENNECO OIL CO.

Gioni 1A, 1065' FNL and 1740' FNL of Sec. 28, T30N, R9W,  
Lease SF 045646-A, San Juan County, New Mexico.

No tanks will be needed on these  
dry gas wells.

scale 1" = 50'

Plata

County

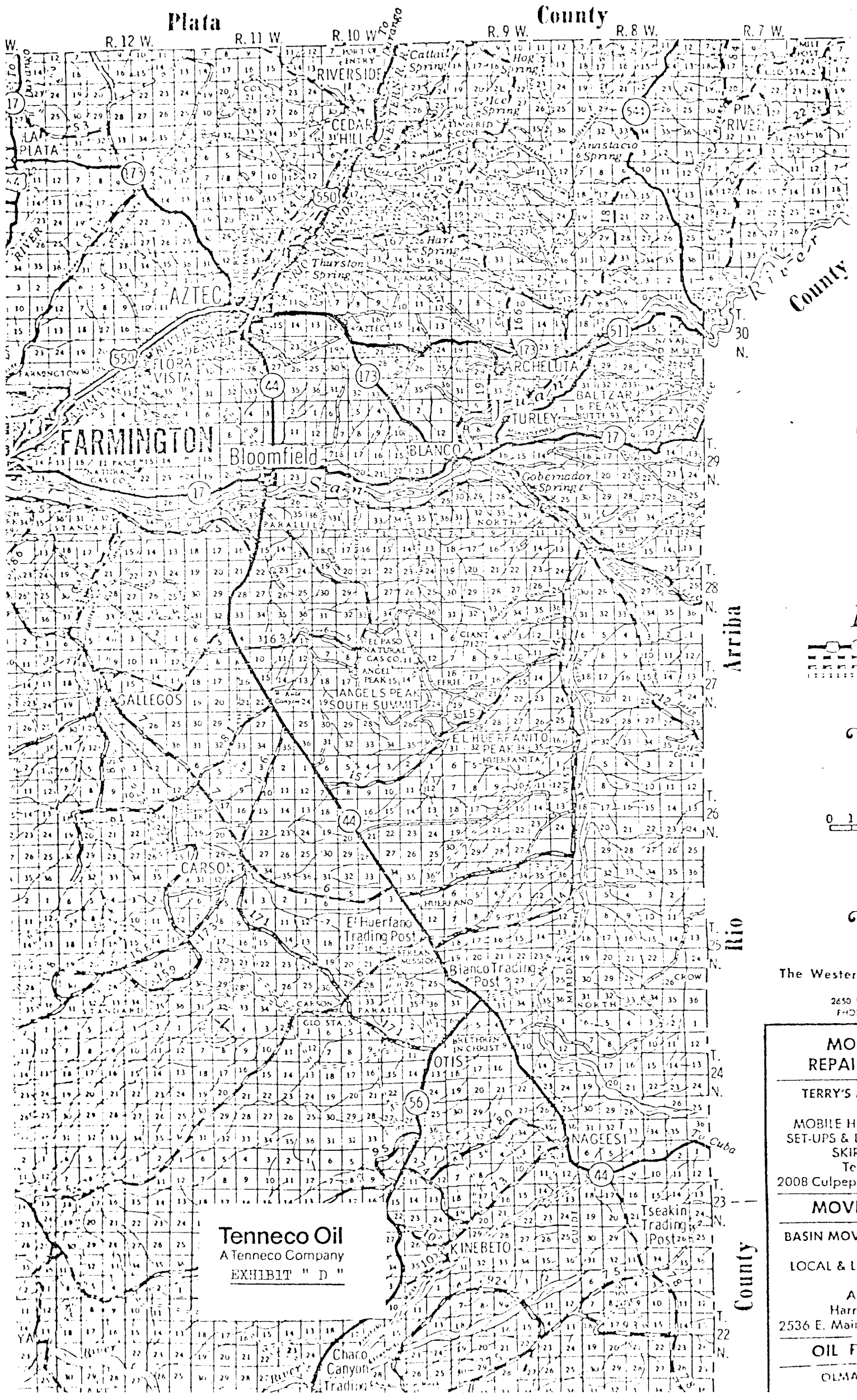

**Tenneco Oil**  
 A Tenneco Company  
 EXHIBIT " D "

The Western  
 2650 E. Front

**MOE REPAIR**

---

TERRY'S AUTO  
 MOBILE HOSE  
 SET-UPS & DETAILING  
 Terry  
 2008 Culpepper

---

**MOVING**

BASIN MOVING  
 LOCAL & LONG DISTANCE  
 ALL TYPES OF MOVING  
 Harry  
 2536 E. Main

---

**OIL FIELD**

OLMARR

