

APPLICATION FOR PERMIT TO DRILL, DEEPEN, OR PLUG BACK

( PAGE 2 ) for Florance #10A

12. SURFACE FORMATION IS San Jose (EOCENE)

13. FORMATION TOPS (Estimated)

Pictured Cliffs	+ 2615'	possible oil or gas producer
Cliff House	+ 4230'	possible oil or gas producer
Menefee	+ 4390'	possible oil or gas producer
Point Lookout	+ 4845'	possible oil or gas producer
Mancos Shale	+ 4980'	possible oil or gas producer

14. Mud program : see point 7 of 7 point well control plan

15. No coring or drill stem tests will be taken

16. Logs to be taken= Density  
Gamma Ray  
Caliper and temperature logs  
Deviation surveys will also be taken

## 7 POINT WELL CONTROL PLAN

1. Surface casing: 9 5/8", 24#, approximately 200, grade K-55, new condition.
2. Casinghead will be 10", 900 Series, 3,000 psi rating.
3. Intermediate casing - 7", 20#, K-55, will be set at  $\pm$  3115' and cemented to surface casing.
4. Blowout preventors: Hydraulic, double ram, 10". One set of rams will be provided for each size drill pipe in the hole. One set of blind rams at all times. Fill line will be 2", kill line will be 2", choke relief line will be 2" with variable choke.
5. Auxiliary equipment:
  - (1) Kelly cock will be in use at all times.
  - (2) Stabbing valve to fit drill pipe will be present on floor at all times.
  - (3) Mud monitoring will be visual, no abnormal pressures are anticipated in this area.
  - (4) Rotating head will be used when drilling with gas.
6. Anticipated bottom-hole pressure:

This is an area of known pressure. Maximum anticipated pressure at TD is 1200 psi. No abnormal pressure is anticipated.
7. Drilling Fluids:

0 - 200'	Spud mud
200-3115'	Gel water - low solids as needed to maintain good conditions.
3115' - T.D.	Compressed gas

BLM SEEDING REQUIREMENTS  
IN THE FARMINGTON RESOURCE AREA

1. SEED MIXTURE 2

2. TIME:

All seeding will take place between July 1 and September 15.

3. EQUIPMENT:

Seeding will be done with a disc-type drill with two boxes for various seed sizes. The drill rows will be eight to ten inches apart. The seed will be planted not less than one-half inch deep or more than one inch deep. The seeder will be followed with a drag, packer, or roller to insure uniform coverage of the seed, and adequate compaction. Drilling will be done on the contour where possible, not up and down the slope. Where slopes are too steep for contour drilling, a "cyclone" hand seeder or similar broadcast seeder will be used. Seed will then be covered to the depth described above by whatever means is practical.

4. SPECIES TO BE PLANTED IN POUNDS PURE-LIVE-SEED PER ACRE:

CRESTED WHEATGRASS (Agropyron desertorum) -  $3\frac{1}{4}$  lbs.

FOURWING SALTBUUSH (dewinged) (Atriplex canescens) -  $\frac{1}{2}$  lb.

SAND DROPSEED (Sporobolus cryptandrus) -  $\frac{3}{4}$  lb.

WINTERFAT (Eurotia lanata) -  $\frac{1}{2}$  lb.

ALKALI SACATON (Sporobolus airoides) -  $\frac{3}{4}$  lb.

BLM COLOR REQUIREMENTS  
IN THE FARMINGTON RESOURCE AREA

1. All equipment shall be painted green to match the surrounding area.

## SURFACE USE PLAN

### TENNECO OIL COMPANY'S

Florance #10A, SE 1/4 of Sec. 30, T30N, R9W,  
Lease #SF 077833, San Juan County, New Mexico.

This plan is to accompany "Application for Permit to Drill" for the above mentioned well.

The following is a discussion of pertinent information concerning possible effect which the proposed drilling of the well may have on the environment of the well and road sites and surrounding acreage. A copy will be posted on the derrick floor so that all contractors and subcontractors will be aware of all items of this plan.

1. AREAL ROAD MAP - Exhibit "A" is a portion of a USGS topographic map, San Juan County, New Mexico, showing existing black top roads. Approximately 11 miles east of Aztec, New Mexico on highway 173, turn south for 2-1/4 miles, turn west for 1/2 miles, turn south. Turn West at four corners on Aztec road, turn left before reaching compressor station, then turn left again to Florance # 92 and follow stakes from there to well site.
2. LOCATION OF EXISTING WELLS - Several MV, Dak., and P.C. have been drilled in a two mile radius and are shown on Exhibit "B".
3. PROPOSED WELL MAT AND IMMEDIATE AREA - Refer to Exhibit "C" for direction orientation and road access.
  - a. Mat size - 130' x 300'
  - b. Surface - Will be native soil, bladed, watered and capped with clay only when necessary.
  - c. Reserve pit - 150' x 150' unlined pit, joining mat to the South West.
  - d. Cut & Fill - 15' cut and 15' fill.
  - e. Drill Site Layout - Exhibit "C" shows position of mat, reserve pits, burn pits, trash pits, and mud pits in relation to the well bore. Rig will be erected with the V-Door to the North West.
  - f. Setting & Environment -
    - (1) Terrain - Sloping to the West                      See Exhibit "A", topographic map of area.
    - (2) Soil - Extremely sandy soil
    - (3) Vegetation - Sparse grass, predominately sagebrush, juniper and cedar.
    - (4) Surface Use - Unknown, possibly used for grazing.

- (5) Other - Drill site, which is sloping to the West, is in a low environmental impact area. The effect of drilling this well and others in this area, would be minimal.

g. Distances to:

- (1) Ponds and Streams - There are no surface waters within 1/2 mile.
- (2) Water Wells - No water well or windmill could be seen within 1/2 mile.
- (3) Residences and Buildings - There are no houses or buildings within 1/2 mile.
- (4) Arroyos, Canyons, etc. - See Exhibit "A". There is an arroyo to the West of the location.

h. Well Sign - Sign identifying and locating well will be maintained at drill site with the spudding of the well.

i. Open Pits - All pits containing mud or other liquids will be fenced.

4. ROADS

- a. Existing roads - All existing roads within one mile of the location are shown on Exhibit "A" and Exhibit "D".
- b. Planned roads - Plan to construct 500' of new 14 foot wide road, North from Florance #92. We will install waterbars where needed.
- c. Fences, Gates and Cattleguards - None

5. TANK BATTERY - This is expected to be a dry gas well, therefore, a tank battery will not be required.

6. LEASE PIPELINES

- a. Existing - Not furnished by the Operator, to be connected by Southern Union Gathering Co.
- b. Planned - If production is encountered, all lease lines are to be constructed on a well mat.

7. WASTE DISPOSAL - Well cuttings will be disposed in reserve pit. Barrel trash containers to be in accessible locations within drill site area during drilling and completion procedures. All detrimental waste will be hauled away, burned or buried with a minimum cover of 24" dirt. See Exhibit "C" for location of pits. If well is productive, maintenance waste will be placed in special trash cans and hauled away periodically. No produced water is anticipated.

8. WATER SUPPLY - Supply water will be hauled from the San Juan River or nearest wash.
9. ARCHAEOLOGICAL RESOURCES - Report has been furnished by ~~Pat. Zarnowski~~ from Salamon Ruins, Bloomfield, New Mexico.
10. RESTORATION OF SURFACE - If well is productive, pits will be backfilled and leveled as soon as practical to original condition.
11. OPERATOR'S REPRESENTATIVE - Field personnel who can be contacted concerning compliance of this Surface Use Plan are as follows:

Production & Drilling

Darrell Brown  
1860 Lincoln St., Suite 1200  
Denver, Colorado 80203

Office Phone: (303) 292-9920 Ext. 254  
Home Phone: (303) 771-8297

12. CERTIFICATION

I hereby certify that I, or persons under my direct supervision, have inspected the proposed drill site and access route; that I am familiar with the conditions as they actually exist; that the statements made in this plan are, to the best of my knowledge, true and correct; and that the proposed work performed by Tenneco Oil Company and its contractors and sub-contractors will conform to this plan.

11-9-76  
Date

D. E. Brown  
D. E. Brown  
Div. Drilling Engineer

**Tenneco Oil**  
A Tenneco Company  
EXHIBIT " A "

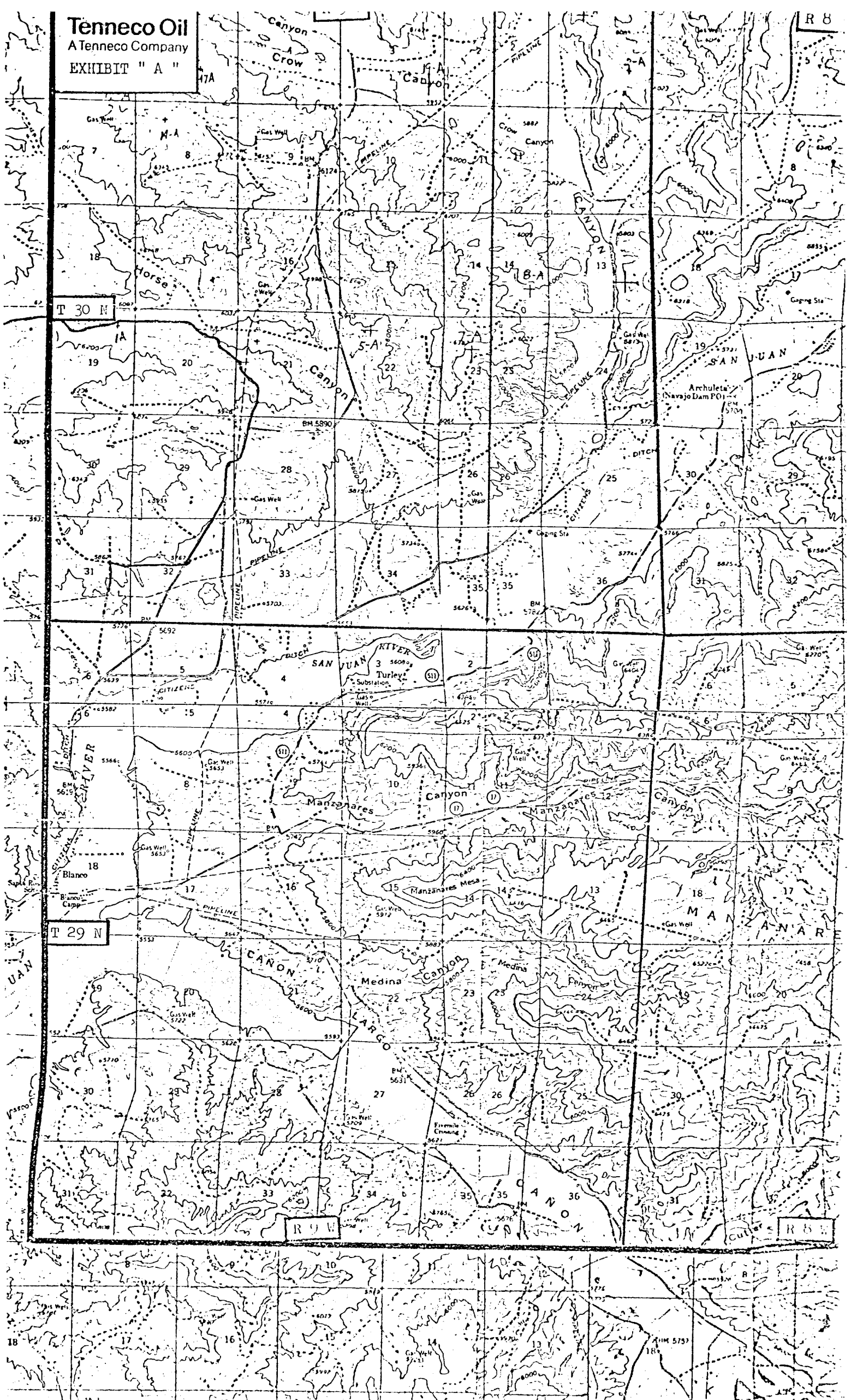

Exhibit "B"

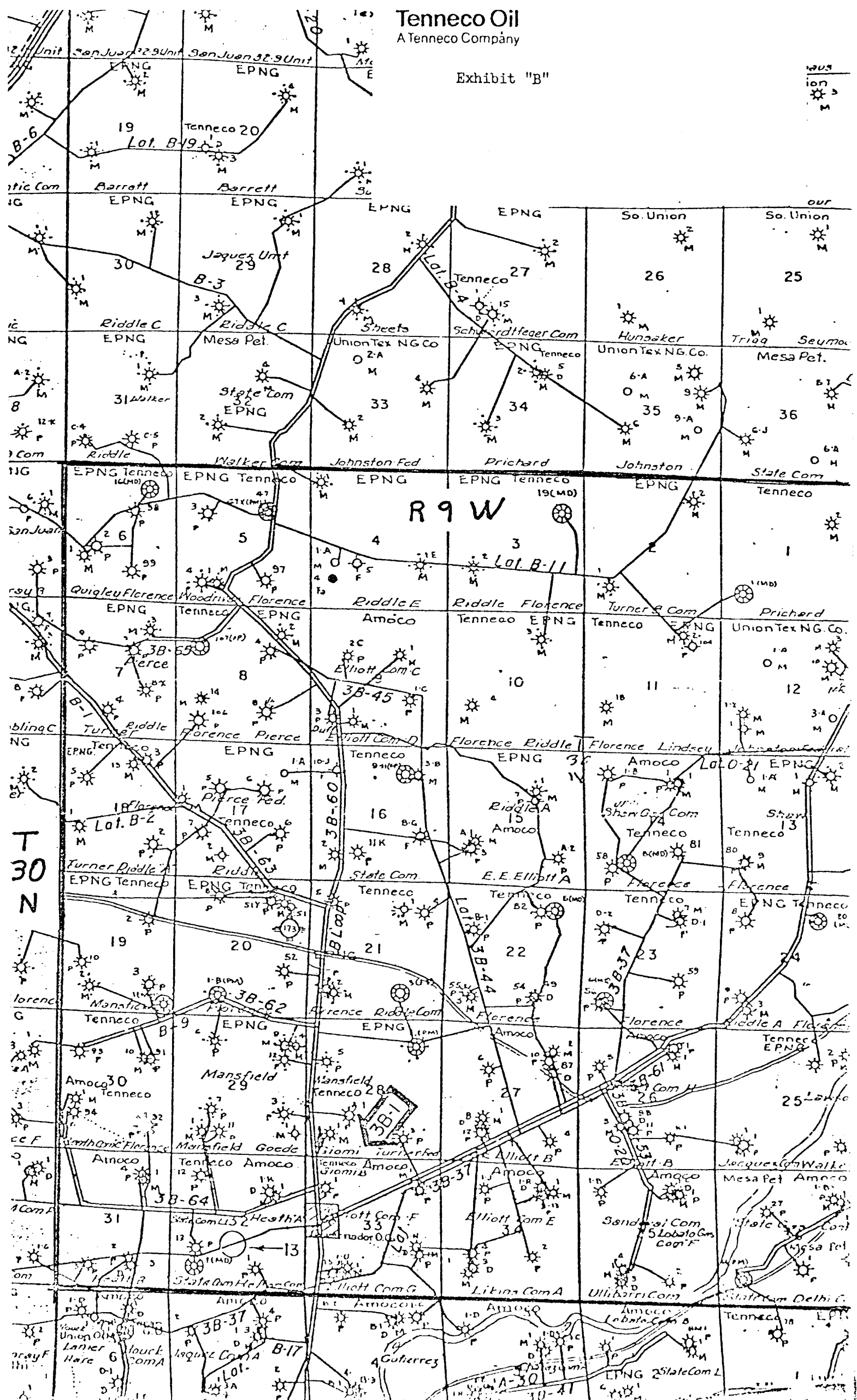
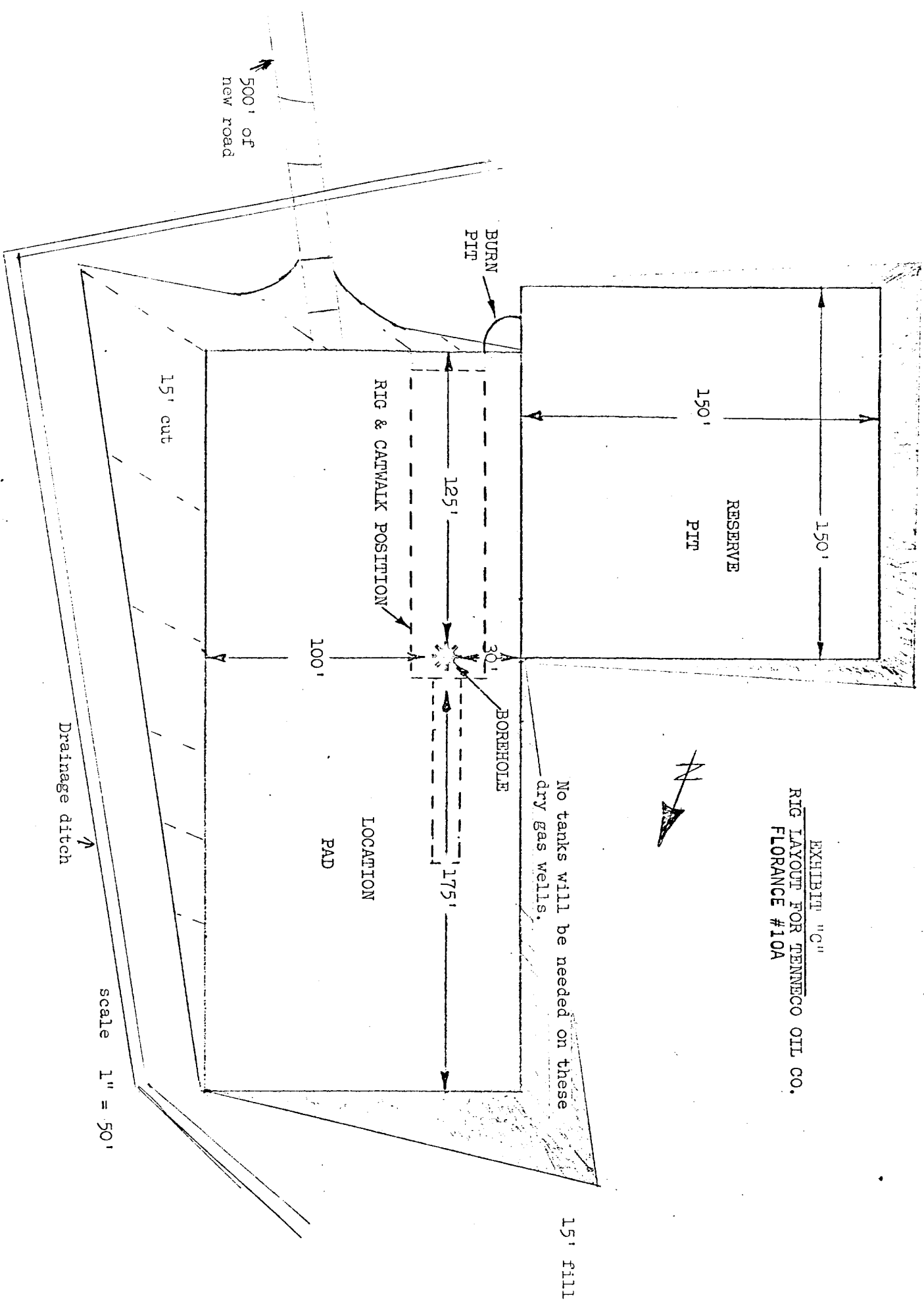
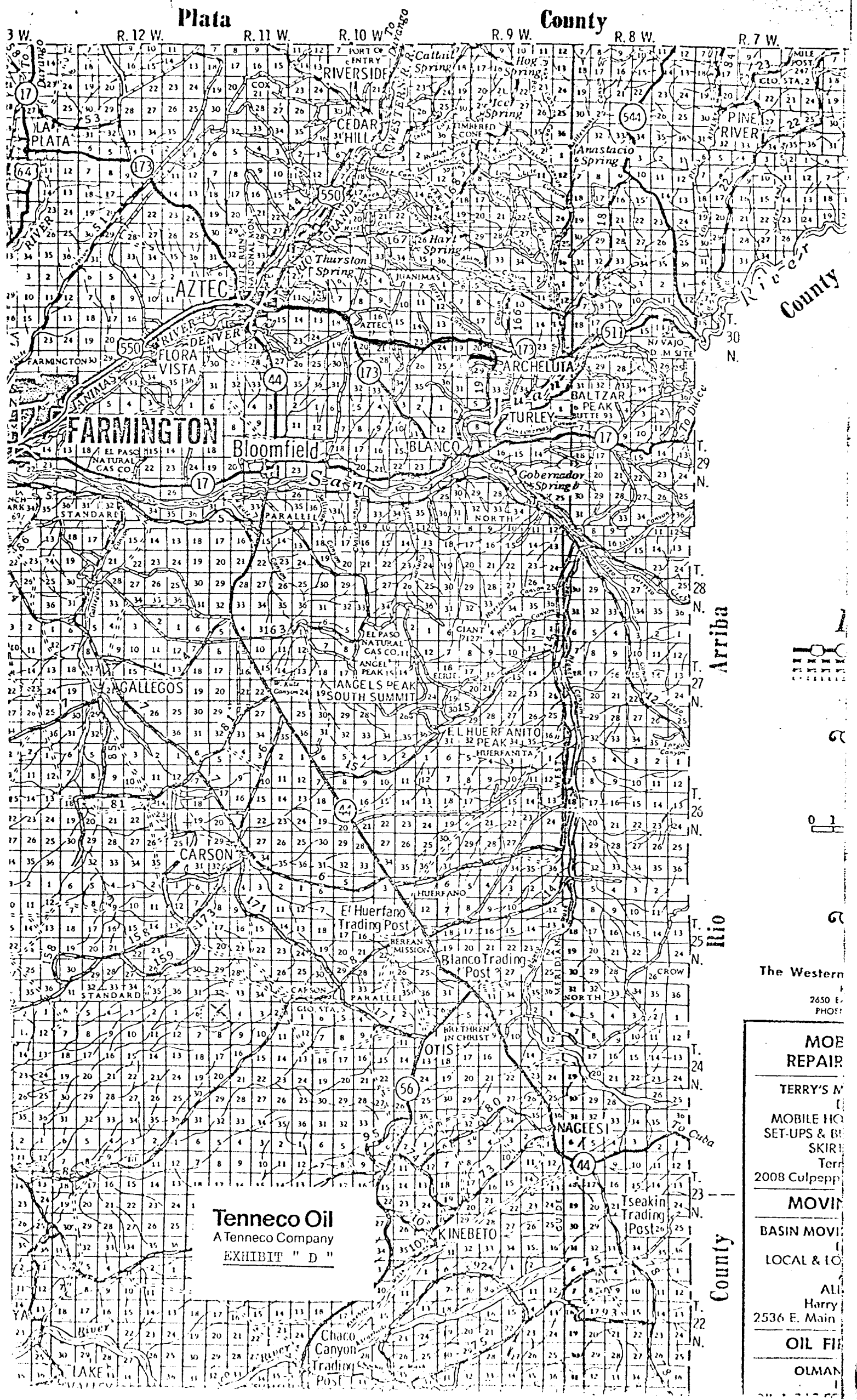



EXHIBIT "C"  
RIG LAYOUT FOR TENNECO OIL CO.  
FLORANCE #10A





**Tenneco Oil**  
A Tenneco Company  
EXHIBIT " D "

The Western  
2650 E.  
PHOS

**MOE  
REPAIR**

TERRY'S M  
MOBILE HO  
SET-UPS & B  
SKIR  
Terr  
2008 Culp  
pepp

**MOVIN**

BASIN MOVI  
LOCAL & LO

ALL  
Harry  
2536 E. Main

**OIL FI**

OLMAN