

NO. OF COPIES RECEIVED	5
DISTRIBUTION	
SANTA FE	1
FILE	1
U.S.G.S.	2
LAND OFFICE	
OPERATOR	1

NEW MEXICO OIL CONSERVATION COMMISSION

30-045-22312
Form C-101
Revised 1-1-65

5A. Indicate Type of Lease	
STATE <input type="checkbox"/>	FEE <input checked="" type="checkbox"/>
5. State Oil & Gas Lease No.	

APPLICATION FOR PERMIT TO DRILL, DEEPEN, OR PLUG BACK

1a. Type of Work		7. Unit Agreement Name	
b. Type of Well DRILL <input checked="" type="checkbox"/> DEEPEN <input type="checkbox"/> PLUG BACK <input type="checkbox"/> OIL WELL <input type="checkbox"/> GAS WELL <input checked="" type="checkbox"/> OTHER <input type="checkbox"/> SINGLE ZONE <input checked="" type="checkbox"/> MULTIPLE ZONE <input type="checkbox"/>		8. Farm or Lease Name Heath Gas Com "B"	
2. Name of Operator AMOCO PRODUCTION COMPANY		9. Well No. 1A	
3. Address of Operator 501 Airport Drive, Farmington, New Mexico 87401		10. Field and Pool, or Wildcat Bianco Mesaverde	
4. Location of Well UNIT LETTER F LOCATED 1490 FEET FROM THE North LINE AND 1450 FEET FROM THE West LINE OF SEC. 9 TWP. 29N RGE. 9W NMPM		12. County San Juan	
21. Elevations (Show whether DF, RT, etc.) 5713' GL, 5726' KB		19. Proposed Depth 4800'	19A. Formation Mesaverde
21A. Kind & Status Plug. Bond Statewide	21B. Drilling Contractor Arapahoe Rig No. 1	20. Rotary or C.T. Rotary	
22. Approx. Date Work will start February, 1977			

23.

PROPOSED CASING AND CEMENT PROGRAM

SIZE OF HOLE	SIZE OF CASING	WEIGHT PER FOOT	SETTING DEPTH	SACKS OF CEMENT	EST. TOP
12-1/4"	9-5/8"	32.3#	250'	280	circ.
8-3/4"	7"	20#	2650'	510	circ.
6-1/4"	4-1/2"	11#	2450-4800'	275	circ.

Amoco proposes to drill the above well to develop the Mesaverde reservoir. The well will be drilled using rotary tools with water and Benex as the circulating media to the intermediate casing point. The well will be gas drilled from the intermediate casing point to TD. Production casing will be set thru the Mesaverde formation on completion. Perforations and stimulation will be based on analysis of open hole logs. Copy of all logs will be filed upon completion. Amoco's standard blowout prevention will be employed, see attached drawing for blowout preventer design.

Upon completion, the well location will be cleaned, and the reserve pit filled and levelled.

Gas produced from this well is dedicated to **El Paso Natural Gas Company.**

APPROVAL VALID
FOR 90 DAY PERIOD
IF DRILLING COMMENCED,
EXPIRES 4-13-77

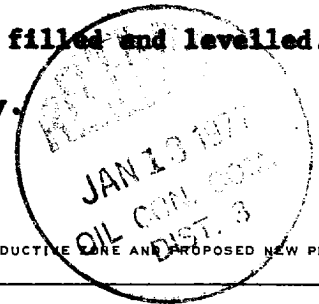

IN ABOVE SPACE DESCRIBE PROPOSED PROGRAM; IF PROPOSAL IS TO DEEPEN OR PLUG BACK, GIVE DATA ON PRESENT PRODUCTIVE ZONE AND PROPOSED NEW PRODUCTIVE ZONE. GIVE BLOWOUT PREVENTER PROGRAM, IF ANY.

I hereby certify that the information above is true and complete to the best of my knowledge and belief.

Signed H. Montgomery Title Area Engineer Date January 13, 1977

(This space for State Use)

PETROLEUM ENGINEER DIST NO. 3

APPROVED BY H. E. Maxwell TITLE _____ DATE JAN 13 1977

CONDITIONS OF APPROVAL, IF ANY:

NEW MEXICO OIL CONSERVATION COMMISSION
WELL LOCATION AND ACREAGE DEDICATION PLAT

Form C-102
Supersedes C-128
Effective 1-1-65

All distances must be from the outer boundaries of the Section.

Operator Amoco Production Company			Lease Heath Gas Com B		Well No. 1A
Unit Letter F	Section 9	Township 29N	Range 9W	County San Juan	
Actual Forage Location of Well: 11490 feet from the North line and 11450 feet from the West line					
Ground Level Elev. 5713	Producing Formation Mesa Verde		Pool Blanco Mesaverde		Dedicated Acreage: 320 Acres

1. Outline the acreage dedicated to the subject well by colored pencil or hachure marks on the plat below.
2. If more than one lease is dedicated to the well, outline each and identify the ownership thereof (both as to working interest and royalty).
3. If more than one lease of different ownership is dedicated to the well, have the interests of all owners been consolidated by communitization, unitization, force-pooling, etc?

☐ Yes ☐ No If answer is "yes," type of consolidation _____

If answer is "no," list the owners and tract descriptions which have actually been consolidated. (Use reverse side of this form if necessary.) _____

No allowable will be assigned to the well until all interests have been consolidated (by communitization, unitization, forced-pooling, or otherwise) or until a non-standard unit, eliminating such interests, has been approved by the Commission.

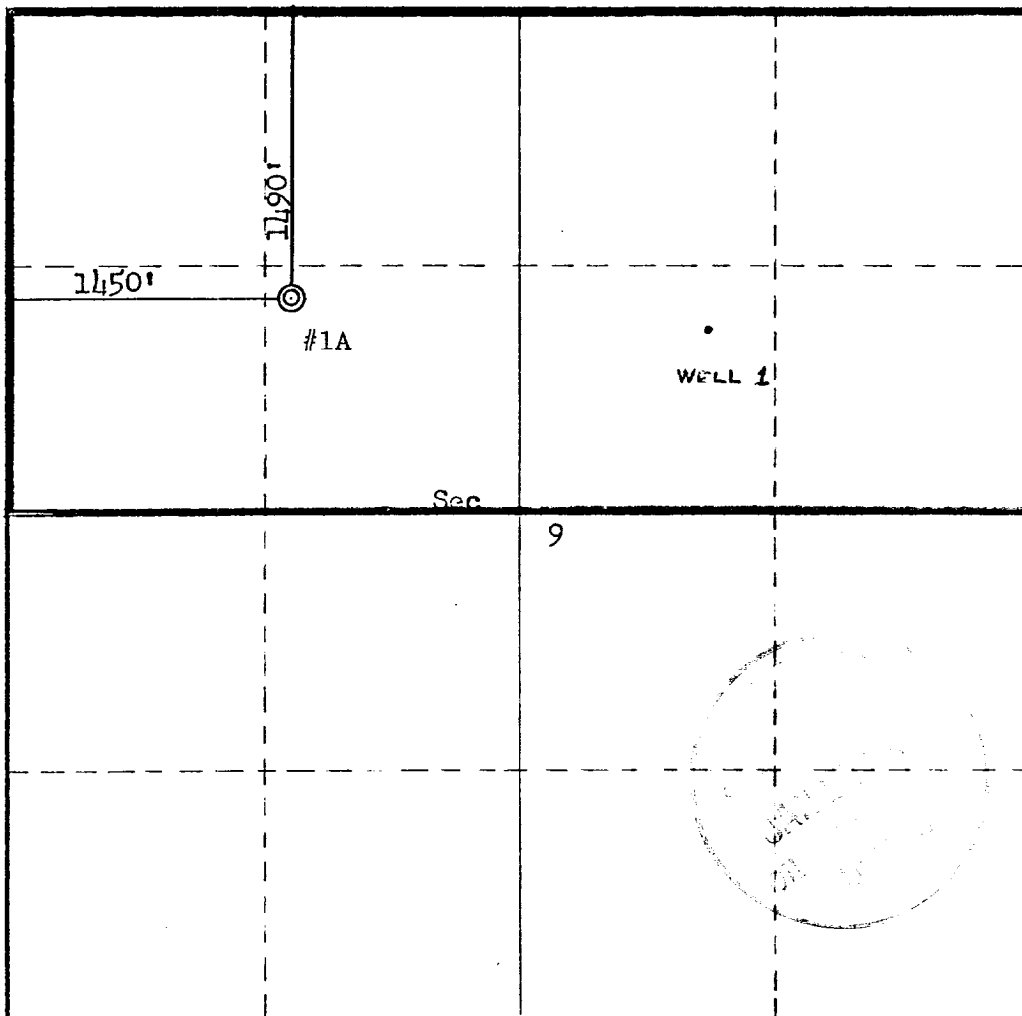

CERTIFICATION

I hereby certify that the information contained herein is true and complete to the best of my knowledge and belief.

Name
H. D. Montgomery
Position
Area Engineer
Company
AMOCO PRODUCTION COMPANY
Date
December 22, 1976

I hereby certify that the well location shown on this plat was plotted from field notes of actual surveys made by me or under my supervision, and that the same is true and correct to the best of my knowledge and belief.

Date Surveyed
December 13, 1976
Registered Professional Engineer and/or Land Surveyor
Fred B. Kerr, Jr.
Certificate No.
3950