

UNITED STATES  
DEPARTMENT OF THE INTERIOR  
GEOLOGICAL SURVEY

## APPLICATION FOR PERMIT TO DRILL, DEEPEN, OR PLUG BACK

1a. TYPE OF WORK  
DRILL ☒ DEEPEN ☐ PLUG BACK ☐

b. TYPE OF WELL  
OIL WELL ☐ GAS WELL ☒ OTHER ☐ SINGLE ZONE ☒ MULTIPLE ZONE ☐

2. NAME OF OPERATOR  
**Sapron Energy Corporation**

3. ADDRESS OF OPERATOR  
**P. O. Box 808, Farmington, New Mexico 87401**

4. LOCATION OF WELL (Report location clearly and in accordance with any State requirements.)\*  
At surface **1785' South line & 1575 ft. West line.**  
At proposed prod. zone **Same as above.**

14. DISTANCE IN MILES AND DIRECTION FROM NEAREST TOWN OR POST OFFICE\*  
**6 Miles East of Artes, New Mexico**

15. DISTANCE FROM PROPOSED\*  
LOCATION TO NEAREST PROPERTY OR LEASE LINE, FT. **855 feet**  
(Also to nearest drlg. unit line, if any) **855 feet**

16. NO. OF ACRES IN LEASE  
**323.84**

17. NO. OF ACRES ASSIGNED TO THIS WELL  
**SW 1/4 158.44 163.84**

18. DISTANCE FROM PROPOSED LOCATION\*  
TO NEAREST WELL, DRILLING, COMPLETED, OR APPLIED FOR, ON THIS LEASE, FT. **120 feet**

19. PROPOSED DEPTH  
**2950 Ft.**

20. ROTARY OR CABLE TOOLS  
**Rotary**

21. ELEVATIONS (Show whether DF, RT, GR, etc.)  
**6271 Gr.**

22. APPROX. DATE WORK WILL START\*  
**September 10, 1979**

5. LEASE DESIGNATION AND SERIAL NO.  
**30-042-23678**  
**IN 0555078**

6. IF INDIAN, ALLOTTEE OR TRIBE NAME

7. UNIT AGREEMENT NAME

8. FARM OR LEASE NAME  
**Melms Federal**

9. WELL NO.  
**2**

10. FIELD AND POOL, OR WILDCAT  
**Artes Pictured Cliffs EXT**

11. SEC., T., R., M., OR BLK. AND SURVEY OR AREA  
**Sec. 22, T-30N, R-10W, N.M.P.M.**

12. COUNTY OR PARISH  
**San Juan**

13. STATE  
**New Mexico**

## 23. PROPOSED CASING AND CEMENTING PROGRAM

SIZE OF HOLE	SIZE OF CASING	WEIGHT PER FOOT	SETTING DEPTH	QUANTITY OF CEMENT
9-7/8	7-5/8	20.0	250 Ft.	150 sz.
6-3/4	2-7/8		2950 Ft.	200 sz.

This well will be drilled by setting surface pipe at approximately 250 feet, running casing and circulating cement to surface then drill with mud to T.D. Casing will be run to T.D. and the long string run and cemented. The well will then be perforated, fraced, tested and put on production.

gas is exhibited

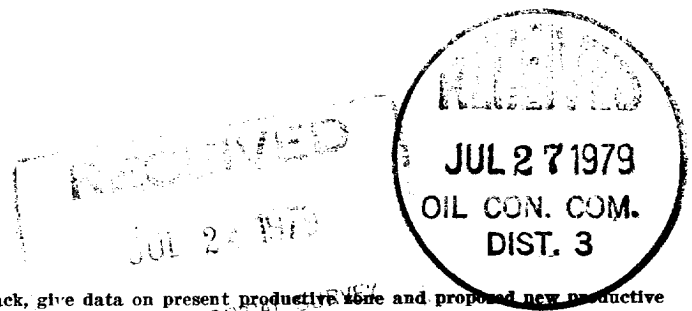

IN ABOVE SPACE DESCRIBE PROPOSED PROGRAM: If proposal is to deepen or plug back, give data on present productive zone and proposed new productive zone. If proposal is to drill or deepen directionally, give pertinent data on subsurface locations and measured and true vertical depths. Give blowout preventer program, if any.

24. SIGNED *Andy D. Motto* TITLE Area Superintendent DATE July 20, 1979  
(This space for Federal or State office use)

PERMIT NO. \_\_\_\_\_ APPROVAL DATE \_\_\_\_\_

APPROVED BY \_\_\_\_\_ TITLE \_\_\_\_\_ DATE \_\_\_\_\_  
CONDITIONS OF APPROVAL, IF ANY:

*Winkler ok Fresh*

*NMOCC*

## Instructions

**General:** This form is designed for submitting proposals to perform certain well operations, as indicated, on all types of lands and leases for appropriate action by either a Federal or a State agency, or both, pursuant to applicable Federal and/or State laws and regulations. Any necessary special instructions concerning the use of this form and the number of copies to be submitted, particularly with regard to local, area, or regional procedures and practices, either are shown below or will be issued by, or may be obtained from, the local Federal and/or State office.

**Item 1:** If the proposal is to redrill to the same reservoir at a different subsurface location or to a new reservoir, use this form with appropriate notations. Consult applicable State or Federal regulations concerning subsequent work proposals or reports on the well.

**Item 4:** If there are no applicable State requirements, locations on Federal or Indian land should be described in accordance with Federal requirements. Consult local State or Federal office for specific instructions.

**Item 14:** Needed only when location of well cannot readily be found by road from the land or lease description. A plat, or plats, separate or on this reverse side, showing the roads to, and the surveyed location of, the well, and any other required information, should be furnished when required by Federal or State agency offices.

**Items 15 and 18:** If well is to be, or has been directionally drilled, give distances for subsurface location of hole in any present or objective production zone.

**Item 22:** Consult applicable Federal or State regulations, or appropriate officials, concerning approval of the proposal before operations are started.

NEW MEXICO OIL CONSERVATION COMMISSION  
WELL LOCATION AND ACREAGE DEDICATION PLAT

Form C-102  
Supersedes C-128  
Effective 1-1-65

All distances must be from the outer boundaries of the Section.

Operator <b>SUPRON ENERGY CORPORATION</b>			Lease <b>HELMS FEDERAL</b>			Well No. <b>2</b>		
Unit Letter <b>K</b>	Section <b>22</b>	Township <b>30 NORTH</b>	Range <b>10 WEST</b>	County <b>SAN JUAN</b>				
Actual Footage Location of Well:								
<b>1785</b>		feet from the <b>SOUTH</b>		line and <b>1575</b>		feet from the <b>WEST</b>		line
Ground Level Elev. <b>6271</b>	Producing Formation <b>PICTURED CLIFFS</b>		Pool <b>ABRIL BLANCO EXT</b>			Dedicated Acreage: <b>163.84</b> <b>SW 1/4 158.44</b> Acres		

1. Outline the acreage dedicated to the subject well by colored pencil or hachure marks on the plat below.
2. If more than one lease is dedicated to the well, outline each and identify the ownership thereof (both as to working interest and royalty).
3. If more than one lease of different ownership is dedicated to the well, have the interests of all owners been consolidated by communitization, unitization, force-pooling, etc?

☐ Yes ☐ No If answer is "yes," type of consolidation \_\_\_\_\_

If answer is "no," list the owners and tract descriptions which have actually been consolidated. (Use reverse side of this form if necessary.) \_\_\_\_\_

No allowable will be assigned to the well until all interests have been consolidated (by communitization, unitization, forced-pooling, or otherwise) or until a non-standard unit, eliminating such interests, has been approved by the Commission.

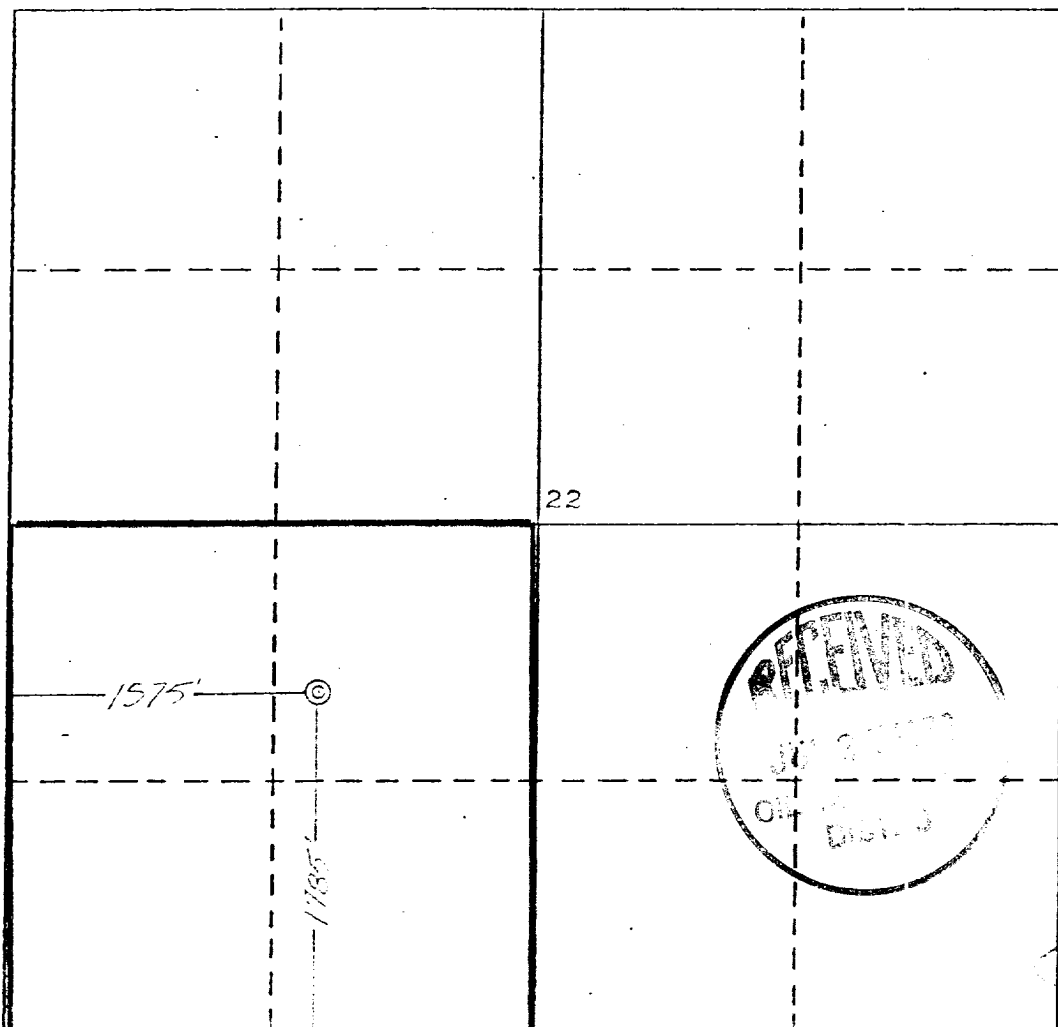

CERTIFICATION

I hereby certify that the information contained herein is true and complete to the best of my knowledge and belief.

**Rudy D. Motto**

Name  
*Rudy D. Motto*  
Position  
**Area Superintendent**

Company  
**SUPRON ENERGY CORPORATION**

Date  
**July 13, 1979**

I hereby certify that the location shown on this plat was plotted from field notes of actual surveys made by me or under my supervision and that the same is true and correct to the best of my knowledge and belief.

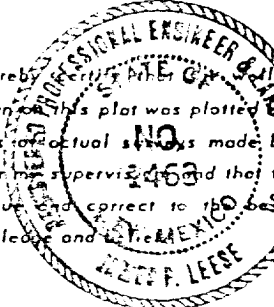

Date Surveyed  
**12 July 1979**

Registered Professional Engineer  
and/or Land Surveyor  
*James P. Leece*  
**James P. Leece**

Certificate No.  
**1463**

United States Geological Survey  
P. O. Box 959  
Farmington, New Mexico 87401

Attention: Mr. P. T. McGrath

Dear Sir:

Supron Energy Corporation proposes to drill the Helms Federal No. 2 well located 1785 feet from the South line and 1575 feet from the West line, Section 22, Township 30 North, Range 10 West, N.M.P.M., San Juan County, New Mexico.

The following attachments are included with this application:

1. Map of existing roads.
2. Planned access road which is approximately 2800 feet in length.
3. Location of existing wells.
4. Lateral roads to well locations.
5. Location of surface equipment, if required.
6. Drilling and completion water will be obtained from the Animas River.
7. Waste will be disposed of by being placed in the reserve pit and buried upon completion of the well.
8. There will be no camp at or near the well site.
9. There will be no air strip.
10. A plat is attached showing the location of the rig, mud pits, reserve pit, burn pit, etc.
11. A letter of Certification is attached and the operators representative is Rudy D. Motto, Area Superintendent, P. O. Box 808, Farmington, New Mexico 87401, Phone (505) 325-3587.
12. After the well is completed the location will be cleaned up and bladed. The reserve pit will be fenced on three sides when the location is built. After the well is drilled the pit will be fenced off until it has dried and then the pit will be filled and restored to its natural state.
13. The soil is sandy clayey loam with the principal vegetation being winterfat, galleta and grama grass.

HELMS FEDERAL NO. 2

SUPPLEMENT TO FORM 9-331C

1. The Geologic name of the surface formation is, "Wasatch".
2. The estimated tops of important Geologic markers are:
  - A. Base of Ojo Alamo 1990 Ft.
  - B. Top of Fruitland 2460 Ft.
  - C. Top of Pictured Cliffs 1990 Ft.
3. The estimated depths at which anticipated water, oil, gas or other mineral bearing formations are expected to be encountered are:
  - A. Base of Ojo Alamo 1990 Ft. - Water
  - B. Top of Fruitland 2460 Ft. - Water
  - C. Top of Pictured Cliffs 2745 Ft. - Gas
4. The casing program is shown on Form 9-331C and all casing is new.
5. The lessee's pressure control equipment schematics are attached along with minimum specifications, testing procedures and frequencies.
6. The type, estimated volumes and characteristics of the circulating mediums are as follows:
  - A. From 0 Ft. to 250 Ft. - Natural Mud.
  - B. From 250 feet to 2950 feet -Permaloid non dispersed mud containing 167 sx of gel. 67 sx of permaloid and 10 sx of C.M.C.
7. The auxiliary equipment to be used will be floats at the bit and a sub on the floor with a full opening valve to be stabbed into the drill pipe when the Kelly is not in the string.
8. This well is in an area which is almost completely developed, therefore we will not have a testing and coring program. The logging program is as follows:
  - A. E. S. Induction
  - B. GammaRay Density
  - C. Gamma Ray Correlation
  - D. Cement Bond or Temperature log
9. There are no abnormal pressures, temperatures, or hydrogen sulfide problems expected in this highly developed area.
10. The anticipated starting date of this well is September 1, 1979.

Supron Energy Corporation  
HELMS FEDERAL #2  
NE $\frac{1}{4}$  SW $\frac{1}{4}$  Sec.22, T30N, R10W,  
NMPM, San Juan County, N.M.  
1785 F/SL - 1575 F/WL  
Elevation - 6271

SUPRON ENERGY CORPORATION  
LOCATION AND EQUIPMENT LAYOUT

HEIMS FEDERAL NO. 2

1785 Feet from the South line and 1575 feet from the West line of Section 22, Township 30 North, Range 10 West, N.M.P.M., San Juan County, New Mexico.

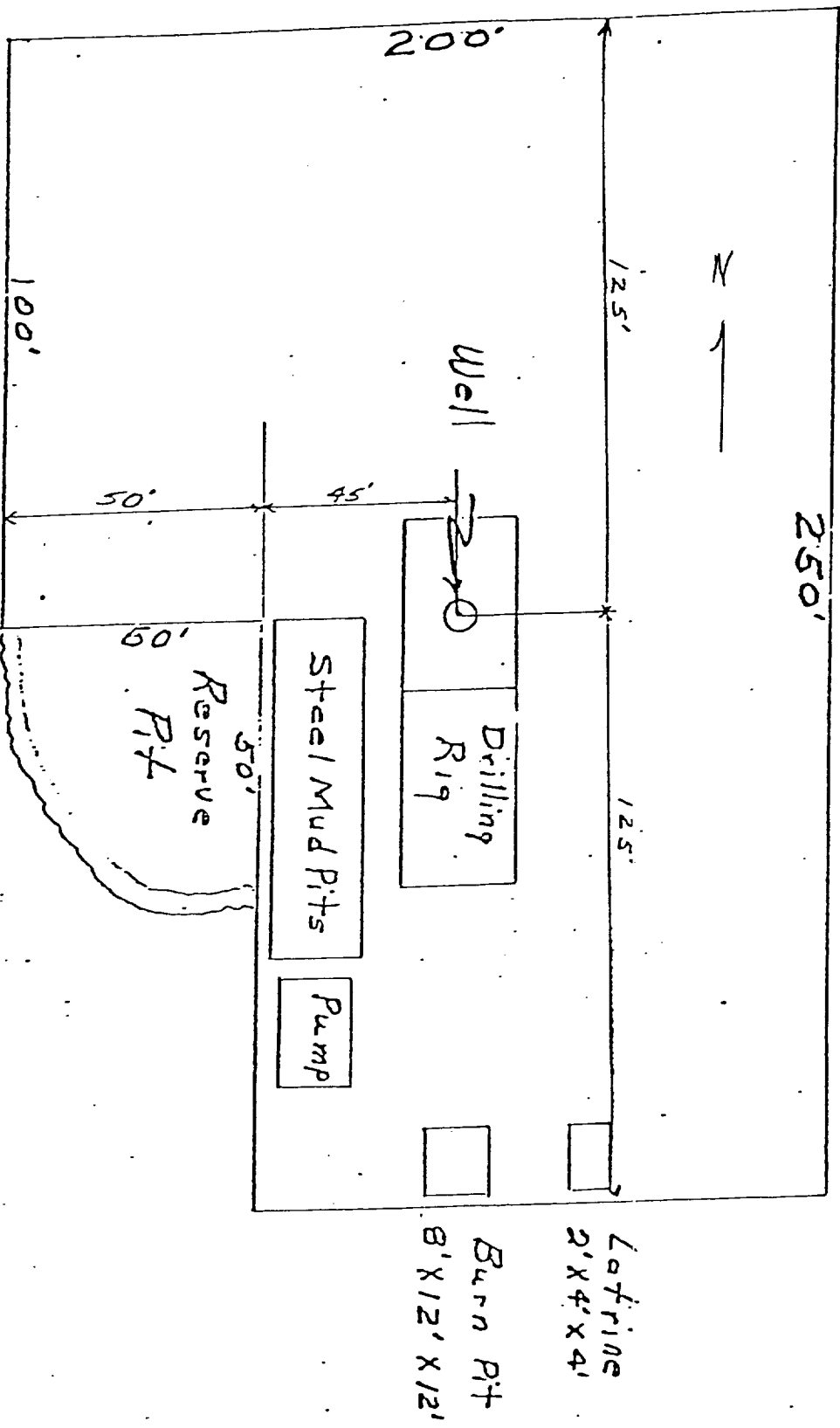

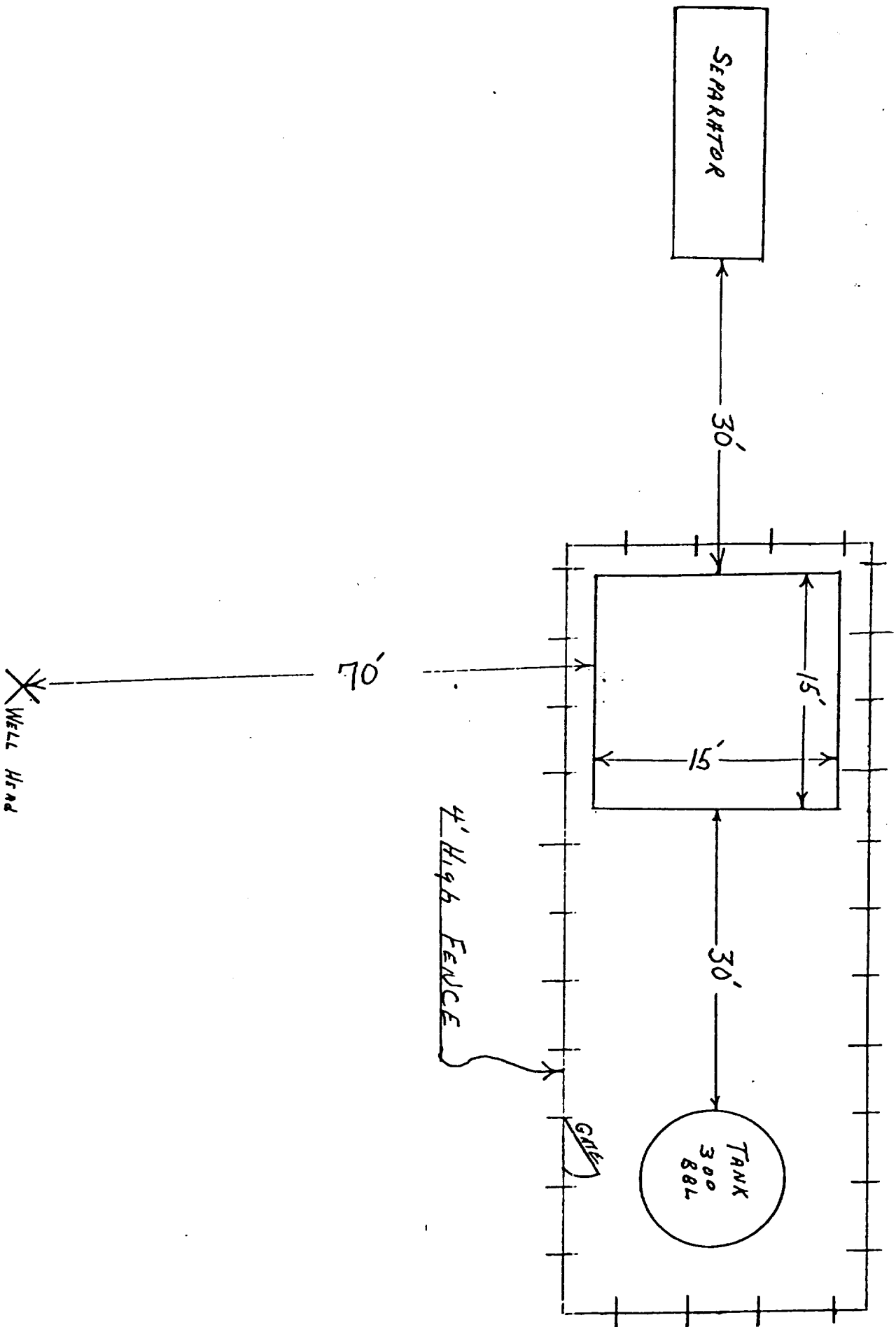



Blowout Preventer will be tested daily and prior to drilling out with the results to be logged on the drillers report.

The B.O.P. and all valve and fittings are rated at 3000 psi working pressure, and hydraulically operated

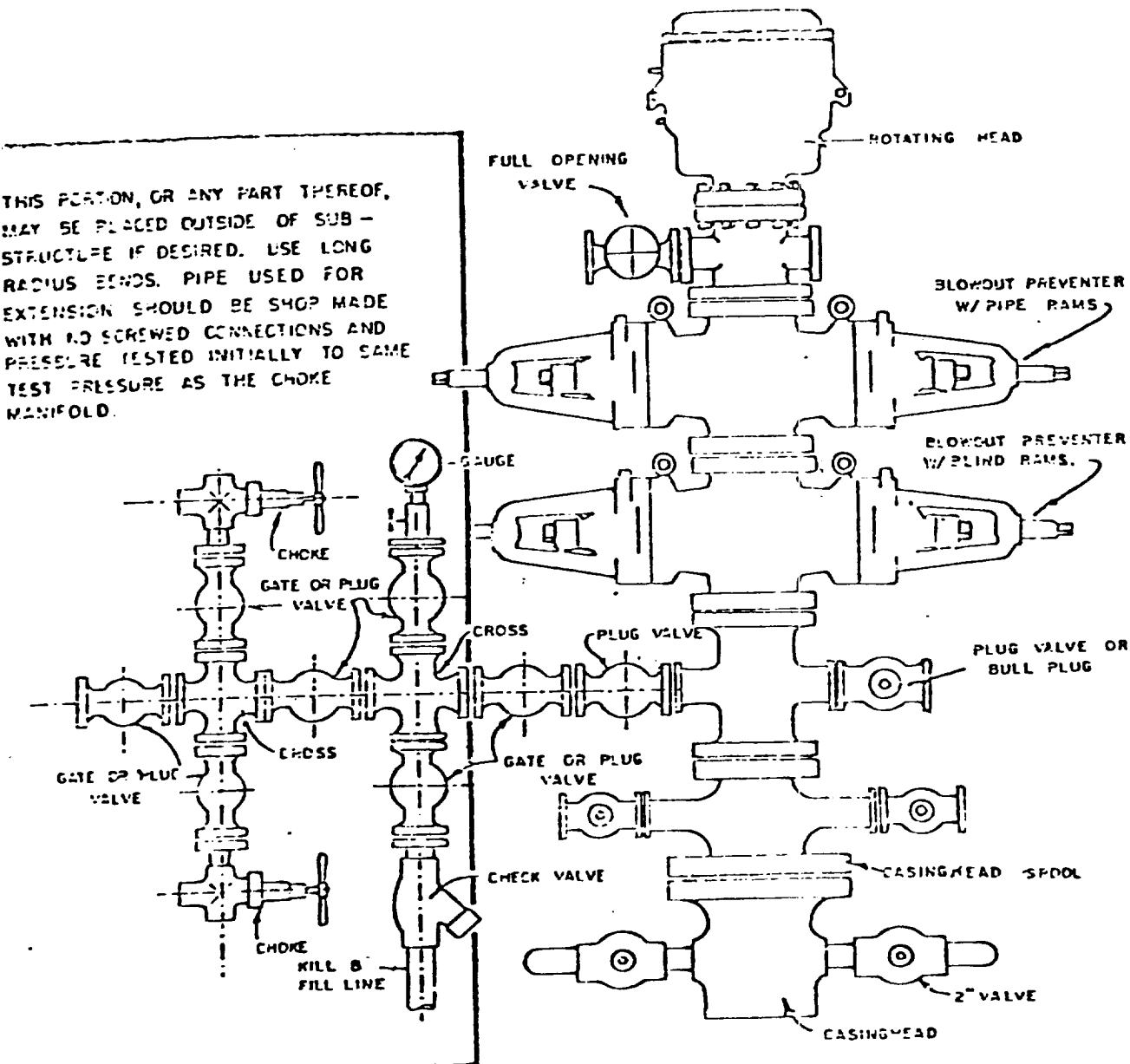

BLOWOUT PREVENTER HOOKUP

SUPRON ENERGY CORPORATION

POST OFFICE BOX 808

FARMINGTON, NEW MEXICO 87401

I hereby certify that I, or persons under my direct supervision, have inspected the proposed drillsite and access route; that I am familiar with the conditions which presently exist; that the statements made in this plan are, to the best of my knowledge, true and correct; and, that the work associated with the operations proposed herein will be performed by SUPRON ENERGY CORPORATION and its contractors subcontractors in conformity with this plan and the terms and conditions under which it is approved.

SUPRON ENERGY CORPORATION

A handwritten signature in black ink, appearing to read "Rudy D. Motto". The signature is fluid and cursive, with a large initial "R" and "M".

Rudy D. Motto  
Area Superintendent  
Phone: 325-3587