

NEW MEXICO OIL CONSERVATION COMMISSION
WELL LOCATION AND ACREAGE DEDICATION PLAT

Form C-102
Supersedes C-128
Effective 1-1-65

All distances must be from the outer boundaries of the Section.

Operator C & E OPERATORS, INC.		Lease AZTEC		Well No. 9.
Unit Letter M	Section 9	Township 30 NORTH	Range 11 WEST	County SAN JUAN
Actual Footage Location of Wells 1095 feet from the SOUTH line and 1140 feet from the WEST line				
Ground Level Elev. 5600	Producing Formation Fruitland	Pool Farmer Fruitland Extension	Dedicated Acreage 158.54 Acres	

1. Outline the acreage dedicated to the subject well by colored pencil or hachure marks on the plat below.
2. If more than one lease is dedicated to the well, outline each and identify the ownership thereof (both as to working interest and royalty).
3. If more than one lease of different ownership is dedicated to the well, have the interests of all owners been consolidated by communitization, unitization, force-pooling, etc?

☐ Yes ☐ No If answer is "yes," type of consolidation _____

If answer is "no," list the owners and tract descriptions which have actually been consolidated. (Use reverse side of this form if necessary.) _____

No allowable will be assigned to the well until all interests have been consolidated (by communitization, unitization, forced-pooling, or otherwise) or until a non-standard unit, eliminating such interests, has been approved by the Commission.

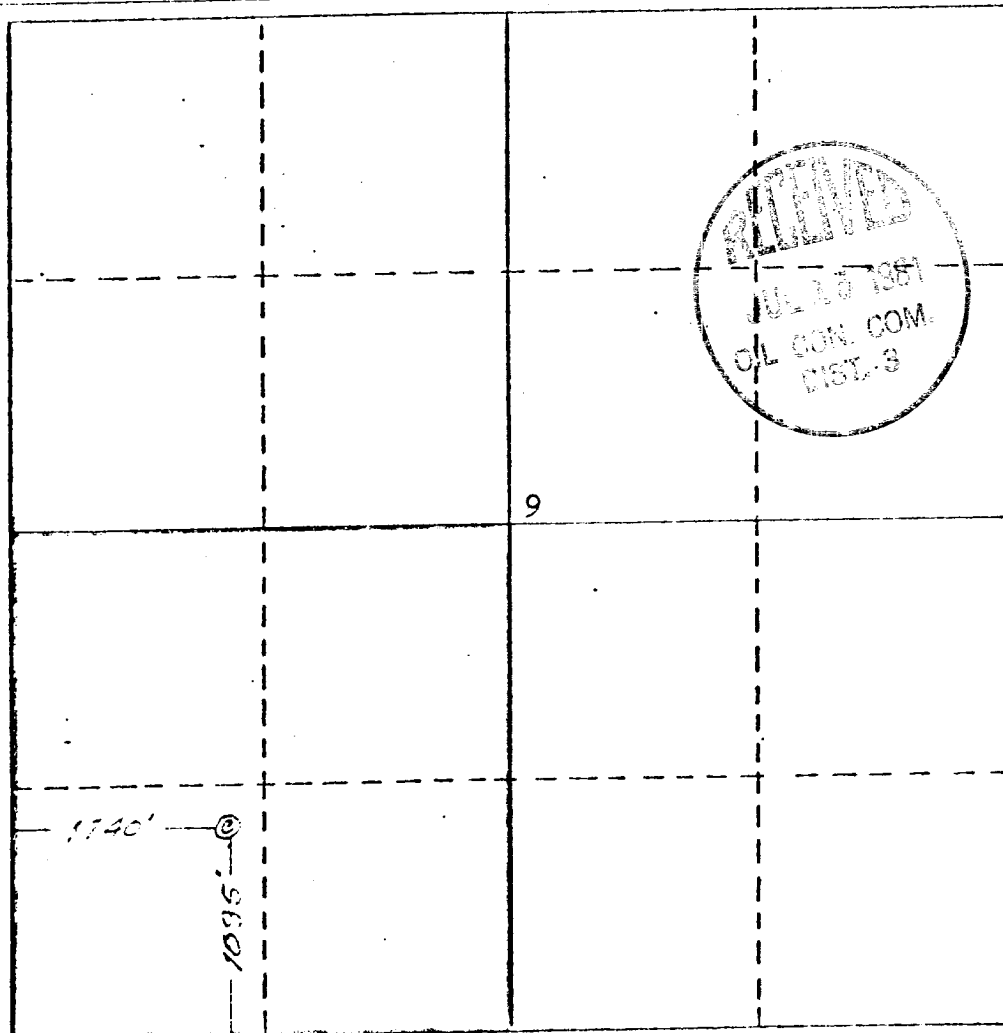

CERTIFICATION

I hereby certify that the information contained herein is true and complete to the best of my knowledge and belief.

L. R. Cunningham
Name

L. R. Cunningham

Position

Agent

Company

C & E Operators, Inc.

Date

7/14/81

I hereby certify that the information shown on this plat was plotted from field notes and actual surveys made by me or under my supervision and that the same is true and correct to the best of my knowledge and belief.

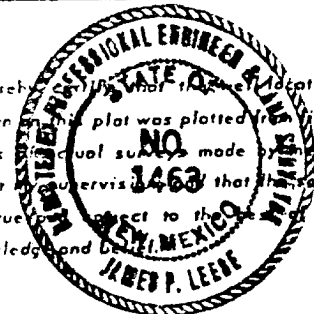

Date Surveyed

August 18, 1980

Registered Professional Engineer
and/or Land Surveyor

James P. Leese
James P. Leese

Certificate No.

1463

