

District I
P. O. Box 1980, Hobbs, NM

District II
P. O. Drawer DD, Artesia, NM 88221

District III
1000 Rio Brazos Rd, Aztec, NM 87410

State of New Mexico
Energy, Minerals and Natural Resources Department

OIL CONSERVATION DIVISION

2040 South Pacheco Street
Santa Fe, New Mexico 87505

*Risk
back*

SUBMIT 1 COPY TO
APPROPRIATE
DISTRICT OFFICE
AND 1 COPY TO
SANTA FE OFFICE

RECEIVED
NOV - 1 1999

OIL CON. DIV.
DIST. 3

PIT REMEDIATION AND CLOSURE REPORT

Operator: PNM Gas Services (Burlington) Telephone: 324-3764

Address: 603 W. Elm Street Farmington, NM 87401

Facility or Well Name: Grenier A #4E

Location: Unit F Sec 26 T 30N R 10W County San Juan

Pit Type: Separator Dehydrator Other _____

Land Type: BLM State Fee Other _____

Pit Location: Pit dimensions: length 12 width 12 depth 2

(Attach diagram) Reference: wellhead other _____

Footage from reference: 75'

Direction from reference: 75 Degrees East North
of West South

Depth to Ground Water:	Less than 50 feet	(20 points)	
	50 feet to 99 feet	(10 points)	
	Greater than 100 feet	(0 points)	<u>10</u>

(Vertical distance from contaminants to seasonal high water elevation of ground water)

Wellhead Protection Area:	Yes	(20 points)	
	No	(0 points)	<u>0</u>

(Less than 200 feet from a private domestic water source, or; less than 1,000 feet from all other water sources)

Distance to Surface Water:	Less than 200 feet	(20 points)	
	200 feet to 1,000 feet	(10 points)	
	Greater than 1,000 feet	(0 points)	<u>0</u>

(Horizontal distance to perennial lakes, ponds, rivers, streams, creeks, irrigation canals and ditches)

RANKING SCORE (TOTAL POINTS): 10

Grenier A #4E

Date Remediation Started: 07/07/1999 Date Completed: 07/07/1999

Remediation Method: Excavation X Approx. Cubic Yard 75

(Check all appropriate sections)

Landfarmed X Amount Landfarmed (cubic yds) 60

Other 15 cu yds overburden

Remediation Location: Onsite _____ Offsite _____
(i.e., landfarmed onsite, name and location of offsite facility)

Backfill Material Location: _____

General Description of Remedial Action:

Excavated contaminated soil to a pit size of 13' X 15.5' X 10' and landfarmed soil onsite within a bermed area at a depth of 6" to 12". Soil was aerated by disking/plowing until soil met regulatory levels.

*** Sandstone encountered at 10'. See attached risk analysis form.

Ground Water Encountered: No Yes Depth _____

Final Pit Closure Sampling:

(if multiple samples, attach sample result and diagram of sample locations and depths.)

Sample Location 5 pt. composite - bottom.

Sample depth 10'

Sample date 07/07/1999 Sample time 1:15:00 PM

Sample Results

Benzene (ppm) < 0.5

Total BTEX (ppm) 129.8 ***

Field headspace (ppm) _____

TPH (ppm) 1100.00 *** Method 8015B

Vertical Extent (ft) _____ Risk Analysis form attached Yes No

Ground Water Sample: Yes No (If yes, see attached Groundwater Site Summary Report)

I HEREBY CERTIFY THAT THE INFORMATION ABOVE IS TRUE AND COMPLETE TO THE BEST OF MY KNOWLEDGE AND MY BELIEF

DATE October 28, 1999

SIGNATURE

Maureen Gannon
Lynne K. Fisher

PRINTED NAME **Maureen Gannon**
AND TITLE **Project Manager**

Premier A4E
 (F) 26-300-10W
 Burlington
 7-7-99 @ 1200

↑
 N

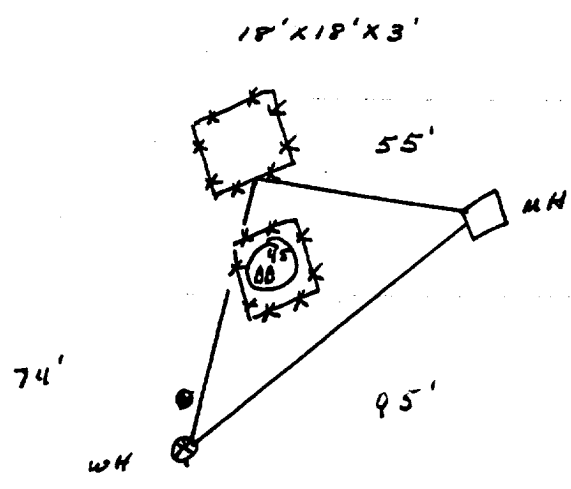
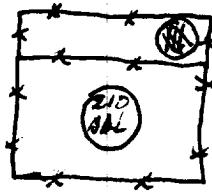

Excavation Sampling

13'(N+S) x 15.5'(E+W) x 10' @

PID Readings

5' - 1460 ppm
 10' - 2999 ppm

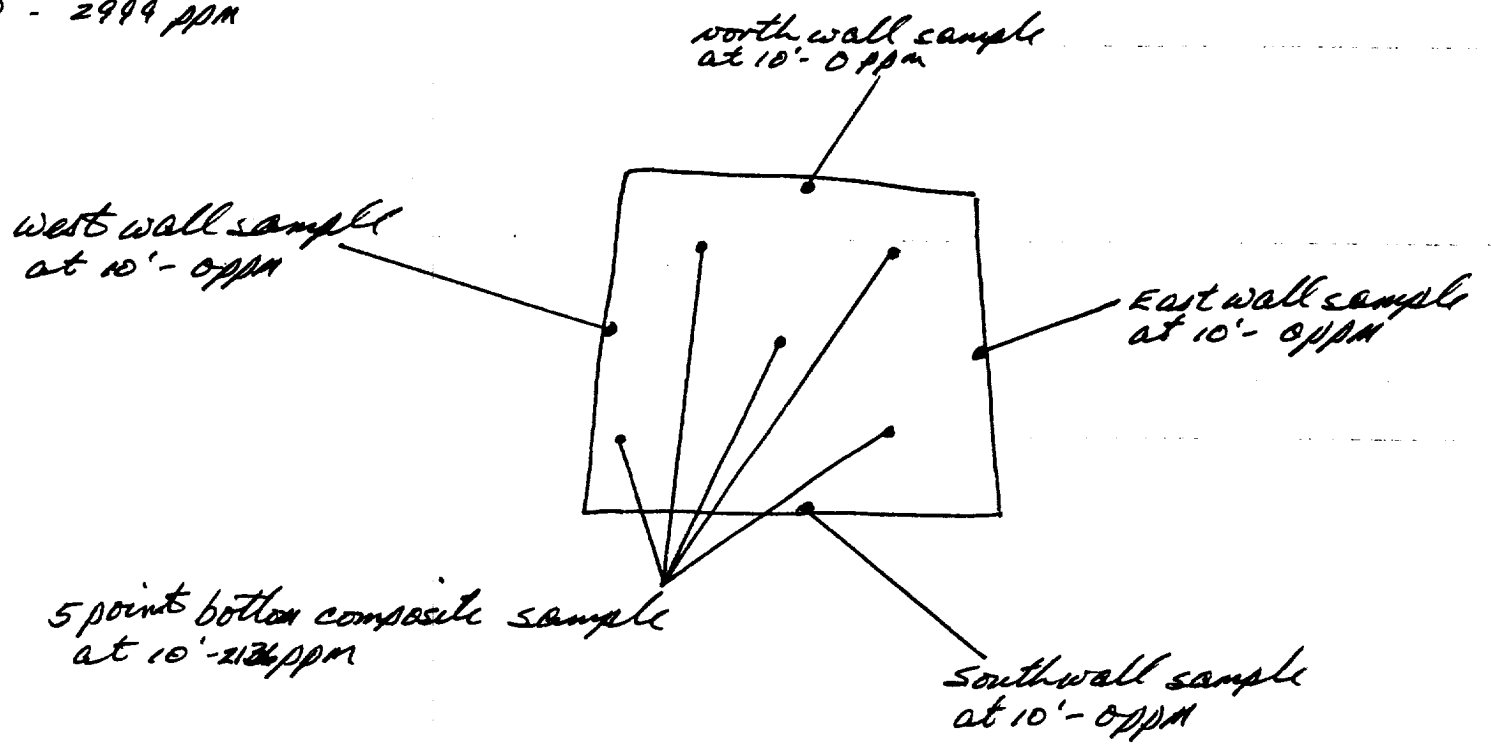

Field headspace: ○ (walks)

not to scale

OFF: (505) 325-5667



LAB: (505) 325-1556

On Site Technologies, LTD.

Date: 22-Jul-99

CLIENT: PNM - Public Service Company of NM

Project: PNM Pit Remediation

Lab Order: 9907014

CASE NARRATIVE

Samples were analyzed using the methods outlined in the following references:

Test Methods for Evaluating Solid Waste, Physical/Chemical Methods, SW846, 3rd Edition

All method blanks, laboratory spikes, and/or matrix spikes met quality assurance objectives.

KAY

OFF: (505) 325-5667

LAB: (505) 325-1556



ANALYTICAL REPORT

Date: 22-Jul-99

Client:	PNM - Public Service Company of NM	Client Sample Info:	Grenier A4E
Work Order:	9907014	Client Sample ID:	9907071315; 5pt Bottom Comp
Lab ID:	9907014-05A	Matrix:	SOIL
Project:	PNM Pit Remediation	Collection Date:	7/7/99 1:15:00 PM
		COC Record:	7645

Parameter	Result	PQL	Qual	Units	DF	Date Analyzed
DIESEL RANGE ORGANICS						
T/R Hydrocarbons: C10-C28	1100	25		mg/Kg	1	7/20/99
						Analyst: DC
AROMATIC VOLATILES BY GC/PID						
Benzene	ND	500		µg/Kg	500	7/12/99
Toluene	4300	1000		µg/Kg	500	7/12/99
Ethylbenzene	4500	500		µg/Kg	500	7/12/99
m,p-Xylene	98000	1000		µg/Kg	500	7/12/99
o-Xylene	23000	500		µg/Kg	500	7/12/99

129800
129.80ppm

Qualifiers:

- PQL - Practical Quantitation Limit
- ND - Not Detected at Practical Quantitation Limit
- J - Analyte detected below Practical Quantitation Limit
- B - Analyte detected in the associated Method Blank
- S - Spike Recovery outside accepted recovery limits
- R - RPD outside accepted recovery limits
- E - Value above quantitation range
- Surr: - Surrogate

OFF: (505) 325-5667



LAB: (505) 325-1556

ANALYTICAL REPORT

Date: 22-Jul-99

Client:	PNM - Public Service Company of NM	Client Sample Info:	Grenier A4E
Work Order:	9907014	Client Sample ID:	9907071320; 4 Wall Comp
Lab ID:	9907014-06A	Matrix:	SOIL
Project:	PNM Pit Remediation	Collection Date:	7/7/99 1:20:00 PM
		COC Record:	7645

Parameter	Result	PQL	Qual	Units	DF	Date Analyzed
DIESEL RANGE ORGANICS		SW8015B				Analyst: DC
T/R Hydrocarbons: C10-C28	66	25		mg/Kg	1	7/20/99

Qualifiers:

PQL - Practical Quantitation Limit	S - Spike Recovery outside accepted recovery limits
ND - Not Detected at Practical Quantitation Limit	R - RPD outside accepted recovery limits
J - Analyte detected below Practical Quantitation Limit	E - Value above quantitation range
B - Analyte detected in the associated Method Blank	Surr: - Surrogate

Orrenier 11-70
Sec. 26 T30N R10W Unit F
Burlington

Landfarm Drawing

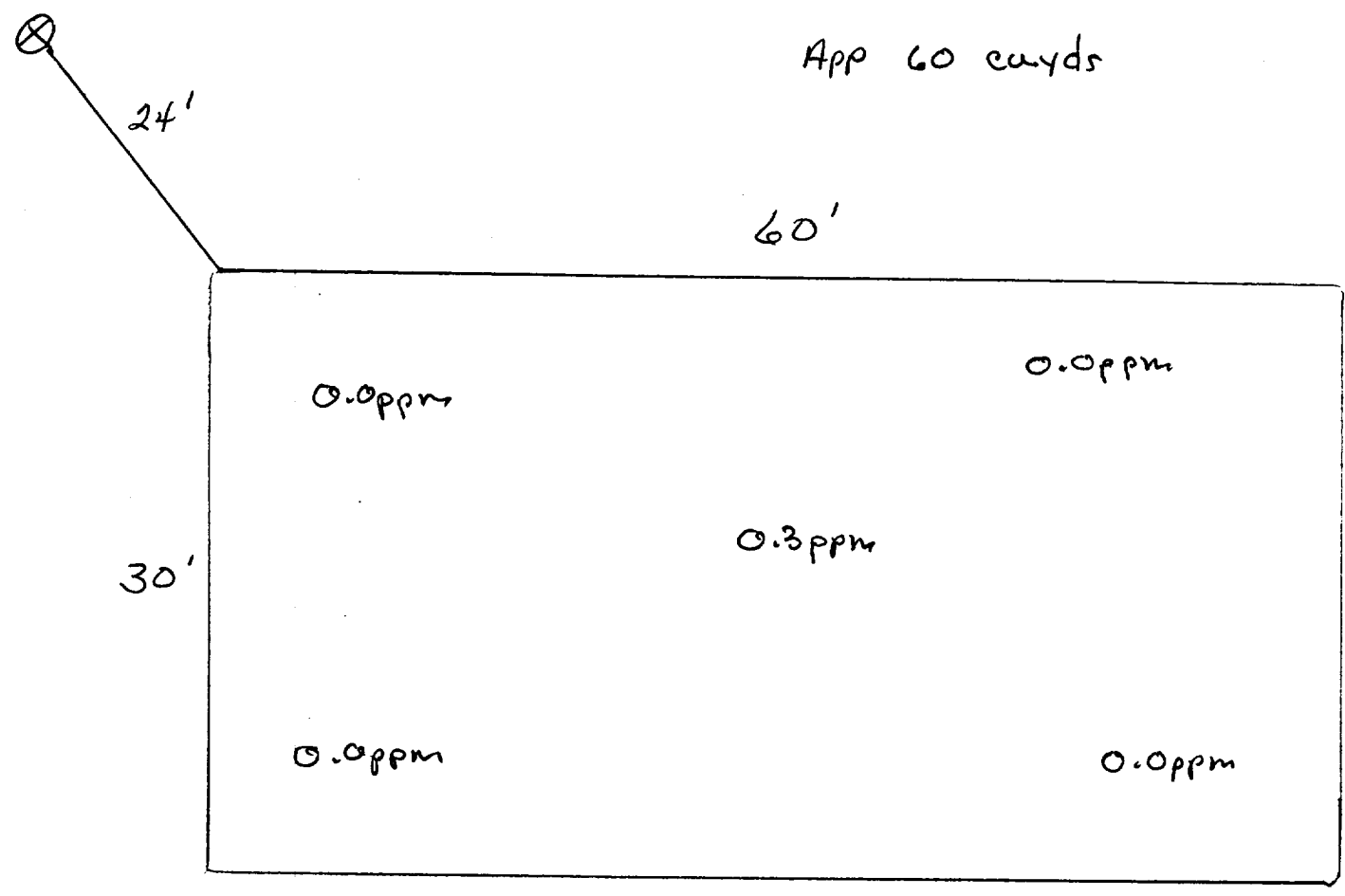

2" to 2" Depth
Headspace 9.8ppm
sample# 9907141425

Not to scale

OFF: (505) 325-5667



LAB: (505) 325-1556

On Site Technologies, LTD.

Date: 30-Jul-99

CLIENT: PNM - Public Service Company of NM
Project: PNM Pit Remediation Landfarms
Lab Order: 9907036

CASE NARRATIVE

Samples were analyzed using the methods outlined in the following references:

Test Methods for Evaluating Solid Waste, Physical/Chemical Methods, SW846, 3rd Edition

All method blanks, laboratory spikes, and/or matrix spikes met quality assurance objectives.

OFF: (505) 325-5667



LAB: (505) 325-1556

ANALYTICAL REPORT

Date: 30-Jul-99

Client:	PNM - Public Service Company of NM	Client Sample Info:	Grenier A-4E LF
Work Order:	9907036	Client Sample ID:	9907141425; 5pt Comp
Lab ID:	9907036-05A	Matrix:	SOIL
Project:	PNM Pit Remediation Landfarms	Collection Date:	7/14/99 2:25:00 PM
		COC Record:	7491

Parameter	Result	PQL	Qual	Units	DF	Date Analyzed
DIESEL RANGE ORGANICS		SW8015B				Analyst: DC
T/R Hydrocarbons: C10-C28	ND	25		mg/Kg	1	7/29/99

Qualifiers:

- PQL - Practical Quantitation Limit
- ND - Not Detected at Practical Quantitation Limit
- J - Analyte detected below Practical Quantitation Limit
- B - Analyte detected in the associated Method Blank
- S - Spike Recovery outside accepted recovery limits
- R - RPD outside accepted recovery limits
- E - Value above quantitation range
- Surr: - Surrogate

P.O. BOX 2606 • FARMINGTON, NM 87499



Environmental Services

Well Name:	Grenier A #4E
Well Legals:	Sec 26, T30N, R10W, Unit F
Pit Type:	Dehydrator
Horizontal Distance to Surface Water:	Greater than 1,000 feet
Groundwater Depth:	50 feet to 99 feet

RISK ANALYSIS

PNM requests closure of their former pit on the Grenier A #4E well site using a limited risk analysis based on the following conditions:

1. Groundwater is estimated to be at a depth of 52 feet based upon the elevation of the site and the elevation of the nearest "listed" or "named" wash. (Reference: Turley, NM series 7.5 minute topographic map.)
2. PNM excavated 75 cubic yards of soil from the former pit. Subsurface lateral contamination has been remediated (see attached map and analytical results for the side wall profiles). Source removal minimizes the possibility of surface water contamination.
3. Sandstone was encountered at 10 feet below ground surface. Bedrock/sandstone provides a barrier between remaining contamination and groundwater. Vertical migration through bedrock or sandstone to groundwater is unlikely.
4. PNM excavated and performed remediation to the maximum depth and horizontal extent practicable.

PNM believes that their former pit on the Grenier A #4E well site poses minimal threat to groundwater, human health and the environment based upon our past experience in excavating over 1,000 pits.