

Amended Location

No longer NSL

donot hold C104

Operator Amoco Production Company			Lease Carson Gas Com		Well No. 1E
Unit Letter F	Section 32	Township 30N	Range 12W	County San Juan	
Actual Footage Location of Well: 1470 feet from the North line and 1460 feet from the West line					
Ground Level Elev. 5445	Producing Formation Dakota		Pool Basin Dakota		Dedicated Acreage: W 320 Acres

1. Outline the acreage dedicated to the subject well by colored pencil or hachure marks on the plat below.
2. If more than one lease is dedicated to the well, outline each and identify the ownership thereof (both as to working interest and royalty).
3. If more than one lease of different ownership is dedicated to the well, have the interests of all owners been consolidated by communitization, unitization, force-pooling, etc?

☒ Yes ☐ No If answer is "yes," type of consolidation Communitization

If answer is "no," list the owners and tract descriptions which have actually been consolidated. (Use reverse side of this form if necessary.)

No allowable will be assigned to the well until all interests have been consolidated (by communitization, unitization, forced-pooling, or otherwise) or until a non-standard unit, eliminating such interests, has been approved by the Commission.

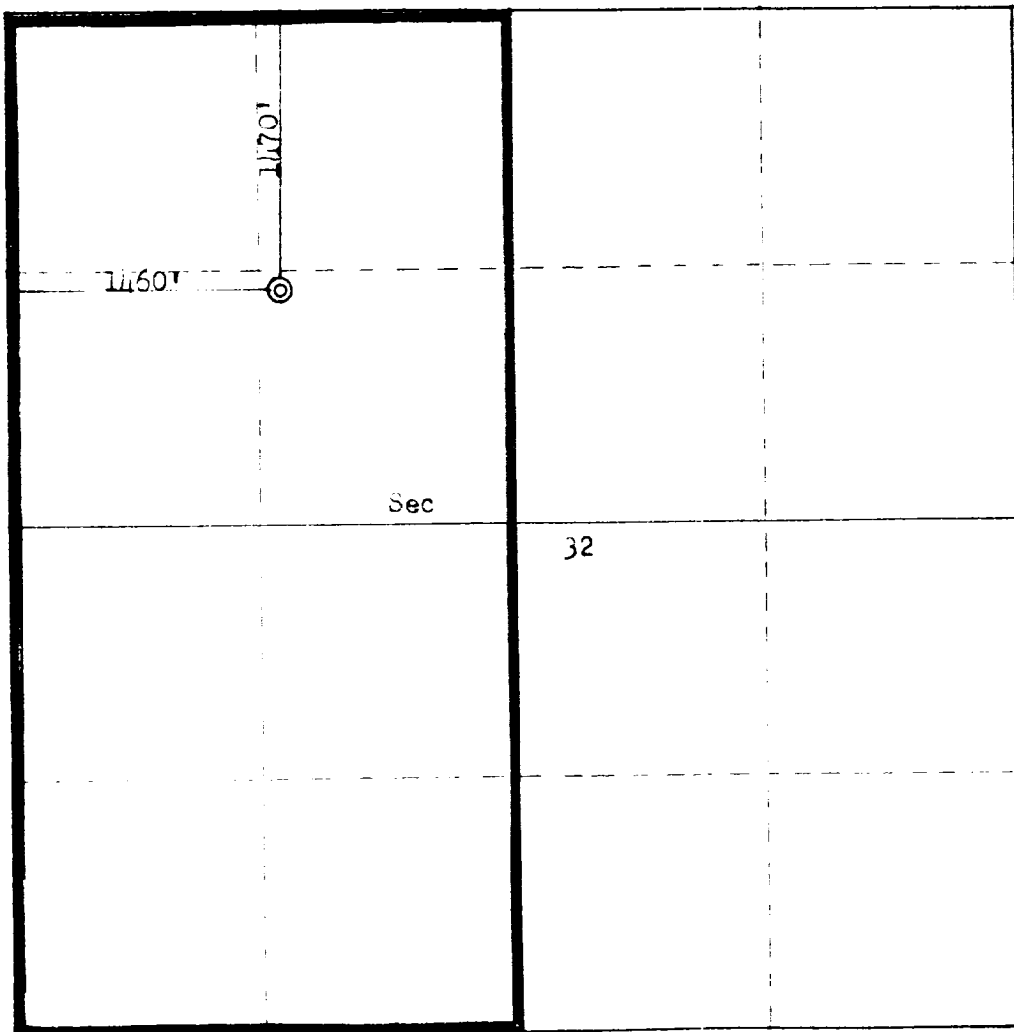

CERTIFICATION

I hereby certify that the information contained herein is true and complete to the best of my knowledge and belief.

D. E. Shoemaker

Name
D. E. Shoemaker

Position
District Engineer

Company
Amoco Production Company

Date
December 2, 1982

I hereby certify that the well location shown on this plat was plotted from field notes of actual surveys made by me or under my supervision, and that the same is true and correct to the best of my knowledge and belief.

Date Surveyed
September 7, 1982

Registered Professional Engineer
and Land Surveyor

Fred B. Kerr Jr.
Fred B. Kerr Jr.

Certificate No.

3950

Scale: 1"=1000'