

| | |
|------------------------|--|
| NO. OF COPIES RECEIVED | |
| DISTRIBUTION | |
| SANTA FE | |
| FILE | |
| J.S.G.S. | |
| LAND OFFICE | |
| OPERATOR | |

NEW MEXICO OIL CONSERVATION COMMISSION

30-045-25910

Form C-101
Revised 1-1-65

8-29-84
APPROVAL EXPIRES
UNLESS DRILLING IS COMMENCED.
SPUD NOTICE MUST BE SUBMITTED
WITHIN 10 DAYS.

RECEIVED
FEB 29 1984
OIL CON. DIV.
DIST. 3

| | |
|---|--|
| 5A. Indicate Type of Lease | |
| STATE <input type="checkbox"/> | FEED <input checked="" type="checkbox"/> |
| 5. State Oil & Gas Lease No. | |
| 7. Unit Agreement Name | |
| 8. Farm or Lease Name | |
| CLAYTON | |
| 9. Well No. | |
| 2 | |
| 10. Field and Pool, or Wildcat | |
| BLANCO MESA VERDE | |
| 12. County | |
| SAN JUAN | |
| 15. Proposed Depth | 19A. Formation |
| 4785' | BLANCO MESA VERDE |
| 20. Rotary or C.T. | ROTARY |
| 1. Elevations (Show whether DF, RT, etc.) | 21A. Kind & Status Plug. Bond |
| 5799' GL | BLANKENT/INFORCE |
| 21B. Drilling Contractor | 22. Approx. Date Work will start |
| N/A | APRIL |

APPLICATION FOR PERMIT TO DRILL, DEEPEN, OR PLUG BACK

1. Type of Work

2. Type of Well

DRILL ☒ DEEPEN ☐ PLUG BACK ☐

OIL WELL ☐ GAS WELL ☒ OTHER ☐

SINGLE ZONE ☒ MULTIPLE ZONE ☐

3. Name of Operator

CONSOLIDATED OIL & GAS, INC.

4. Address of Operator

P.O. BOX 2038, FARMINGTON, NEW MEXICO 87499

5. Location of Well

UNIT LETTER K LOCATED 1850 FEET FROM THE WEST LINE

1850 FEET FROM THE SOUTH LINE OF SEC. 2 TWP. 30N RGE. 12W NMPM

15. Proposed Depth

4785'

19A. Formation

BLANCO MESA VERDE

20. Rotary or C.T.

ROTARY

1. Elevations (Show whether DF, RT, etc.)

5799' GL

21A. Kind & Status Plug. Bond

BLANKENT/INFORCE

21B. Drilling Contractor

N/A

22. Approx. Date Work will start

APRIL

3. PROPOSED CASING AND CEMENT PROGRAM

| SIZE OF HOLE | SIZE OF CASING | WEIGHT PER FOOT | SETTING DEPTH | SACKS OF CEMENT | EST. TOP |
|--------------|----------------|-----------------|---------------|-----------------|-----------------|
| 12 1/4 | 8 5/8 | 24.00 | 250 | 200 sx | Circ to surf |
| 7 7/8 | 4 1/2 | 10.5 | 4785 | 500 sx | Cover Ojo Alamo |

- 1.) Drill 12 1/4" hole to 250' set 8 5/8 csg, circ cmt to surface
- 2.) WDC 12 hrs.
- 3.) NU BOP'S Pressure test surface casing & BOP'S to 1000 psi.
- 4.) Drill 7 7/8" hole to \pm 4785' w/ fresh water gel mud. Run logs.
- 5.) Run 5 1/2" casing and cement same w/approximately 500 sx. Exact cmt volume will be calculated from logs.
- 6.) Selectively perforate & stimulate the Mesa Verde formation and complete as required by applicable rules & regulations.

RECEIVED
FEB 22 1984
OIL CON. DIV.
DIST. 3

IN ABOVE SPACE DESCRIBE PROPOSED PROGRAM: IF PROPOSAL IS TO DEEPEN OR PLUG BACK, GIVE DATA ON PRESENT PRODUCTIVE ZONE AND PROPOSED NEW PRODUCTIVE ZONE. GIVE FLOWOUT PREVENTER PROGRAM, IF ANY.

I hereby certify that the information above is true and complete to the best of my knowledge and belief.

Signed [Signature] Title DRILLING FOREMAN Date 2-20-84

(This space for State Use)

APPROVED BY [Signature] TITLE SUPERVISOR DISTRICT #3 DATE FEB 29 1984

CONDITIONS OF APPROVAL, IF ANY:

All distances must be from the outer boundaries of the Section.

| | | | | |
|---|--|----------------------------------|--|----------------------------------|
| Operator Consolidated Oil and Gas | | Lease Clayton | | Well No. Clayton No. 2 |
| Unit Letter 3 | Section 2 | Township T30N | Range R12W | County San Juan |
| Actual Footage Location of Well: | | | | |
| 1850 | feet from the South | line and | 1850 | feet from the West |
| Ground Level Elev. 5799 | Producing Formation Mesa Verde | Pool Blanco Mesa Verde | Dedicated Acreage: 320 Acres | |

1. Outline the acreage dedicated to the subject well by colored pencil or hatchure marks on the plat below.
2. If more than one lease is dedicated to the well, outline each and identify the ownership thereof (both as to working interest and royalty).
3. If more than one lease of different ownership is dedicated to the well, have the interests of all owners been consolidated by communitization, unitization, force pooling, etc?

☐ Yes ☐ No If answer is "yes," type of consolidation _____

If answer is "no," list the owners and tract descriptions which have actually been consolidated. (Use reverse side of this form if necessary.) _____

No allowable will be assigned to the well until all interests have been consolidated (by communitization, unitization, forced-pooling, or otherwise) or until a non-standard unit, eliminating such interests, has been approved by the Division.

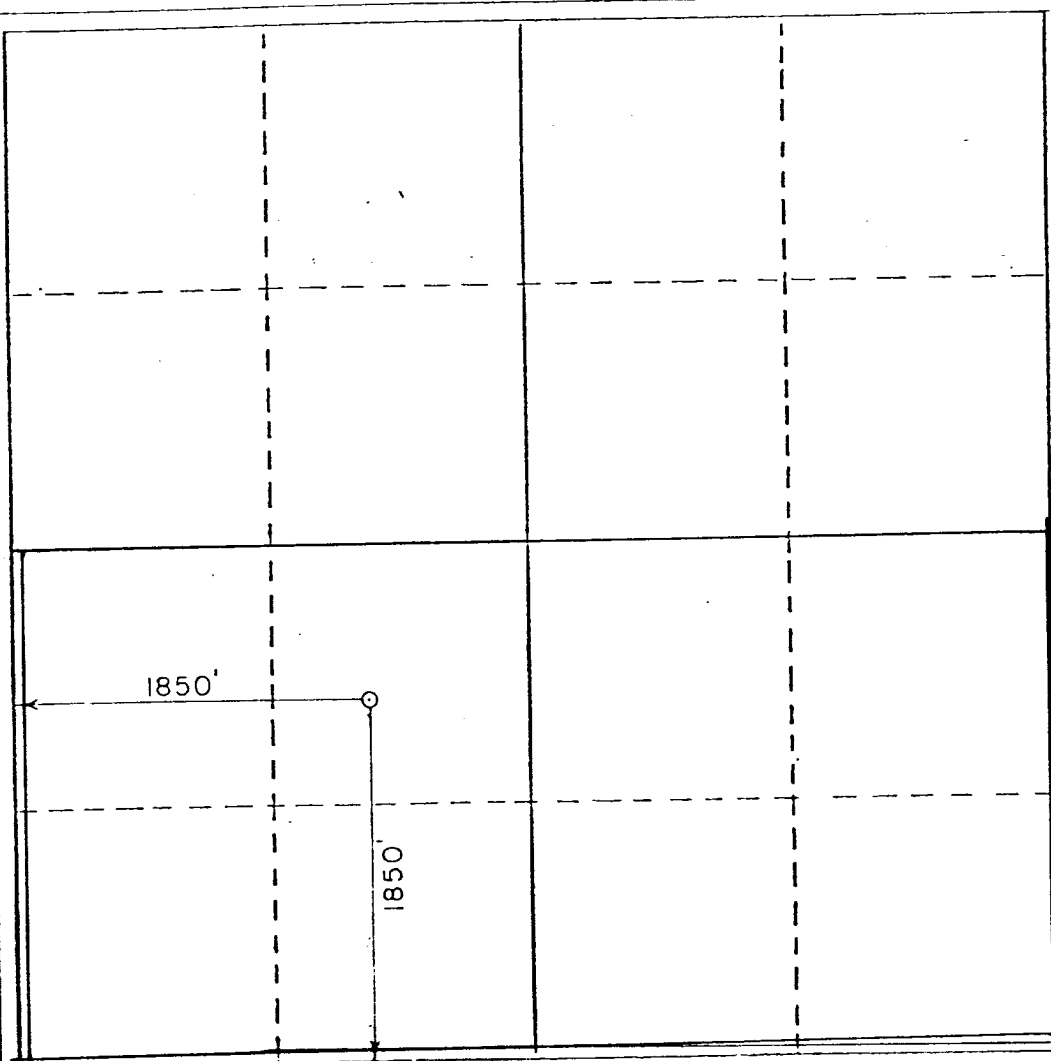

CERTIFICATION

I hereby certify that the information contained herein is true and complete to the best of my knowledge and belief.

Barney L. Jones
Name

Barney L. Jones

Position

Drilling Foreman

Company

Consolidated Oil & Gas

Date

2-20-84

I hereby certify that the well location shown on this plat was plotted from field notes of actual surveys made by me or under my supervision, and that the same is true and correct to the best of my knowledge and belief.

George T. Walters
Date Surveyed **6159**

George T. Walters

Registered Professional Engineer and/or Land Surveyor
STATE OF NEW MEXICO

N.M. 6159

Certificate No.

C-201