

UNITED STATES
DEPARTMENT OF THE INTERIOR
BUREAU OF LAND MANAGEMENT

APPLICATION FOR PERMIT TO DRILL, DEEPEN, OR PLUG BACK

1a. TYPE OF WORK
DRILL ☒ — DEEPEN ☐ PLUG BACK ☐

b. TYPE OF WELL
OIL WELL ☐ GAS WELL ☒ OTHER ☐
SINGLE ZONE ☒ MULTIPLE ZONE ☐

2. NAME OF OPERATOR
Union Texas Petroleum

3. ADDRESS OF OPERATOR
375 U.S. Highway 64, Farmington New Mexico 87401

4. LOCATION OF WELL (Report location clearly and in accordance with any State requirements)
At surface 1149' FSL & 1176' FWL
Same as above
At proposed prod. zone

14. DISTANCE IN MILES AND DIRECTION FROM NEAREST TOWN OR POST OFFICE*
6 miles NW of Blanco, New Mexico

BUREAU OF LAND MANAGEMENT
FARMINGTON RESOURCE AREA

16. DISTANCE FROM PROPOSED*
LOCATION TO NEAREST
PROPERTY OR LEASE LINE, FT.
(Also to nearest dir. unit line, if any)
1149 from Lease
1149 from DU

18. NO. OF ACRES IN LEASE
475.60

17. NO. OF ACRES ASSIGNED
TO THIS WELL
S/2 316.76

19. DISTANCE FROM PROPOSED LOCATION*
TO NEAREST WELL, DRILLING, COMPLETED,
OR APPLIED FOR, ON THIS LEASE, FT.
100

19. PROPOSED DEPTH
5100'

20. ROTARY OR CABLE TOOLS
Rotary

21. ELEVATIONS (Show whether DF, RT, GR, etc.)
5917' 6417' Ungraded

23. PROPOSED CASING AND CEMENTING PROGRAM

DRILLING OPERATIONS AUTHORIZED ARE
SUBJECT TO COMPLIANCE WITH ATTACHED

22. APPROX. DATE WORK WILL START*
August 1, 1986

This action is subject to technical and
procedural review pursuant to 43 CFR 3165.3
and appeal pursuant to 43 CFR 3165.4.
QUANTITY OF CEMENT

SIZE OF HOLE	SIZE OF CASING	WEIGHT PER FOOT	SETTING DEPTH	QUANTITY OF CEMENT
13-3/4"	9-5/8"	32.3	300'	270 sx (318 cu.ft.)
8-3/4"	7"	23	2700'	360 sx (591 cu.ft.)
6-1/4"	4-1/2" liner	10.5	2500' -5100'	310 sx (487 cu.ft.)

Union Texas Petroleum wishes to advise we intend to drill a 13-3/4" hole with mud to 300+ and set 9-5/8", 32.3#, H-40, ST&C csg. to 300' + cementing to surface with 270 sx (318 cu.ft.) CI "B" with 2% CaCl2 and 1/4# flocele/sk. Wait on cement for 12 hrs.

Nipple up test BOP. Drill 8-3/4" hole with mud out of surface to 2700+. Set 7", 23#, K-55, ST&C intermediate csg. to 2700+ cementing to the surface with 260 sx (473 cu.ft.) 65/35 POZ with 6% gel and 10# gilsonite/sk tailed by 100 sx (118 cu.ft.) CI "B" with 2% CaCl2.

Drill 6-1/4" hole, with natural gas, out of intermediate to a TD of 5100'. Log the well, run 4-1/2", 10.5#, K-55, ST&C liner from 2500+ to 5100'+. Cement liner into intermediate csg. with 310 sx (487 cu.ft.) 50/50 POZ with 4% gel and 6-1/4# gilsonite/sk.

Following perforation and treatment of the Mesaverde formation, standard production equipment will be installed.

IN ABOVE SPACE DESCRIBE PROPOSED PROGRAM: If proposal is to deepen or plug back, give data on present productive zone and proposed new productive zone. If proposal is to drill or deepen directionally, give pertinent data on subsurface locations and measured and true vertical depths. Give blowout preventer program, if any.

24.

SIGNED

Robert C. Frank

TITLE

Permit Coordinator

DATE

June 16, 1986

(This space for Federal or State office use)

PERMIT NO.

APPROVED DATE

RECEIVED
JUN 24 1986

APPROVED BY

TITLE

DATE

CONDITIONS OF APPROVAL, IF ANY:

NMOCC

OIL CON. DIV
DIST. 3

*See Instructions On Reverse Side

**NEW MEXICO OIL CONSERVATION COMMISSION
WELL LOCATION AND ACREAGE DEDICATION PLAT**

Supervisors C-1:
Effective 1-1-85

All distances must be from the outer boundaries of the Section.

Operator UNION TEXAS PETROLEUM CORPORATION			Lease SANCHEZ		Well No. 3A
Unit Letter M	Section 34	Township 30 NORTH	Range 10 WEST	County SAN JUAN	
Actual Footage Location of Wells					
1149 feet from the SOUTH line and		1176 feet from the WEST line			
Ground Level Elev. 5917	Producing Formation Mesaverde	Pool Blanco	Dedicated Acreage: 316.76 Acres		

1. Outline the acreage dedicated to the subject well by colored pencil or hachure marks on the plat below.
2. If more than one lease is dedicated to the well, outline each and identify the ownership thereof (both as to working interest and royalty).
3. If more than one lease of different ownership is dedicated to the well, have the interests of all owners been consolidated by communitization, unitization, force-pooling, etc?

☐ Yes ☐ No If answer is "yes," type of consolidation _____

If answer is "no," list the owners and tract descriptions which have actually been consolidated. (Use reverse side of this form if necessary.) _____

No allowable will be assigned to the well until all interests have been consolidated (by communitization, unitization, forced-pooling, or otherwise) or until a non-standard unit, eliminating such interests, has been approved by the Commission.

RECEIVED
JUN 24 1986

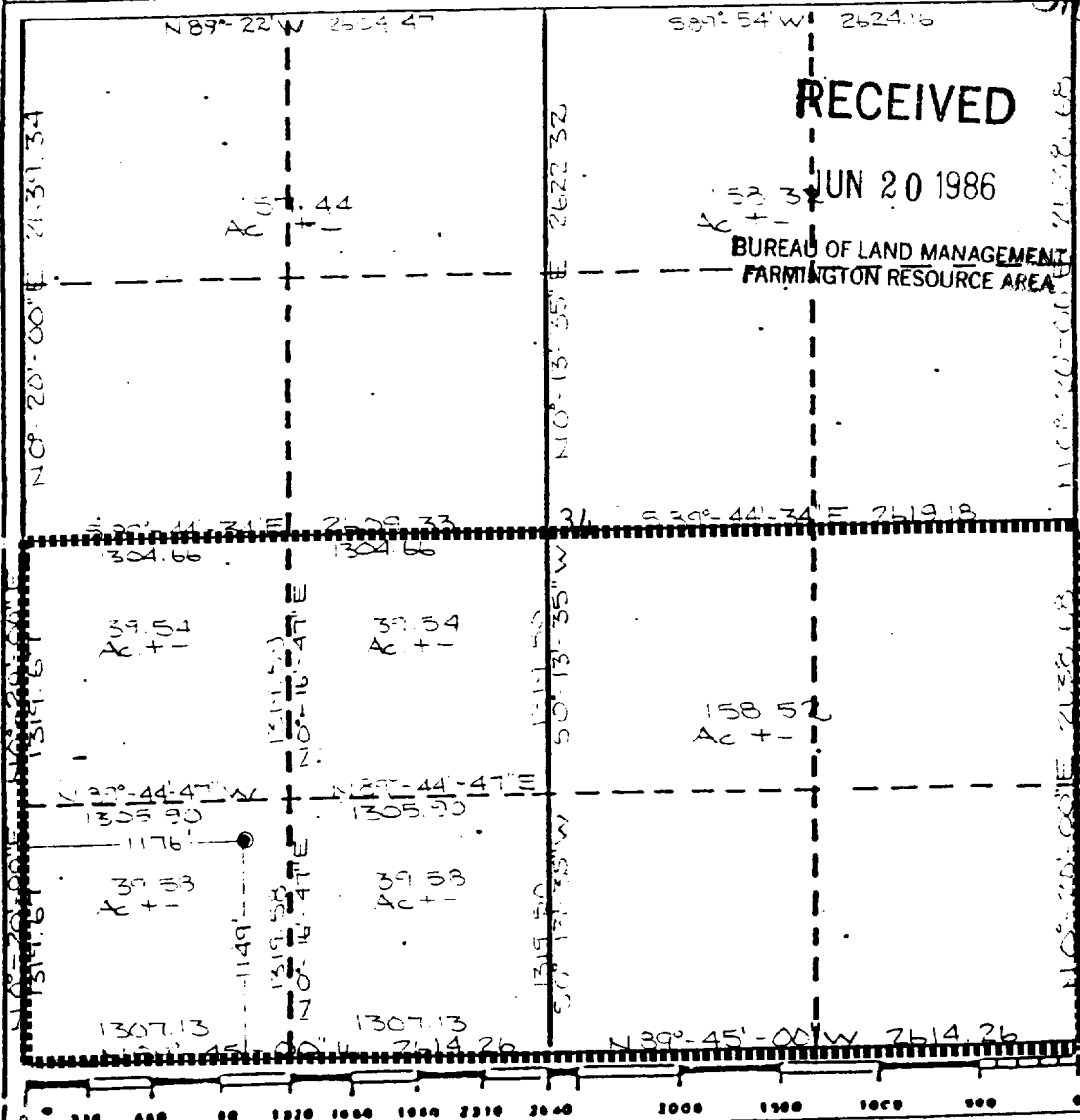

RECEIVED

JUN 20 1986

BUREAU OF LAND MANAGEMENT
FARMINGTON RESOURCE AREA

CERTIFICATION

CON. DIV
DIST. 3

I hereby certify that the information contained herein is true and complete to the best of my knowledge and belief.

Robert C. Frank
Name **Robert C. Frank**

Position **Permit Coordinator**

Company **Union Texas Petroleum**

Date **June 19, 1986**

I hereby certify that the well location shown on this plat was plotted from field notes of actual surveys made by me or under my supervision, and that the same is true and correct to the best of my knowledge and belief.

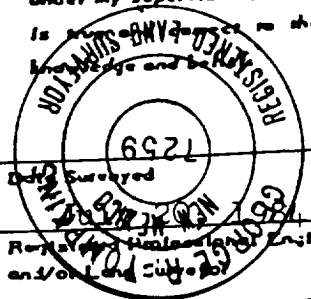

Registered Professional Engineer and/or Land Surveyor

George Tompkins
GEORGE TOMPKINS
7259 Exhibit I

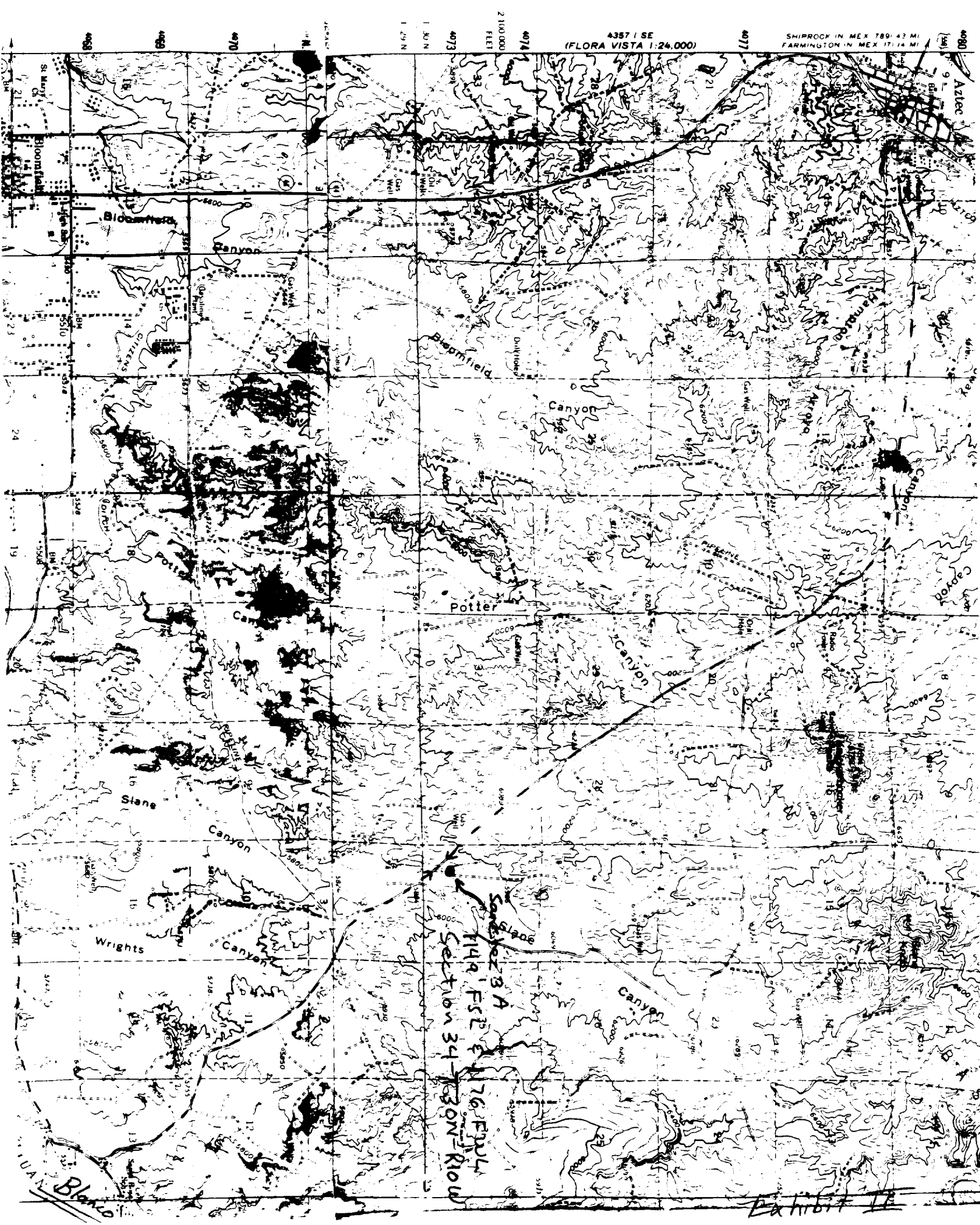

Exhibit 12