

NO. OF COPIES RECEIVED		
DISTRIBUTION		
SANTA FE		
FILE		
U.S.G.S.		
LAND OFFICE		
OPERATOR		

NEW MEXICO OIL CONSERVATION COMMISSION

Form C-101
Revised 1-1-65

5A. Indicate Type of Lease	
STATE <input checked="" type="checkbox"/>	FEE <input type="checkbox"/>
5. State Oil & Gas Lease No.	
B-10037-65	

APPLICATION FOR PERMIT TO DRILL, DEEPEN, OR PLUG BACK

1a. Type of Work		7. Unit Agreement Name	
b. Type of Well OIL WELL <input type="checkbox"/> GAS WELL <input checked="" type="checkbox"/> OTHER <input type="checkbox"/>		8. Farm or Lease Name Beaver Lodge Com	
2. Name of Operator Meridian Oil Inc.		9. Well No. 320	
3. Address of Operator PO Box 4289, Farmington, NM 87499		10. Field and Pool, or Wildcat Undes. Fruitland Coal	
4. Location of Well UNIT LETTER <u>L</u> LOCATED <u>1850</u> FEET FROM THE <u>South</u> LINE AND <u>790</u> FEET FROM THE <u>West</u> LINE OF SEC. <u>32</u> TWP. <u>30N</u> RGE. <u>8W</u> NMPM		12. County San Juan	
19. Proposed Depth 2460		19A. Formation Fruitland	
20. Rotary or C.T. Rotary		21. Elevations (Show whether DF, RT, etc.) 5813' GL	
21A. Kind & Status Plug. Bond statewide		21B. Drilling Contractor	
22. Approx. Date Work will start			

23.

PROPOSED CASING AND CEMENT PROGRAM

SIZE OF HOLE	SIZE OF CASING	WEIGHT PER FOOT	SETTING DEPTH	SACKS OF CEMENT	EST. TOP
12 1/4"	9 5/8"	36.0#	200'	130 cu.ft.	circ. surface
8 3/4"	7"	20.0#	2315	287 cu.ft.	circ. surface
6 1/4"	5 1/2"	23.0#	2460	do not cement	

The Fruitland Coal formation will be completed.

A 3000 psi WP and 6000 psi test double gate preventer equipped with blind and pipe rams will be used for blow out prevention on this well.

This gas is dedicated.

The SW/4 of Section 32 is dedicated to this well.

IN ABOVE SPACE DESCRIBE PROPOSED PROGRAM: IF PROPOSAL IS TO DEEPEN OR PLUG BACK, GIVE DATA ON PRESENT PRODUCTIVE ZONE AND PROPOSED NEW PRODUCTIVE ZONE. GIVE BLOWOUT PREVENTER PROGRAM, IF ANY.

I hereby certify that the information above is true and complete to the best of my knowledge and belief.

Signed Debra B. B. B. Title Drilling Clerk Date 9-19-88

(This space for State Use)

APPROVED BY Ernie Busch TITLE _____ DATE _____

CONDITIONS OF APPROVAL, IF ANY:

All distances must be from the outer boundaries of the Section.

Operator Meridian Oil Company		Lease Beaver Lodge COM(B-10037-65)		Well No. 320
Unit Letter L	Section 32	Township T30N	Range R8W	County San Juan County
Actual Footage Location of Well 1850 feet from the South line and 790 feet from the West line				
Ground Level Elev. 5813	Producing Formation Fruitland Coal	Pool Undesignated	Dedicated Acreage 160 Acres	

1. Outline the acreage dedicated to the subject well by colored pencil or hatchure marks on the plat below.
2. If more than one lease is dedicated to the well, outline each and identify the ownership thereof (both as to working interest and royalty).
3. If more than one lease of different ownership is dedicated to the well, have the interests of all owners been consolidated by communitization, unitization, force-pooling, etc?
☒ Yes ☐ No If answer is "yes," type of consolidation communitization

If answer is "no," list the owners and tract descriptions which have actually been consolidated. (Use reverse side of this form if necessary.)

No allowable will be assigned to the well until all interests have been consolidated (by communitization, unitization, forced-pooling, or otherwise) or until a non-standard unit, eliminating such interests, has been approved by the Division.

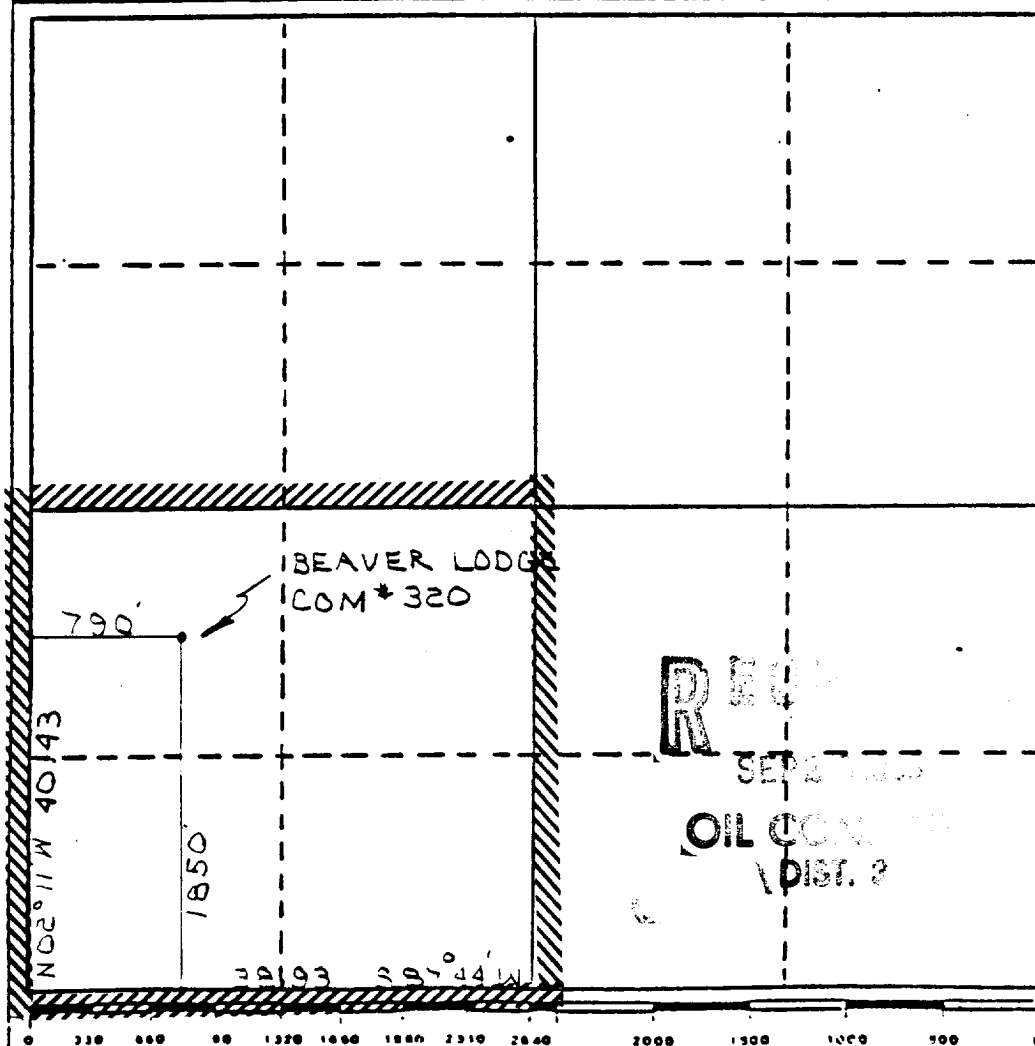

CERTIFICATION

I hereby certify that the information contained herein is true and complete to the best of my knowledge and belief.

Name
Regulatory Affairs

Position
Meridian Oil Inc.

Company
9-19-88

Date

I hereby certify that the well location shown on this plat was plotted from field notes of accurate surveys made by me or under my supervision and that the same is true and correct to the best of my knowledge and belief.

Registered Professional

Date Surveyed and Surveyed
July 26, 1988

Registered Land Surveyor
R. Howard Daggett

Certificate No.
9679