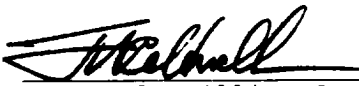

UNITED STATES
DEPARTMENT OF THE INTERIOR
BUREAU OF LAND MANAGEMENT

APPLICATION FOR PERMIT TO DRILL, DEEPEN, OR PLUG BACK

1a. Type of Work DRILL	5. Lease Number SF-078504 9 Unit Reporting Number
1b. Type of Well GAS	6. If Indian, All. or Tribe
2. Operator MERIDIAN OIL 14538	7. Unit Agreement Name San Juan 32-9 Unit
3. Address & Phone No. of Operator PO Box 4289, Farmington, NM 87499 (505) 326-9700	8. Farm or Lease Name 7473 San Juan 32-9 Unit 9. Well Number 120
4. Location of Well 960' FSL, 1135' FEL Latitude 36° 55' 20", Longitude 107° 48' 55"	10. Field, Pool, Wildcat 72359 Blanco Pictured Cliffs 11. Sec., Twn, Rge, Mer. (NMPM) P Sec 6, T-31-N, R-9-W API # 30-045-29283
14. Distance in Miles from Nearest Town 4 miles to Cedar Hill NM	12. County San Juan 13. State NM
15. Distance from Proposed Location to Nearest Property or Lease Line 960'	16. Acres in Lease This tract is subject to technical and procedural requirements to 43 CFR 3165.3 and appeal pursuant to 43 CFR 3165.4.
16. Acres in Lease	17. Acres Assigned to Well 157.92 SE/4
18. Distance from Proposed Location to Nearest Well, Drig, Compl, or Applied for on this Lease 400'	19. Proposed Depth 3800'
20. Rotary or Cable Tools Rotary	21. Elevations (DF, FT, GR, Etc.) 6606' GR
22. Approx. Date Work will Start 3rd quarter 1995	23. Proposed Casing and Cementing Program See Operations Plan attached
24. Authorized by:  Regional Drilling Engineer	DRILLING OPERATIONS AUTHORIZED ARE SUBJECT TO AGREEMENT WITH ATTACHED "GENERAL" ... Date: 7/21/95

PERMIT NO. _____ APPROVAL DATE _____

APPROVED BY _____ TITLE _____ DATE _____

Archaeological Report to be submitted by Arboles Contract Archaeology
Threatened and Endangered Species Report to be submitted
NOTE: This format is issued in lieu of U.S. BLM Form 3160-3

APPROVED
AS AMENDED

SEP 18 1995

DISTRICT MANAGER

NMOCD

District I
PO Box 1980, Hobbs, NM 88241-1980
District II
PO Drawer DD, Artesia, NM 88211-0719
District III
1000 Rio Hrazas Rd., Aztec, NM 87410
District IV
PO Box 2088, Santa Fe, NM 87504-2088

State of New Mexico
Energy, Minerals & Natural Resources Department

OIL CONSERVATION DIVISION
PO Box 2088
Santa Fe, NM 87504-2088

Form C-101
Revised February 21, 199-
Instructions on back
Submit to Appropriate District Office
State Lease - 4 Copies
Fee Lease - 3 Copies

☐ AMENDED REPORT

WELL LOCATION AND ACREAGE DEDICATION PLAT

API Number 30-045-29283		Pool Code 72359	Pool Name Blanco Pictured Cliffs
Property Code 7473	Property Name San Juan 32-9 Unit		Well Number 120
GRID No. 14538	Operator Name Meridian Oil Inc.		Elevation 6606'

10 Surface Location

UL or lot no.	Section	Township	Range	Lot Idn	Feet from the	North/South line	Feet from the	East/West line	County
P	6	31 N	9 W		960	South	1135	East	S.J.

11 Bottom Hole Location If Different From Surface

UL or lot no.	Section	Township	Range	Lot Idn	Feet from the	North/South line	Feet from the	East/West line	County

12 Dedicated Acres 157.92	13 Joint or Infill	14 Consolidation Code	15 Order No.
------------------------------	--------------------	-----------------------	--------------

NO ALLOWABLE WILL BE ASSIGNED TO THIS COMPLETION UNTIL ALL INTERESTS HAVE BEEN CONSOLIDATED
OR A NON-STANDARD UNIT HAS BEEN APPROVED BY THE DIVISION

16	281.16'	1518.00'	2594.46'	17 OPERATOR CERTIFICATION	
11	2480.28'	10	14	I hereby certify that the information contained herein is true and complete to the best of my knowledge and belief.	
				RECEIVED	
				SEP 21 1995	
				OIL CON. DIV.	
12	2480.28'	13	15	Signature Peggy Bradfield	
18	2657.16'	17	16	Printed Name Regulatory Affairs	
				Title 7-10-95	
				Date	
				17	
19	2657.16'	20	21	18 SURVEYOR CERTIFICATION	
11	2480.28'	10	14	I hereby certify that the well location shown on this plat was plotted from field notes of actual surveys made by me or under my supervision, and that the same is true and correct to the best of my belief.	
				6-1-95	
				Date of Survey	
				Signature and Seal of Professional Surveyor	
12	2480.28'	13	15	NEALE C. EDWARDS	
18	2657.16'	17	16	8857	
				8857	
				8857	
				8857	
19	2657.16'	20	21	Certificate Number	
11	2480.28'	10	14	387.42'	
				1335.84'	
				2671.02'	
				960'	

July 14, 1995

OPERATIONS PLAN

Well Name: San Juan 32-9 Unit #120
Location: 960' FSL, 1135' FEL Section 6, T-31-N, R-9-W
 San Juan County, New Mexico
 Latitude 36° 55' 20", Longitude 107° 50' 49"
Formation: Blanco Pictured Cliffs
Elevation: 6751' GL

Formation:	Top	Bottom	Contents
Surface	San Jose	1653	
Ojo Alamo	1653'	1771'	aquifer
Kirtland	1771'	2863'	
Fruitland	2863'	3439'	
Pictured Cliffs	3439'	3559'	gas
Lewis	3559'		
Total Depth	3800'		

Logging Program: Mud logs from 1650' to Total Depth.
 CNL/hi res LDT/ML/GR/CAL to Total Depth.

Mud Program:

Interval	Type	Weight	Vis.	Fluid Loss
0- 200'	Spud	8.4-8.9	40-50	no control
200-3800'	Non-dispersed	8.4-9.5	30-60	no control

Casing Program:

Hole Size	Depth Interval	Csg. Size	Wt.	Grade
12 1/4"	0 - 200'	8 5/8"	24.0#	K-55
7 7/8"	0 - 3800'	4 1/2"	10.5#	K-55

Tubing Program: - 2 3/8", 4.7#, J-55 EUE 8rd tbg landed @ 3800'

Float Equipment: 8 5/8" surface casing - saw tooth guide shoe.
 Centralizers will be run in accordance with Onshore Order #2.

4 1/2" production casing - float shoe on bottom. Three centralizers run every other joint above shoe. Four centralizers run every 3rd joint to the base of the Ojo Alamo @ 1771'. Two turbolizing type centralizers - one below and one into the base of the Ojo Alamo @ 1771'. Standard centralizers thereafter every fourth joint up to the base of the surface pipe.

Wellhead Equipment: 8 5/8" x 4 1/2" x 2 3/8" x 11" 2000 psi xmas tree assembly.

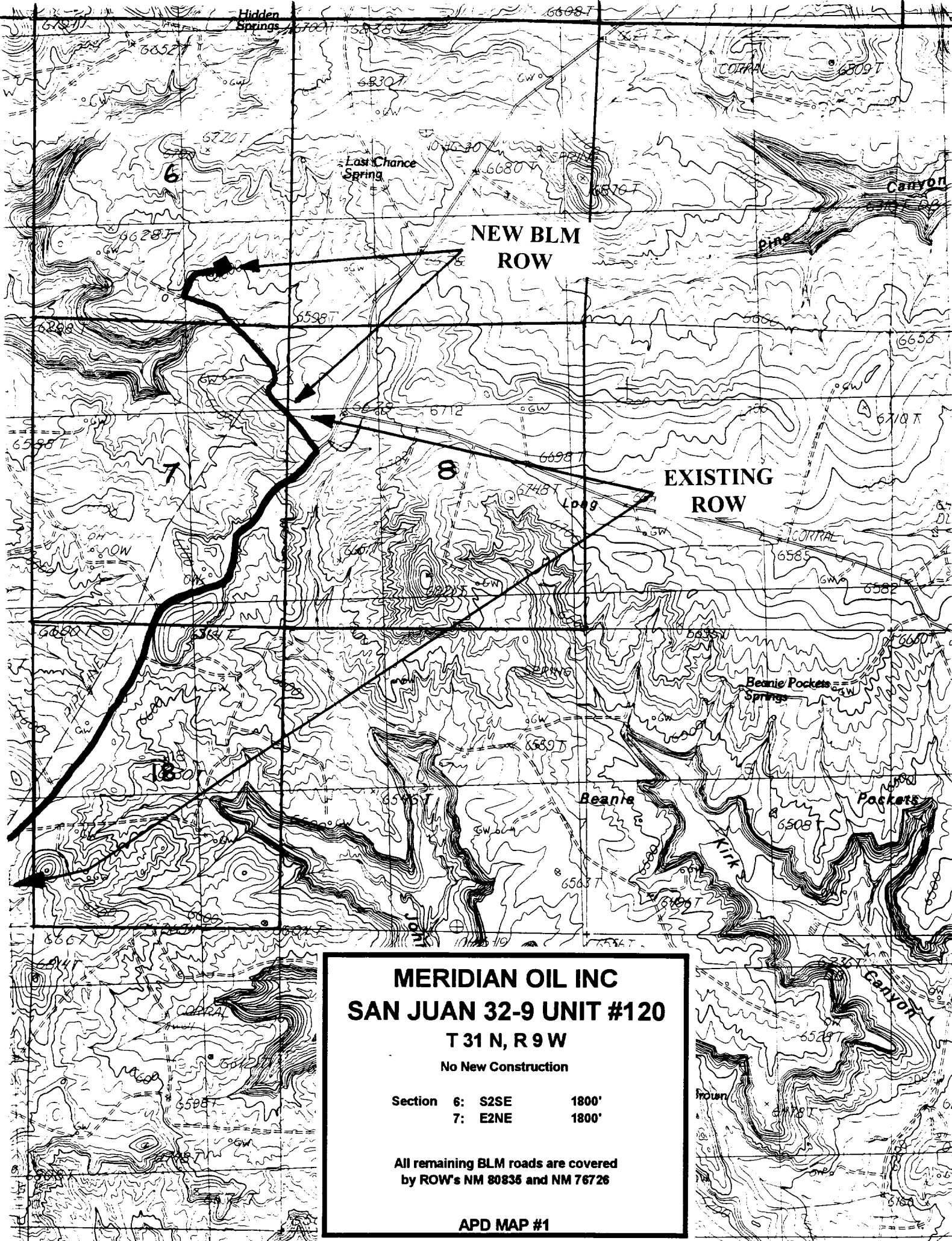

MERIDIAN OIL INC
SAN JUAN 32-9 UNIT #120

T 31 N, R 9 W

No New Construction

Section	6:	S2SE	1800'
	7:	E2NE	1800'

All remaining BLM roads are covered
by ROW's NM 80835 and NM 76726

APD MAP #1