

submitted in lieu of Form 3160-5

UNITED STATES  
DEPARTMENT OF THE INTERIOR  
BUREAU OF LAND MANAGEMENT

Sundry Notices and Reports on Wells

1. Type of Well  
GAS

2. Name of Operator

**BURLINGTON  
RESOURCES**

OIL & GAS COMPANY

3. Address & Phone No. of Operator

PO Box 4289, Farmington, NM 87499 (505) 326-9700

4. Location of Well, Footage, Sec., T, R, M

1515' FNL, 1150' FEL, Sec. 28, T-30-N, R-11-W, NMPM

5. Lease Number  
SF-078138

6. If Indian, All. or  
Tribe Name

7. Unit Agreement Name

8. Well Name & Number  
Morris Com #102

9. API Well No.  
30-045-29542

10. Field and Pool  
WC-30N11W28 Chacra/  
Blanco Mesaverde

11. County and State  
San Juan Co, NM

12. CHECK APPROPRIATE BOX TO INDICATE NATURE OF NOTICE, REPORT, OTHER DATA

Type of Submission

☒ Notice of Intent

☐ Subsequent Report

☐ Final Abandonment

Type of Action

☐ Abandonment

☒ Recompletion

☐ Plugging Back

☐ Casing Repair

☐ Altering Casing

☐ Other -

☐ Change of Plans

☐ New Construction

☐ Non-Routine Fracturing

☐ Water Shut off

☐ Conversion to Injection

13. Describe Proposed or Completed Operations

It is intended to recomplate the subject well in the Chacra formation  
according to the attached procedure and wellbore diagram.

14. I hereby certify that the foregoing is true and correct.

Signed Regan Cole (MQ) Title Regulatory Administrator Date 3/2/00  
TLW

(This space for Federal or State Office use)

APPROVED BY /s/ Charlie Beecham Title \_\_\_\_\_ Date 3/2/00

CONDITION OF APPROVAL, if any:

Title 18 U.S.C. Section 1001, makes it a crime for any person knowingly and willfully to make to any department or agency of the  
United States any false, fictitious or fraudulent statements or representations as to any matter within its jurisdiction.

OK per R-11363

RECORDED

District I  
PO Box 1980, Hobbs, NM 88241-1980

District II  
PO Drawer UD, Artesia, NM 88211-0719

District III  
1000 Rio Brazos Rd., Aztec, NM 87410

District IV  
PO Box 2088, Santa Fe, NM 87504-2088

State of New Mexico  
Energy, Minerals & Natural Resources Dep.

OIL CONSERVATION DIVISION  
PO Box 2088  
Santa Fe, NM 87504-2088

Form C-  
Revised February 21, 1991  
Instructions on p  
Submit to Appropriate District Off  
State Lease - 4 Cop  
Fee Lease - 3 Cop

75-10-2 01:10:01 ☐ AMENDED REPORT

### WELL LOCATION AND ACREAGE DEDICATION PLAT

API Number 30-045-29542	Pool Code 72319/	Pool Name Blanco Mesaverde/WC:30N11W28 Chacra
Property Code	Property Name MORRIS COM	Well Number 102
GRID No. 14538	Operator Name BURLINGTON RESOURCES OIL & GAS COMPANY	Elevation 6010'

#### 10 Surface Location

UL or lot no.	Section	Township	Range	Lot Idn	Feet from the	North/South line	Feet from the	East/West line	County
H	28	30N	11W		1515	North	1150	East	SAN JU

#### 11 Bottom Hole Location If Different From Surface

UL or lot no.	Section	Township	Range	Lot Idn	Feet from the	North/South line	Feet from the	East/West line	County

12 Dedicates Acres NE 159.12	13 Joint or Infill	14 Consolidation Code	15 Order No.
---------------------------------	--------------------	-----------------------	--------------

NO ALLOWABLE WILL BE ASSIGNED TO THIS COMPLETION UNTIL ALL INTERESTS HAVE BEEN CONSOLIDATED OR A NON-STANDARD UNIT HAS BEEN APPROVED BY THE DIVISION

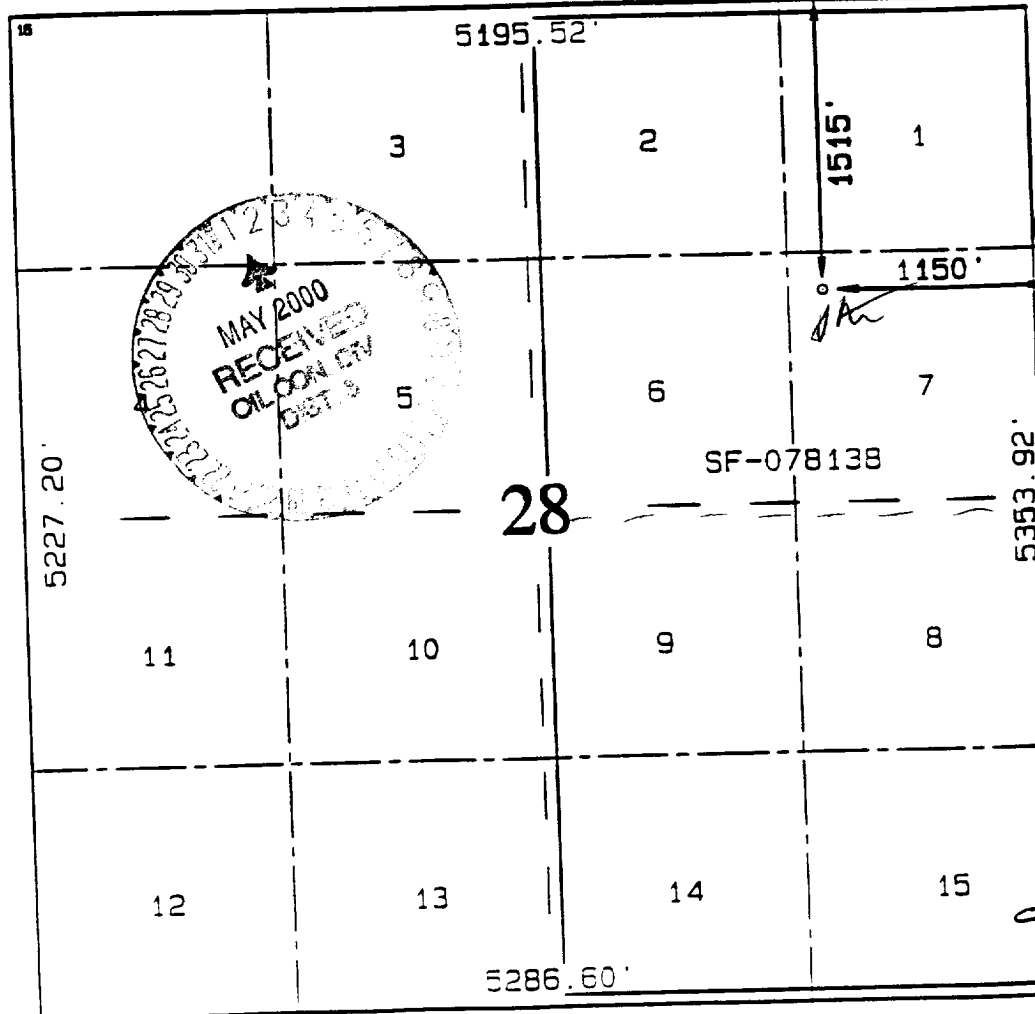

#### 17 OPERATOR CERTIFICATION

I hereby certify that the information contained herein is true and complete to the best of my knowledge and belief.

Signature  
Peggy Cole  
Printed Name  
Regulatory Administrator  
Title  
3-2-00  
Date

#### 18 SURVEYOR CERTIFICATION

I hereby certify that the well location shown on this plat was plotted from field notes of actual surveys made or under my supervision, and that the same is true and correct to the best of my belief.

OCTOBER 15, 1997  
Date of Survey  
Signature and Seal of Professional Surveyor

Certificate Number  
NEALE C. EDWARDS  
NEW MEXICO  
Professional Surveyor

**Morris Com #102**

Chacra Recompletion Procedure  
 Unit H, Section 28, T-30N, R-11 W  
 Lat: 36° 47.21' Long: 107° 59.43'

*This well was originally drilled in 1998 and is currently completed in the Menefee and Point Lookout. It is intended to recomplete the Chacra (Lewis Shale) and commingle with the existing production. The Chacra will be sand fracture stimulated in two stages using 100,000 lbs 20/40 sand and 75Q 20 lb linear gel in each stage. Foam will be used to limit fluid damage and aid in the flowback. The flowback choke schedule is to be used to ensure that the proppant remains in the fractures.*

- Comply with all BLM, NMOCD, and BR rules and regulations.
- Hold safety meetings.
- Place fire safety equipment in strategic locations.
- Inspect location and test rig anchors.
- Dig flowback pit or set flowback tank.
- Set and fill 3-400 BBL Frac tanks w/ 2% KCl water. Test and filter if necessary.

**Equipment Needed:**

- (3) Frac Tanks with 2% KCl water
- (2) 4-1/2" CIBP
- (1) 4-1/2" RBP
- (1) 4-1/2" Packer

**PROCEDURE:**

1. MIRU. Record and report SI pressures on tubing, casing, and bradenhead. Lay blowdown line and blow well down. Kill well with 2% KCl water. ND WH, NU BOP. Test and record operation of rams. NU blooie line and 2-7/8" relief line. Redress production wellhead as needed.
2. TOOH w/ 2-3/8" 4.7# J-55 tubing set at 4786' (SN @ 4754'). Visually inspect tubing, note and report any corrosion and/or scale\*\* in/on tubing. Replace bad joints as needed.

\*\* If tubing is scaled up, contact the production engineer so a scale analysis can be run to determine if an acid treatment is needed.

3. RU wireline. Run 4-1/2" gauge ring to 3870'. If ring tags up before 3870', TIH with 3-7/8" Bit, 4-1/2" 10.5# casing scraper on 2-3/8" tubing and CO to 4956'. TOOH. RIH with 4-1/2" CIBP and wireline set CIBP @  $\pm$  3850'. Load Hole w/ 2% KCl water. Pressure Test Casing to 3000 psi.
4. Correlate to CBL/CCL/GR log and perforate the Lower Chacra as follows using Scallop HSC guns loaded with TAG-4000-311T 23 gm, .42" diameter, 22.2" penetration charges at 1 SPF in the following intervals from bottom up:

**3790-80, 3762-52, 3712-02, 3680-70, 3650-40, 3590-80**

RD wireline.

5. TIH with 4-1/2" RBP, on/off tool and 4-1/2" packer on 2-3/8" tubing.

Set RBP at RBP setting depth. PUH  $\pm$  10 ft and set Packer. RU stimulation company and pressure test RBP and lines to 3800 psi. Release packer, and reset packer at Packer Setting Depth. Breakdown perforations and establish an injection rate between 8 and 10 BPM with 333 gals of Acetic Acid + 5% NH<sub>4</sub>Cl \*\*. Breakdown to the **Max pressure of 3800 psi**. Release packer and RBP. Repeat for the remaining intervals.

\*\* All Acid to contain the following additives/ 1000 gal:

1000 gal	10%	Acetic Acid
2 gal	MSA II	corrosion inhibitor
5%	NH <sub>4</sub> CL	clay control

**Morris Com #102**  
**Chacra Recompletion Procedure**  
**Unit H, Section 28, T-30N, R-11 W**  
**Lat: 36° 47.21' Long: 107° 59.43'**

RBP Setting Depth	Packer Setting Depth	Perforation Intervals
3840	3720	3752-62, 3780-90
3740	3655	3670-80, 3702-12
3660	3530	3580-90, 3640-50

6. TOOH w/ RBP, Packer, and 2-3/8" tubing.
7. Pressure Test surface lines to 4000 psi. Fracture stimulate Lower Chacra with 100,000 lbs 20/40 sand in 75Q foam w/ 20 lb linear gel at a rate of 35 BPM in 0.5 to 3.0 ppg stages. **Tag sand with 3 radioactive isotopes. Maximum Surface Treating Pressure is 3000 psi.** At 35 BFM friction pressure is approximately 570 psi. Slow rate during flush. Flush to 50' above top perf with 75Q foam.
8. Record ISIP, 5, 10 and 15 shut-in pressure. Shut-in frac valve. RD stimulation company. Install flowback line above frac valve. Lay flowback line to dual-choke manifold and pit. Begin flowback after stimulation company has rigged down from frac valve. Open well to pit on accordance with flowback schedule listed in the table below. Do not shut well in during flowback. When schedule dictates a larger choke size, open ball valve upstream of adjustable choke and open adjustable choke on manifold to pre-determined size listed in table and begin flowing through adjustable choke. Close ball valve upstream of positive flow bean and change out flow bean to next larger size in table. Open ball valve upstream of positive flow bean and begin flowing. Close ball valve upstream of adjustable choke and close adjustable choke.

10/64" Choke	Approximately 2 hrs.
12/64" Choke	Approximately 2 hrs.
14/64" Choke	Approximately 2 hrs.
16/64" Choke	Approximately 3 hrs.
18/64" Choke	Approximately 3 hrs.
20/64" Choke	Approximately 3 hrs.
22/64" Choke	Approximately 3 hrs.
24/64" Choke	Approximately 3 hrs.
32/64" Choke	Approximately 3 hrs.

**NOTE: Follow this schedule to utilize a 24+ hour flowback. If well begins to slug or make large amounts of sand to surface, drop to next lower choke size. If well begins to taper off in liquid production (mostly N<sub>2</sub>), change to next larger choke size before time schedule dictates.**

9. RU wireline. RIH w/ 4-1/2" CIBP and wireline set CIBP @  $\pm$  3550'. Pressure test CIBP and casing to 3000 psi.
10. Correlate to CBL/CCL/GR and perforate the Upper Chacra as follows using Scallop HSC guns loaded with TAG-4000-311T 23 gm, .42" diameter, 22.2" penetration charges at 1 SPF in the following intervals from bottom up:

**3510-00, 3422-12, 3366-56, 3308-3298, 3170-60, 3130-20**

RD wireline.

11. TIH with 4-1/2" RBP, on/off tool and 4-1/2" packer on 2-3/8" tubing.

Set RBP at RBP setting depth. PUH  $\pm$  10 ft and set Packer. RU stimulation company and pressure test RBP and lines to 3800 psi. Release packer, and reset packer at Packer Setting Depth. Breakdown perforations and establish an injection rate between 8 and 10 BPM with 333 gals of Acetic Acid + 5% NH<sub>4</sub>Cl \*\*. Breakdown to the **Max pressure of 3800 psi.** Release packer and RBP. Repeat for the remaining intervals.

**Morris Com #102**  
**Chacra Recompletion Procedure**  
**Unit H, Section 28, T-30N, R-11 W**  
**Lat: 36° 47.21' Long: 107° 59.43'**

\*\* All Acid to contain the following additives/ 1000 gal:

1000 gal	10%	Acetic Acid
2 gal	MSA II	corrosion inhibitor
5%	NH <sub>4</sub> CL	clay control

RBP Setting Depth	Packer Setting Depth	Perforation Intervals
3540	3380	3412-22, 3500-10
3400	3250	3298-3308, 3356-66
3220	3070	3120-30, 3160-70

12. TOOH w/ RBP, Packer, and 2-3/8" tubing and stand back.
13. Pressure Test surface lines to 4000 psi. Fracture stimulate Upper Chacra with 100,000 lbs 20/40 sand in 75Q foam w/ 20 lb linear gel at a rate of 35 BPM in 0.5 to 3.0 ppg stages. **Tag sand with 3 radioactive isotopes. Maximum Surface Treating Pressure is 3000 psi.** At 35 BPM friction pressure is approximately 450 psi. Slow rate during flush. Flush to 50' above top perf with 75Q foam.
14. Record ISIP, 5, 10 and 15 shut-in pressure. Shut-in frac valve. RD stimulation company. Install flowback line above frac valve. Lay flowback line to dual-choke manifold and pit. Begin flowback after stimulation company has rigged down from frac valve. Open well to pit on accordance with flowback schedule listed in the table below. Do not shut well in during flowback. When schedule dictates a larger choke size, open ball valve upstream of adjustable choke and open adjustable choke on manifold to pre-determined size listed in table and begin flowing through adjustable choke. Close ball valve upstream of positive flow bean and change out flow bean to next larger size in table. Open ball valve upstream of positive flow bean and begin flowing. Close ball valve upstream of adjustable choke and close adjustable choke.

10/64" Choke	Approximately 2 hrs.
12/64" Choke	Approximately 2 hrs.
14/64" Choke	Approximately 2 hrs.
16/64" Choke	Approximately 3 hrs.
18/64" Choke	Approximately 3 hrs.
20/64" Choke	Approximately 3 hrs.
22/64" Choke	Approximately 3 hrs.
24/64" Choke	Approximately 3 hrs.
32/64" Choke	Approximately 3 hrs.

**NOTE: Follow this schedule to utilize a 24+ hour flowback. If well begins to slug or make large amounts of sand to surface, drop to next lower choke size. If well begins to taper off in liquid production (mostly N<sub>2</sub>), change to next larger choke size before time schedule dictates.**

15. TIH w/ 3-7/8" bit on 2-3/8" tubing and CO to CIBP @ 3550'. Monitor gas and water returns. When sand and water allow (less than 5 BPH and trace sand), take a Upper Chacra pitot gauge. DO CIBP @ 3550' with a minimum of 12 BPH mist rate.
16. CO to CIBP @ 3<sup>8</sup>550'. Monitor gas and water returns. When sand and water allow (less than 5 BPH and trace sand), take a complete Chacra pitot gauge. DO CIBP @ 3850' with a minimum of 12 BPH mist rate.
17. Continue to CO to PBSD with air. Blow well at PBSD and monitor water rates. If needed continue to blow well for clean up. When water rates are below 5 BPH and there is no sand production, TOOH.

**Morris Com #102**  
Chacra Recompletion Procedure  
Unit H, Section 28, T-30N, R-11 W  
Lat: 36° 47.21' Long: 107° 59.43'

18. TIH with an expendable check, one 2-3/8" joint, seating nipple, and remaining production tubing. Broach tubing while running in hole. CO with air/mist to PBTD again, if necessary. Obtain final pitot gauge. Land tubing at  $\pm$  4870'. ND BOP. NU WH. Pump off expendable check. RDMO. Contact Production Operations for well tie-in.

19. RU Pro-Technics. Run After Frac Log across Chacra (3900' – 3000'). RD Pro-Technics.

Recommended: Michele Quisel  
Production Engineer  
1-12-00

Approved: PJ [Signature] 1/24/00  
Drilling Superintendent

Approved: [Signature] 1/12/00  
Team Leader

Contact:

Michele Quisel 324-6162 (WORK)      326-8196(PAGER)      564-9097(HOME)

Vendors:	Wireline:	Basin	327-5244
	RA Tagging:	Pro-Technics	326-7133

# Morris Com #102

1515' FNL, 1150' FEL  
Unit H Sec.28, T-30 R-11W  
San Juan County, New Mexico

KB 6025

GL 6010

Lat: 36° 47.21'

Long: 107° 59.43'

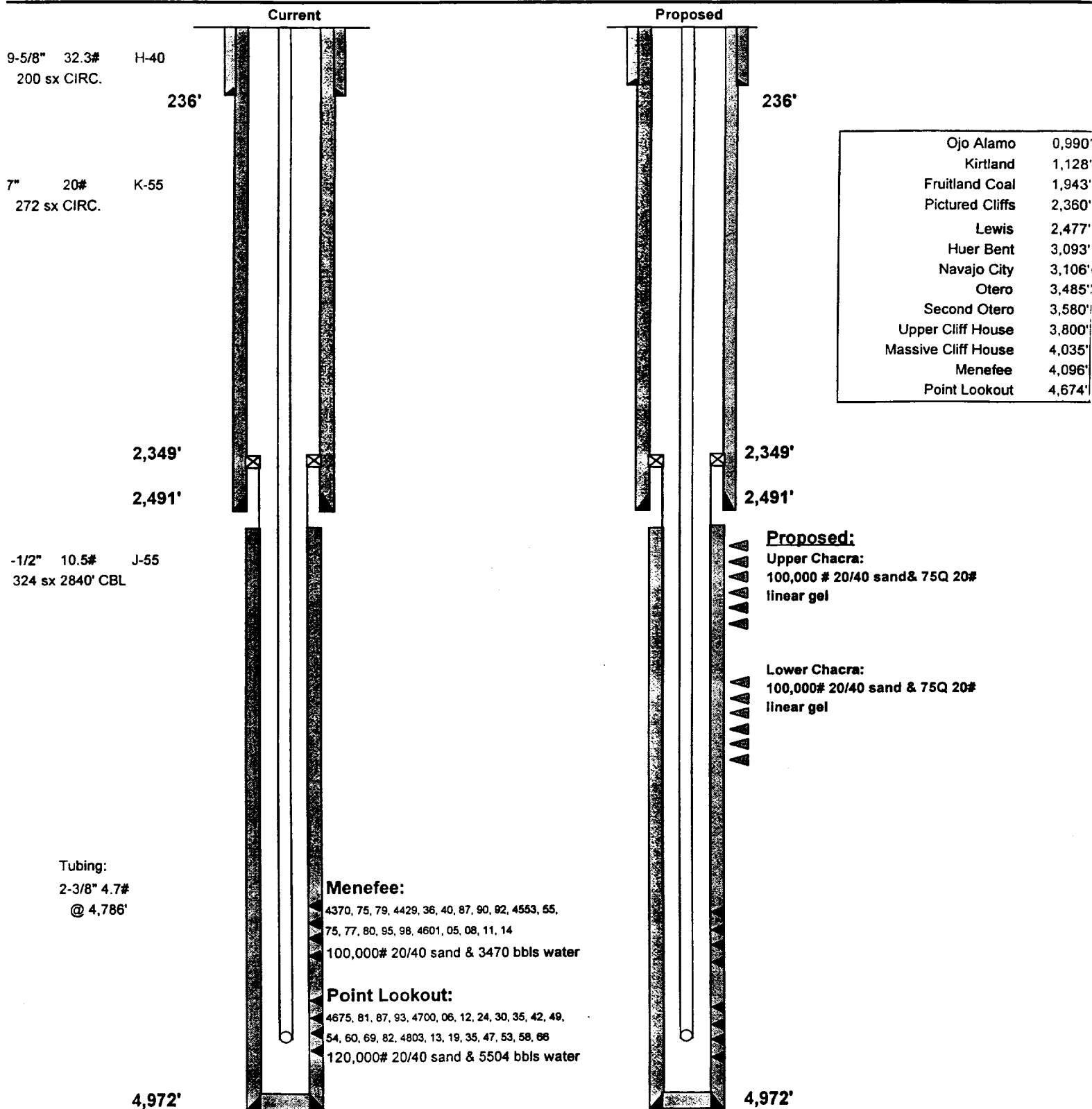

Ojo Alamo	0,990'
Kirtland	1,128'
Fruitland Coal	1,943'
Pictured Cliffs	2,360'
Lewis	2,477'
Huer Bent	3,093'
Navajo City	3,106'
Otero	3,485'
Second Otero	3,580'
Upper Cliff House	3,800'
Massive Cliff House	4,035'
Menefee	4,096'
Point Lookout	4,674'

PBTD = 4,956'  
TD= 5,000'

01/12/2000

MSQ