

UNITED STATES
DEPARTMENT OF THE INTERIOR
BUREAU OF LAND MANAGEMENT

SUBMIT IN TRIPLICATE*
(Other instructions apply)
RECEIVED
BLM

FORM APPROVED
OMB NO. 1004-0136
Expires: February 28, 1995

A-9305

COUPLER PH 1-17
070 FARMINGTON, NM

APPLICATION FOR PERMIT TO DRILL OR DEEPEN

1. TYPE OF WORK
DRILL **DEEPEN**
2. TYPE OF WELL
OIL WELL GAS WELL OTHER
SINGLE ZONE MULTIPLE ZONE

3. NAME OF OPERATOR
Phillips Petroleum Company 17654

4. ADDRESS AND TELEPHONE NO.
5525 Highway 64, NBU 3004, Farmington, NM 87401 505-599-3454

5. LOCATION OF WELL (Report location clearly and in accordance with any State requirements.)
At surface
Unit M, 655' FSL & 705' FWL
At proposed prod. zone
Unit M, 1600' FSL & 150' FWL

6. DISTANCE IN MILES AND DIRECTION FROM NEAREST TOWN OR POST OFFICE
15 miles south of Ignacio, Colorado

7. DISTANCE FROM PROPOSED LOCATION TO NEAREST PROPERTY OR LEASE LINE, FT.
(Also to nearest drlg. unit line, if any) *150'*

8. DISTANCE FROM PROPOSED LOCATION TO NEAREST WELL, DRILLING, COMPLETED, OR APPLIED FOR, ON THIS LEASE, FT. *500' (#218)*

9. ELEVATIONS (Show whether DF, RT, GR, etc.)
6766' (unprepared ground level)

10. PROPOSED CASING AND CEMENTING PROGRAM

SIZE OF HOLE	GRADE, SIZE OF CASING	WEIGHT PER FOOT	SETTING DEPTH	QUANTITY OF CEMENT
12-1/4"	9-5/8"	36#, J/K-55	350'	185 sx C1 B (222 cu ft)
8-3/4"	7"	20#, J/K-55	3380' (TVD)	L-450 sx (994.5 cu ft) CL B POZ
6-1/4"	5-1/2"	15.5# J/K-55	3360' to TD	T-150 sx (180 cu ft) C1 B

** If the coal is clefted a 5-1/2" 15.5# J/K-55 liner will be run in the open hole without being cemented.

If the coal is not clefted, the well will be stimulated and open hole completed.

See attached for the BOP equipment, mud program and plans for cathodic protection.

See attached pipeline surveys for right-a-way footages.

See attached directional drill survey and plat.

DRILLING OPERATIONS AUTHORIZED ARE SUBJECT TO COMPLIANCE WITH ATTACHED "GENERAL REQUIREMENTS"

RECEIVED
MAR 26 1998
OIL CON. DIV.
DIST. 3

IN ABOVE SPACE DESCRIBE PROPOSED PROGRAM: If proposal is to deepen, give data on present productive zone and proposed new productive zone. If proposal is to drill or deepen directionally, give pertinent data on subsurface locations and measured and true vertical depths. Give blowout preventer program, if any.

24. SIGNED *Falsy Clugston* TITLE Regulatory Assistant DATE 3-11-98

(This space for Federal or State office use)

PERMIT NO. _____ APPROVAL DATE MAR 24 1998

Application approval does not warrant or certify that the applicant holds legal or equitable title to those rights in the subject lease which would entitle the applicant to conduct operations thereon.

CONDITIONS OF APPROVAL, IF ANY:

A-9305 + DD-201
ISI Duane W. Spencer

APPROVED BY _____ TITLE _____ DATE MAR 24 1998

*See Instructions On Reverse Side

District I
190 Box 1980, Hobbs, NM 88241-1980
District II
811 South First, Artesia, NM 88210
District III
1000 Rio Brazos Rd., Aztec, NM 87410
District IV
2040 South Pacheco, Santa Fe, NM 87505

State of New Mexico
Energy, Minerals & Natural Resources Department

OIL CONSERVATION DIVISION
2040 South Pacheco
Santa Fe, NM 87505

Form C-102
Revised October 18, 1994
Instructions on back
Submit to Appropriate District Office
State Lease - 4 Copies
Fee Lease - 3 Copies

RECEIVED
95 MAR 11 PM 1:17

AMENDED REPORT

WELL LOCATION AND ACREAGE DEDICATION PLAT

¹ All Number 30-045-29567	² Pool Code 71629	³ Pool Name Basin Fruitland Coal
⁴ Property Code 009260	⁵ Property Name San Juan 32-7 Unit	
⁷ OGRID No. 017654	⁶ Operator Name Phillips Petroleum Company	⁸ Well Number 220
		⁹ Elevation 6766'

¹⁰ Surface Location

UL or lot no.	Section	Township	Range	Lot Idn	Feet from the	North/South line	Feet from the	East/West line	County
M	5	31N	7W		655'	South	705'	West	San Juan

¹¹ Bottom Hole Location If Different From Surface

UL or lot no.	Section	Township	Range	Lot Idn	Feet from the	North/South line	Feet from the	East/West line	County
M	5	31N	7W		1600'	South	150'	West	San Juan

¹² Dedicated Acres 319.16	¹³ Joint or Infill Y	¹⁴ Consolidation Code U	¹⁵ Order No.
---	------------------------------------	---------------------------------------	-------------------------

NO ALLOWABLE WILL BE ASSIGNED TO THIS COMPLETION UNTIL ALL INTERESTS HAVE BEEN CONSOLIDATED OR A NON-STANDARD UNIT HAS BEEN APPROVED BY THE DIVISION

					<p>¹⁷ OPERATOR CERTIFICATION</p> <p>I hereby certify that the information contained herein is true and complete to the best of my knowledge and belief</p> <p>Signature: <i>W D Jaap</i> W. D. Jaap Printed Name: Operations Support Dir. Title: Operations Support Dir. Date: 7-14-97</p>				
					<p>¹⁸ SURVEYOR CERTIFICATION</p> <p>I hereby certify that the well location shown on this plat was plotted from field notes of actual surveys made by me or under my supervision, and that the same is true and correct to the best of my belief.</p> <p>Date of Survey: 06/04/97</p> <p>Signature and Seal of Professional Surveyor: <i>[Signature]</i></p> <p>Certificate Number: <i>[Number]</i></p>				

RECEIVED
MAR 26 1998
OIL CON. DIV.
DIST. 3

4533.54'

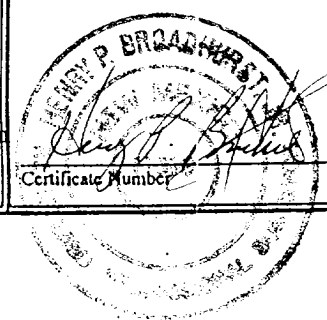

PHILLIPS PETROLEUM CO.
32-7 #220 H2O P/L & ACCESS ROAD
SW/4 SEC.5, T.31 N., R.7 W., N.M.P.M.,
SAN JUAN COUNTY, NEW MEXICO



BURNT MESA QUAD.

Earl

PHILLIPS PETROLEUM



Structure : SEC.5-T31N-R7W Well : SAN JUAN 32-7 #220

Field : SAN JUAN COUNTY Location : NEW MEXICO



WELL PROFILE DATA

Point	MD	Inc	Gr	TVD	North	East	V. Sect	Deg/100
Tie on	0.00	0.00	329.57	0.00	0.00	0.00	0.00	0.00
KOP	600.00	0.00	329.57	600.00	0.00	0.00	0.00	0.00
End of Build	1175.29	28.76	329.57	1151.42	121.93	-71.61	141.40	5.00
End of Hold	2669.16	28.76	329.57	2460.96	741.79	-435.65	860.26	0.00
Target SJ 220	3627.97	0.00	329.57	3380.00	945.00	-555.00	1095.92	3.00
T.D. & End of Hold	3777.97	0.00	329.57	3530.00	945.00	-555.00	1095.92	0.00

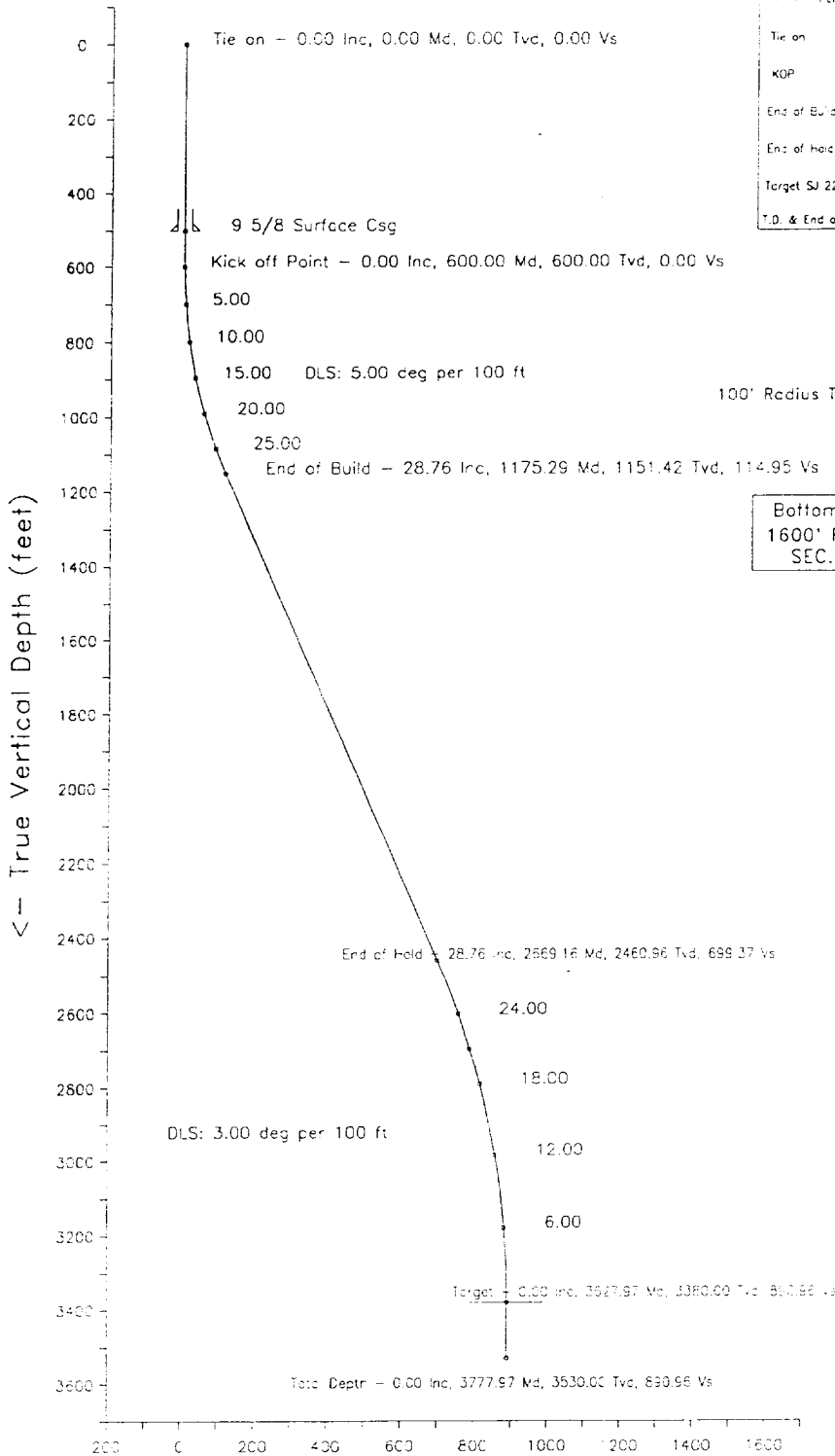

West (feet)

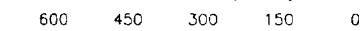

North (feet)

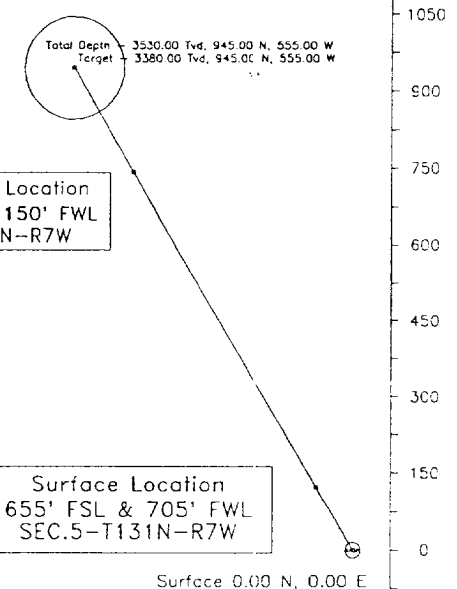

Bottom Hole Location
1600' FSL & 150' FWL
SEC.5-T31N-R7W

Surface Location
655' FSL & 705' FWL
SEC.5-T31N-R7W

Surface 0.00 N, 0.00 E

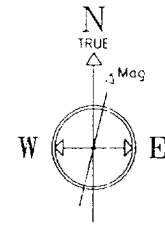

9-Jun-97
Magnetic North is 11.5 degrees East of TRUE North
To correct azimuth from Magnetic to TRUE add 11.51 deg

Baker Hughes INTEQ
DRAWN BY: ERIN ANDERSON
DATE: JULY 21, 1997
TVD REFERENCED RKS
DENVER, COLORADO
PHONE: (303) 534-3223

Vertical Section (feet) ->
Azimuth 293.96 with reference 0.00 N, 0.00 E from SLOT #1

PHILLIPS PETROLEUM
SEC.5-T31N-R7W

SAN JUAN 32-7 #220
SLOT #1
SAN JUAN COUNTY
NEW MEXICO

P R O P O S A L L I S T I N G

by
Baker Hughes INTEQ

Your ref : INITIAL PLAN, REV.#3
Our ref : prop2916
License :

Date printed : 21-Jul-97
Date created : 9-Jun-97
Last revised : 21-Jul-97

Field is centred on n36 50 0.000,w107 30 0
Structure is centred on n36 56 39.000,w107 38 21

Slot location is n36 56 45.476,w107 38 12.316
Slot Grid coordinates are N 2163657.238, E 557444.693
Slot local coordinates are 655.00 N 705.00 E

Projection type: mercator - New Mexico West (3003), Spheroid: Clarke - 1866

Reference North is True North

PHILLIPS PETROLEUM
 SEC. 5-T31N-R7W, SAN JUAN 32-7 #220
 SAN JUAN COUNTY, NEW MEXICO

PROPOSAL LISTING Page 1
 Your ref : INITIAL PLAN, REV.#3
 Last revised : 21-Jul-97

Measured Depth	Inclin. Degrees	Azimuth Degrees	True Depth	Vert	R E C T A N G U L A R C O O R D I N A T E S	Dogleg Deg/100ft	Vert Sect
0.00	0.00	329.57	0.00	0.00	0.00 E	0.00	0.00
500.00	0.00	329.57	500.00	0.00	0.00 E	0.00	0.00
600.00	0.00	329.57	600.00	0.00	0.00 E	0.00	0.00
700.00	5.00	329.57	699.87	3.76	2.21 W	5.00	4.36
800.00	10.00	329.57	798.99	15.01	8.82 W	5.00	17.41
900.00	15.00	329.57	896.58	33.67	19.77 W	5.00	39.05
1000.00	20.00	329.57	991.93	59.59	35.00 W	5.00	69.11
1100.00	25.00	329.57	1084.28	92.58	54.37 W	5.00	107.36
1175.29	28.76	329.57	1151.42	121.93	71.61 W	5.00	141.40
1500.00	28.76	329.57	1436.07	256.66	150.74 W	0.00	297.65
1600.00	28.76	329.57	1874.37	464.13	272.59 W	0.00	538.26
1500.00	28.76	329.57	2312.68	671.60	394.43 W	0.00	778.86
1669.16	28.76	329.57	2460.96	741.79	435.65 W	0.00	860.26
1727.97	27.00	329.57	2512.94	765.50	449.58 W	3.00	887.76
1827.97	24.00	329.57	2603.19	802.62	471.38 W	3.00	930.81
1927.97	21.00	329.57	2695.57	835.62	490.76 W	3.00	969.07
1027.97	18.00	329.57	2789.82	864.40	507.66 W	3.00	1002.45
1127.97	15.00	329.57	2885.69	888.89	522.04 W	3.00	1030.85
1227.97	12.00	329.57	2982.92	909.01	533.86 W	3.00	1054.19
1327.97	9.00	329.57	3081.23	924.72	543.09 W	3.00	1072.41
1427.97	6.00	329.57	3180.37	935.98	549.70 W	3.00	1085.46
1527.97	3.00	329.57	3280.05	942.74	553.67 W	3.00	1093.31
1627.97	0.00	329.57	3380.00	945.00	555.00 W	3.00	1095.92
1777.97	0.00	329.57	3530.00	945.00	555.00 W	0.00	1095.92

All data is in feet unless otherwise stated.
 Coordinates from SLOT #1 and TVD from rotary table.
 Bottom hole distance is 1095.92 on azimuth 329.57 degrees from wellhead.
 Vertical section is from wellhead on azimuth 329.57 degrees.
 Calculation uses the minimum curvature method.
 Presented by Baker Hughes INTEQ

PHILLIPS PETROLEUM
 SEC. 5-T31N-R7W, SAN JUAN 32-7 #220
 SAN JUAN COUNTY, NEW MEXICO

PROPOSAL LISTING Page 2
 Your ref : INITIAL PLAN, REV.#3
 Last revised : 21-Jul-97

MD	TVD	Rectangular Coords.	Comments in wellpath
=====			
			Comment
3627.97	3380.00	945.00 N 555.00 W	SJ 220
3777.97	3530.00	945.00 N 555.00 W	Total Depth

Top MD	Top TVD	Rectangular Coords.	Bot MD	Bot TVD	Rectangular Coords.	Casing
=====						
0.00	0.00	0.00N 0.00E	500.00	500.00	0.00N 0.00E	9 5/8 Surfa

Target name	Geographic Location	T.V.D.	Rectangular Coordinates	Revised
=====				
SJ 220		3380.00	945.00N 555.00W	9-Jun-97

Targets associated with this wellpath

Casing positions in string 'A'

PHILLIPS PETROLEUM CO.

SAN JUAN 32-7 #220
SW/4 SEC. 5, T.31 N., R. 7 W., N.M.P.M.,
SAN JUAN COUNTY, NEW MEXICO

6696

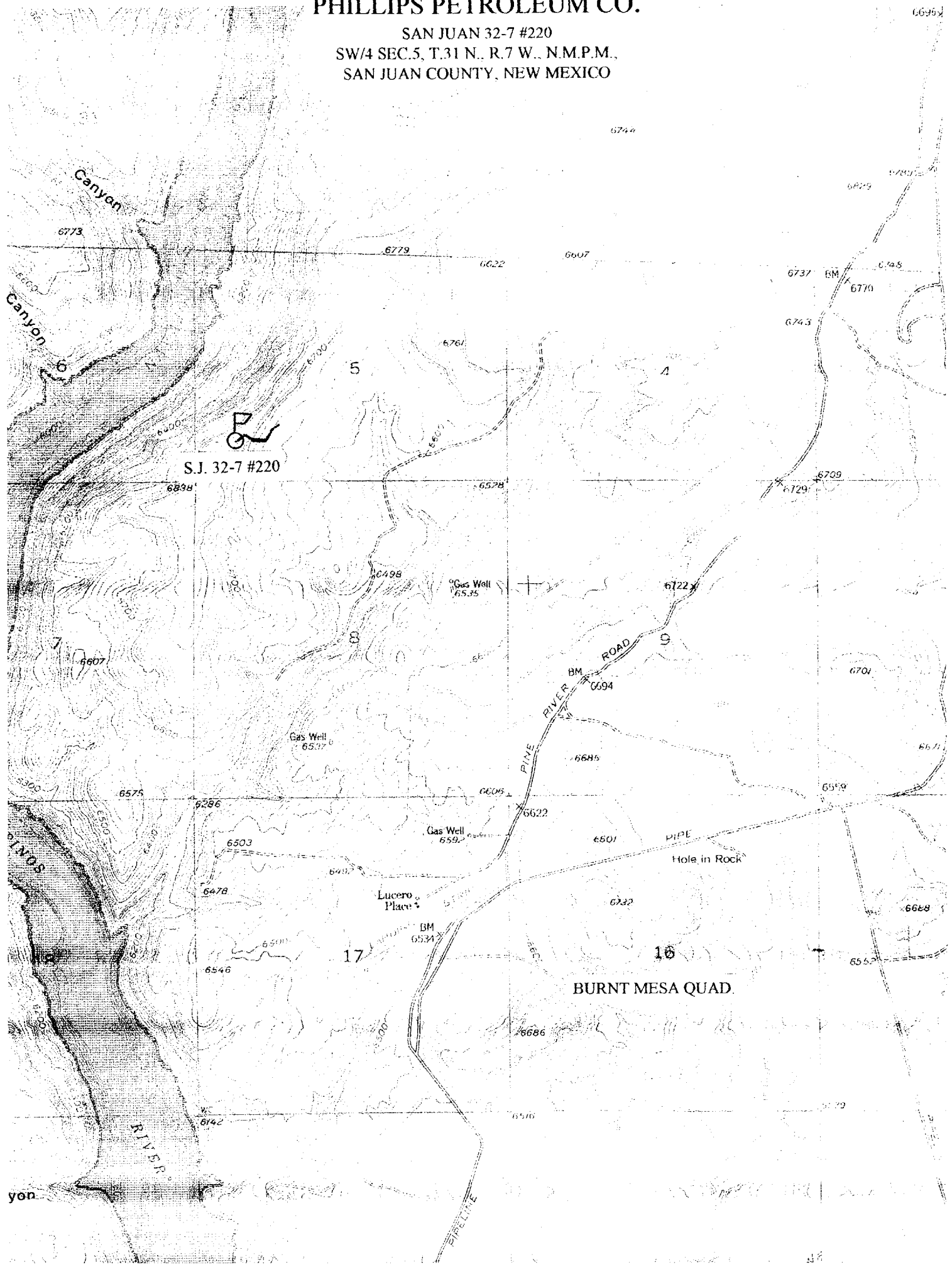

S.J. 32-7 #220

BURNT MESA QUAD.

yon