

District I
PO Box 1980, Hobbs, NM 88241-1980
District II
811 South First, Artesia, NM 88210
District III
1000 Rio Brazos Rd., Aztec, NM 87410
District IV
2040 South Pacheco, Santa Fe, NM 87505

State of New Mexico
Energy, Minerals & Natural Resources Department

OIL CONSERVATION DIVISION
2040 South Pacheco
Santa Fe, NM 87505

Form C-101
Revised October 18, 1994
Instructions on back
Submit to Appropriate District Office
State Lease - 6 Copies
Fee Lease - 5 Copies

CONFIDENTIAL

☐ AMENDED REPORT

APPLICATION FOR PERMIT TO DRILL, RE-ENTER, DEEPEN, PLUGBACK OR ADD A ZONE

Operator Name and Address. Richardson Operating Company 1700 Lincoln St., Suite 1700 Denver, CO 80203		RECEIVED DEC - 8 1998	OGRID Number 19219
Property Name WF State 16			API Number 30-045-29780
Property Code 3932	Well No. 1		

7 Surface Location									
UL or lot no.	Section	Township	Range	Lot Idn	Feet from the	North/South line	Feet from the	East/West line	County
M	16	30N	14W		930	South	1115	West	San Juan

8 Proposed Bottom Hole Location If Different From Surface									
UL or lot no.	Section	Township	Range	Lot Idn	Feet from the	North/South line	Feet from the	East/West line	County

Proposed Pool 1	Proposed Pool 2
Fruitland Coal	Pictured Cliffs

Work Type Code N	Well Type Code M	Cable/Rotary Rotary	Lease Type Code S	Ground Level Elevation 5617'
Multiple Yes	Proposed Depth 1400'	Formation Pictured Cliffs	Contractor L & B Speed Drill	Spud Date 12-15-98

21 Proposed Casing and Cement Program					
Hole Size	Casing Size	Casing weight/foot	Setting Depth	Sacks of Cement	Estimated TOC
8 3/4"	7"	20#	130'	35 Sacks	Surface
6 1/4"	4 1/2"	10.5#	1400'	175 Sacks	Surface

22 Describe the proposed program. If this application is to DEEPEN or PLUG BACK give the data on the present productive zone and proposed new productive zone. Describe the blowout prevention program, if any. Use additional sheets if necessary.

A 2000 psi rated blowout prevention system will be used consisting of both blind rams and pipe rams.

CONFIDENTIAL

I hereby certify that the information given above is true and complete to the best of my knowledge and belief. Signature: <i>Cathleen Colby</i> Printed name: Cathleen Colby Title: Land Manager Date: 12-4-98		OIL CONSERVATION DIVISION Approved by: <i>Genie Busch</i> 12-18-98 Title: DEPUTY CHIEF OF BUREAU, DIST. #3 Approval Date: DEC 10 1998 Expiration Date: DEC 10 1999 Conditions of Approval: Attached <input type="checkbox"/>	
Phone: (303) 830-8000			

C-101 Instructions

Measurements and dimensions are to be in feet/inches. Well locations will refer to the New Mexico Principal Meridian.

IF THIS IS AN AMENDED REPORT CHECK THE BOX LABELED "AMENDED REPORT" AT THE TOP OF THIS DOCUMENT.

authorized to make this report. The date this report was signed and the telephone number to call for questions about this report.

- 1 Operator's OGRID number. If you do not have one it will be assigned and filled in by the District office.
- 2 Operator's name and address
- 3 API number of this well. If this is a new well the OCD will assign the number and fill this in.
- 4 Property code. If this is a new property the OCD will assign the number and fill it in.
- 5 Property name that used to be called 'well name'
- 6 The number of this well on the property.
- 7 The surveyed location of this well New Mexico Principal Meridian. NOTE: If the United States government survey designates a Lot Number for this location use that number in the 'UL or lot no.' box. Otherwise use the OCD Unit Letter.
- 8 The proposed bottom hole location of this well at TD
- 9 and 10 The proposed pool(s) to which this well is being drilled.
- 11 Work type code from the following table:

N	New well
E	Re-entry
D	Drill deeper
P	Plugback
A	Add a zone
- 12 Well type code from the following table:

O	Single oil completion
G	Single gas completion
M	Multiple completion
I	Injection well
S	SWD well
W	Water supply well
C	Carbon dioxide well
- 13 Cable or rotary drilling code

C	Propose to cable tool drill
R	Propose to rotary drill
- 14 Lease type code from the following table:

S	State
P	Private
- 15 Ground level elevation above sea level
- 16 Intend to multiple complete? Yes or No
- 17 Proposed total depth of this well
- 18 Geologic formation at TD
- 19 Name of the intended drilling company if known.
- 20 Anticipated spud date.
- 21 Proposed hole size ID inches, proposed casing OD inches, casing weight in pounds per foot, setting depth of the casing or depth and top of liner, proposed cementing volume, and estimated top of cement
- 22 Brief description of the proposed drilling program and BOP program. Attach additional sheets if necessary.
- 23 The signature, printed name, and title of the person

District I
PO Box 1980, Hobbs, NM 88241-1980
District II
PO Drawer DD, Artesia, NM 88211-0719
District III
1000 Rio Brazos Rd., Aztec, NM 87410
District IV
PO Box 2088, Santa Fe, NM 87504-2088

State of New Mexico
Energy, Minerals & Natural Resources Department

OIL CONSERVATION DIVISION
PO Box 2088
Santa Fe, NM 87504-2088

Form C-102
Revised February 21, 1994
Instructions on back
Submit to Appropriate District Office
State Lease - 4 Copies
Fee Lease - 3 Copies

CONFIDENTIAL

☐ AMENDED REPORT

WELL LOCATION AND ACREAGE DEDICATION PLAT

¹ APT Number 30-045-29750		² Pool Code 71629/96863		³ Pool Name BASIN FRUITLAND COAL WELLOCAT 30N14W16M, PICTURED CLIFFS	
⁴ Property Code 23932		⁵ Property Name WF State			⁶ Well Number 16 - 1
⁷ OGRID No. 019219		⁸ Operator Name RICHARDSON OPERATING CO.			⁹ Elevation 5617'

¹⁰ Surface Location



UL or lot no.	Section	Township	Range	Lot Idn	Feet from the	North/South line	Feet from the	East/West line	County
M	16	30 N.	14 W.		930	South	1115	West	San Juan

¹¹ Bottom Hole Location If Different From Surface

UL or lot no.	Section	Township	Range	Lot Idn	Feet from the	North/South line	Feet from the	East/West line	County

¹² Dedicated Acres 320 160	¹³ Joint or Infill	¹⁴ Consolidation Code	¹⁵ Order No.
---	-------------------------------	----------------------------------	-------------------------

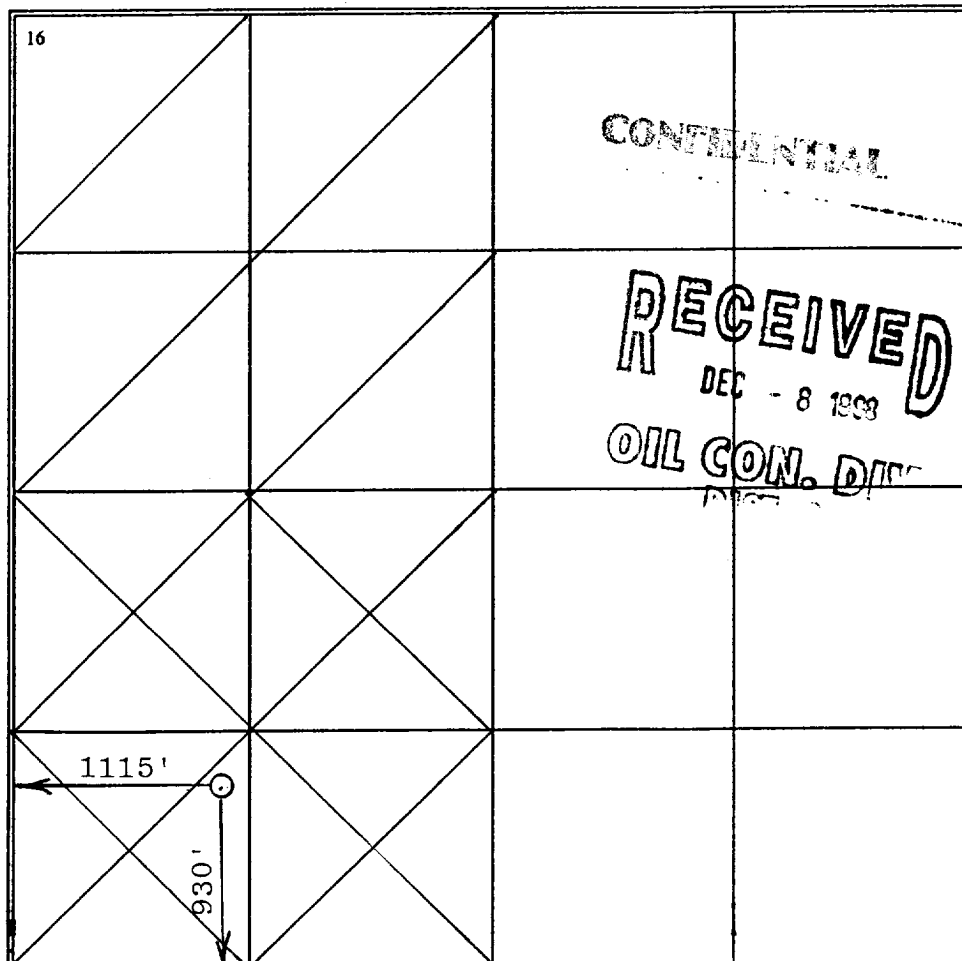
NO ALLOWABLE WILL BE ASSIGNED TO THIS COMPLETION UNTIL ALL INTERESTS HAVE BEEN CONSOLIDATED
OR A NON-STANDARD UNIT HAS BEEN APPROVED BY THE DIVISION

<div>16</div> 	<div>¹⁷ OPERATOR CERTIFICATION I hereby certify that the information contained herein is true and complete to the best of my knowledge and belief Cathleen Colby Signature Cathleen Colby Printed Name Land Manager Title 12-4-98 Date</div> <div>¹⁸ SURVEYOR CERTIFICATION I hereby certify that the well location shown on this plat was plotted from field notes of actual surveys made by me or under my supervision, and that the same is true and correct to the best of my belief. Date of Survey Signature and Seal of Professional Surveyor:  Certificate Number</div>
--	--



Fruitland Coal

Pictured Cliffs

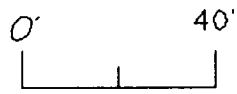

Scale 1" = 40'

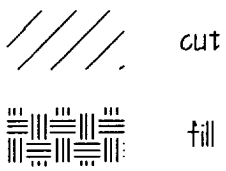

□ set stake & lath

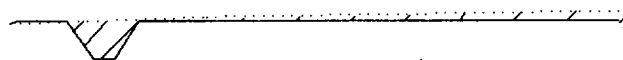
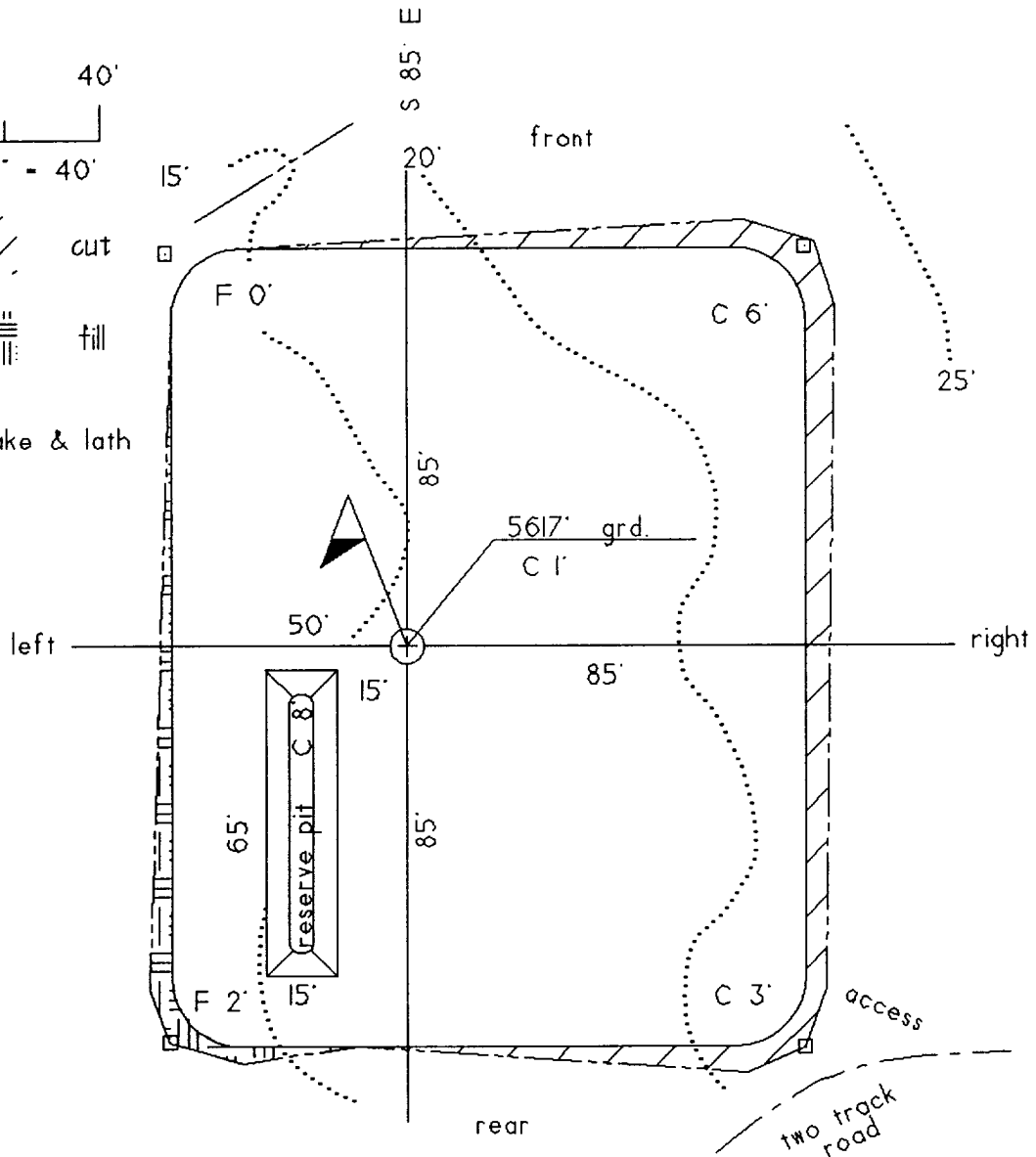

section

Township 30 North Range 14 West County San Juan State NM

W/2 - Section 16 Leases

ST NM B11242-47									
ST NM B11571-54									
ST NM E3149-6		ST NM V4832							
		ST NM E70-39							