

District I  
PO Box 1980, Hobbs, NM 88241-1980  
District II  
811 S. 1st Street, Artesia, NM 88210-2834  
District III  
1000 Rio Brazos Rd., Aztec, NM 87410  
District IV  
2040 South Pacheco, Santa Fe, NM 87505

State of New Mexico  
Energy, Minerals & Natural Resources Department

OIL CONSERVATION DIVISION  
2040 South Pacheco  
Santa Fe, NM 87505

Form C-101  
Revised October 18, 1999  
Instructions on back  
Submit to Appropriate District Office  
State Lease - 6 Copies  
Fee Lease - 5 Copies

☒ AMENDED REPORT  
LOCATION

APPLICATION FOR PERMIT TO DRILL, RE-ENTER, DEEPEN, PLUGBACK, OR ADD A ZONE

<sup>1</sup> Operator name and Address Cross Timbers Operating Company 2700 Farmington Ave., Bldg. K. Ste 1 Farmington, NM 87401		<sup>2</sup> OGRID Number 167067
<sup>4</sup> Property Code 26050	<sup>5</sup> Property Name Aztec Com 4	<sup>3</sup> API Number 30-0 45-30273
		<sup>6</sup> Well No. #1E

<sup>7</sup> Surface Location									
UL or lot no.	Section	Township	Range	Lot. Idn	Feet from the	North/South Line	Feet from the	East/West line	County
M	16	30N	11W		1,050	South	870	West	San Juan

<sup>8</sup> Proposed Bottom Hole Location If Different From Surface									
UL or lot no.	Section	Township	Range	Lot. Idn	Feet from the	North/South Line	Feet from the	East/West line	County
<sup>9</sup> Proposed Pool 1 Basin Dakota					<sup>10</sup> Proposed Pool 2 Blanco Mesaverde				

<sup>11</sup> Work Type Code N	<sup>12</sup> Well Type Code G	<sup>13</sup> Cable/Rotary R	<sup>14</sup> Lease Type Code P	<sup>15</sup> Ground Level Elevation 5,667' Ground Level
<sup>16</sup> Multiple Yes	<sup>17</sup> Proposed Depth 6,900'	<sup>18</sup> Formation Dakota	<sup>19</sup> Contractor Not yet awarded	<sup>20</sup> Spud Date Summer, 2000

<sup>21</sup> Proposed Casing and Cement Program					
Hole Size	Casing Size	Casing weight/foot	Setting Depth	Sacks of Cement	Estimated TOC
12-1/4"	8-5/8"	24.0 #/ft	400'	180 sx	Surface
7-7/8"	4-1/2"	10.5 #/ft	6,900'—	1,175 sx	Surface

<sup>22</sup> Describe the proposed program. If this application is to DEEPEN or PLUG BACK give the data on the present productive zone and proposed new productive zone. Describe the blowout prevention program, if any. Use additional sheets if necessary.

Drill to 400' Run new 8-5/8" csg. Cmt csg w/280 sx cl "B" cmt (15.6 ppg, 1.18 cuft/sx) w/2% CaCl & 1/4# Celloflake. Attempt to circ cmt to surface. NU BOP. Test BOP. Mix mud. Drill ahead w/7-7/8 hole.

Drill to TD (@ 6,900'). Log well. Run new 4-1/2" csg to btm. Cmt csg with approx 1,025 sx Premium Lite cmt (65% cmt, 35% Poz, 6% gel) w/1/4# celloflake @ 12.5 ppg, 2.07 cuft/sx followed by 150 sx cl "H" cmt (neat) @ 15.6 ppg, 1.18 cuft/sx. Attempt to circ cmt to surface.

See enclosed drawing for BOP stack configuration.

<sup>23</sup> I hereby certify that the information given above is true and complete to the best of my knowledge and belief.

Signature: *[Signature]*

Printed name:

Title: Drilling Engineer

OIL CONSERVATION DIVISION

Approved by: *[Signature]*

Title: DEPUTY OIL & GAS INSPECTOR, DIST. 3

Approval Date: AUG 21 2000

Expiration Date: AUG 21 2001

District I  
PO Box 1980, Hobbs, NM 88241-1980

District II  
PO Drawer DD, Artesia, NM 88211-0719

District III  
1000 Rio Brazos Rd., Aztec, NM 87410

District IV  
PO Box 2088, Santa Fe, NM 87504-2088

State of New Mexico  
Energy, Minerals & Natural Resources Department

OIL CONSERVATION DIVISION  
PO Box 2088  
Santa Fe, NM 87504-2088

Form C-102

Revised February 21, 1994

Instructions on back

Submit to Appropriate District Office

State Lease - 4 Copies

Fee Lease - 3 Copies

☐ AMENDED REPORT

WELL LOCATION AND ACREAGE DEDICATION PLAT

*API Number 30-045-30273		*Pool Code 71599 72319		*Pool Name BASIN DAKOTA Blanco MV	
*Property Code 26050		*Property Name AZTEC COM 4			*Well Number 1E
*OGRID No. 167067		*Operator Name CROSS TIMBERS OPERATING COMPANY			*Elevation 5667'

10 Surface Location

UL or lot no.	Section	Township	Range	Lot Idn	Feet from the	North/South line	Feet from the	East/West line	County
M	16	30N	11W		1050	SOUTH	870	WEST	SAN JUAN

11 Bottom Hole Location If Different From Surface

UL or lot no.	Section	Township	Range	Lot Idn	Feet from the	North/South line	Feet from the	East/West line	County
12 Dedicated Acres W/2 320		13 Joint or Infill I		14 Consolidation Code		15 Order No.			

NO ALLOWABLE WILL BE ASSIGNED TO THIS COMPLETION UNTIL ALL INTERESTS HAVE BEEN CONSOLIDATED  
OR A NON-STANDARD UNIT HAS BEEN APPROVED BY THE DIVISION

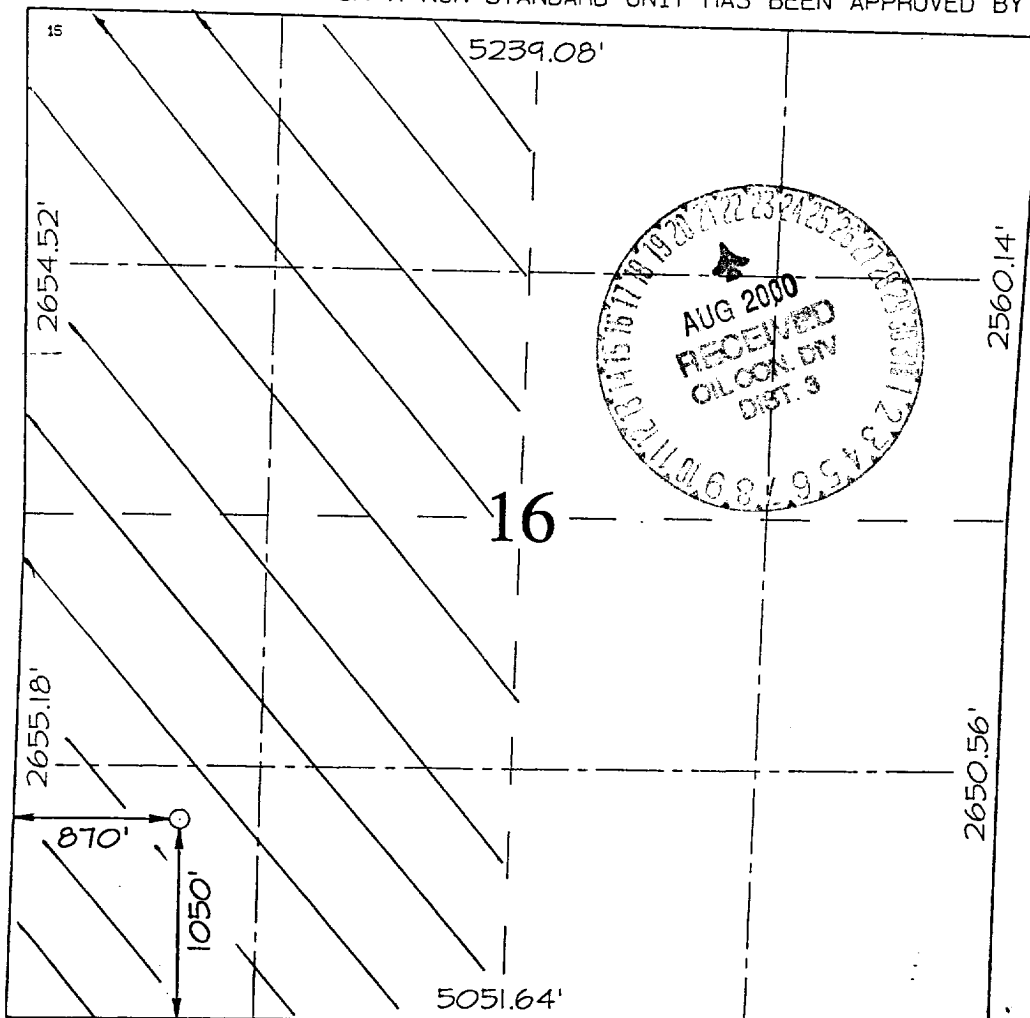

17 OPERATOR CERTIFICATION

I hereby certify that the information contained herein is true and complete to the best of my knowledge and belief.

Signature: *Jeff Patton*  
Printed Name: Jeff Patton  
Title: Production Engineer  
Date: 8/17/00

18 SURVEYOR CERTIFICATION

I hereby certify that the well location shown on this plat was plotted from field notes of actual surveys made by me or under my supervision, and that the same is true and correct to the best of my belief.

AUGUST 7, 2000  
Date of Survey  
Signature and Seal of Registered Professional Surveyor  
*Neale C. Edwards*  
Certificate No. 6857

CROSS TIMBERS OPERATING COMPANY AZTEC COM 4 #1E  
1050' FSL & 870' FWL, SECTION 16, T30N, R11W, N.M.P.M.  
SAN JUAN COUNTY, NEW MEXICO

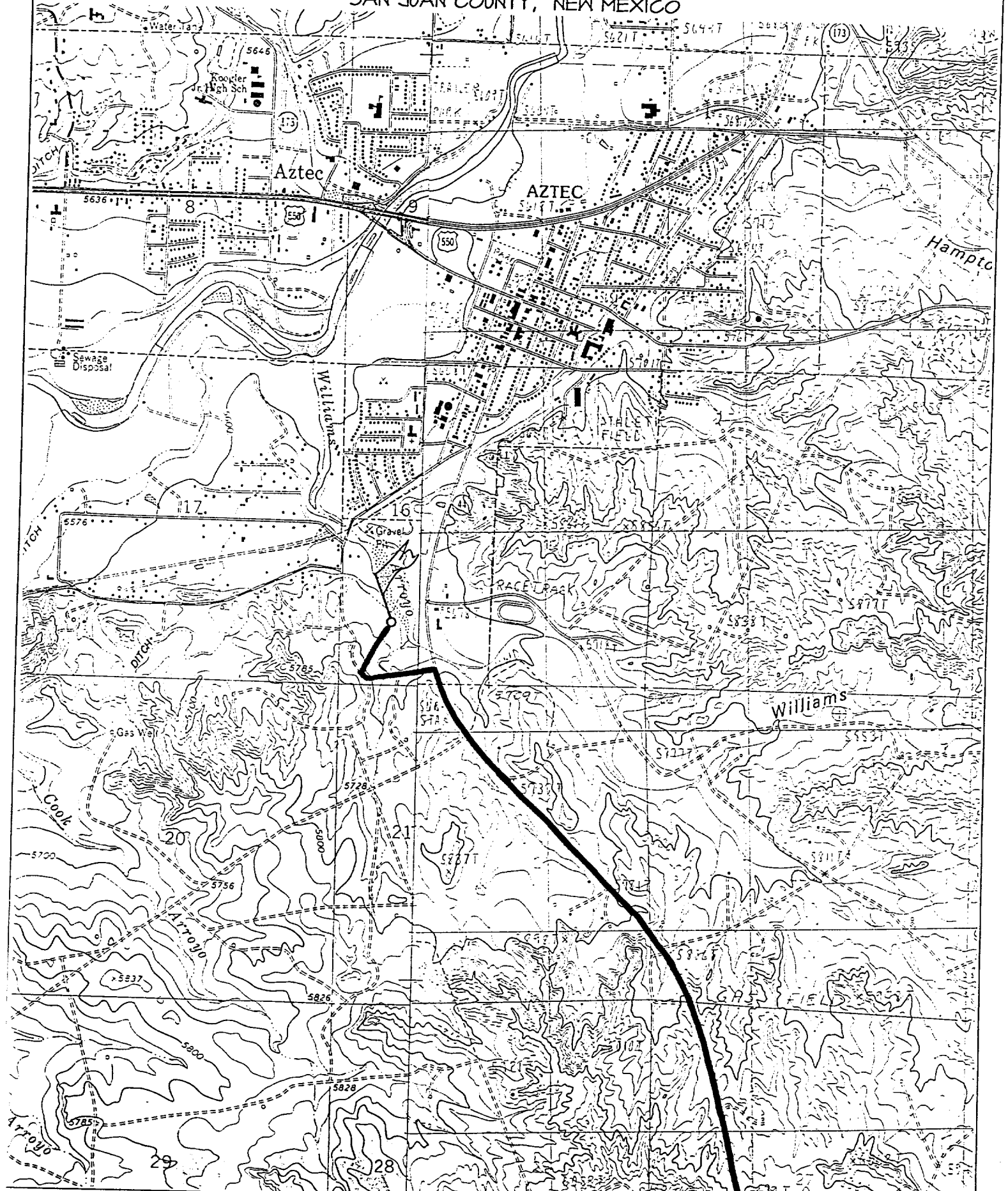

**BOPE SCHEMATIC FOR DRILLING OPERATIONS**  
**CLASS 1 - NORMAL PRESSURE**  
**CROSS TIMBERS OPERATING COMPANY STANDARD**

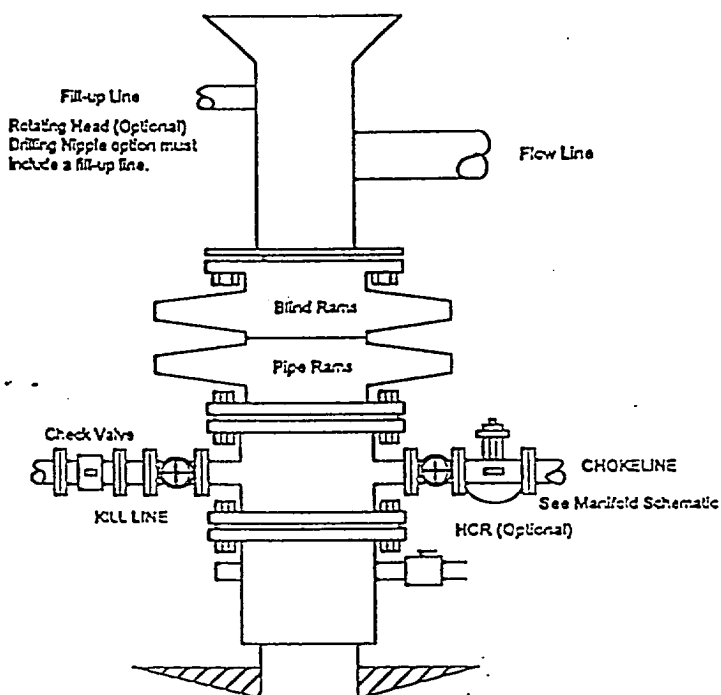

**CHOKE MANIFOLD SCHEMATIC FOR DRILLING OPERATIONS**  
**2M SERVICE**  
**CROSS TIMBERS OPERATING COMPANY STANDARD**

