

District I
1625 N. French Dr., Hobbs, NM 88240
District II
811 South First, Artesia, NM 88210
District III
1000 Rio Brazos Road, Aztec, NM 87410
District IV
2040 South Pacheco, Santa Fe, NM 87505

State of New Mexico
Energy Minerals and Natural Resources

Oil Conservation Division
2040 South Pacheco
Santa Fe, NM 87505

Form C-101
Revised March 17, 1999

Submit to appropriate District Office
State Lease - 6 Copies
Fee Lease - 5 Copies

☐ AMENDED REPORT

APPLICATION FOR PERMIT TO DRILL, RE-ENTER, DEEPEN, PLUGBACK, OR ADD A ZONE

¹ Operator Name and Address Merrion Oil & Gas Corporation		² OGRID Number 014634
		³ API Number 30 - 045 - 30429
³ Property Code 26929	⁵ Property Name Knight Com	⁶ Well No. 1

⁷ Surface Location

UL or lot no.	Section	Township	Range	Lot Idn	Feet from the	North/South line	Feet from the	East/West line	County
M	36	30N	13W	sw sw	417	South	860	West	San Juan

⁸ Proposed Bottom Hole Location If Different From Surface

UL or lot no.	Section	Township	Range	Lot Idn	Feet from the	North/South line	Feet from the	East/West line	County
⁹ Proposed Pool 1 Fulcher Kutz PC					¹⁰ Proposed Pool 2				

¹¹ Work Type Code N	¹² Well Type Code G	¹³ Cable/Rotary R	¹⁴ Lease Type Code S	¹⁵ Ground Level Elevation 5545'
¹⁶ Multiple No	¹⁷ Proposed Depth 1700'	¹⁸ Formation Pictured Cliffs	¹⁹ Contractor L&B Speed Drill	²⁰ Spud Date When Permitted

²¹ Proposed Casing and Cement Program

Hole Size	Casing Size	Casing weight/foot	Setting Depth	Sacks of Cement	Estimated TOC
8 1/2"	7"	23 ppf	120'	50 sx	Surface
6 1/2"	4 1/2"	10.5 ppf	1700'	160 sx	Surface

²² Describe the proposed program. If this application is to DEEPEN or PLUG BACK, give the data on the present productive zone and proposed new productive zone. Describe the blowout prevention program, if any. Use additional sheets if necessary.

Merrion proposes to drill 8 1/2" surface hole with native mud to approx. 120' and set 7" 23 ppf J55 surface casing, cement to surface with ~50 sx 'H' w/ 2% CaCl₂ (59 cuft). Will drill 6 1/2" hole to TD @ approx. 1700' KB with low solids non-dispersed mud. Run open hole surveys. Will set 4 1/2" 10.5 ppf J55 production casing from TD to surface. Will cement with ~100 sx 'B' 2% SMS (206 cuft) and tail in with 60 sx 'B' 2% Gel (73 cuft) cement to fill from total depth to surface (Will adjust volumes based upon caliper log). If cement does not reach surface, a temperature log or cement-bond log will be run to find top of cement.

Will test Pictured Cliffs through perforated casing. Will fracture stimulate and put on production test. Drilling operations below surface casing will be conducted with a bag-type BOP in place, minimum working-pressure - 1000 psig.

This well is located within the city limits of Farmington and a city special use permit and Oil & Gas permit will be obtained prior to commencing drilling.

A second well, the Heights Com 1E Dakota, will be drilled on the same pad.

Tops: Ojo Alamo - Surface, Kirtland - 13', Fruitland - 1105', Pictured Cliffs - 1478'.

²³ I hereby certify that the information given above is true and complete to the best of my knowledge and belief.

Signature: 

Printed name: Steven S. Dunn

Title: Drilling & Production Manager

Date: November 15, 2000

Phone: 505.327.9801

OIL CONSERVATION DIVISION

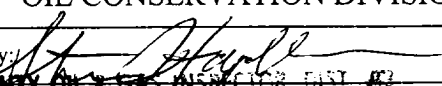
Approved by: 

Title: **DEPUTY OIL & GAS INSPECTOR DIST. #3**

Approval Date: **NOV 17 2000**

Expiration Date: **NOV 17 2001**

Conditions of Approval:

Attached ☐

NSL

OL CONSERVATION DIVISION
2040 South Pacheco
Santa Fe, NM 87505

☐ AMENDED REPORT

WELL LOCATION AND ACREAGE DEDICATION PLAT

APN Number 30-045-30129	Pool Code 77200 -	Pool Name Fulcher Kutz pictured cliffs
Property Code 26929	Property Name KNIGHT COM	Well Number 1
GRID No. 014634	Operator Name MERRION OIL & GAS	Elevation 5545' -

Surface Location							
UL or Lot M	Sec. 36	Twp. 30 N.	Rge. 13 W.	Lot Id. SW SW	Feet from North/South 417	Feet from East/West 860	County SAN JUAN

Section Hole Location if Different From Surface							
UL or Lot	Sec.	Twp.	Rge.	Lot Id.	Feet from North/South	Feet from East/West	County
Dedication 160	Joint? Y	Consolidation C	Order No. Communitization in progress				

NO ALLOWABLE WELL ASSIGNED TO THIS COMPLETION UNTIL ALL INTERESTS HAVE BEEN CONSOLIDATED
OR A NON-STANDARD UNIT HAS BEEN APPROVED BY THE DIVISION

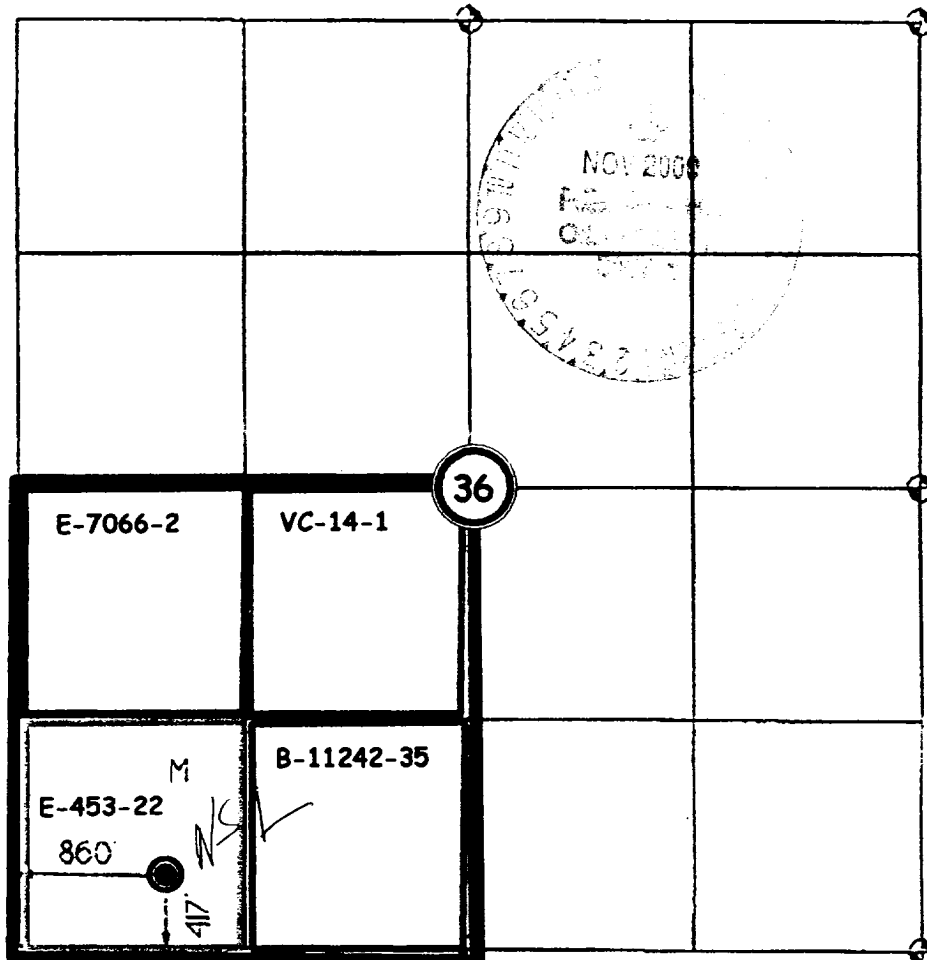

OPERATOR CERTIFICATION I hereby certify that the information contained herein is true and complete to the best of my knowledge and belief. Signature: <i>Steven S. Dunn</i> Printed Name: Steven S. Dunn Title: Drilling & Production Manager Date: November 15, 2000	
SURVEYOR CERTIFICATION I hereby certify that the well location on this plat was plotted from field notes of actual surveys made by me or under my supervision, and that the same is true and correct to the best of my belief. Date of Survey: 10 NOVEMBER 2000 Signature: <i>James H. Heston</i> Professional Seal: 6844 REGISTERED LAND SURVEYOR	