

NEW MEXICO OIL CONSERVATION COMMISSION
Santa Fe, New Mexico

Form C-101
Revised (12/1/55)

NOTICE OF INTENTION TO DRILL

Notice must be given to the District Office of the Oil Conservation Commission and approval obtained before drilling or recompletion begins. If changes in the proposed plan are considered advisable, a copy of this notice showing such changes will be returned to the sender. Submit this notice in QUINTUPLICATE. One copy will be returned following approval. See additional instructions in Rules and Regulations of the Commission. If State Land submit 6 Copies Attach Form C- 128 in triplicate to first 3 copies of form C-101

Farmington, New Mexico

June 18, 1959

(Place)

(Date)

OIL CONSERVATION COMMISSION
SANTA FE, NEW MEXICO

Gentlemen:

You are hereby notified that it is our intention to commence the Drilling of a well to be known as
La Plata Gathering System, Inc.

(Company or Operator)

San Juan Unit 32-5

Well No. 1-32

Unit N

The well is

(Lease)

(Unit)

located 1,650 feet from the South West line and 1,105 feet from the

South

Line of Section 32, T 32-N, R 5-W, NMPM.

(GIVE LOCATION FROM SECTION LINE)

Undesignated Blaine Pool, Rio Arriba County

If State Land the Oil and Gas Lease is No. 346-23

If patented land the owner is

Address

We propose to drill well with drilling equipment as follows:

Rotary tools

The status of plugging bond is On file in Santa Fe

Drilling Contractor San Juan Drilling Company

We intend to complete this well in the Mesa Verde

formation at an approximate depth of 6,000 feet.

CASING PROGRAM

We propose to use the following strings of Casing and to cement them as indicated:

Size of Hole	Size of Casing	Weight per Foot	New or Second Hand	Depth	Sacks Cement
12-1/4	9-5/8	36#	New	175	150
8-3/4	5-1/2	17#	New	6000	150
-	2-3/8	Tubing	Ne	6000	None

If changes in the above plans become advisable we will notify you immediately.

ADDITIONAL INFORMATION (If recompletion give full details of proposed plan of work.)

Approved
Except as follows:

6-19, 1959

Sincerely yours,

LA PLATA GATHERING SYSTEM, Inc.

(Company or Operator)

By

C. Beeson Neal, Agent in Farmington

Position Send Communications regarding well to

Name C. Beeson Neal

Address Box 728 - Farmington, New Mexico.

OIL CONSERVATION COMMISSION

By

NEW MEXICO OIL CONSERVATION COMMISSION
WELL LOCATION AND ACREAGE DEDICATION PLAT

FORM C-128
Revised 5/1/57

SEE INSTRUCTIONS FOR COMPLETING THIS FORM ON THE REVERSE SIDE

SECTION A

Operator LA PLATA GATHERING SYSTEM			Lease San Juan 32-5 Unit		Well No. 1-32
Unit Letter N	Section 32	Township 32 NORTH	Range 5 WEST	County RIO ARriba	
Actual Footage Location of Well: 1105 feet from the SOUTH line and 1650 feet from the WEST line					
Ground Level Elev. 6454.3	Producing Formation Mesa Verde		Pool Undesignated		Dedicated Acreage: 320 Acres

1. Is the Operator the only owner in the dedicated acreage outlined on the plat below? YES _____ NO ☒ . ("Owner" means the person who has the right to drill into and to produce from any pool and to appropriate the production either for himself or for himself and another. (65-3-29 (e) NMSA 1935 Comp.)
2. If the answer to question one is "no," have the interests of all the owners been consolidated by communication agreement or otherwise? YES ☒ NO _____. If answer is "yes," Type of Consolidation Communitization
3. If the answer to question two is "no," list all the owners and their respective interests below:

Owner	Land Description

RECEIVED

JUN 19 1959

OIL CON. COM.
DIST. 3

SECTION B

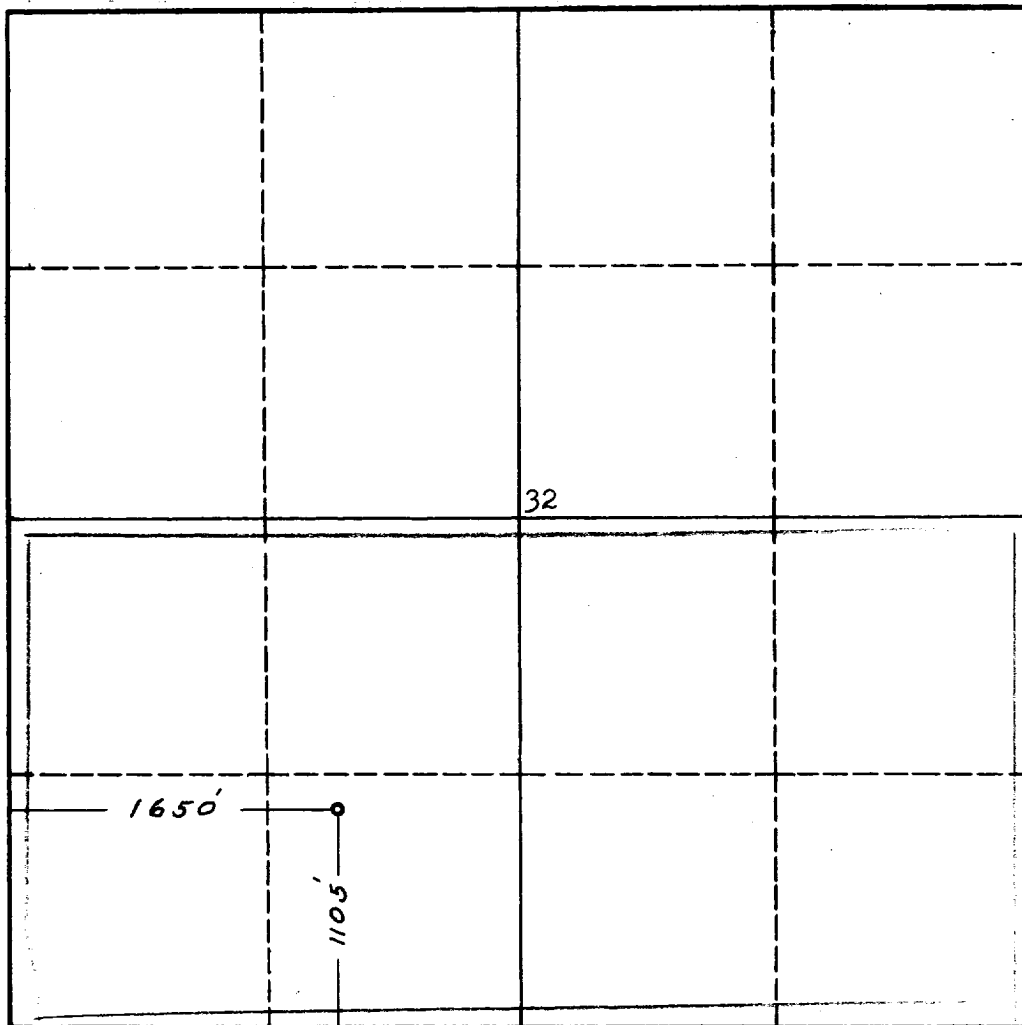

CERTIFICATION

I hereby certify that the information in SECTION A above is true and complete to the best of my knowledge and belief.

Name
C. Beeson Neal, Agent
Position
La Plata Gathering System, Inc.
Company
C. Beeson Neal
Date
June 18, 1959

I hereby certify that the well location shown on the plat in SECTION B was plotted from field notes of actual surveys made by me or under my supervision, and that the same is true and correct to the best of my knowledge and belief.

Date Surveyed
23 March 1959
Registered Professional Engineer
and/or Land Surveyor
James P. Leese
James P. Leese

Certificate No. 1463

0 330 660 990 1320 1650 1980 2310 2640 2000 1500 1000 500 0

INSTRUCTIONS FOR COMPLETION OF FORM C-128

1. Operator shall furnish and certify to the information called for in Section A.
2. Operator shall outline the dedicated acreage for *both* oil and gas wells on the plat in Section B.
3. A registered professional engineer or land surveyor registered in the State of New Mexico or approved by the Commission shall show on the plat the location of the well and certify this information in the space provided.
4. All distances shown on the plat must be from the outer boundaries of the Section.
5. If additional space is needed for listing owners and their respective interests as required in question 3 of Section A, please use space below.

OIL CONSERVATION COMMISSION		
ACTING DISTRICT OFFICE		
COUNTY OF SHERMAN		
1	1	
2	2	
1	1	✓