

# NOTICE OF INTENTION TO DRILL

Notice must be given to the District Office of the Oil Conservation Commission and approval obtained before drilling or recompletion begins. If changes in the proposed plan are considered advisable, a copy of this notice showing such changes will be returned to the sender. Submit this notice in QUINTUPLICATE. One copy will be returned following approval. See additional instructions in Rules and Regulations of the Commission. If State Land submit 6 Copies Attach Form C- 128 in triplicate to first 3 copies of form C-101

~~xx~~ Farmington, New Mexico  
(Place)

October 24, 1962  
(Date)

OIL CONSERVATION COMMISSION  
SANTA FE, NEW MEXICO

Gentlemen:

You are hereby notified that it is our intention to commence the Drilling of a well to be known as  
~~San Juan 32-5 Unit (Well No. 3-24)~~ La Plata Gathering System, Inc.

San Juan 32-5 Unit  
(Lease)

(Company, or Operator)

, Well No. 3-24, in L (Unit) The well is

located 1,850 feet from the South line and 790 feet from the

West line of Section 24, T. 32-N, R. 6-W, NMPM.

(GIVE LOCATION FROM SECTION LINE) Blanco Mesa Verde Pool, Rio Arriba County

If State Land the Oil and Gas Lease is No.

If patented land the owner is Amerante D. Quintano  
Address Rosa, New Mexico

We propose to drill well with drilling equipment as follows:  
Botary Drilling Tools

The status of plugging bond is On file in Santa Fe

Drilling Contractor Gardner Brothers

We intend to complete this well in the Mesa Verde  
formation at an approximate depth of 5900 feet.

## CASING PROGRAM

We propose to use the following strings of Casing and to cement them as indicated:

Size of Hole	Size of Casing	Weight per Foot	New or Second Hand	Depth	Sacks Cement
12-1/4"	8-5/8"	24#	New	600'	350
7-7/8"	4-1/2"	10.5#	New	5,900	300
	2-3/8" Tubing	- For production			

If changes in the above plans become advisable we will notify you immediately.

ADDITIONAL INFORMATION (If recompletion give full details of proposed plan of work.)

This supersedes Notice of Intention to drill a well to the Mesa Verde in the N/W quarter of this section - filed with the United States Geological Survey on September 30, 1962.

Approved: 10-25, 1962  
Except as follows:

OIL CONSERVATION COMMISSION

By: *Emery*

Sincerely yours,

LA PLATA GATHERING SYSTEM, INC.  
(Company, or Operator)

By: *E. Beeson Neal*  
Position E. Beeson Neal, Agent in Farmington

Send Communications regarding well to  
C. Beeson Neal

Name  
Address Box 728 - Farmington, New Mexico

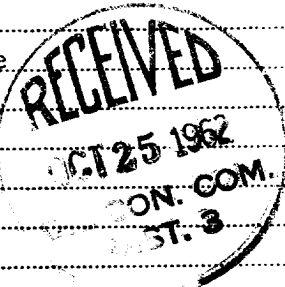

## Well Location and Acreage Dedication Plat

Section A.

Date October 24, 1962

Operator LA PLATA GATHERING SYSTEM Lease 32-5  
 Well No. 3-24 Unit Letter L Section 24 Township 32 NORTH Range 6 WEST NMPM  
 Located 1850' Feet From SOUTH Line, 790' Feet From WEST Line  
 County RIO ARriba G. L. Elevation 6356.2 Dedicated Acreage 320 Acres  
 Name of Producing Formation Mesa Verde Pool Mesa Verde

1. Is the Operator the only owner in the dedicated acreage outlined on the plat below?

Yes \_\_\_\_\_ No X2. If the answer to question one is "no", have the interests of all the owners been consolidated by communization agreement or otherwise? Yes X No \_\_\_\_\_. If answer is "yes", Type of Consolidation. Unitization

3. If the answer to question two is "no", list all the owners and their respective interests below:

Owner

Land Description

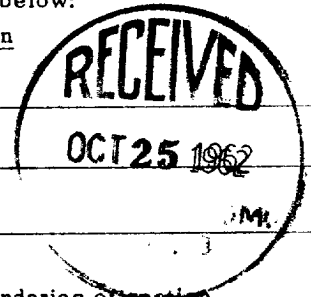

## Section B.

Note: All distances must be from outer boundaries of section.

This is to certify that the information  
 in Section A above is true and complete  
 to the best of my knowledge and belief.

LA PLATA GATHERING SYSTEM, INC.

Operator

(Representative)

C. Deeson Neal, Agent in Farmington

(Address)

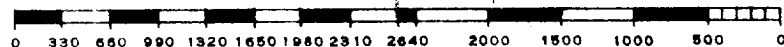
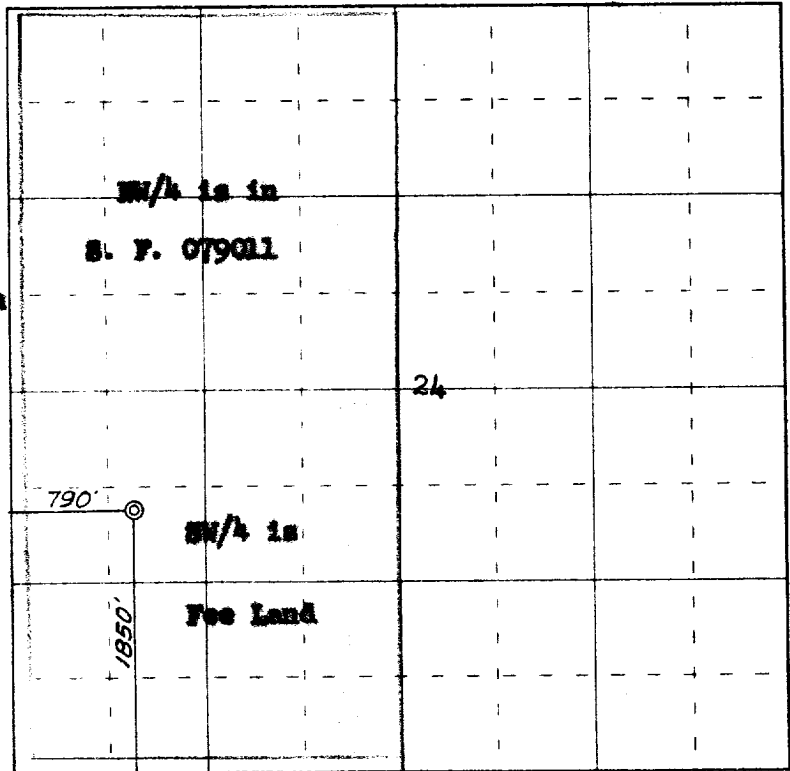
P. O. Box 728Farmington, New Mexico

Scale 4 inches equal 1 mile

This is to certify that the above plat was prepared from field notes of actual surveys  
 made by me or under my supervision and that the same are true and correct to the best  
 of my knowledge and belief.

(Seal)

Farmington, New Mexico

Date Surveyed 23 October, 1962

James P. Leese  
 Registered Professional Engineer and/or Land Surveyor  
 James P. Leese N. Mex. Reg. No. 1463  
 San Juan Engineering Company