

LA PLATA GATHERING SYSTEM, INC.

1940 MERCANTILE DALLAS BUILDING

DALLAS 1, TEXAS

September 13, 1963

C
Mr. A. L. Porter, Jr., Secretary
New Mexico Oil Conservation Commission
P. O. Box 791
Santa Fe, New Mexico

O
Re: Application for Administrative
Approval for an Unorthodox Well
Located in the Basin Dakota and
Blanco Mesaverde Pools for the
Proposed San Juan 32-5 Unit Well
No. 1-20

P
Dear Mr. Porter:

Y
La Plata Gathering System, Inc. hereby requests administrative approval for an exception to Rule 104(d)(2) for an unorthodox well location in the Basin Dakota and Blanco Mesaverde Pools for the proposed San Juan 32-5 Unit Well No. 1-20 to be drilled at a location 2558 feet from South line and 400 feet from West line Section 20, Township 32 North, Range 5 West, Rio Arriba County, New Mexico.

Because of the extremely mountainous terrain, any location in the West half of Section 20, Township 32 North, Range 5 West, Rio Arriba County, New Mexico, must lie in a narrow valley running approximately East and West and bisecting the section. A normally dry creek bed drains the valley and runs along its South side. This creek runs a very large volume of water during rainy weather and has created a large network of deep gullies. An extremely large amount of money would be necessary to build and maintain roads and location either in the mountainous terrain or in the aforementioned creek bed. Any orthodox location in the West half of Section 20 would lie in one of these unsuitable areas. A plat of the proposed location is attached hereto as well as a surveyor's plat of the topographic conditions.

The ownership of all oil and gas leases within a radius of 790 feet of the proposed unorthodox well location is common with the ownership in the proposed location, such owners being J. Glenn Turner, Frank A. Schultz and William G. Webb.

LA PLATA (LATVIA) 1941-1945

1941-1945

1941-1945

1941-1945

1941-1945

1941-1945

1941-1945

1941-1945

1941-1945

1941-1945

1941-1945

1941-1945

1941-1945

1941-1945

1941-1945

1941-1945

1941-1945

1941-1945

1941-1945

1941-1945

1941-1945

1941-1945

1941-1945

1941-1945

1941-1945

1941-1945

1941-1945

1941-1945

1941-1945

1941-1945

1941-1945

1941-1945

1941-1945

1941-1945

1941-1945

1941-1945

1941-1945

1941-1945

1941-1945

1941-1945

1941-1945

1941-1945

1941-1945

1941-1945

1941-1945

1941-1945

1941-1945

1941-1945

1941-1945

1941-1945

1941-1945

1941-1945

1941-1945

1941-1945

1941-1945

1941-1945

1941-1945

1941-1945

1941-1945

1941-1945

1941-1945

1941-1945

1941-1945

1941-1945

Mr. A. L. Porter, Jr. Secretary
New Mexico Oil Conservation Commission
September 13, 1963
Page 2

Therefore, La Plata Gathering System, Inc., as Operator of the San Juan 32-5 Unit, respectfully requests the Secretary of the Commission to grant an exception to the well location requirement of Rule 104(d)(2) without notice or hearing, pursuant to the authority granted by the Commission's Rule 104(f).

Respectfully submitted,

LA PLATA GATHERING SYSTEM, INC.

Walter M. Kilgo, Chief Engineer

WMK:lc
Encls.

... ..
... ..
... ..
... ..

... ..
... ..
... ..
... ..
... ..

... ..

... ..

... ..
... ..
... ..
... ..
... ..

... ..
... ..

Memo

From

JAMES M. DURRETT JR.
GENERAL COUNSEL

9-20-63

To Cmsy

Please verify topography
As Applicant owns offsetting
Acres application is
eligible for approval upon
verification by your office.

Done
9.23.63
used file



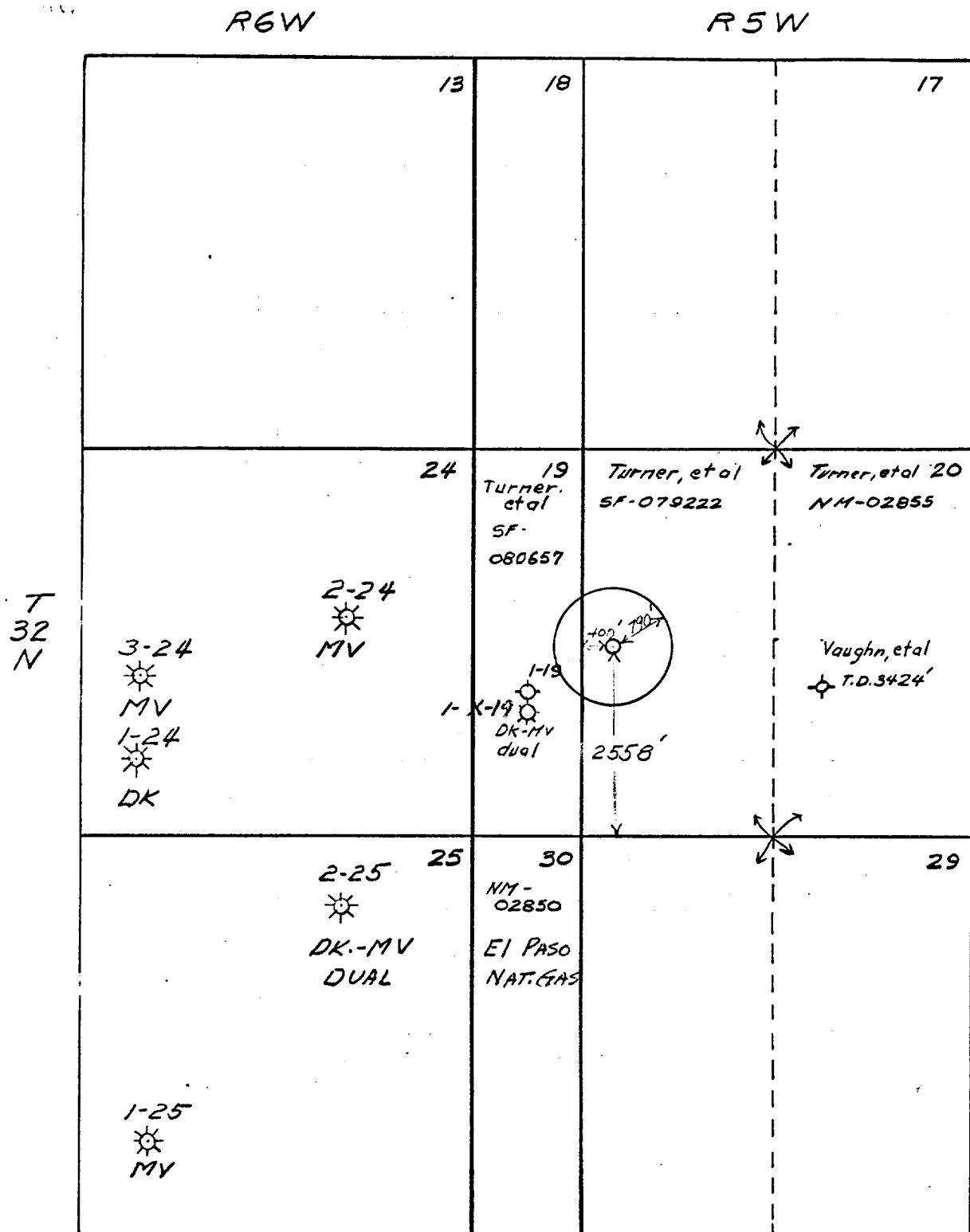

Rio Arriba Co, New Mexico
Scale 1"=2000'

WELL LOCATION PLAT
SJU 32-5 NO. 1-20

NEW MEXICO OIL CONSERVATION COMMISSION

Well Location and Acreage Dedication Plat

Section A

Date

Operator LA PLATA GATHERING SYSTEM Lease
 Well No. _____ Unit Letter L Section 20 Township 32 NORTH Range 5 WEST, NMPM
 Located 2558 Feet From the SOUTH Line 400 Feet From the WEST Line
 County RIO ARriba G. L. Elevation 6187.0 Dedicated Acreage _____ Acres
 Name of Producing Formation _____ Pool _____

1. Is the Operator the only owner in the dedicated acreage outlined on the plat below?
 Yes _____ No _____
2. If the answer to question one is "no", have the interests of all the owners been consolidated by communitization agreement or otherwise? Yes _____ No _____ If answer is "yes", Type of Consolidation _____
3. If the answer to question two is "no", list all the owners and their respective interests below:

Owner

Land Description

Section B

Note: All distances must be from outer boundaries of section.

This is to certify that the information in Section A above is true and complete to the best of my knowledge and belief.

(Operator)

(Representative)

(Address)

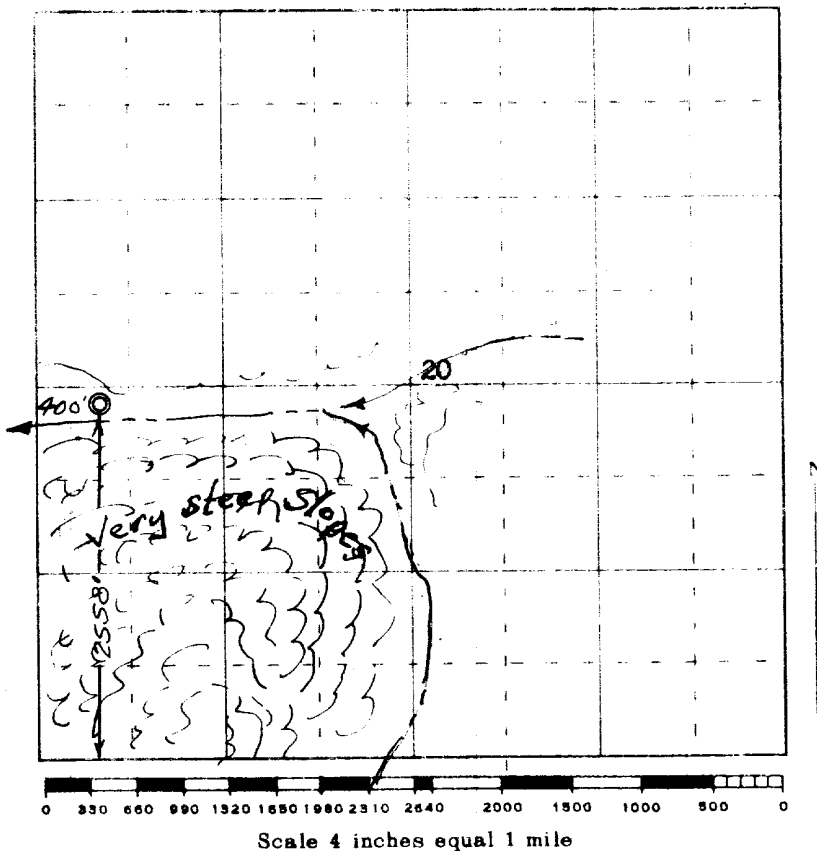

This is to certify that the above plat was prepared from field notes of actual surveys made by me or under my supervision and that the same are true and correct to the best of my knowledge and belief.

Date Surveyed 13 September 1963

James P. Leese
 Registered Professional Engineer and/or Land Surveyor
 James P. Leese N. Mex. Reg. No. 1463
 San Juan Engineering Company

Farmington, New Mexico