

# NEW MEXICO OIL CONSERVATION COMMISSION

## Santa Fe, New Mexico

### NOTICE OF INTENTION TO DRILL OR RECOMPLETE

Notice must be given to the District Office of the Oil Conservation Commission and approval obtained before drilling or recompletion begins. If changes in the proposed plan are considered advisable, a copy of this notice showing such changes will be returned to the sender. Submit this notice in **QUINTUPLICATE**. One copy will be returned following approval. See additional instructions in Rules and Regulations of the Commission.

**If State Land submit 6 Copies**

**Farmington, New Mexico**

(Place)

**December 23, 1955**

(Date)

OIL CONSERVATION COMMISSION  
SANTA FE, NEW MEXICO

Gentlemen:

You are hereby notified that it is our intention to commence the (Drilling) (Recompletion) of a well to be known as

**PACIFIC REFINEMENT PIPELINE CORPORATION**

(Company or Operator)

**SAN JUAN UNIT 30-5**

(Lease)

Well No.

**6-10**

in

**30-5**

(Unit)

The well is

located **990** feet from the **North** line and **990** feet from the

**EAST**

line of Section **10**

T. **30N**

R. **6W**

, NMPM.

(GIVE LOCATION FROM SECTION LINE)

**WILSON**

Pool,

**SAN JUAN**

County

If State Land the Oil and Gas Lease is No.

If patented land the owner is **Mr. B. B. B.**

Address **Rt. 2 - Ignacio, Colorado**

We propose to drill well with drilling equipment as follows: **2000 to 5407**

The status of plugging bond is

Drilling Contractor **SAGE DRILLING COMPANY**

We intend to complete this well in the **WILSON**

formation at an approximate depth of **5400**

feet.

#### CASING PROGRAM

We propose to use the following strings of Casing and to cement them as indicated:

Size of Hole	Size of Casing	Weight per Foot	New or Second Hand	Depth	Sacks Cement
<b>13"</b>	<b>9-5/8"</b>	<b>32.30</b>	<b>New</b>		<b>125 Sx 4 1/2 Gal</b>
<b>9-7/8"</b>	<b>7"</b>	<b>24</b>	<b>New</b>		<b>150 Sx 8 1/2 Gal</b>
<b>6-3/4"</b>	<b>5"</b>	<b>14</b>	<b>New</b>		<b>120 Sx 2 1/2 Gal</b>

If changes in the above plans become advisable we will notify you immediately.

ADDITIONAL INFORMATION (If recompletion give full details of proposed plan of work.)

**THE CLIFF HOUSE, MINERAL, POINT LOCATED TO BE FRACED SEPARATELY EACH WITH 40,000 GALLONS WATER WITH APPROXIMATELY 1 1/2 Sx 8 1/2 Gal. 277 ACRES (1/2) SECTION 10P ADJACENT TO THIS WELL**

Approved **12-27-55**, 19 **55**  
Except as follows:

OIL CONSERVATION COMMISSION

By **Ernest C. Curd**

Oil and Gas Inspector Dist. #3.

Title

Sincerely yours,

**PACIFIC REFINEMENT PIPELINE CORPORATION**

(Company or Operator)

Original signed by **T. A. Dugan**

By

**REGISTERED ENGINEER**

Position. Send Communications regarding well to

Name **PACIFIC REFINEMENT PIPELINE CORPORATION**

Address **115 West Main Street**

**FARMINGTON, NEW MEXICO**

COMPANY PACIFIC NORTHWEST PIPELINE CORPORATION

Well Name & No. \_\_\_\_\_ Lease No. \_\_\_\_\_

Location 990' FROM THE NORTH LINE AND 990' FROM THE EAST LINE

Being in NW SE NE

Sec. 10, T32 N., R. 6 W., N.M.P.M., SAN JUAN COUNTY, NEW MEXICO

Ground Elevation 6193.9 UNGRADED

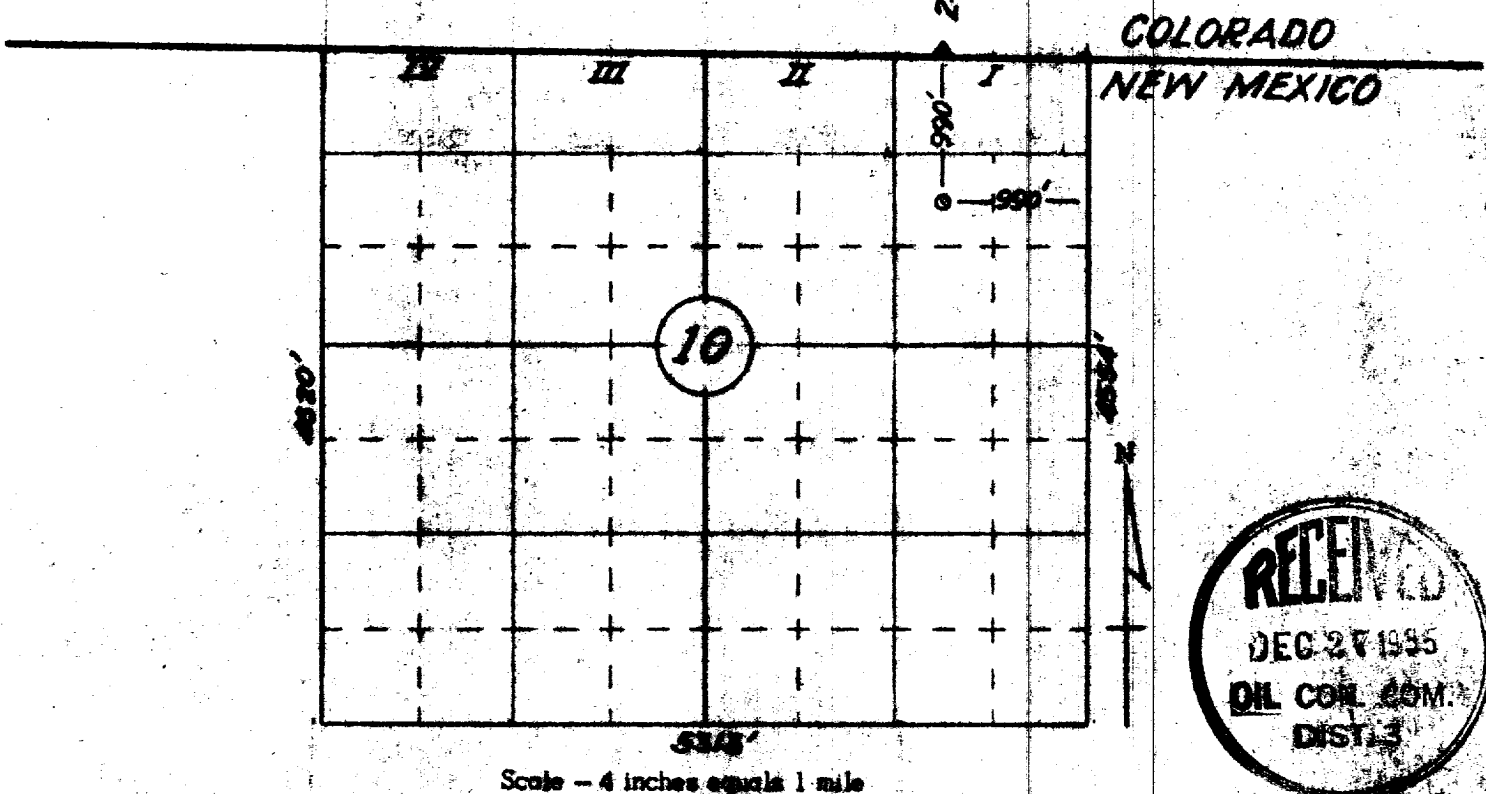

Surveyed 10 NOVEMBER 19 35

This is to certify that the above plat was prepared from field notes of actual surveys made by me or under my supervision and that the same are true and correct to the best of my knowledge and belief.

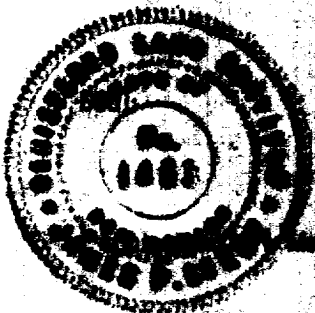

*James A. [Signature]*  
JAMES A. [Name]  
[Title]  
[Address]

ACTPRO ELECTRONIC SERVICE 1500 S. 10th St. Suite 100 Lincoln, NE 68502 (402) 441-1111		
S. Copies Received <u>6</u>		
P. Copies Received <u>2</u>		
1. <u>1</u>	<u>2</u>	
2. <u>1</u>	<u>1</u>	
3. <u>2</u>	<u>2</u>	
4. <u>1</u>	<u>1</u>	✓