

NO. OF COPIES RECEIVED	6
DISTRIBUTION	
SANTA FE	1
FILE	1
U.S.G.S.	2
LAND OFFICE	1
OPERATOR	1

NEW MEXICO OIL CONSERVATION COMMISSION

30-039-21821
Form C-101
Revised 1-1-65

5A. Indicate Type of Lease	
STATE <input checked="" type="checkbox"/>	FEE <input type="checkbox"/>
5. State Oil & Gas Lease No.	
LG-898	

APPLICATION FOR PERMIT TO DRILL, DEEPEN, OR PLUG BACK

1a. Type of Work		7. Unit Agreement Name	
b. Type of Well DRILL <input checked="" type="checkbox"/> DEEPEN <input type="checkbox"/> PLUG BACK <input type="checkbox"/> OIL WELL <input type="checkbox"/> GAS WELL <input checked="" type="checkbox"/> OTHER <input type="checkbox"/> SINGLE ZONE <input checked="" type="checkbox"/> MULTIPLE ZONE <input type="checkbox"/>		8. Farm or Lease Name State Bancos	
2. Name of Operator Kimbark Operating Co.		9. Well No. #1	
3. Address of Operator 808 Lincoln Tower Bldg., 1860 Lincoln St., Denver, Colorado 80295		10. Field and Pool, or Wildcat Blanco Mesa Verde	
4. Location of Well UNIT LETTER <u>D</u> LOCATED <u>795</u> FEET FROM THE <u>North</u> LINE AND <u>1110</u> FEET FROM THE <u>West</u> LINE OF SEC. <u>32</u> TWP. <u>32N</u> RGE. <u>5W</u> NMPM		12. County Rio Arriba	
19. Proposed Depth 6400'		19A. Formation Mesa Verde	
20. Rotary or C.T. Rotary		21. Elevations (Show whether DF, RT, etc.) 6731' gl.	
21A. Kind & Status Plug. Bond 1 well plugging		21B. Drilling Contractor Four Corners	
22. Approx. Date Work will start July 1, 1978			

23. bond being prepared PROPOSED CASING AND CEMENT PROGRAM

SIZE OF HOLE	SIZE OF CASING	WEIGHT PER FOOT	SETTING DEPTH	SACKS OF CEMENT	EST. TOP
12-3/4"	8-5/8"	24.00	220'	Circ.	Sfc.
7-7/8"	4-1/2"	10.50	6400'	2 stage	Circ.

-- Will drill hole with mud, log, run csg., perf., and complete.

-- First well was drilled in NE $\frac{1}{4}$ (Schultz #14-32 State, P&A years ago) as required by Blanco Mesa Verde rules. Second well was drilled in SW $\frac{1}{4}$.

-- 6/9/78 telephone contact made with Mr. Benny Lopez and Mr. Ray Graham, State Land Office; have State permission to go ahead with operations.

Not Dedicated

FOR SO MANY YEARS
DRILLING (CANNONED)

EXPIRES 9-10-78

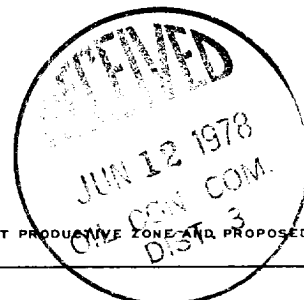

IN ABOVE SPACE DESCRIBE PROPOSED PROGRAM: IF PROPOSAL IS TO DEEPEN OR PLUG BACK, GIVE DATA ON PRESENT PRODUCTIVE ZONE AND PROPOSED NEW PRODUCTIVE ZONE. GIVE BLOWOUT PREVENTER PROGRAM, IF ANY.

I hereby certify that the information above is true and complete to the best of my knowledge and belief.

Signature Elliott A. Riggs Title Agent Date June 8, 1978
(This space for State Use)

APPROVED BY AL Hendrick TITLE SUPERVISOR DIST. 3 DATE JUN 12 1978
CONDITIONS OF APPROVAL, IF ANY:

Gas is dedicated. Subject to approval of off-pattern location

NEW MEXICO OIL CONSERVATION COMMISSION
WELL LOCATION AND ACREAGE DEDICATION PLAT

Form C-102
Supersedes C-128
Effective 1-1-65

All distances must be from the outer boundaries of the Section.

KIMBARK OPERATING COMPANY			Lease State Bancos		Well No. #1
Well Letter D	Section 32	Township 32 NORTH	Range 5 WEST	County RIO ARriba	
Actual Footage Location of Well: 795 feet from the NORTH line and 1110 feet from the WEST line					
Ground Level Elev. 6731	Producing Formation Mesa Verde	Pool Blanco Mesa Verde		Dedicated Acreage: 320 Acres	

- Outline the acreage dedicated to the subject well by colored pencil or hachure marks on the plat below.
- If more than one lease is dedicated to the well, outline each and identify the ownership thereof (both as to working interest and royalty). **Only one lease.**
- If more than one lease of different ownership is dedicated to the well, have the interests of all owners been consolidated by communitization, unitization, force-pooling, etc?

☐ Yes ☐ No If answer is "yes," type of consolidation Only one lease

If answer is "no," list the owners and tract descriptions which have actually been consolidated. (Use reverse side of this form if necessary.)

No allowable will be assigned to the well until all interests have been consolidated (by communitization, unitization, forced-pooling, or otherwise) or until a non-standard unit, eliminating such interests, has been approved by the Commission.

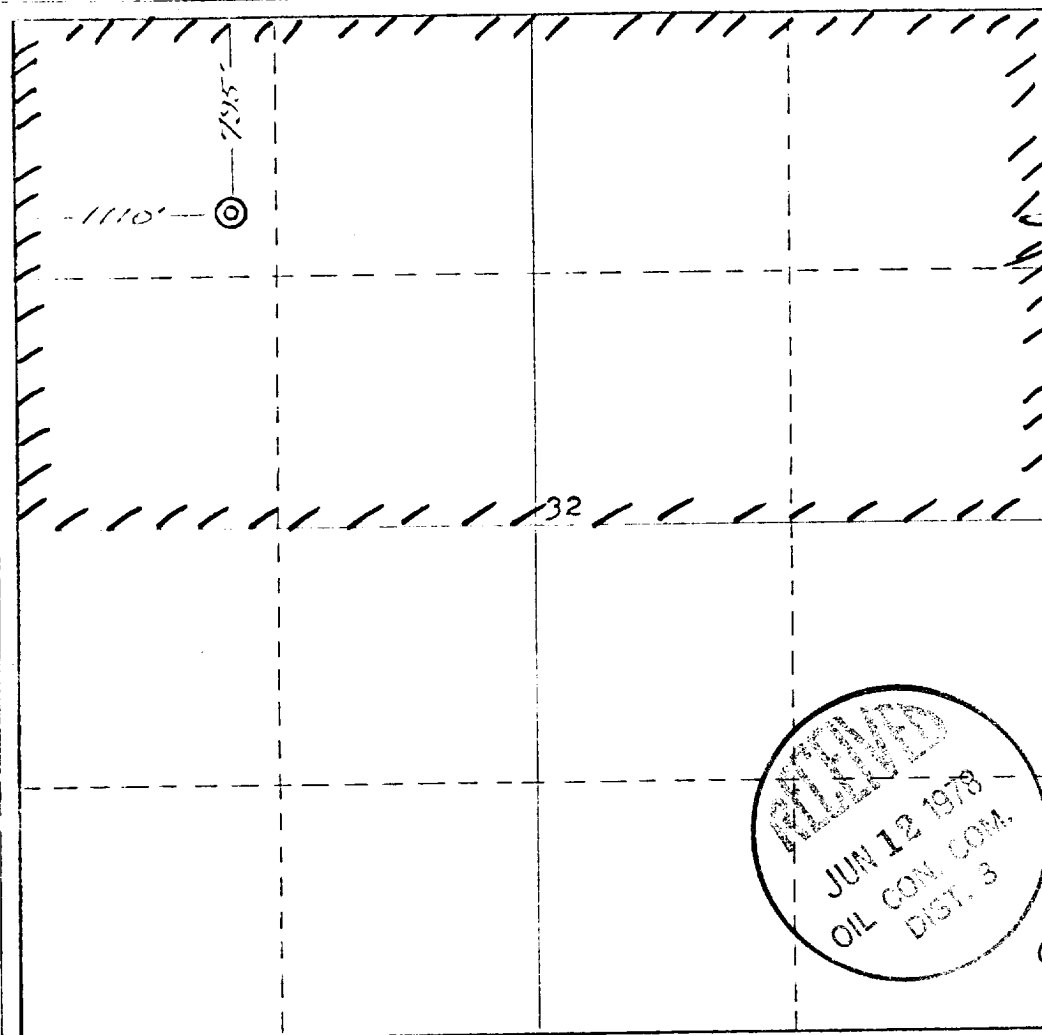

CERTIFICATION

I hereby certify that the information contained herein is true and complete to the best of my knowledge and belief.

Elliott A. Riggs
Elliott A. Riggs

Position
Agent

Company
Rincon Operating Co.

Date
June 8, 1978

I hereby certify that the well location shown on this plat was plotted from field notes of actual surveys made by me or under my supervision, and the same is true and correct to the best of my knowledge and belief.

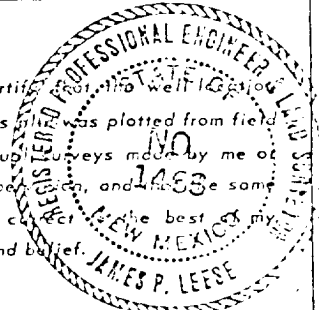

Date Surveyed
31 May 1978

Registered Professional Engineer
of Land Surveyor

James P. Leese
James P. Leese

Certificate No.
1463

0 530 660 790 920 1050 1180 1310 1440 1570 1700 1830 1960 2090 2220 2350 2480 2610 2740 2870 3000