

UNITED STATES  
DEPARTMENT OF THE INTERIOR  
BUREAU OF LAND MANAGEMENT

RECEIVED  
MAIL ROOM

APPLICATION FOR PERMIT TO DRILL, DEEPEN, OR PLUG BACK

1a. TYPE OF WORK

DRILL ☒

DEEPEN ☐

PLUG BACK ☐

b. TYPE OF WELL

OIL  
WELL ☐

GAS  
WELL ☒

OTHER ☐

2. NAME OF OPERATOR

MERIDIAN OIL INC.  
El Paso Natural Gas Company

3. ADDRESS OF OPERATOR

PO Box 4289, Farmington, NM 87499

4. LOCATION OF WELL (Report location clearly and in accordance with any State requirements.)

At surface

2430'N, 1560'E

At proposed prod. zone

14. DISTANCE IN MILES AND DIRECTION FROM NEAREST TOWN OR POST OFFICE\*

8 miles from Arboles, Colorado

15. DISTANCE FROM PROPOSED\*

LOCATION TO NEAREST  
PROPERTY OR LEASE LINE, FT. 1560'  
(Also to nearest drig. unit line, if any)

18. NO. OF ACRES IN LEASE

1480

13. DISTANCE FROM PROPOSED LOCATION\*  
TO NEAREST WELL, DRILLING, COMPLETED,  
OR APPLIED FOR, ON THIS LEASE, FT. 1 mile

21. ELEVATIONS (Show whether DF, BT, GR, etc.)

6313'GL DRILLING OPERATIONS AUTHORIZED ARE

23.

SUBJECT TO COMPLIANCE WITH ATTACHED  
PROPOSED CASING AND CEMENTING PROGRAM  
"GENERAL REQUIREMENTS"

This action is subject to technical and  
procedural review pursuant to 43 CFR 3165.3  
and appeal pursuant to 43 CFR 3165.4.

SIZE OF HOLE	SIZE OF CASING	WEIGHT PER FOOT	SETTING DEPTH	
12 1/4"	9 5/8"	32.3#	200'	130 cf. circulated
8 3/4"	7"	20.0#	2918'	920 cf. circ. surface
6 1/4"	5 1/2" liner	23.0#	3035'	do not cement

The Fruitland coal formation will be completed.

A 3000 psi WP and 6000 psi test double gate preventer equipped with  
blind and pipe rams will be used for blow out prevention on this well.

This gas is dedicated.

The NE/4 of Section 24 is dedicated to this well.

IN ABOVE SPACE DESCRIBE PROPOSED PROGRAM: If proposal is to deepen or plug back, give data on present productive zone and proposed new productive zone. If proposal is to drill or deepen directionally, give pertinent data on subsurface locations and measured and true vertical depths. Give blowout preventer program, if any.

24.

SIGNED

TITLE

Regulatory Affairs

DATE

07-11-88

(This space for Federal or State office use)

PERMIT NO.

APPROVAL DATE

APPROVED BY

TITLE

DATE

AUG 09 1988

CONDITIONS OF APPROVAL, IF ANY:

APPROVED  
AS AMENDED  
AREA MANAGER

\*See Instructions On Reverse Side

Title 18 U.S.C. Section 1001, makes it a crime for any person knowingly and willfully to make to any department or agency of the United States any false, fictitious or fraudulent statements or representations as to any matter within its jurisdiction.

# WELL LOCATION AND ACREAGE DEDICATION PLAT

3 1-101 C-11  
E: 100 14-65

All distances must be from the outer boundaries of the Section.

Operator <b>MERIDIAN OIL INC.</b> EL PASO NATURAL GAS		Lease <b>SAN JUAN 32-5 UNIT(SF-079011)</b>		Well No. <b>103</b>
Unit Letter <b>G</b>	Section <b>24</b>	Township <b>32 NORTH</b>	Range <b>6 WEST</b>	County <b>RIO ARriba</b>
Actual Postage Location of Well				
2430 feet from the NORTH line and		1560 feet from the EAST line		Ne
Ground Level Elev. <b>6313</b>	Producing Formation <b>Fruitland Coal</b>	Pool <b>Undesignated</b>	Dedicated Acreage <b>160</b> Acres	

1. Outline the acreage dedicated to the subject well by colored pencil or hachure marks on the plat below.
2. If more than one lease is dedicated to the well, outline each and identify the ownership thereof (both as to working interest and royalty).
3. If more than one lease of different ownership is dedicated to the well, have the interests of all owners been consolidated by communitization, unitization, force-pooling, etc?

☒ Yes ☐ No If answer is "yes," type of consolidation Unitization

If answer is "no," list the owners and tract descriptions which have actually been consolidated. (Use reverse side of this form if necessary.)

No allowable will be assigned to the well until all interests have been consolidated (by communitization, unitization, forced-pooling, or otherwise) or until a non-standard unit, eliminating such interests, has been approved by the Commission.

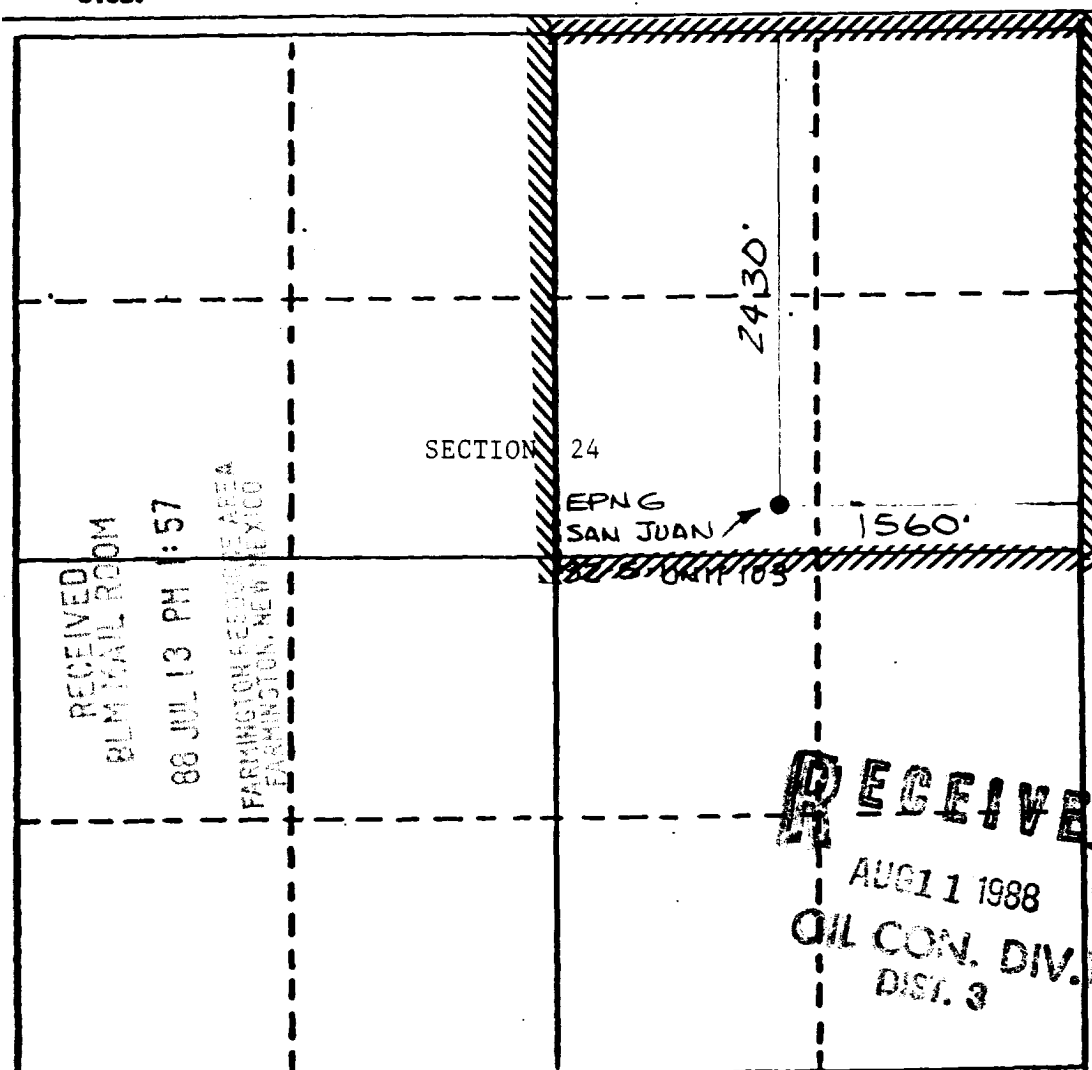

## CERTIFICATION

I hereby certify that the information contained herein is true and complete to the best of my knowledge and belief.

*[Signature]*  
Name **Drilling Clerk**

Position **El Paso Natural Gas**

Company **7-11-88**

Date

I hereby certify that the well location shown on this plat was plotted from field notes and actual surveys made by me or under my supervision, and that the same is true and correct to the best of my knowledge and belief.

*[Signature]*  
Name **Neale C. Edwards**

Date Surveyed **JUNE 6, 1988**

Registered Professional Engineer  
and/or Land Surveyor

**NEALE C. EDWARDS**

Certificate No. **6857**

RECEIVED  
BLM MAIL ROOM  
88 JUL 13 PM 1:57  
FARMINGTON REGIONAL AREA  
FARMINGTON, NEW MEXICO

RECEIVED  
AUG 11 1988  
OIL CON. DIV.  
DIST. 3

