

ENERGY, MINERALS AND NATURAL RESOURCES DEPARTMENT

OIL CONSERVATION DIVISION



ok  
JB

GARREY CARRUTHERS  
GOVERNOR

POST OFFICE BOX 2088  
STATE LAND OFFICE BUILDING  
SANTA FE, NEW MEXICO 87504  
(505) 827-5800

July 12, 1988

El Paso Natural Gas Co.  
P.O. Box 4289  
Farmington, NM 87499-4289

Attention: Peggy Doak

Administrative Order NSL-2547

Dear Ms. Doak:

Reference is made to your application for a non-standard location for your San Juan 32-5 Unit Well No. 103 to be located 2430 feet from the North line and 1560 feet from the East line (Unit G) of Section 24, Township 32 North, Range 6 West, NMPM, Wildcat Fruitland Pool, Rio Arriba County, New Mexico. The NE/4 of said Section 24 shall be dedicated to the well.

By the authority granted me under the provisions of Rule 104 F(I), the above-described unorthodox location is hereby approved.

Sincerely,

A handwritten signature in dark ink, appearing to read "William J. LeMay".

William J. LeMay  
Director

WJL/DRC/ag

cc: Oil Conservation Division - Aztec

RECEIVED  
JUL 19 1988  
OIL CON. DIV.  
DIST. 2



STATE OF NEW MEXICO  
ENERGY AND MINERALS DEPARTMENT  
OIL CONSERVATION DIVISION  
AZTEC DISTRICT OFFICE

GARREY CARRUTHERS  
GOVERNOR

1000 RIO BRAZOS ROAD  
AZTEC, NEW MEXICO 87410  
(505) 334-6178

Date: 6/30/88

Oil Conservation Division  
P.O. Box 2088  
Santa Fe, NM 87504-2088

Re: Proposed MC \_\_\_\_\_  
Proposed DHC \_\_\_\_\_  
Proposed NSL   X   \_\_\_\_\_  
Proposed SWD \_\_\_\_\_  
Proposed WFX \_\_\_\_\_  
Proposed PMX \_\_\_\_\_

Gentlemen:

I have examined the application dated 6/16/88  
for the Melvin San Juan 32-S Unit #103  
Operator Lease & Well No.

G 24-32N-6W and my recommendations are as follows:  
Unit, S-T-R

Cypress  
\_\_\_\_\_  
\_\_\_\_\_  
\_\_\_\_\_  
\_\_\_\_\_

Yours truly,

W. G.

June 14, 1988

Mr. William LeMay  
New Mexico Oil Conservation Division  
Post Office Box 2088  
Santa Fe, New Mexico 87501

Dear Mr. LeMay:

This is a request for administrative approval for an unorthodox gas well location in the Undesignated Fruitland Pool.

It is intended to locate the El Paso Natural Gas Company's San Juan 32-5 Unit #103 at 2430' from the North line and 1560' from the East line of Section 24, T-32-N, R-6-W, Rio Arriba County, New Mexico.

Extremely rough terrain in the form of steep cliffs makes it impossible to build an orthodox location in the southeast quarter of this section.

El Paso Natural Gas Company is the operator of this unit.

Plats showing the proposed well location and the terrain in Section 24, along with an ownership plat, are attached.

Sincerely yours,

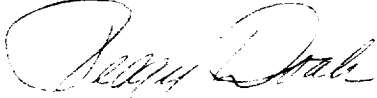

Peggy Doak

encl.

RECEIVED  
JUN 16 1988  
OIL CON. DIV.  
DIST. 3

# EL PASO NATURAL GAS COMPANY

Well Name San Juan 32-5 Unit #103, Undesignated Fruitland

Footage----- 2430' FNL; 1560' FEL

## APPLICATION FOR NON-STANDARD LOCATION

County Rio Arriba State New Mexico Section 24 Township 32N Range 6W

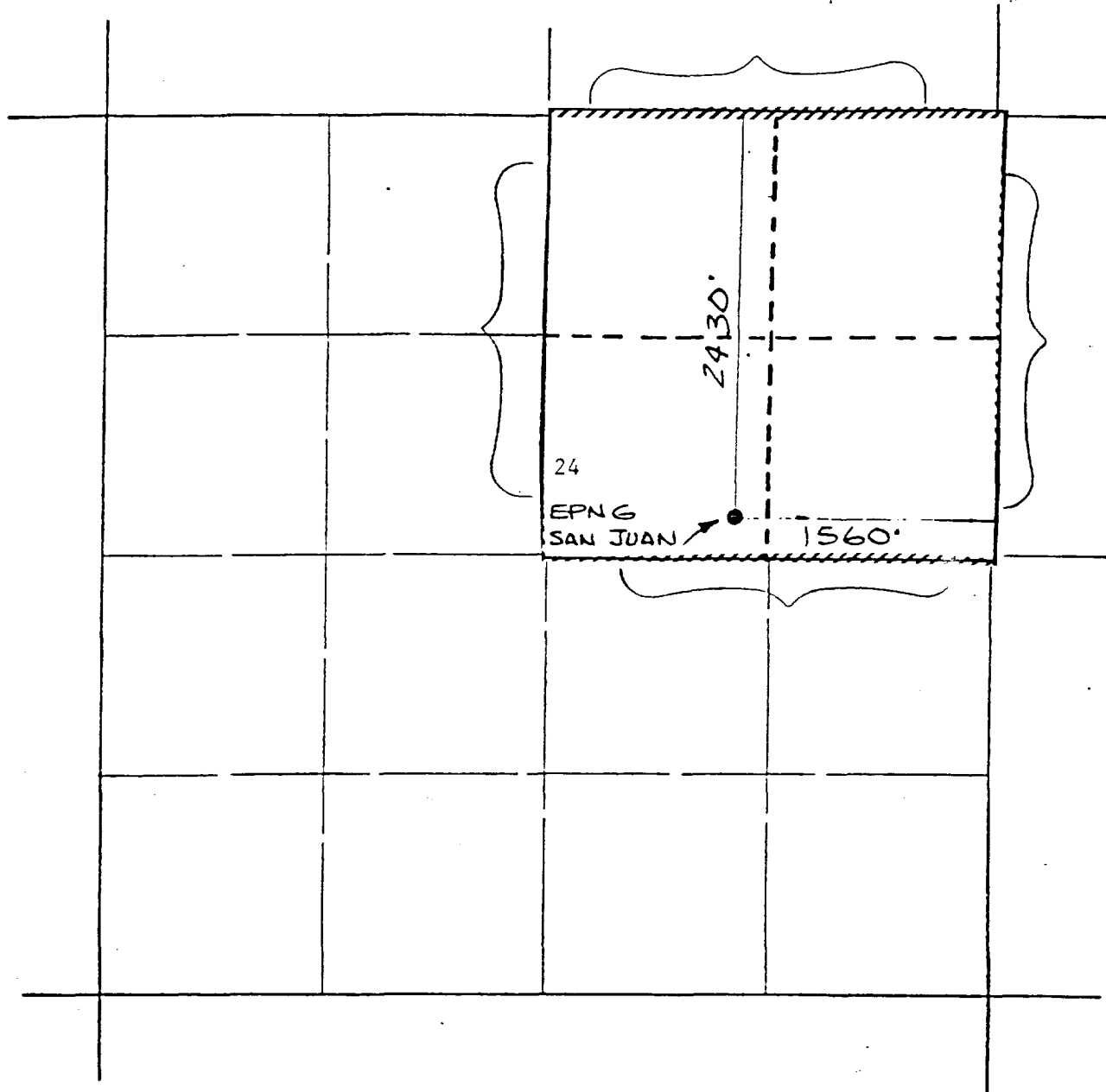

REMARKS: All -- El Paso Natural Gas Company

# WELL LOCATION AND ACREAGE DEDICATION PLAT

St. 10-11 C-13  
Ch. 10-14-68

All distances must be from the outer boundaries of the Section.

Operator <b>EL PASO NATURAL GAS</b>			Lease <b>SAN JUAN 32-5 UNIT(SF-079011)</b>		Well No. <b>103</b>
Unit Letter <b>G</b>	Section <b>24</b>	Township <b>32 NORTH</b>	Range <b>6 WEST</b>	County <b>RIO ARriba</b>	

Actual Postage Location of Well:  
 2430 feet from the **NORTH** line and 1560 feet from the **EAST** line

Ground Level Elev. <b>6313</b>	Producing Formation <b>Fruitland Coal</b>	Pool <b>Undesignated</b>	Dedicated Acreage <b>160</b> Acres
-----------------------------------	--	-----------------------------	---------------------------------------

1. Outline the acreage dedicated to the subject well by colored pencil or hatchure marks on the plat below.
2. If more than one lease is dedicated to the well, outline each and identify the ownership thereof (both as to working interest and royalty).
3. If more than one lease of different ownership is dedicated to the well, have the interests of all owners been consolidated by communitization, unitization, force-pooling, etc?

☒ Yes   ☐ No   If answer is "yes," type of consolidation Unitization

If answer is "no," list the owners and tract descriptions which have actually been consolidated. (Use reverse side of this form if necessary.)

No allowable will be assigned to the well until all interests have been consolidated (by communitization, unitization, forced-pooling, or otherwise) or until a non-standard unit, eliminating such interests, has been approved by the Commission.

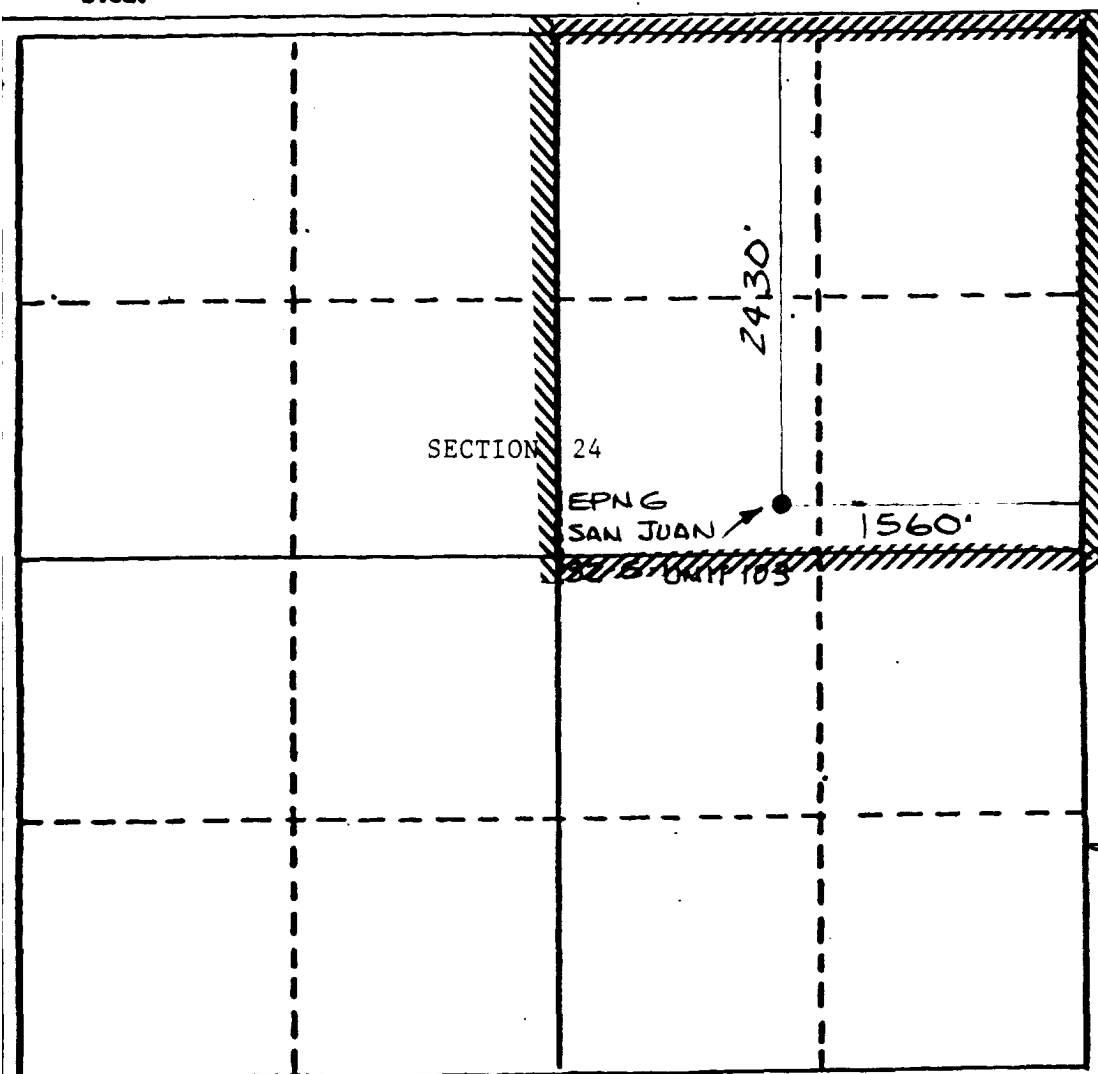

## CERTIFICATION

I hereby certify that the information contained herein is true and complete to the best of my knowledge and belief.

Name Drilling Clerk  
 Position El Paso Natural Gas  
 Company \_\_\_\_\_  
 Date \_\_\_\_\_

I hereby certify that the well location shown on this plat was plotted from field notes and actual surveys made by me or under my supervision, and that the same is true and correct to the best of my knowledge and belief.

Date Surveyed  
**JUNE 6, 1988**  
 Registered Professional Engineer  
 and/or Land Surveyor

**NEALE C. EDWARDS**

Certificate No.  
**6857**



