

All distances must be from the outer boundaries of the Section.

Operator Nassau Resources, Inc.			Lease Carracas Unit 20 B		Well No. 3
Unit Letter C	Section 20	Township 32 North	Range 4 West	County Rio Arriba	
Actual Footage Location of Well 1170 feet from the NORTH line and 1480 feet from the WEST line					
Ground Level Elev. 7388	Producing Formation Fruitland		Pool Basin Fruitland Coal	Dedicated Acreage 320 Acres	

1. Outline the acreage dedicated to the subject well by colored pencil or hatchure marks on the plat below.
2. If more than one lease is dedicated to the well, outline each and identify the ownership thereof (both as to working interest and royalty).
3. If more than one lease of different ownership is dedicated to the well, have the interests of all owners been consolidated by communitization, unitization, force-pooling, etc?

☒ Yes ☐ No If answer is "yes," type of consolidation Carracas Unit - Unitization

If answer is "no," list the owners and tract descriptions which have actually been consolidated. (Use reverse side of this form if necessary.)

No allowable will be assigned to the well until all interests have been consolidated (by communitization, unitization, forced-pooling, or otherwise) or until a non-standard unit, eliminating such interests, has been approved by the Division.

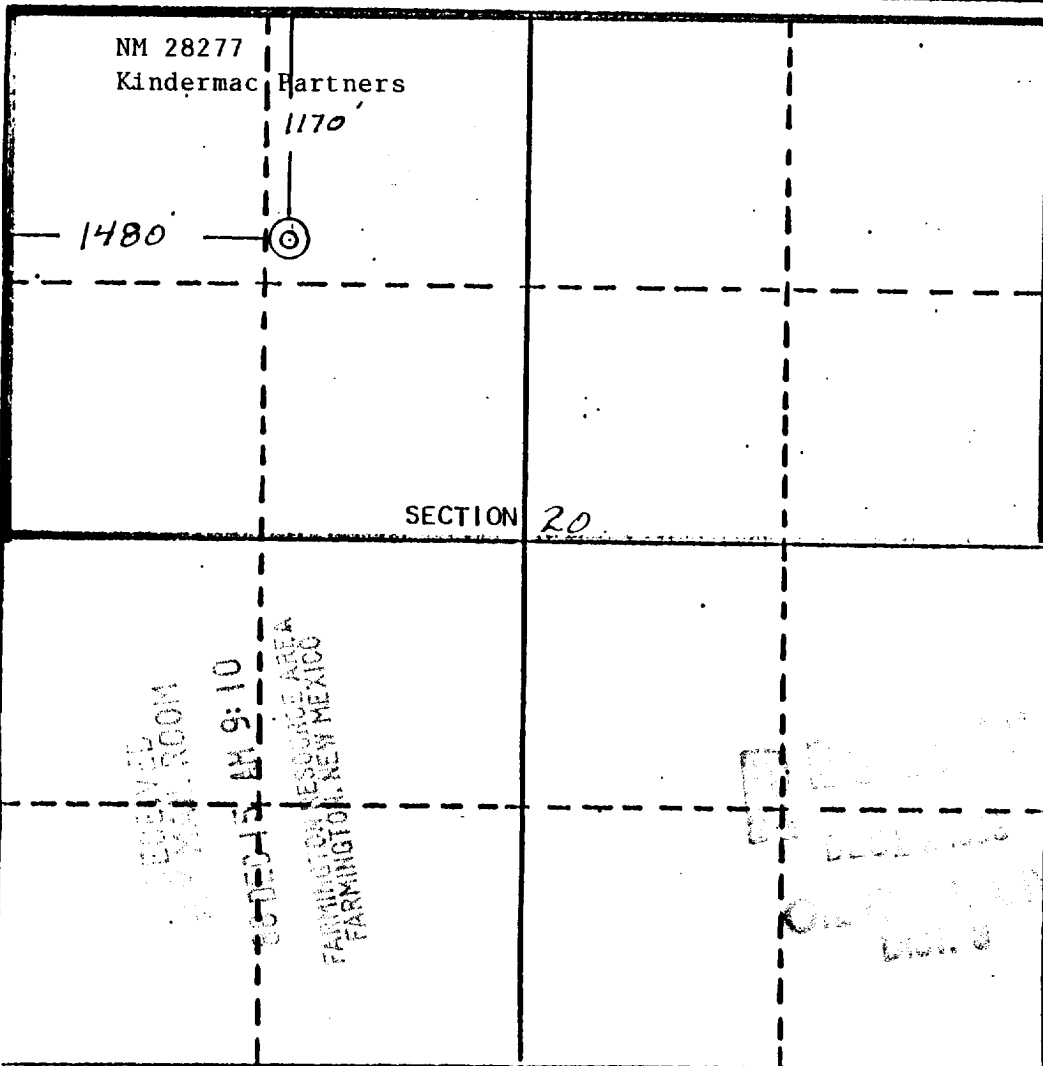

CERTIFICATION

I hereby certify that the information contained herein is true and complete to the best of my knowledge and belief.

Fran Perrin

Name

Fran Perrin

Position

Admin. Asst.

Company

Nassau Resources, Inc.

Date

12/8/88

I hereby certify that the location shown on this plat is the true and correct location of the well as shown on the survey made by me or under my supervision, and that the same is true and correct to the best of my knowledge and belief.

Date Surveyed

6-11-88

Registered Professional Engineer and/or Land Surveyor

Edgar L. Risenhoover
Certificate No. 5979