

Title 18 U.S.C. Section 1001, makes it a crime for any person knowingly and willfully to make to any department or agency of the United States any false, fictitious or fraudulent statements or representations as to any matter within its jurisdiction.

NEW MEXICO OIL CONSERVATION COMMISSION
WELL LOCATION AND ACREAGE DEDICATION PLAT

Form C-102
Supersedes C-128
Effective 1-1-65

All distances must be from the outer boundaries of the Section.

Operator Nassau Resources, Inc.			Lease Carracas Unit II A		Well No. 9
Unit Letter I	Section 11	Township 32 North	Range 5 West	County Rio Arriba	
Actual Postage Location of Well: 1675 feet from the South line and 1190 feet from the EAST line					
Ground Level Elev. 7506	Producing Formation Dakota		Pool Basin Dakota	Dedicated Acreage: 320 Acres	

1. Outline the acreage dedicated to the subject well by colored pencil or hatchure marks on the plat below.
2. If more than one lease is dedicated to the well, outline each and identify the ownership thereof (both as to working interest and royalty).
3. If more than one lease of different ownership is dedicated to the well, have the interests of all owners been consolidated by communitization, unitization, force-pooling, etc?

☒ Yes ☐ No If answer is "yes," type of consolidation Carracas Unit - Unitization

If answer is "no," list the owners and tract descriptions which have actually been consolidated. (Use reverse side of this form if necessary.)

No allowable will be assigned to the well until all interests have been consolidated (by communitization, unitization, forced-pooling, or otherwise) or until a non-standard unit, eliminating such interests, has been approved by the Commission.

RECEIVED
MAR 02 1989

Colo. OIL CON. DIST. 3

CERTIFICATION

I hereby certify that the information contained herein is true and complete to the best of my knowledge and belief.

Fran Perrin

Name

Fran Perrin

Position

Admin. Asst.

Company

Nassau Resources, Inc.

Date

2/17/89

EDGAR L. RISENBOOM
NEW MEXICO
REGISTERED PROFESSIONAL ENGINEER
AND/OR LAND SURVEYOR
5979

Date Surveyed

5-14-88

Registered Professional Engineer
and/or Land Surveyor

Edgar L. Risenboom
Certificate No. 5979

Edgar L. Risenboom

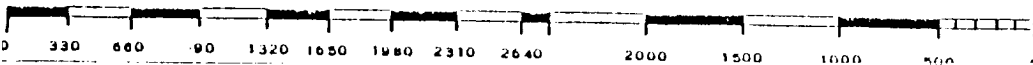
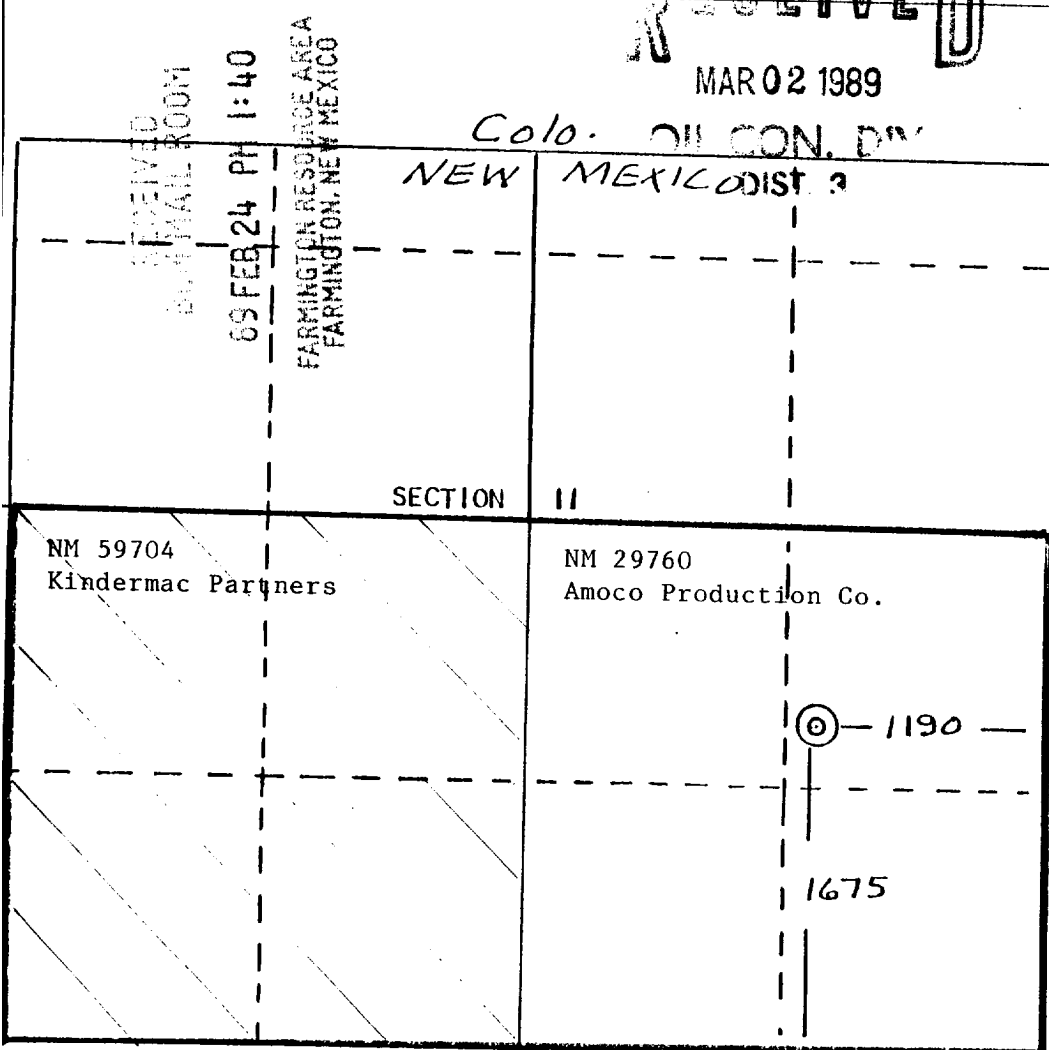

OPERATIONS PLAN

OPERATOR: NASSAU RESOURCES, INC.
WELL NAME: Carracas Unit 11 A #9
FIELD: WC Fruitland
LOCATION: 1675' FSL - 1190' FEL, Sec. 11, T32N, R5W NMPM
Rio Arriba County, New Mexico
ELEVATION: 7506' GL

EXPECTED FORMATION TOPS:

Ojo Alamo	3325'	Gallup Silt	7775'
Kirtland	3460'	Gallup Sand (1st)	7870'
Fruitland	3805'	Gallup Sand (2nd)	8121'
T/Main Coal	4007'	Tocito	8542'
B/Main Coal	4043'	Greenhorn	8685'
Picture Cliff	4098'	Graneros	8735'
Lewis	4208'	Dakota "A"	8840'
Chacra	5335'	Dakota "B"	8905'
Cliff House	5685'	Dakota "C"	8941'
Menefee	6490'	Dakota "D"	8975'
Point Lookout	6775'	Burro Canyon	9031'
Mancos	6997'	Total Depth	9090'

LOGGING PROGRAM: DIL-GR-SP & FDC-CNL-GR-Caliper

SAMPLES: Catch samples every 10' from 4000' to 4100' &
10' from 8900' to TD.

CASING PROGRAM:

Hole Size	Depth	Csg. Size	Wt./Ft.	Grade & Condition
12-1/4"	250'	9-5/8"	36#	J-55, New
Cement:	125 sx	Class "B"	w/ 2% CaCl	(150 cu.ft.)
7-7/8"	9270'	5-1/2"	17 & 15.5#	K-55, New
Cement:	650 sx	50/50 poz w/ 2% gel,	6-1/4#/sk	gilsonite
3 stage		& 1/4#/sk	flowseal	
	770 sk	65/35 w/12% gel & 1/4#/sk	flowseal	
		(2921 cu.ft.)		

DV tools at approx. 4250' and 6900'.

WELLHEAD EQUIPMENT: 9-5/8" x 11" 900 series Bradenhead &
11" x 7-1/16" 900 series, 3000 psi working pressure well head.

TECHNICAL PERSONNEL:

James S. Hazen, Field Supt.
Nassau Resources, Inc.
P O Box 809
Farmington, NM 87499
(505) 326-7793 Office
(505) 334-8225 Home

Gary Johnson, Petroleum Engr.
Nassau Resources, Inc.
650 South Cherry St. #1225
Denver, CO 80222
(303) 321-2111 Office
(303) 688-9864 Home

NASSAU RESOURCES, INC.
Carracas Unit 11 A #9
Exhibit B
Revised 2/23/89

RECEIVED
MAR 02 1989
OIL CON. DIV.
DIST. 3