



STATE OF NEW MEXICO
ENERGY, MINERALS AND NATURAL RESOURCES DEPARTMENT
OIL CONSERVATION DIVISION

GARREY CARRUTHERS
GOVERNOR

POST OFFICE BOX 2088
STATE LAND OFFICE BUILDING
SANTA FE, NEW MEXICO 87504
(505) 827-5800

September 20, 1988

Nassau Resources, Inc.
c/o Jerome P. McHugh & Associates
P.O. Box 809
Farmington, NM 87499-0809

Attention: James S. Hazen,
Field Superintendent

Administrative Order NSL-2581

Dear Mr. Hazen:

Reference is made to your application of September 8, 1988 for a non-standard gas well location for your Carracas "17-B" Well No. 15 to be located 650 feet from the South line and 2070 feet from the East line (Unit O) of Section 17, Township 32 North, Range 4 West, NMPH, to test the Fruitland formation, Rio Arriba County, New Mexico. The SE/4 of said Section 17 shall be dedicated to the well forming a standard 160-acre gas spacing and proration unit for said formation.

By the authority granted me under the provisions of General Rule 104 F(1), the above-described unorthodox location is hereby approved.

Sincerely,

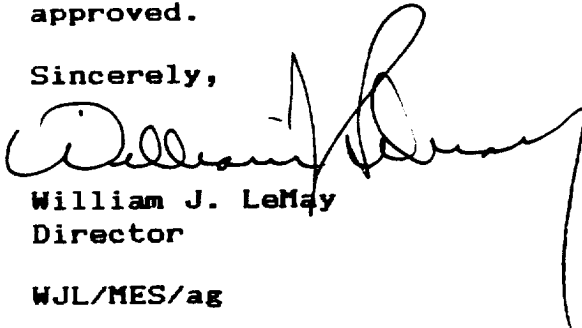
William J. LeMay
Director
WJL/MES/ag

RECEIVED
SEP 26 1988
OIL CON. DIV.
DIST. 3

cc: Oil Conservation Division - Aztec
US Bureau of Land Management - Farmington
New Mexico Oil & Gas Engineering Committee - Hobbs
US Forest Service - Blanco



STATE OF NEW MEXICO
ENERGY AND MINERALS DEPARTMENT

OIL CONSERVATION DIVISION
AZTEC DISTRICT OFFICE

10001 RTH HIGHWAY ROAD
AZTEC, NEW MEXICO 87410
(505) 334-6178

OIL CONSERVATION DIVISION
BOX 2088
SANTA FE, NEW MEXICO 87501

DATE 9-8-88

RE: Proposed HC _____
Proposed DIIC _____
Proposed NSL _____
Proposed SWD _____
Proposed WFX _____
Proposed PHX _____

Gentlemen:

I have examined the application dated 9-7-88
for the NASSAU RESOURCES, INC. CARRALAS UNIT 17B*15 0-17-32N-4W
Operator Lease and Well No. Unit, S-T-R

and my recommendations are as follows:

APPROVE

Yours truly,

[Signature]

September 6, 1988

New Mexico Oil Conservation Division
Attn: Mike Stogner
P O Box 2088
Santa Fe, NM 87504-2088

RECEIVED
SEP 07 1988
OIL CON. DIV.
DIST 2

RE: Application for Unorthodox Location
Nassau Resources, Inc.
Carracas Unit 17 B #15
650' FSL - 2070' FWL
Sec. 17, Township 32 North, Range 4 West, NMPM
Rio Arriba County, New Mexico

Gentlemen:

Nassau Resources, Inc., hereby requests administrative approval of an unorthodox location for the captioned well based upon archeological findings and Carson National Forest requirements.

This well was originally staked 790' FSL and 1850' FEL; however, the archeological survey revealed cultural material and pit houses. The present proposed location has been tentatively agreed upon with the U.S. Forest Service after an on site inspection. It utilizes an existing well pad, with the proposed pad being situated so as to protect a natural spring and disurb a minimum of timber. Also, the proposed location requires no access road, which meets USFS guidelines for off-road vehicle restriction.

Attached is a copy of a letter from Philip Settles of the Jicarilla Ranger District of Carson National Forest indicating their guidelines for development.

This well is in Nassau's Carracas Unit. As indicated by the attached lease plat, all offsetting leases are owned by Kindermac Partners, Inc. Kindermac, an operating affiliate of Nassau Resources, has been notified of this application.

Also attached are production and topographic maps of the area and a C-102 plat.

New Mexico Oil Conservation Division
Application for Unorthodox Location
Carracas Unit 17 B #15

September 2, 1988

Please contact us if anything further is required to complete this application.

Respectfully submitted,

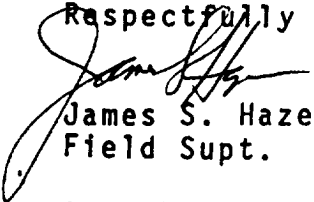

James S. Hazen
Field Supt.

Attachments

XC: Ernie Busch, NMOCD, Aztec, NM
Kindermac Partners

fp

All distances must be from the outer boundaries of the Section.

Operator Nassau Resources, Inc.		Lease Carracas Unit 17 B		Well No. 15
Unit Letter 0	Section 17	Township 32 North	Range 4 West	County Rio Arriba
Actual Footage Location of Well: 650 feet from the South line and 2070 feet from the East line				
Ground Level Elev. 7370	Producing Formation Fruitland	Pool W C Fruitland	Dedicated Acreage 160.0 Acres	

1. Outline the acreage dedicated to the subject well by colored pencil or hatchure marks on the plat below.
2. If more than one lease is dedicated to the well, outline each and identify the ownership thereof (both as to working interest and royalty).
3. If more than one lease of different ownership is dedicated to the well, have the interests of all owners been consolidated by communitization, unitization, force-pooling, etc?

☒ Yes ☐ No If answer is "yes," type of consolidation Carracas Unit - unitization

If answer is "no," list the owners and tract descriptions which have actually been consolidated. (Use reverse side of this form if necessary.)

No allowable will be assigned to the well until all interests have been consolidated (by communitization, unitization, forced-pooling, or otherwise) or until a non-standard unit, eliminating such interests, has been approved by the Division.

SECTION 17		<p>RECEIVED SEP 07 1988 OIL CON. DIV DIST. 3</p>	
<p>NM 28277 Kindermac Partners 100% Purchased from Mitchell Energy Co. 8/3/88</p>		<p>Nassau Resources, Inc. Carracas Unit 17 B #15 Appl. for Unorthodox Loc.</p>	

CERTIFICATION

I hereby certify that the information contained herein is true and complete to the best of my knowledge and belief.

Name
James S. Hazen
Position
Field Supt.
Company
Nassau Resources, Inc.
Date
9/6/88



Date Surveyed
August 24, 1988

Registered Professional Engineer
and/or Land Surveyor

Edgar L. Risenhoover
Certificate No. 5979

Edgar L. Risenhoover, L.S.

Township 32 North, Range 4 West, NMPM, Rio Arriba County, New Mexico

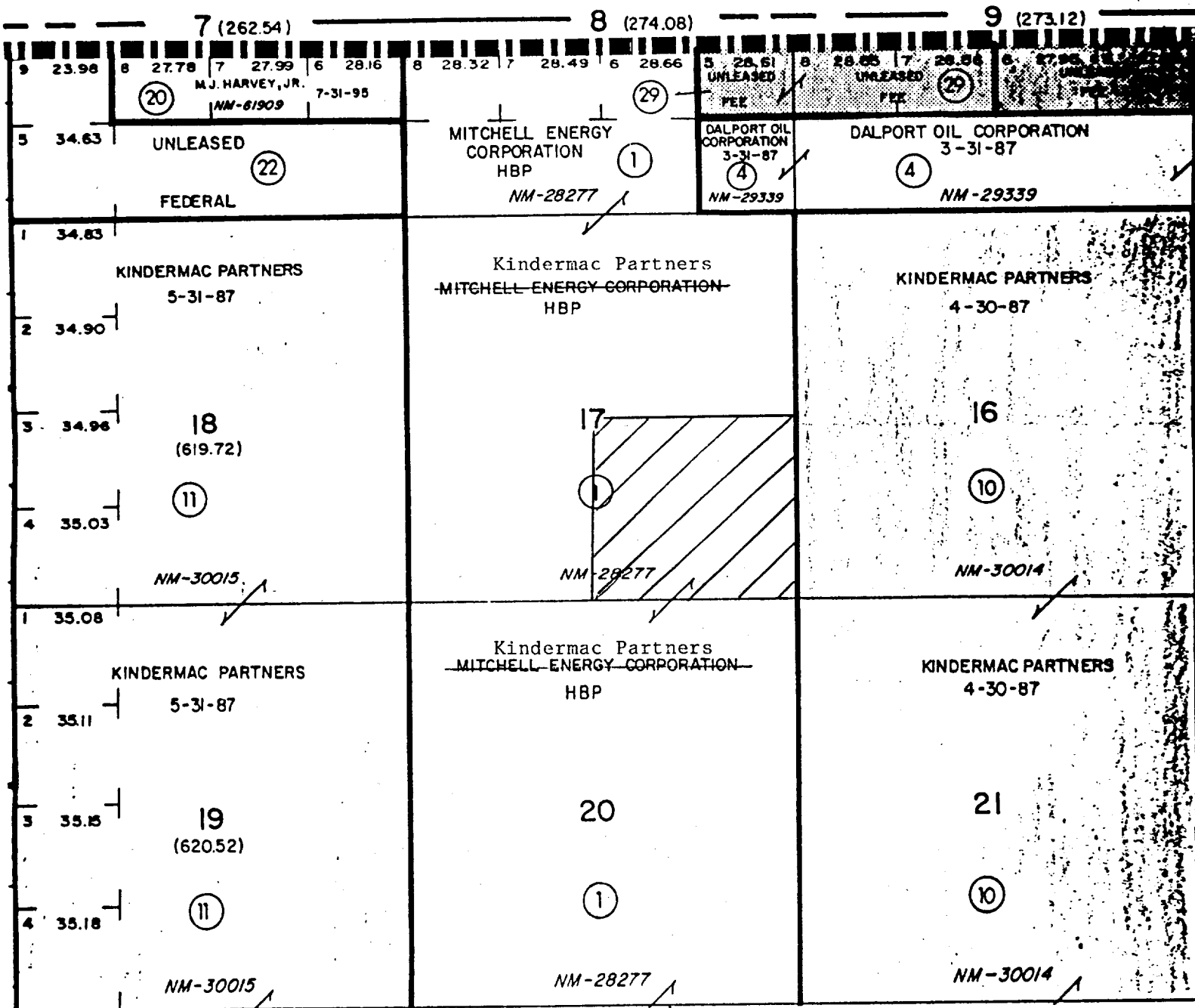

Kindermac Partners purchased
Fed. Ls. #NM 28277 from
Mitchell Energy Co. 8/3/88.

Nassau Resources, Inc.
Carracas Unit 17 B #15
Appl. for Unorthodox Loc.

BANCOS MESA QUADRANGLE

NEW MEXICO

7.5 MINUTE SERIES (TOPOGRAPHIC)

1558' 1.62500
PAGOSA JUN

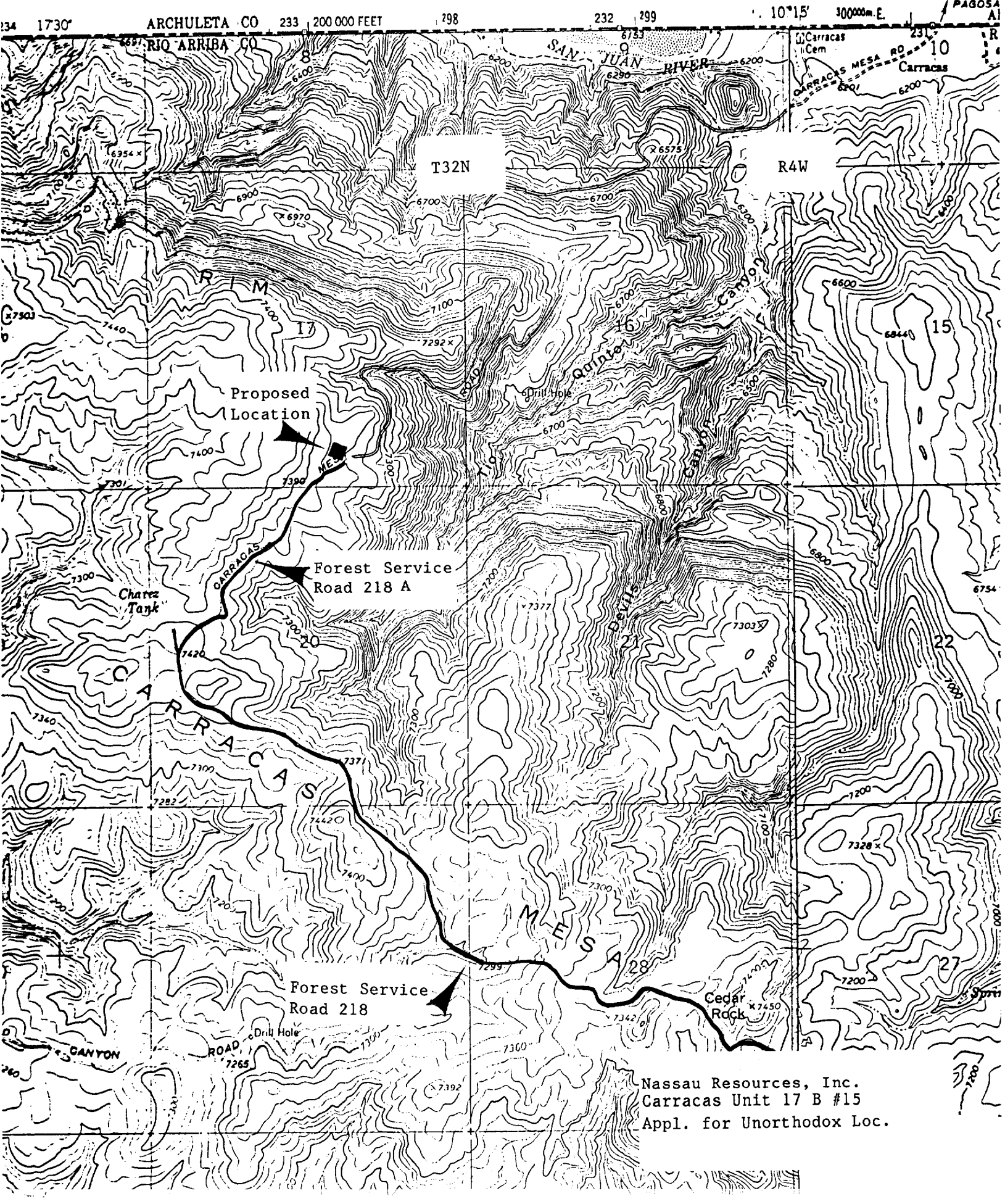

Nassau Resources, Inc.
Carracas Unit 17 B #15
Appl. for Unorthodox Loc.

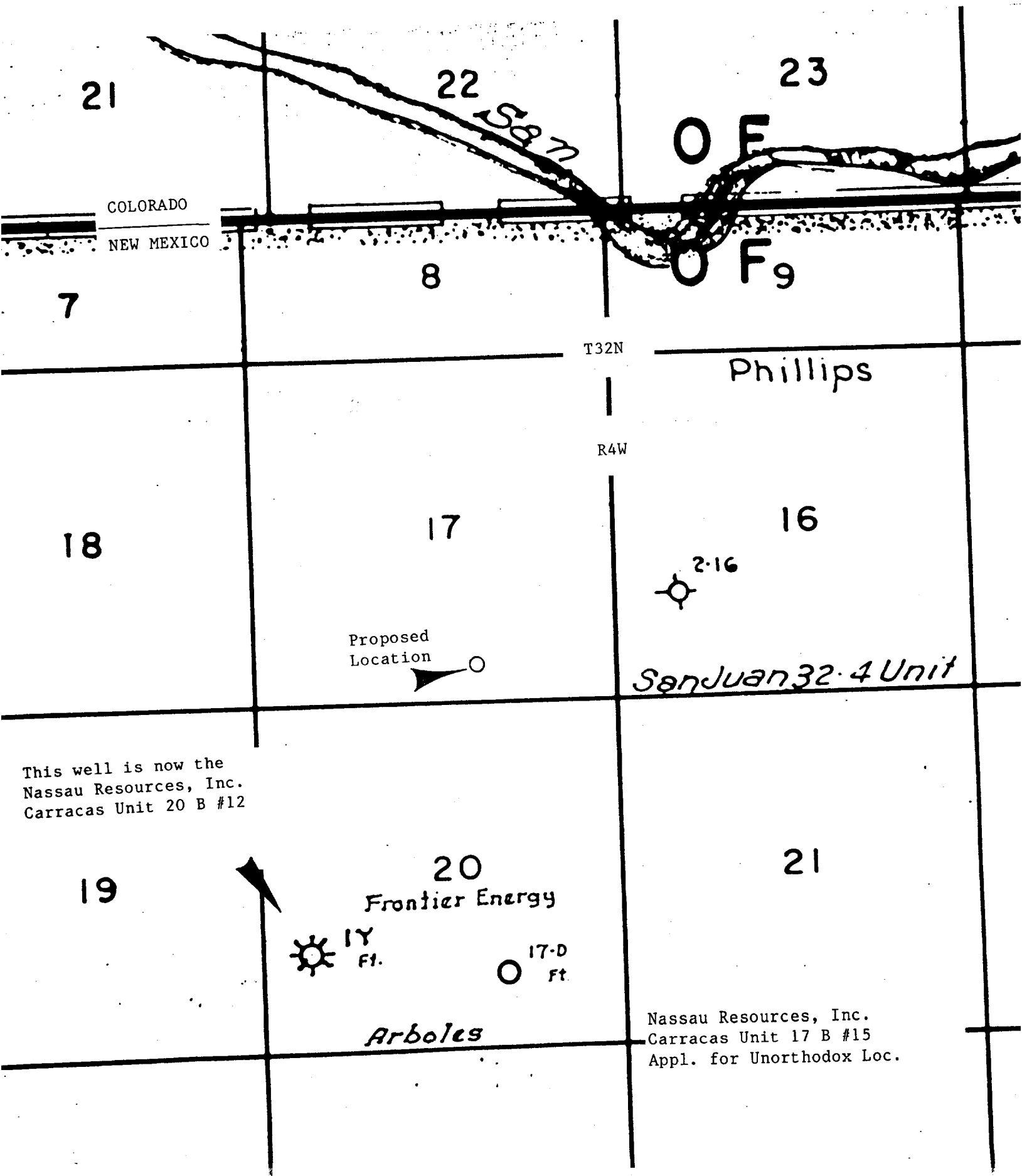



United States
Department of
Agriculture

Forest
Service

Jicarilla
Ranger District

Gobernador Route
Blanco, NM 87412

Reply to: 2820

Date: August 3, 1988

Mr. James Hazen
Nassau Resources, Inc.
P.O. Box 809
Farmington, New Mexico 87499

Dear James:

It was brought to my attention by Mike Atchison that you will be needing to apply for some unorthodox locations for some of the wells in the Carracas Unit. The current location in need of unorthodox approval is the well location just northwest of the Carracas Administrative site, Section 18, T. 32 N., R. 4 W. The need for moving the location to the new site is based upon wildlife habitat protection and in keeping within the guidelines set forth in the Carson Forest Plan. The Plan, as you know, has a major emphasis in wildlife and wildlife habitat. Also key to this request for moving the location is the current Off-Road-Vehicle restriction policy in place over the entire Carracas Unit. This restriction is in place to limit off-road-vehicle travel within a key wildlife management area so that security area will not be lost by unnecessary road construction.

Whenever possible, locations will be required to be placed along open access roads. Further unorthodox locations can be expected within the Carracas Unit to keep in line with the management direction set forth for this area.

Because of this management direction and the probability of future relocations, I would hope the approval of these unorthodox locations can become routine. If not, please don't hesitate to contact me for further help or if needed to appear in person before the approving officer. If you have any questions, please give me a call.

Sincerely,

Philip R. Settles

PHILIP R. SETTLES
District Forest Ranger

Jerome P. McHugh
Farmington, N.M.

CARING FOR THE LAND AND SERVING PEOPLE

Nassau Resources, Inc.
Carracas Unit 17 B #15
Appl. for Unorthodox Loc.



AUG 9 1988

RECEIVED