

Submit to Appropriate  
District Office  
State Lease - 4 copies  
Fee Lease - 3 copies

State of New Mexico  
Energy, Minerals and Natural Resources Department

Form C-102  
Revised 1-1-89

OIL CONSERVATION DIVISION

P.O. Box 2088  
Santa Fe, New Mexico 87504-2088

DISTRICT I  
P.O. Box 1980, Hobbs, NM 88240

DISTRICT II  
P.O. Drawer DD, Artesia, NM 88210

DISTRICT III  
1000 Rio Brazos Rd., Aztec, NM 87410

WELL LOCATION AND ACREAGE DEDICATION PLAT

All Distances must be from the outer boundaries of the section

Operator Nassau Resources, Inc.			Lease Carracas Unit 23 B		Well No. 8
Unit Letter H	Section 23	Township 32 North	Range 4 West	County Rio Arriba	
Actual Footage Location of Well: 1650 feet from the North line and 810 feet from the East line					
Ground level Elev. 6775	Producing Formation Fruitland Coal		Pool Basin Fruitland Coal		Dedicated Acreage: 320.0 Acres

1. Outline the acreage dedicated to the subject well by colored pencil or hatchure marks on the plat below.

2. If more than one lease is dedicated to the well, outline each and identify the ownership thereof (both as to working interest and royalty).

3. If more than one lease of different ownership is dedicated to the well, have the interest of all owners been consolidated by communitization, unitization, force-pooling, etc.?

☒ Yes ☐ No

If answer is "yes" type of consolidation Unit Agreement #14-08-0001-19596 (Tract #31 joined & ratified effective 12-14-89.)

If answer is "no" list the owners and tract descriptions which have actually been consolidated. (Use reverse side of this form if necessary.)

No allowable will be assigned to the well until all interests have been consolidated (by communitization, unitization, forced-pooling, or otherwise) or until a non-standard unit, eliminating such interest, has been approved by the Division.

OPERATOR CERTIFICATION

I hereby certify that the information contained herein is true and complete to the best of my knowledge and belief.

Signature

Fran Perrin

Printed Name

Fran Perrin

Position

Admin. Asst.

Company

Nassau Resources, Inc.

Date

10/15/90

SURVEYOR CERTIFICATION

I hereby certify that the well location shown on this plat was plotted from field notes of actual surveys made by me or under my supervision, and that the same is true and correct to the best of my knowledge and belief.

Date Surveyed

March 30, 1990

Signature & Seal of Professional Surveyor

EDGAR L. RISENHOOVER  
NEW MEXICO  
5279  
Edgar L. Risenhoover, P.S.

Certificate No. 5279

Edgar L. Risenhoover, P.S.

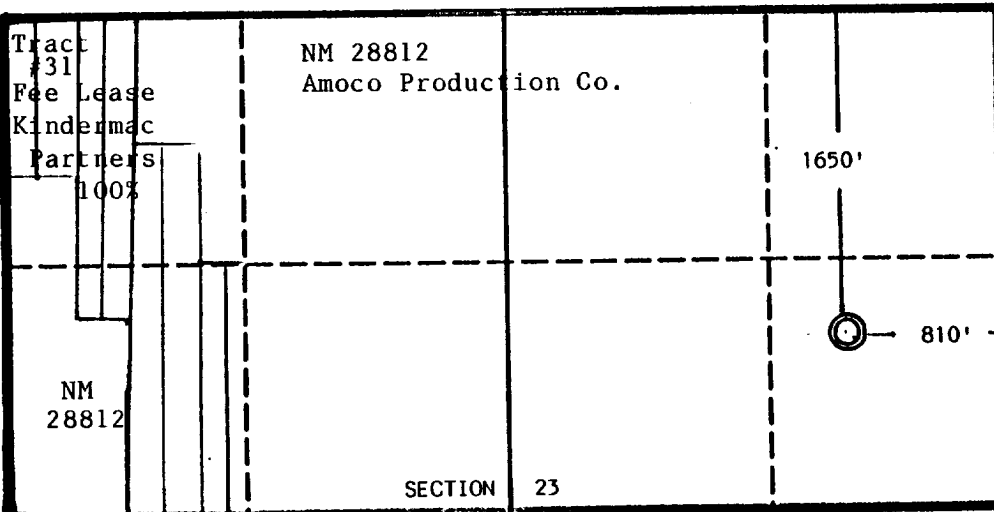

RECEIVED

OCT 18 1990

OIL CON. DIV.

DIST. 13

0 330 660 990 1320 1650 1980 2310 2640 2000 1500 1000 500 0