

4



STATE OF NEW MEXICO  
ENERGY, MINERALS AND NATURAL RESOURCES DEPARTMENT

OIL CONSERVATION DIVISION



BRUCE KING  
GOVERNOR

ANITA LOCKWOOD  
CABINET SECRETARY

September 29, 1992

POST OFFICE BOX 2088  
STATE LAND OFFICE BUILDING  
SANTA FE, NEW MEXICO 87504  
(505) 827-5800

Nassau Resources, Inc.  
c/o Jerome P. McHugh & Associates  
P.O. Box 809  
Farmington, New Mexico 87499-0809

**RECEIVED**  
OCT 02 1992  
OIL CON. DIV  
DIST. 3

Attention: Fran Perrin

*Administrative Order DD-68*

Dear Ms. Perrin:

Under the provisions of General Rule 111(c), (d) and (e), Jerome P. McHugh & Associates on behalf of the operator Nassau Resources, Inc. made application to the New Mexico Oil Conservation Division on September 8, 1992, for authorization to directionally drill its proposed Carracas Unit-PC 26-B Well No. 13, Rio Arriba County, New Mexico.

The Division Director Finds That:

- (1) The application has been dully filed under the provisions of Rule 111(d) and (e) of the Division General Rules and Regulations;
- (2) Satisfactory information has been provided that all offset operators have been duly notified;
- (3) The applicant has presented satisfactory evidence that all requirements prescribed in General Rule 111 will be met; and
- (4) No objections have been received within the waiting period prescribed by said rule.

IT IS THEREFORE ORDERED THAT:

(1) The operator, Nassau Resources, Inc., is hereby authorized to directionally drill its Carracas Unit-PC 26-B Well No. 13, the surface location of which shall be 1123 feet from the South line and 790 feet from the West line (Unit M) of Section 26, Township 32 North, Range 4 West, NMPM, Rio Arriba County, New Mexico, by kicking off from the vertical at a depth of approximately 3000 feet, and drilling in such a manner as to bottom in the Pictured Cliffs formation at a standard gas well location within the SW/4 SW/4 of said Section 26.

PROVIDED HOWEVER THAT prior to commencing directional drilling operations into said wellbore, the applicant shall establish the location of the kick-off point by means of a directional survey acceptable to the Division.

PROVIDED HOWEVER THAT during or upon completion of directional drilling operations, the applicant shall conduct an accurate wellbore survey from the kick-off point to total depth in order that the subsurface bottomhole location, as well as the wellbore's true depth and course, may be determined.

(2) The applicant shall notify the supervisor of the Aztec district office of the Division of the date and time said wellbore surveys are to be conducted so that they may be witnessed. The applicant shall further provide a copy of said wellbore surveys to the Santa Fe and Aztec offices of the Division upon completion.

(3) Form C-105 shall be filed in accordance with Division Rule 1105 and the operator shall indicate thereon true vertical depth in addition to measured depths.

(4) The SW/4 of said Section 26 shall be dedicated to the well forming a standard 160-acre gas spacing and proration unit for the Pictured Cliffs formation.

(5) Jurisdiction of this cause is retained for the entry of such further orders as the Division may deem necessary.

DONE at Santa Fe, New Mexico, on the day and year hereinabove designated.

STATE OF NEW MEXICO  
OIL CONSERVATION DIVISION

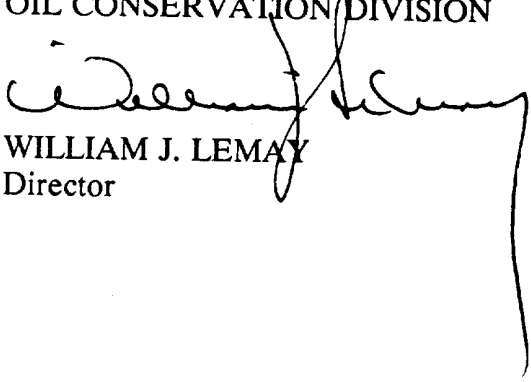
  
WILLIAM J. LEMAY  
Director

S E A L

cc: Oil Conservation Division - Aztec ✓  
U.S. BLM - Farmington



STATE OF NEW MEXICO  
ENERGY, MINERALS and NATURAL RESOURCES DEPARTMENT  
OIL CONSERVATION DIVISION  
AZTEC DISTRICT OFFICE

1000 RIO BRAZOS ROAD  
AZTEC, NEW MEXICO 87410  
(505) 334-6178

Date: 9-9-92

attn: Mike Stogner

Oil Conservation Division  
P.O. Box 2088  
Santa Fe, NM 87504-2088

RE: Proposed MC \_\_\_\_\_  
Proposed NSL \_\_\_\_\_  
Proposed WFX \_\_\_\_\_  
Proposed NSP \_\_\_\_\_

Proposed DHC \_\_\_\_\_  
Proposed SWD \_\_\_\_\_  
Proposed PMX \_\_\_\_\_  
Proposed DD X \_\_\_\_\_

Gentlemen:

I have examined the application received on 9-8-92

for the NASSAU RESOURCES, INC. CARRACAS Unit 268913  
OPERATOR LEASE & WELL NO.

M-26-32N-4W and my recommendations are as follows:  
UL-S-T-R

Approve  
\_\_\_\_\_  
\_\_\_\_\_  
\_\_\_\_\_  
\_\_\_\_\_  
\_\_\_\_\_

Yours truly,

Eric Bush



Jerome P. McHugh & Associates  
Operating Affiliate: **Nassau Resources, Inc.**  
P O Box 809, Farmington, NM 87499-0809  
(505) 326-7793 Fax (505) 327-0859

September 3, 1992

CERTIFIED MAIL - RETURN RECEIPT REQUESTED

New Mexico Oil Conservation Division  
Attn: Michael Stogner  
P O Box 2088  
Santa Fe, New Mexico 87504

**RECEIVED**  
SEP 08 1992  
OIL CON. DIV.  
DIST. 3

RE: Application for Administrative Approval of  
Directional Drilling  
Nassau Resources, Inc., Carracas Unit-PC 26 B #13  
Section 26, T32N, R4W, NMPM  
Rio Arriba County, New Mexico

Dear Mr. Stogner:

Nassau Resources, Inc., hereby requests administrative approval to directionally drill the subject well as follows:

Proposed Surface Location:	1123' FSL and 790' FWL
Proposed Bottom Hole Location:	1090' FSL and 990' FWL (within a 100' radius)
True Vertical Depth:	Approx. 4240'
Measured Depth:	Approx. 4262'

This surface location is on the present location of the Carracas Unit 26 B #13 (Fruitland Coal) well. No new construction will be required; a closed mud system will be utilized on the present well pad during drilling and completion operations. The proposed bottom hole location is a standard location for a Pictured Cliffs well.

This well is in Nassau's Carracas Unit. Amoco, a party to the unit, has been notified of this application. Kindermac Partners is an affiliate with Nassau Resources, Inc. and has been notified.

Attached are copies of the pending APD (including the directional plan and C-102 plat), a lease plat and a topographic map showing both the surface and bottom hole locations. A copy of the approved APD will be forwarded to your office as soon as it is available.

NMOCD - September 3, 1992

Page 2

Application for Administrative Approval of Directional Drilling

Please contact me immediately if anything further is required to complete this application. Since we are restricted by the Forest Service from drilling between November 1 and April 15, we respectfully request that this application be expedited in any way possible so that the well can be drilled this year.

Thank you,

*Fran Perrin*

Fran Perrin  
Regulatory Liaison

xc: Ernie Busch, NMOCD  
Kindermac Partners  
Amoco Production Co.

Attachments

Form-3160-3  
(December 1990)

1 OCD in Aztec 1 OCD in Santa Fé

SUBMIT IN TRIPLICATE\*  
(Other instructions on  
reverse side)

Form approved.  
Budget Bureau No. 1004-0136  
Expires: December 31, 1991

UNITED STATES  
DEPARTMENT OF THE INTERIOR  
BUREAU OF LAND MANAGEMENT

APPLICATION FOR PERMIT TO DRILL OR DEEPEN

1a. TYPE OF WORK

DRILL ☒

DEEPEN ☐

b. TYPE OF WELL

OIL  
WELL ☐

GAS  
WELL ☒

OTHER

SINGLE  
ZONE ☒

MULTIPLE  
ZONE ☐

2. NAME OF OPERATOR

NASSAU RESOURCES, INC.

3. ADDRESS AND TELEPHONE NO.

P O Box 809, Farmington, N.M. 87499

4. LOCATION OF WELL (Report location clearly and in accordance with any State requirements.)\*

At surface

Surface Location:

1123' FSL & 790' FWL

At proposed prod. zone

Bottom Hole Location:

1090' FSL & 990' FWL (within 100' radius)

14. DISTANCE IN MILES AND DIRECTION FROM NEAREST TOWN OR POST OFFICE\*

± 32 miles NE of Gobernador, N.M.

15. DISTANCE FROM PROPOSED\* Bottom Hole

LOCATION TO NEAREST

PROPERTY OR LEASE LINE, FT.

(Also to nearest drig. unit line, if any)

990'

18. DISTANCE FROM PROPOSED LOCATION\*

TO NEAREST WELL, DRILLING, COMPLETED, 300' to a

OR APPLIED FOR, ON THIS LEASE, FT.

Fr. Coal well

16. NO. OF ACRES IN LEASE

2,522.12

19. PROPOSED DEPTH

4240' VD, 4262' MD

17. NO. OF ACRES ASSIGNED  
TO THIS WELL

160.0

20. ROTARY OR CABLE TOOLS

TD

21. ELEVATIONS (Show whether DF, RT, GR, etc.)

7045' GL, 7057' RKB

22. APPROX. DATE WORK WILL START\*

9/20/92

23.

PROPOSED CASING AND CEMENTING PROGRAM

SIZE OF HOLE	GRADE SIZE OF CASING	WEIGHT PER FOOT	SETTING DEPTH	QUANTITY OF CEMENT
12-1/4"	9-5/8"	36#	250'	150 cu.ft. circ. to surf.
7-7/8"	5-1/2"	15.5#	4262' MD	924 cu.ft. circ. to surf.

Plan to drill directionally with spud mud to set 250' of surface casing. Will then drill with water and gel-chem. mud to test the Pictured Cliffs coal zone at +4240' VD. Will run DIL-GR-SP and FDC-CNL-GR Caliper and directional survey. If well appears productive, will set 5-1/2" casing at TD, cement in 1 stage, selectively perforate, frac, clean out after frac and complete with 2-7/8" tubing.

NOTE: The surface location will be on the present location of the Carracas Unit 26 B #13 (Fruitland Coal) well.

GAS IS NOT DEDICATED.

RECEIVED  
SEP 08 1992

IN ABOVE SPACE DESCRIBE PROPOSED PROGRAM: If proposal is to deepen, give data on present productive zone and proposed new productive zone. If proposal is to drill or deepen directionally, give pertinent data on subsurface locations and measured and true vertical depths. Give blowout preventer program, if any.

24.

SIGNED

*Fran Perrin*  
Fran Perrin

TITLE

Regulatory Liaison

DATE

9/3/92

(This space for Federal or State office use)

PERMIT NO.

APPROVAL DATE

Application approval does not warrant or certify that the applicant holds legal or equitable title to those rights in the subject lease which would entitle the applicant to conduct operations thereon.

CONDITIONS OF APPROVAL, IF ANY:

APPROVED BY

TITLE

DATE

\*See Instructions On Reverse Side

Title 18 U.S.C. Section 1001, makes it a crime for any person knowingly and willfully to make to any department or agency of the United States any false, fictitious or fraudulent statements or representations as to any matter within its jurisdiction.

Submit to Appropriate  
District Office  
State Lease - 4 copies  
Fee Lease - 3 copies

State of New Mexico  
Energy, Minerals and Natural Resources Department

Form C-102  
Revised 1-1-89

OIL CONSERVATION DIVISION

P.O. Box 2088

Santa Fe, New Mexico 87504-2088

DISTRICT I

P.O. Box 1980, Hobbs, NM 88240

DISTRICT II

P.O. Drawer DD, Artesia, NM 88210

DISTRICT III

1000 Rio Brazos Rd., Aztec, NM 87410

WELL LOCATION AND ACREAGE DEDICATION PLAT

All Distances must be from the outer boundaries of the section

Operator Nassau Resources, Inc.			Lease Carracas Unit 26 B		Well No. 13
Unit Letter M	Section 26	Township 32 North	Range 4 West	County Rio Arriba	
Actual Footage Location of Well: 1123 feet from the South line and 790 feet from the West line					
Ground level Elev. 7045 Est.	Producing Formation Pictured Cliffs	Pool WC	Dedicated Acreage: 160.0 Acres		
<del>Undesignated Pictured Cliffs</del>					

- Outline the acreage dedicated to the subject well by colored pencil or hatchure marks on the plat below.
- If more than one lease is dedicated to the well, outline each and identify the ownership thereof (both as to working interest and royalty).
- If more than one lease of different ownership is dedicated to the well, have the interest of all owners been consolidated by communitization, unitization, force-pooling, etc.?  
☒ Yes ☐ No If answer is "yes" type of consolidation Unitization - Carracas Unit  
If answer is "no" list the owners and tract descriptions which have actually been consolidated. (Use reverse side of this form if necessary.)  
No allowable will be assigned to the well until all interests have been consolidated (by communitization, unitization, forced-pooling, or otherwise) or until a non-standard unit, eliminating such interest, has been approved by the Division.

OPERATOR CERTIFICATION

I hereby certify that the information contained herein is true and complete to the best of my knowledge and belief.

Signature

*Fran Perrin*

Printed Name

Fran Perrin

Position

Regulatory Liaison

Company

Nassau Resources, Inc.

Date

9/3/92

SURVEYOR CERTIFICATION

I hereby certify that the well location shown on this plat was plotted from field notes of actual surveys made by me or under my supervision, and that the same is true and correct to the best of my knowledge and belief.

Date Surveyed

September 2, 1992

Signature & Seal of  
Professional Surveyor

*Edgar L. Risenhoover*  
Certification No. 5979  
Edgar L. Risenhoover, P.S.

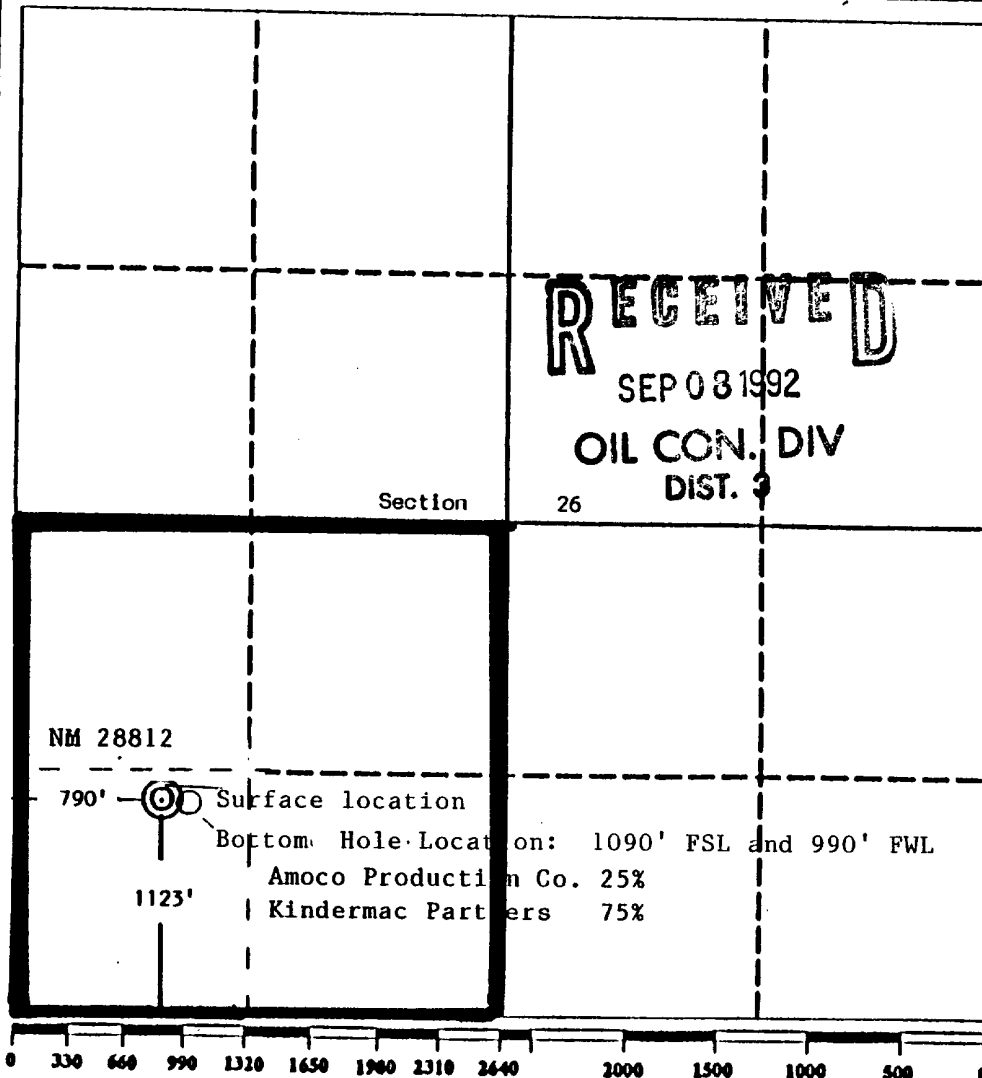

NASSAU RESOURCES, INC.  
CARRACAS UNIT-PC 26 B #13  
DEVELOPMENT PLAN

This well will be drilled as a "twin" well, from the existing location of the Carracas Unit 26 B #13 (Fruitland Coal) directionally to the Pictured Cliffs formation.

1. Existing roads are shown on Exhibit F.  
Existing road will be maintained in the same or better condition than present.
2. Planned access road                      NO NEW ACCESS ROAD
3. Location of existing wells is shown on Exhibit G.
4. Location of existing and/or proposed facilities.
  - A. Existing facilities owned or controlled by lessee/operator are shown on Exhibits G and I.
  - B. New facilities, in the event of production, are shown on Exhibit I.
  - C. Protective measures and devices to protect livestock and wildlife will be installed as required.
  - D. No new construction is planned except production equipment; however, rehabilitation will be performed as required by the surface management agency.
5. Location and Type of Water Supply.
  - A. Location and type of water supply: BANCOS WATER HOLE, Sec. 14, T31N, R4W (See Exhibit G.)
  - B. Method of transporting water: TRUCK
  - C. Water well is not to be drilled on lease.
6. Source of Construction Materials    NO NEW CONSTRUCTION
7. Methods for Handling Waste Disposal
  - A. Waste materials will be contained/disposed of as follows:
    - 1) Cuttings: CLOSED MUD SYSTEM
    - 2) Drilling fluids: CLOSED MUD SYSTEM
    - 3) Produced fluids (oil, water): TANKS
    - 4) Sewage: Drilling contractor will provide facilities.
    - 5) Garbage and other waste material: Operator will provide a trash basket.
    - 6) Operator will be responsible for proper cleanup when the rig is moved.
8. Ancillary facilities  
No permanent camp is planned; a trailer house will be used on location while drilling. No airstrip is planned.
9. Well site layout is shown on Exhibit C.

10. Plans for restoration of surface upon completion of operations: Production equipment will be painted the color designated by the surface managing agency. Reseeding and rehabilitation will be done if directed by the surface management agency.

When the well is abandoned, the location and access road will be cleaned and restored to the original topographical contours as much as possible. The area will be reseeded with the appropriate seed mixture.

11. Surface Ownership JICARILLA RANGER DISTRICT, U S FOR. SER.  
GOVERNADOR ROUTE, BLANCO, NM 87412

12. Other Information

Refer to the archaeological report for a description of the topography, flora, fauna, soil characteristics, dwellings, historical and cultural sites: MOORE ANTHROPOLOGICAL RESEARCH, TECHNICAL REPORT NO. 89-27, JUNE 12, 1989, FOR CARRACAS UNIT 26 B #13 (FRUITLAND COAL) WELL.

Proximity of:

- 1) Water - 1/2 mile
- 2) Occupied dwellings - 1-1/2 miles
- 3) archeological - See archeological report.
- 4) Historical or cultural sites - See archeological report.

13. Lessee's or Operator's Representative

Murphy Brasuel	Gary Johnson
Nassau Resources, Inc.	Nassau Resources, Inc.
P O Box 809	650 Cherry St. #1225
Farmington, N.M. 87499-0809	Denver, CO 80222

14. I hereby certify that I, or persons under my direct supervision, have inspected the proposed drill site and access route; that the statements made in the Plan are, to the best of my knowledge true and correct; and, that the work associated with the operations proposed herein will be performed by Nassau Resources, Inc. and its contractors and subcontractors in conformity with this Plan and the terms and conditions under which it is approved.

By: Murphy Brasuel  
Murphy Brasuel, Field Superintendent

Date: 9-3-92

## OPERATIONS PLAN

OPERATOR: NASSAU RESOURCES, INC.  
WELL NAME: Carracas Unit-PC 26 B #13  
FIELD: Undesignated Pictured Cliffs  
LOCATION: Surface Location: 1123' FSL & 790' FWL  
Bottom Hole Location: 1090' FSL & 990' FWL  
Sec. 26, T32N, R4W, NMPM  
Rio Arriba County, New Mexico  
ELEVATION: 7045' GL, 7057' RKB

EXPECTED FORMATION TOPS:	<u>Vertical Depth</u>	<u>Measured Depth</u>
Ojo Alamo	3384'	3385'
Kirtland	3510'	3511'
Fruitland	3760'	3765'
Fruitland Coal	3968'	3978'
Pictured Cliffs	4040'	4053'
Total Depth	4240'	4262'

LOGGING PROGRAM: DIL-GR-SP & FDC-CNL-GR-Caliper & Directional Survey

SAMPLES: Catch samples every 10' from 3960' MD to TD.

### CASING PROGRAM:

<u>Hole Size</u>	<u>Depth</u>	<u>Csg. Size</u>	<u>Wt./Ft.</u>	<u>Grade &amp; Condition</u>
12-1/4"	250'	9-5/8"	36#	J-55, New
Cement:	125 sx	Class "B"	w/ 2% CaCl	(150 cu.ft.)
7-7/8"	4262'	5-1/2"	15.5#	K-55, New
Cement:	637 sx	50/50 poz w/ 2% gel,	6-1/4#/sk	gilsonite & 1/4#/sk flowseal (924 cu.ft.)

Regarding the cementing of 5-1/2" casing, centralizers will be placed on each joint through usable water zones with turbulators installed just below and into the base of the Ojo Alamo. A chronological log of the cement job will be kept.

WELLHEAD EQUIPMENT: 9-5/8" x 11" 600 series Bradenhead & 11" x 7-1/16" 600 series, 2000 psi working pressure well head.

### TECHNICAL PERSONNEL:

Murphy Brasuel, Field Supt.  
Nassau Resources, Inc.  
P O Box 809  
Farmington, NM 87499  
(505) 326-7793 Office  
(505) 289-3335 Home

Gary Johnson, Petroleum Engr.  
Nassau Resources, Inc.  
650 South Cherry St. #1225  
Denver, CO 80222  
(303) 321-2111 Office  
(303) 688-9864 Home

Location : RIO ARRIBA, NEW MEXICO

POINT	MO	INC	DIR	TVB	NORTH	EAST
TIE DN	8	0.08	99.37	8	8	0
KOP	3011	0.08	99.37	3011	8	0
CNS OF BLAD	4211	18.08	88.37	4192	-30	184
TARGET	4282	18.08	88.37	4248	-33	208

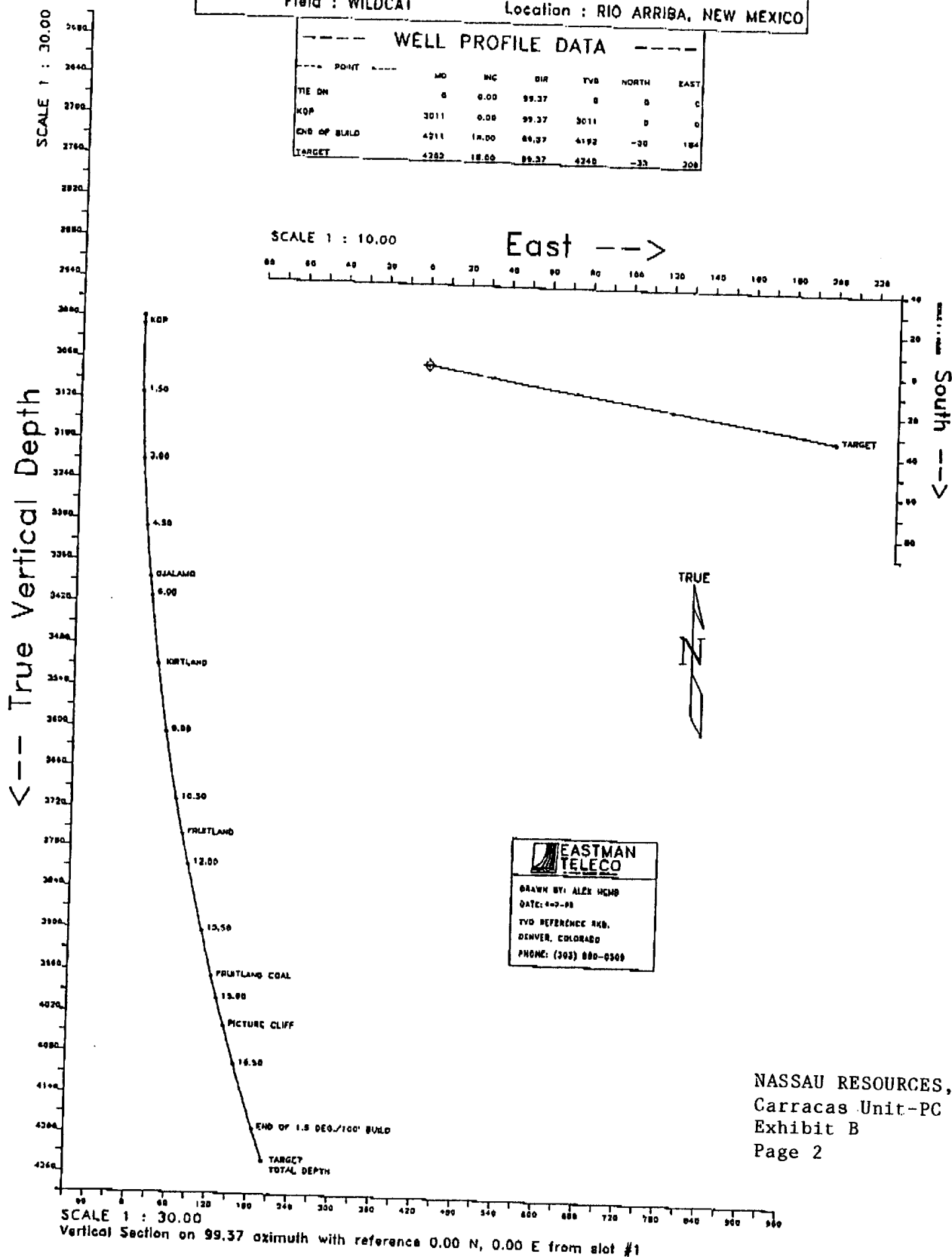

NASSAU RESOURCES  
SEC. 26 T32N-R4W, PRELIMINARY  
WILDCAT, RIO ARRIBA, NEW MEXICO

PROPOSAL LISTING Page 2  
Your ref : PRELIMINARY#2  
Last revised : 2-Sep-92

## Comments in wellpath

MD	TVD	Rectangular Coords.		Comment
3011.16	3011.16	0.00 N	0.00 E	KOP
3384.59	3384.00	2.97 S	18.00 E	OJALAMO
3511.43	3510.00	5.32 S	32.28 E	KIRTLAND
3764.88	3760.00	12.07 S	73.13 E	FRUITLAND
3978.30	3968.00	19.83 S	120.16 E	FRUITLAND COAL
4052.86	4040.00	22.98 S	139.28 E	PICTURE CLIFF
4211.16	4191.51	30.44 S	184.46 E	END OF 1.5 DEG./100' BUILD
4262.14	4240.00	33.00 S	200.00 E	TOTAL DEPTH

## Targets associated with this wellpath

Target name	Position	T.V.D. Local rectangular coords. Date revised		
TARGET	not specified	4240.00	33.00S	200.00E 2-Sep-92

All data is in feet unless otherwise stated  
Coordinates are from slot #1 and TVDs are from wellhead.  
Slot coordinates are 0.00 N 0.00 E.  
Bottom hole distance is 202.70 on azimuth 99.37 degrees from wellhead.  
Total Dogleg for wellpath is 18.00 degrees.  
Vertical section is from wellhead on azimuth 99.37 degrees.  
Calculation uses the minimum curvature method.

NASSAU RESOURCES, INC.  
Carracas Unit-PC 26 B #13  
Exhibit B  
Page 3

NASSAU RESOURCES  
SEC. 26 T32N-R4W, PRELIMINARY  
WILDCAT, RIO ARRIBA, NEW MEXICO

PROPOSAL LISTING Page 1  
Your ref : PRELIMINARY#2  
Last revised : 2-Sep-92

Measured Depth	Inclin. Degrees	Azimuth Degrees	True Vert. Depth	R E C T A N G U L A R C O O R D I N A T E S		Dogleg Deg/100Ft	Vert Sect
0.00	0.00	99.37	0.00	0.00 N	0.00 E	0.00	0.00
500.00	0.00	99.37	500.00	0.00 N	0.00 E	0.00	0.00
1000.00	0.00	99.37	1000.00	0.00 N	0.00 E	0.00	0.00
1500.00	0.00	99.37	1500.00	0.00 N	0.00 E	0.00	0.00
2000.00	0.00	99.37	2000.00	0.00 N	0.00 E	0.00	0.00
2500.00	0.00	99.37	2500.00	0.00 N	0.00 E	0.00	0.00
3000.00	0.00	99.37	3000.00	0.00 N	0.00 E	0.00	0.00
3011.16	0.00	99.37	3011.16	0.00 N	0.00 E	0.00	0.00 KOP
3111.16	1.50	99.37	3111.14	0.21 S	1.29 E	1.50	1.31
3211.16	3.00	99.37	3211.06	0.85 S	5.16 E	1.50	5.23
3311.16	4.50	99.37	3310.85	1.92 S	11.62 E	1.50	11.77
3384.59	5.60	99.37	3384.00	2.97 S	18.00 E	1.50	18.24 OJALAMO
3411.16	6.00	99.37	3410.42	3.41 S	20.64 E	1.50	20.92
3511.16	7.50	99.37	3509.73	5.32 S	32.24 E	1.50	32.68
3511.43	7.50	99.37	3510.00	5.32 S	32.28 E	1.50	32.71 KIRTLAND
3611.16	9.00	99.37	3608.69	7.66 S	46.40 E	1.50	47.03
3711.16	10.50	99.37	3707.24	10.41 S	63.11 E	1.50	63.96
3764.88	11.30	99.37	3760.00	12.07 S	73.13 E	1.50	74.12 FRUITLAND
3811.16	12.00	99.37	3805.32	13.59 S	82.36 E	1.50	83.47
3911.16	13.50	99.37	3902.85	17.18 S	104.13 E	1.50	105.54
3978.30	14.51	99.37	3968.00	19.83 S	120.16 E	1.50	121.79 FRUITLAND COAL
4011.16	15.00	99.37	3999.77	21.19 S	128.42 E	1.50	130.15
4052.86	15.62	99.37	4040.00	22.98 S	139.28 E	1.50	141.17 PICTURE CLIFF
4111.16	16.50	99.37	4096.02	25.61 S	155.20 E	1.50	157.30
4211.16	18.00	99.37	4191.51	30.44 S	184.46 E	1.50	186.95 END OF 1.5 DEG./100' BUILD
4262.14	18.00	99.37	4240.00	33.00 S	200.00 E	0.00	202.70 TOTAL DEPTH

All data is in feet unless otherwise stated  
Coordinates are from slot #1 and TVDs are from wellhead.  
Vertical section is from wellhead on azimuth 99.37 degrees.  
Calculation uses the minimum curvature method.

NASSAU RESOURCES, INC.  
Carracas Unit-PC 26 B #13  
Exhibit B  
page 4

# LOCATION LAYOUT FOR PICTURED CLIFFS WELL

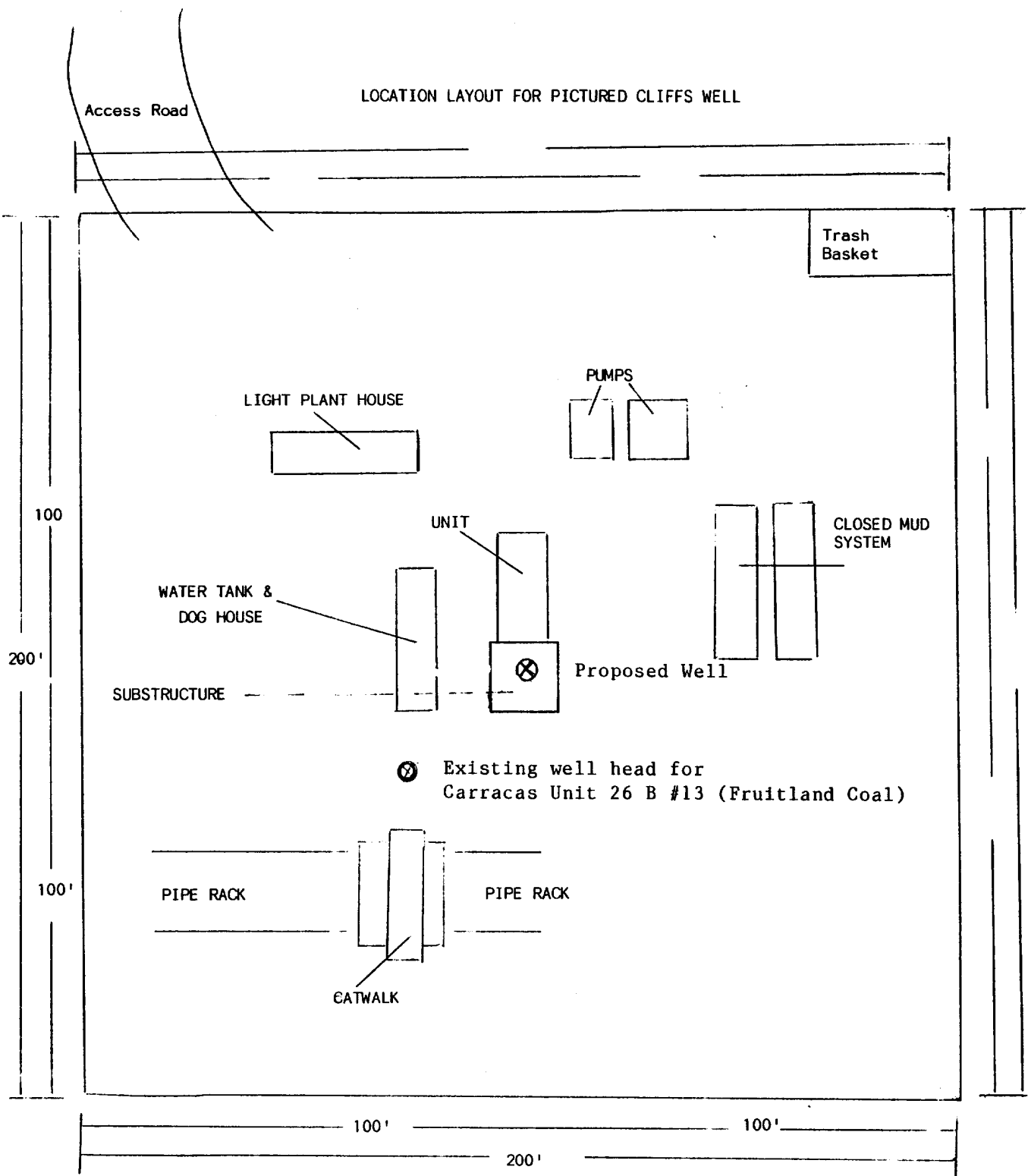

N

NASSAU RESOURCES, INC.  
Carracas Unit-PC 26 B #13  
Exhibit C

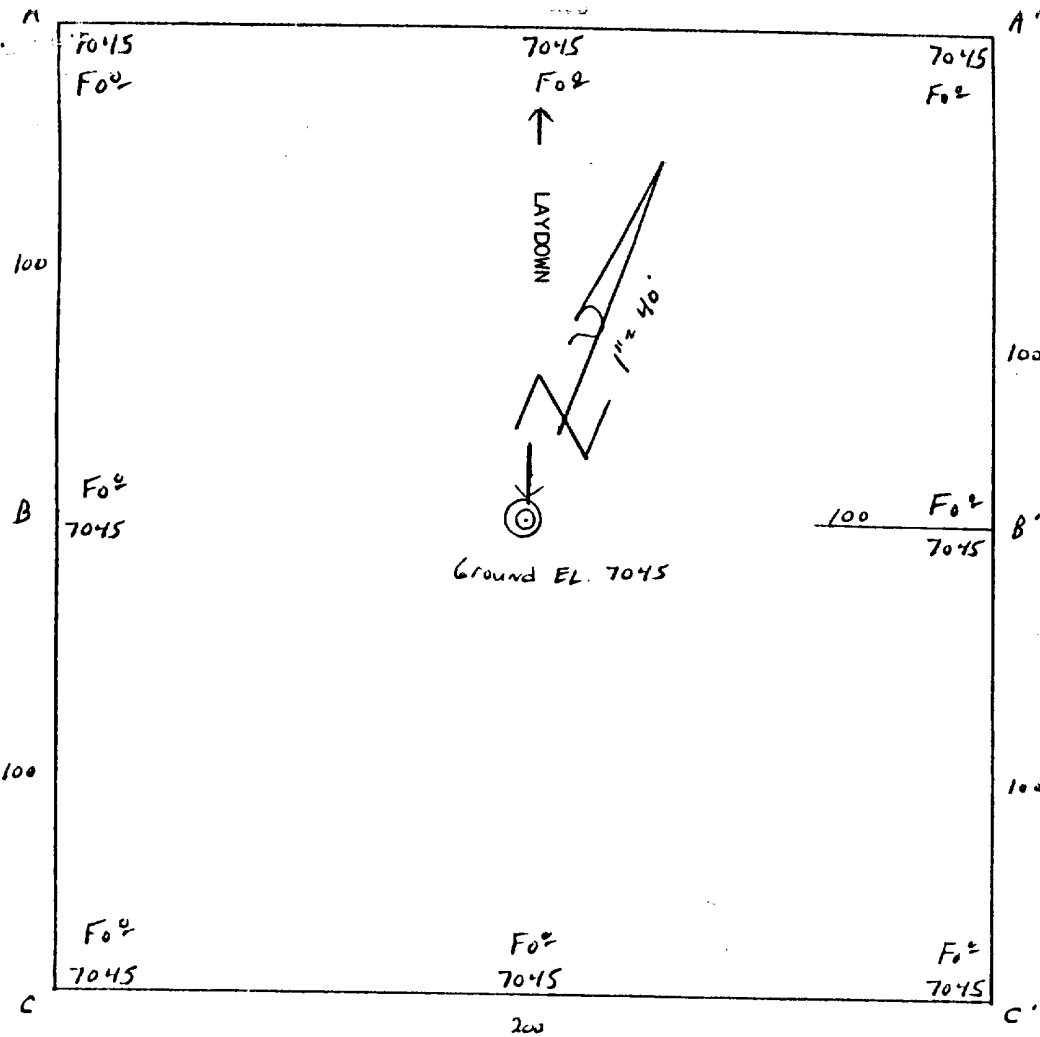

Nassau Resources, Inc.

OPERATOR

Carracas Unit-PC 26 B #13

WELL NAME and NUMBER

1123' F/SL

790' F/WL

FOOTAGES

26

32N

4W

SEC.

TWP.

RGE.

Rio Arriba, New Mexico

COUNTY

STATE

September 2, 1992

DATE

A					
	7050				7045
	7040	↘	↘	↘	↘
A'					

SCALE

Horiz. 1" = 40'

Vert. 1" = 30'

B					
	7050				7045
	7040	↘	↘	● ↘	↘
B'					

NASSAU RESOURCES, INC.  
Carracas Unit-PC 26 B #13  
Exhibit D

C					
	7050				7045
	7040	↘	↘	↘	↘
C'					

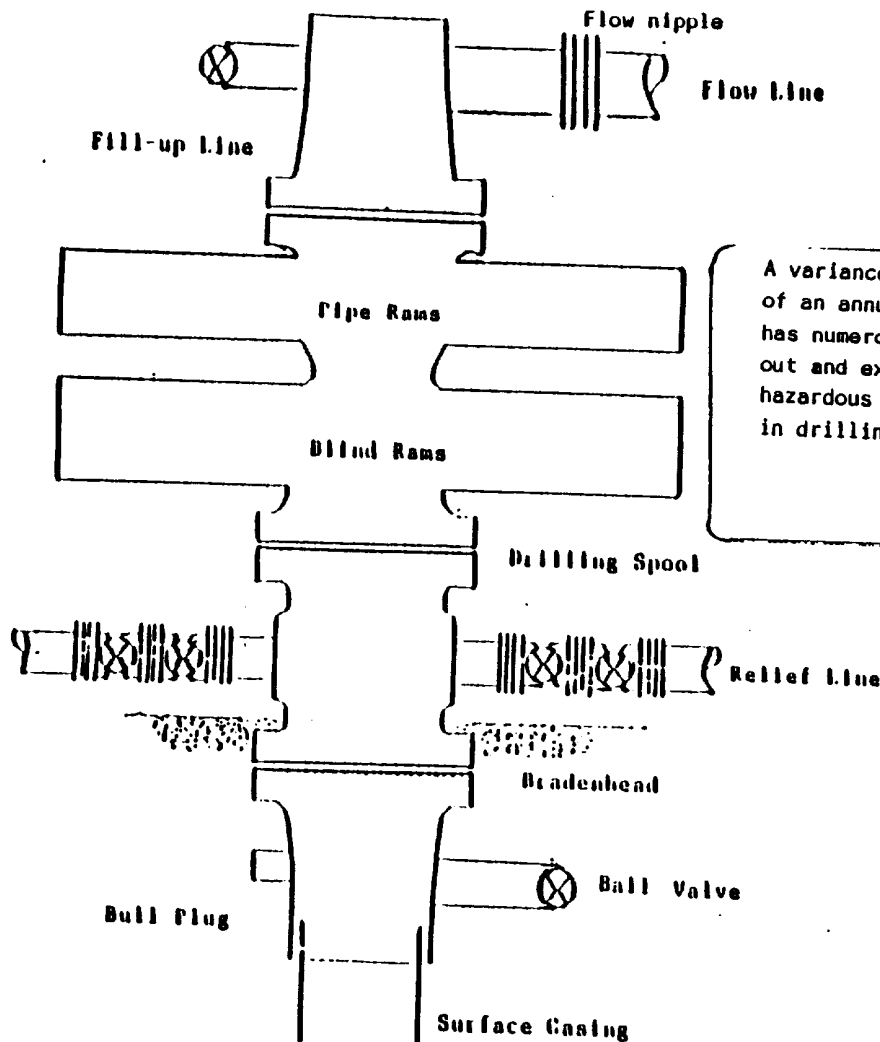

A variance is requested on the use of an annular preventer. The area has numerous wells drilled through-out and excessive pressures or hazardous zones are not expected in drilling this well.

Series 900 Double gate BOP, rated at 3000 psi working pressure. When gas drilling operations begin, a Shaffer type 50 or equivalent rotating head is installed on top of the flow nipple and the flow line is converted into a blowline. Upper Kelly cock valve will be in place with handle on rig floor at all times along with Safety valve and subs for drill string in use.

The kill lines will be a minimum of 2".

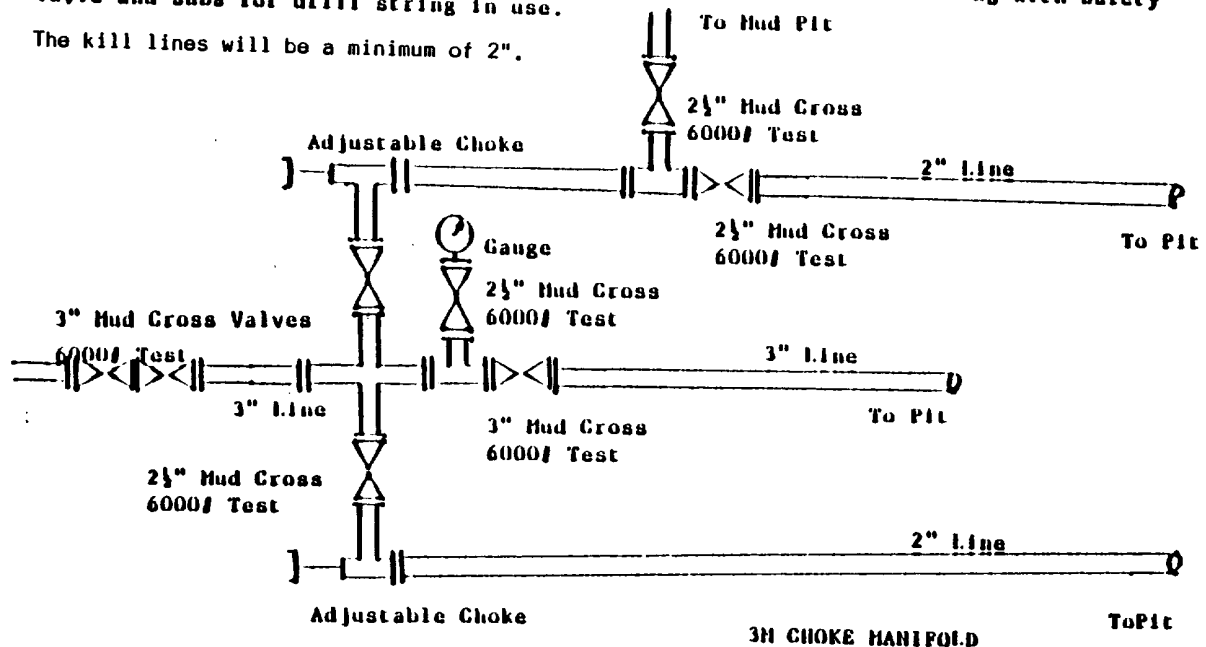

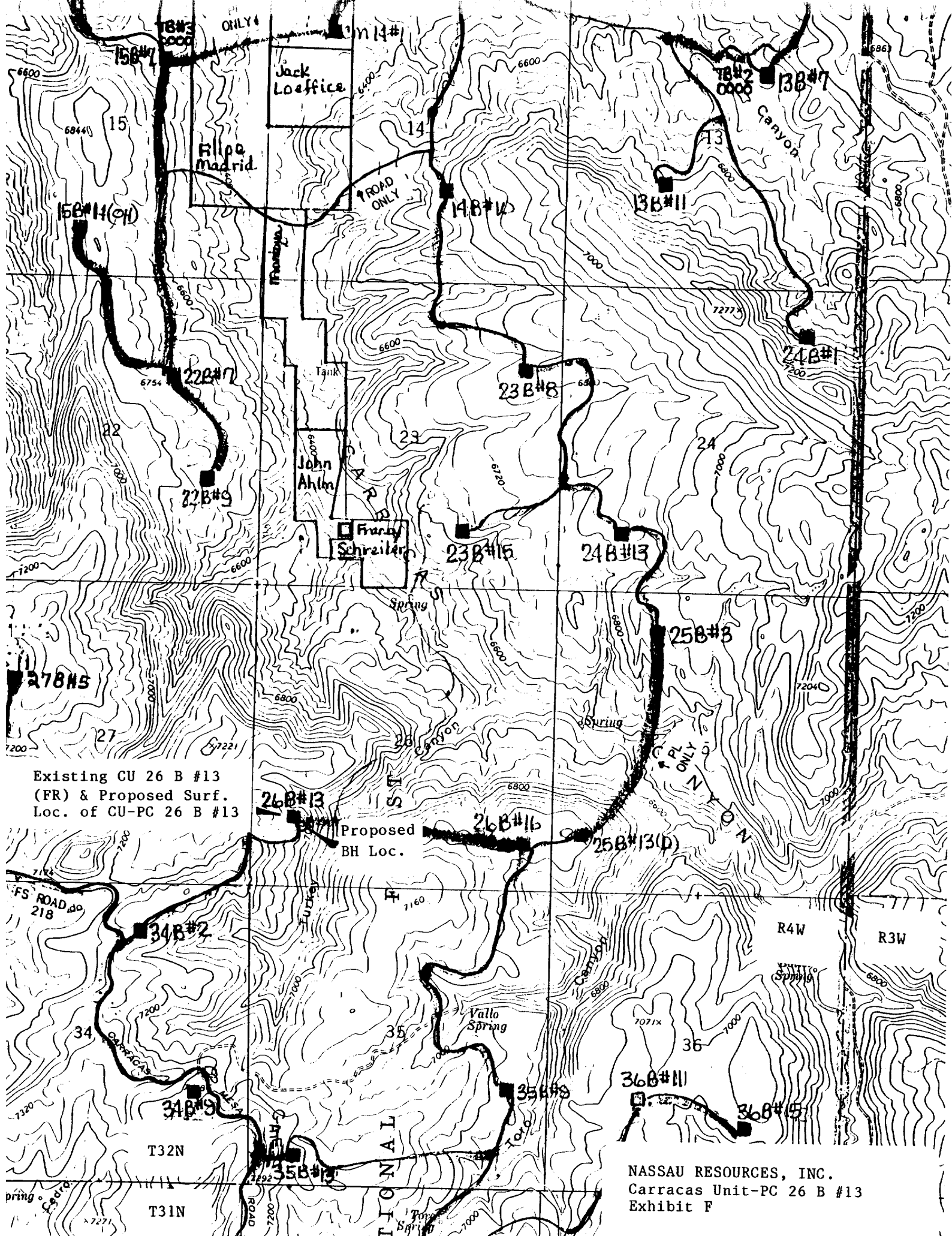

Existing CU 26 B #13  
(FR) & Proposed Surf.  
Loc. of CU-PC 26 B #13

NASSAU RESOURCES, INC.  
Carracas Unit-PC 26 B #13  
Exhibit F

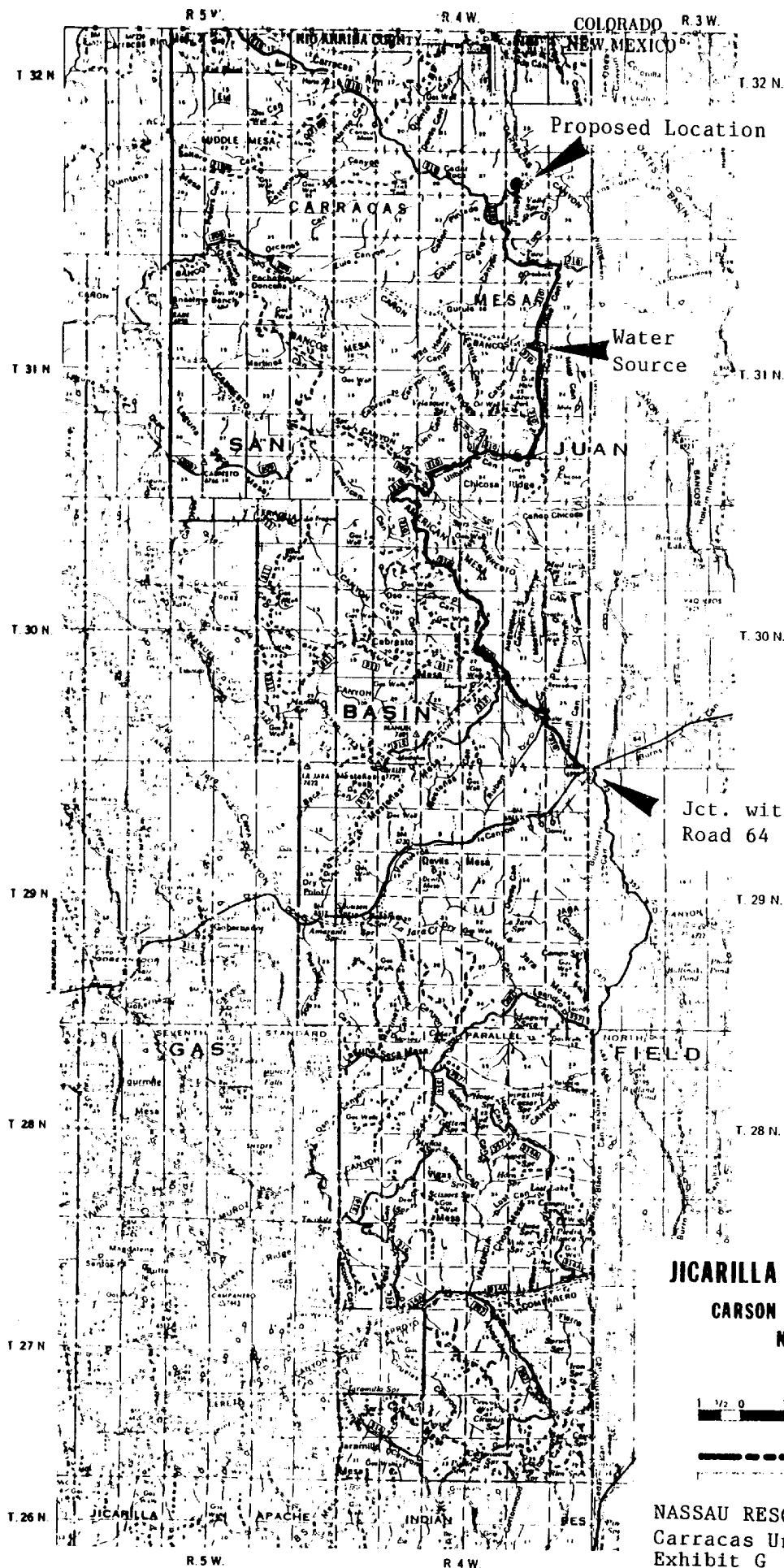

**JICARILLA RANGER DISTRICT**  
**CARSON NATIONAL FOREST**  
**NEW MEXICO**

1977

Scale

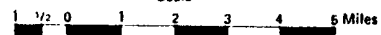

**LEGEND**

- Ranger District Boundary
- ..... National Forest Land

NASSAU RESOURCES, INC.  
 Carracas Unit-PC 26 B #13  
 Exhibit G

15

0

F

14

10

0

13

Carracas U. 15B

C. Unit 14B  
Carracus Mesa 14

Nassau

22

23

24

19

0

Carracus 24B

Nassau

T32N  
R4W

Nassau

Nassau

27

26

25

Existing  
Nassau Resources  
CU 26 B #13

19

0

Proposed BH Loc.

Nassau Resources  
CU 26B #16

Nassau Resources  
CU 25 B #13

Carracus 27B

Carracus 26B

Carracus 25B

Nassau

Nassau

Nassau

Nassau Resources  
Cu 34B #2

34

JEROME H. HUNTER

35

Nassau Resources  
CU 35B #9

36

Nassau Resources  
CU 34B #9

Nassau Resources  
CU 35 B #13

NASSAU RESOURCES, INC.  
Carracas Unit-PC 26 B #13  
Exhibit H

Carracas 34B

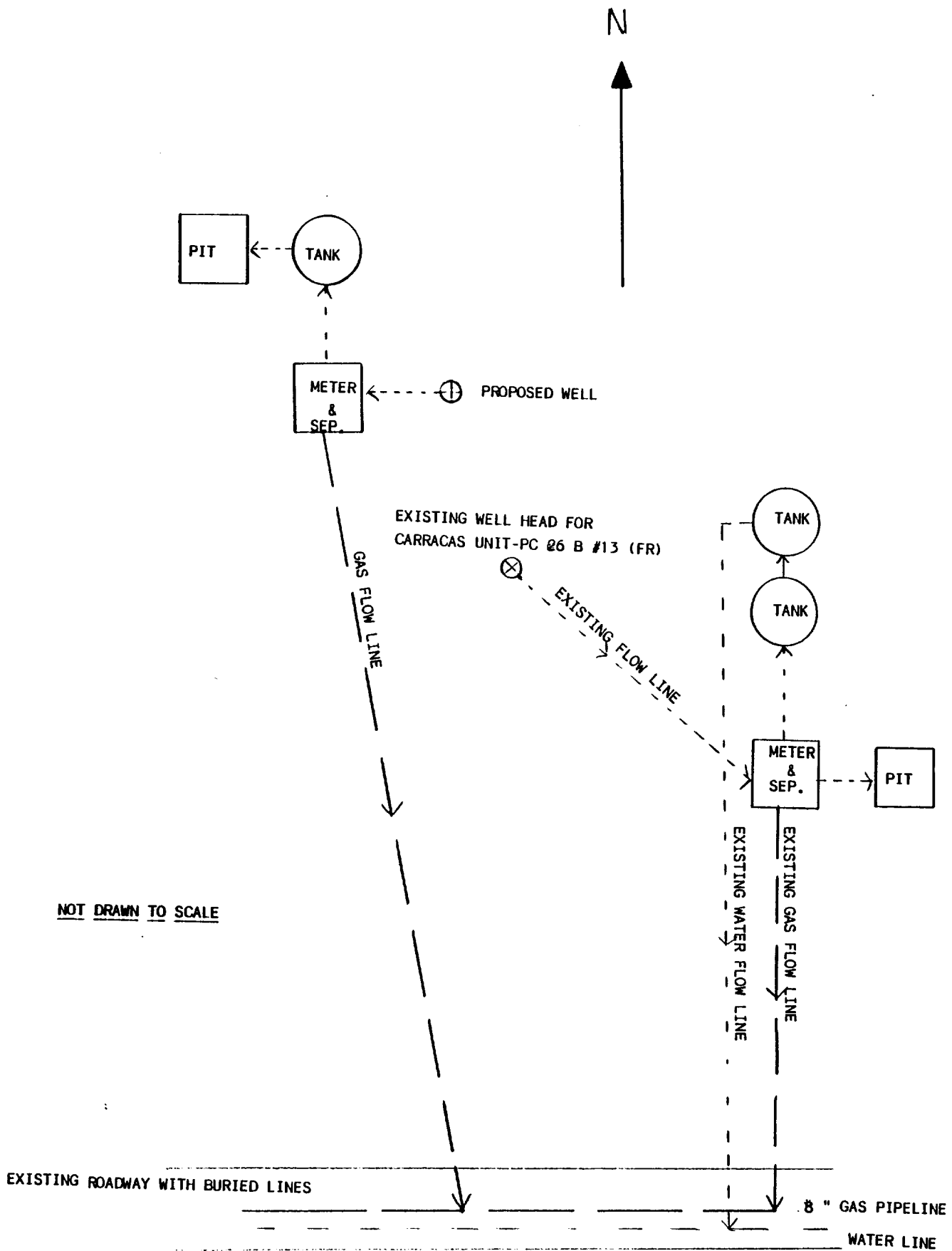

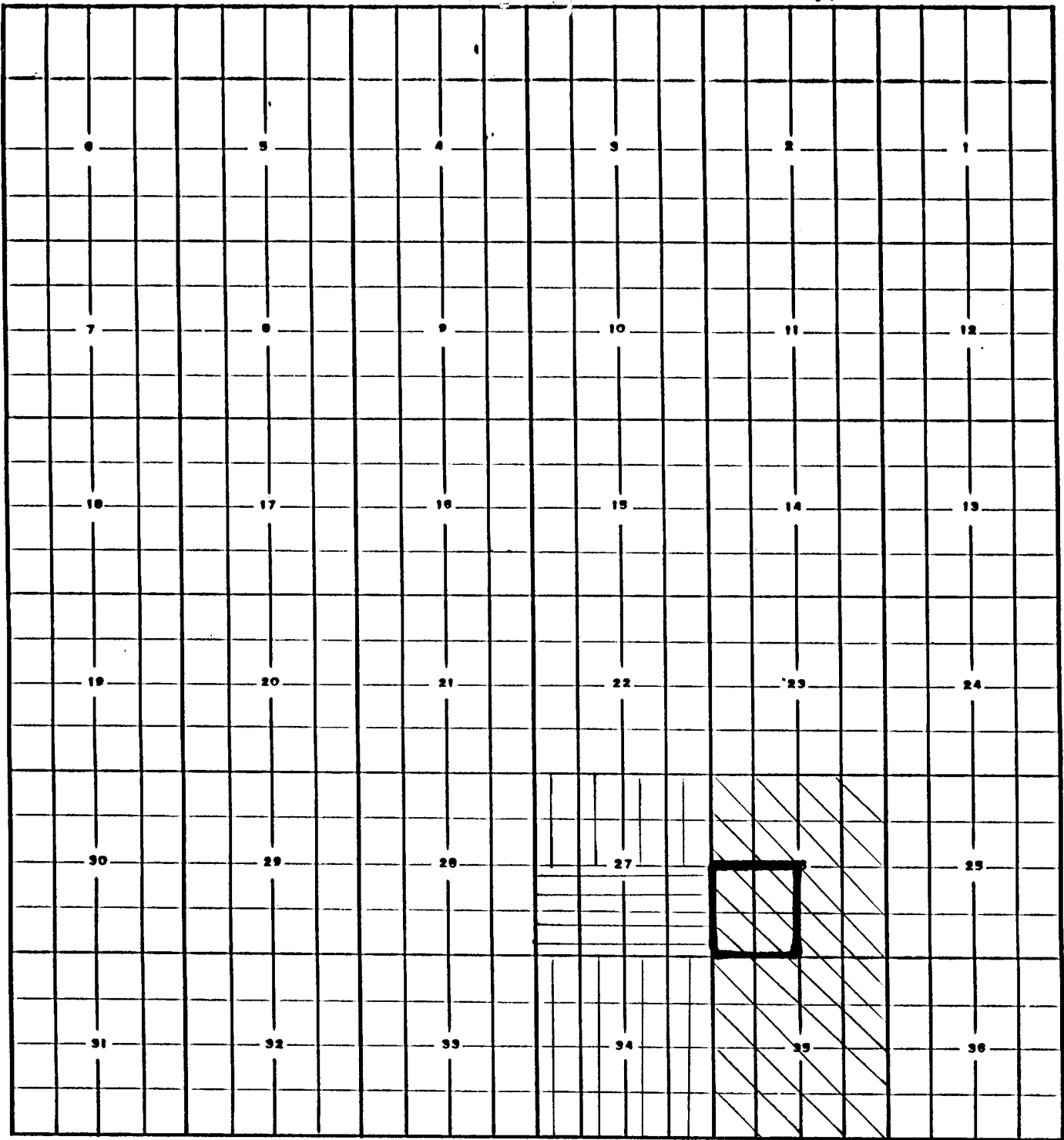

NM 28812 Amoco Production Co. 25% & Kindermac Partners 75%



NM 59696 Amoco Production Co. 25% & Kindermac Partners 75%



NM 66864 Kindermac Partners 100%

NASSAU RESOURCES, INC.  
Carracas Unit-PC 26 B #13  
Application for  
Directional Drilling