

DISTRICT I
 P.O. Box 1980, Hobbs, NM 88241-1980
 DISTRICT II
 311 S. First St., Artesia, NM 88210-2835
 DISTRICT III
 1000 Rio Brazos Rd, Aztec, NM 87410-1693

State of New Mexico
 Energy, Minerals and Natural Resources Department

Form C-107-A
 New 3-12-96

OIL CONSERVATION DIVISION

2040 S. Pacheco
 Santa Fe, New Mexico 875054-6429

APPROVAL PROCESS:

Administrative Hearing

EXISTING WELLBORE

YES NO

APPLICATION FOR DOWNHOLE COMMINGLING

OPERATOR: ENERGEN RESOURCES CORPORATION ADDRESS: 2198 Bloomfield Highway, Farmington, NM 87401

LEASE: San Juan 32-5 Unit L3M I Sec. 25 T32N R6W Rio Arriba
 Well No. Unit Ltr. - Sec - Twp - Rge County

GRID NO. 162928 Property Code 21996 API NO. 30-039-25878 Spacing Unit Lease Types: (check 1 or more)
 Federal State (and/or) Fee

The following facts are submitted in support of downhole commingling:	Upper Zone	Intermediate Zone	Lower Zone
1. Pool Name and Pool Code	Blanco Mesaverde 72319		Basin Dakota 71599
2. Top and Bottom of Pay Section (Perforations)	4500 - 6000		8030 - 8137
3. Type of production (Oil or Gas)	Gas		Gas
4. Method of Production (Flowing or Artificial Lift)	Flowing		Flowing
5. Bottomhole Pressure Oil Zones - Artificial Lift: Estimated Current Gas & Oil - Flowing: Measured Current All Gas Zones: Estimated Or Measured Original	a. (Current) Not Yet Completed	RECEIVED JUL - 2 1999 OIL CON. DIV. DIST. 3	1143 Meas.
	b. (Original) 1300 Est.		2206 Meas.
6. Oil Gravity (^o API) or Gas BTU Content)	1000 BTU Est.		968 BTU
7. Producing or Shut-In?	Not Yet Completed		Producing
Production Marginal? (yes or no)	Yes		Yes
* If Shut-In, give date and oil/gas/water rates of last production Note: For new zones with no production history, applicant shall be required to attach production estimates and supporting data	Date: Rates:	Date: Rates:	Date: Rates:
* If Producing, give date and oil/gas/water rates of recent test (within 60 days)	Date: N/A Rates:	Date: Rates:	Date: 6/26/99 Rates: 0/54/.3
8. Fixed Percentage Allocation Formula - % for each zone	Oil: See % Gas: Attached %	Oil: % Gas: %	Oil: See % Gas: Attached %

9. If allocation formula is based upon something other than current or past production, or is based upon some other method, submit attachments with supporting data and/or explaining method and providing rate projections or other required data.

10. Are all working, overriding, and royalty interests identical in all commingled zones? Yes No
 If not, have all working, overriding, and royalty interests been notified by certified mail? Yes No
 Have all offset operators been given written notice of the proposed downhole commingling? Yes No

11. Will cross-flow occur? Yes No If yes, are fluids compatible, will the formations not be damaged, will any cross-flowed production be recovered, and will the allocation formula be reliable. Yes No (If No, attach explanation)

12. Are all produced fluids from all commingled zones compatible with each other? Yes No

13. Will the value of production be decreased by commingling? Yes No (If Yes, attach explanation)

14. If this well in on, or communized with, state or federal lands, either the Commissioner of Public Lands or the United States Bureau of Land Management has been notified in writing of this application. Yes No

15. NMOCD Reference Cases for Rule 303(D) Exceptions: ORDER NO(S) _____

16. ATTACHMENTS:

- * C-102 for each zone to be commingled showing its spacing unit and acreage dedication.
- * Production curve for each zone for at least one year. (If not available, attach explanation.)
- * For zones with no production history, estimated production rates and supporting data.
- * Data to support allocation method or formula.
- * Notification list of all offset operators.
- * Notification list of working, overriding, and royalty interests for uncommon interest cases.
- * Any additional statements, data, or documents required to support commingling.

hereby certify that the information above is true and complete to the best of my knowledge and belief.

SIGNATURE [Signature] TITLE Prod. Superintendent DATE 6/30/99

TYPE OR PRINT NAME Gary W. Brink TELEPHONE NO. (505) 325-6800

Box 1980, Hobbs, NM 88241-1980
 District II
 111 South First, Artesia, NM 88210
 District III
 1000 Rio Huerfano Rd., Aztec, NM 87410
 District IV
 2040 South Pacheco, Santa Fe, NM 87505

OIL CONSERVATION DIVISION
 2040 South Pacheco
 Santa Fe, NM 87505

30 APR 1998 PM 1:40 AMENDED REPORT

WELL LOCATION AND ACREAGE DEDICATION PLAT

* API Number		* Pool Code		* Well Name	
		72319/71599		Blanco Mesa Verde/Basin Dakota	
* Property Code		* Property Name			* Well Number
		SAN JUAN 32-5 UNIT			13M
* OGRID No.		* Operator Name			* Elevation
162928		TAURUS EXPLORATION U.S.A., Inc.			6494

10 Surface Location

UL or lot no.	Section	Township	Range	Lot Idn	Feet from the	North/South line	Feet from the	East/West line	County
I	25	32N	6W		1711	SOUTH	1295	EAST	RIO ARRIBA

11 Bottom Hole Location If Different From Surface

UL or lot no.	Section	Township	Range	Lot Idn	Feet from the	North/South line	Feet from the	East/West line	County

* Dedicated Acres	* Joint or Infill	* Consolidation Code	* Owner No.
320			

NO ALLOWABLE WILL BE ASSIGNED TO THIS COMPLETION UNTIL ALL INTERESTS HAVE BEEN CONSOLIDATED OR A NON-STANDARD UNIT HAS BEEN APPROVED BY THE DIVISION

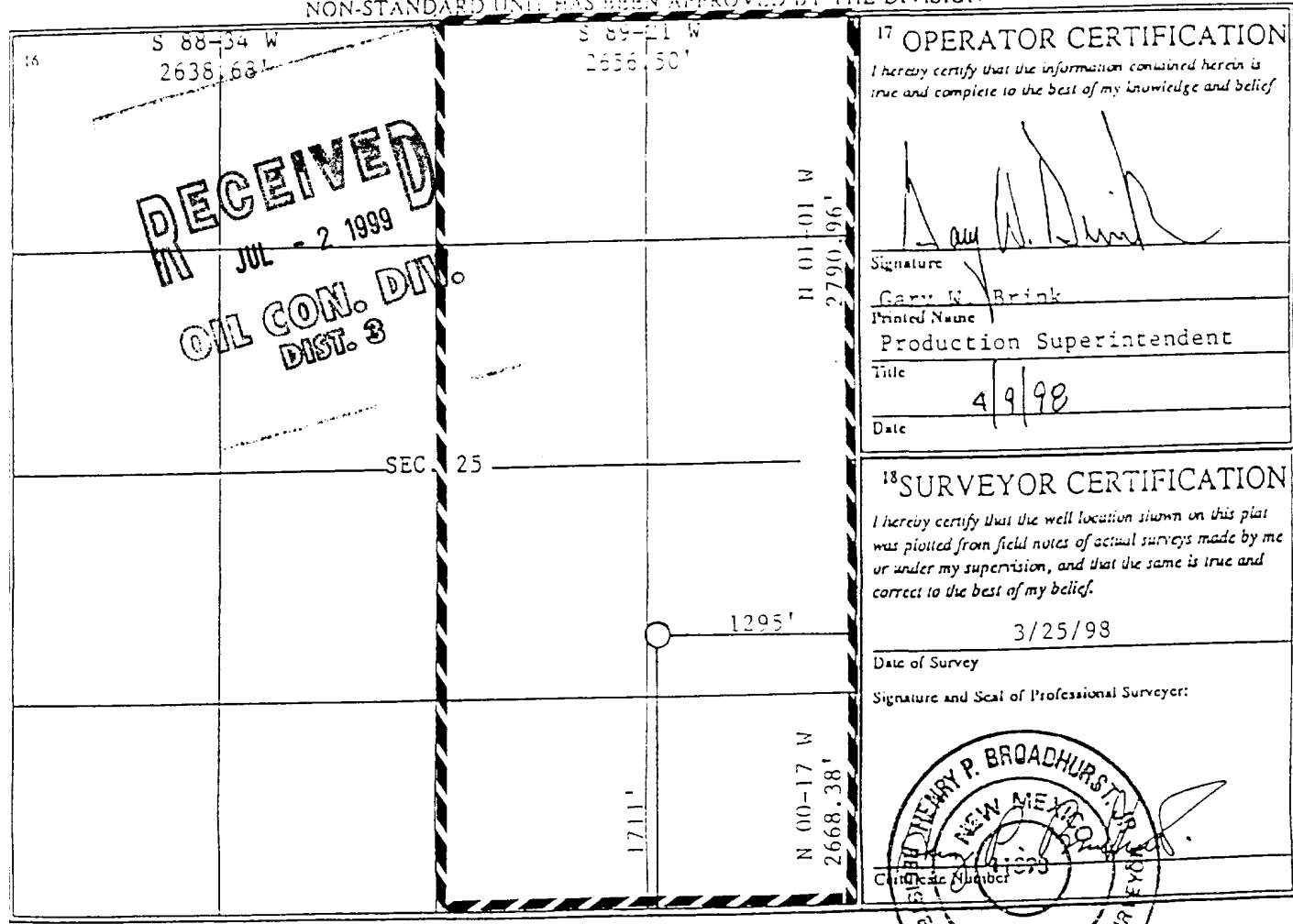

17 OPERATOR CERTIFICATION
 I hereby certify that the information contained herein is true and complete to the best of my knowledge and belief

[Signature]
 Signature
 Gary W. Brink
 Printed Name
 Production Superintendent
 Title
 4/9/98
 Date

18 SURVEYOR CERTIFICATION
 I hereby certify that the well location shown on this plat was plotted from field notes of actual surveys made by me or under my supervision, and that the same is true and correct to the best of my belief.

3/25/98
 Date of Survey
 Signature and Seal of Professional Surveyor:

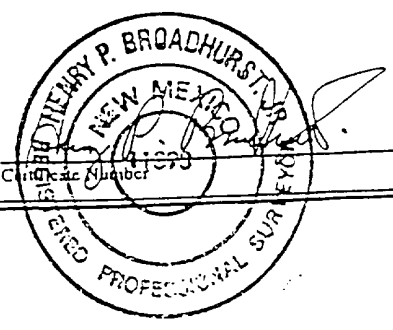

N 89-42 W
 5415.96'

Energen Resources Corp.

San Juan 32-5 Unit #13M
Offset Operator / Ownership Plat
Blanco Mesa Verde/ Basin Dakota
Downhole Commingling

Township 32 N, Range 6 W

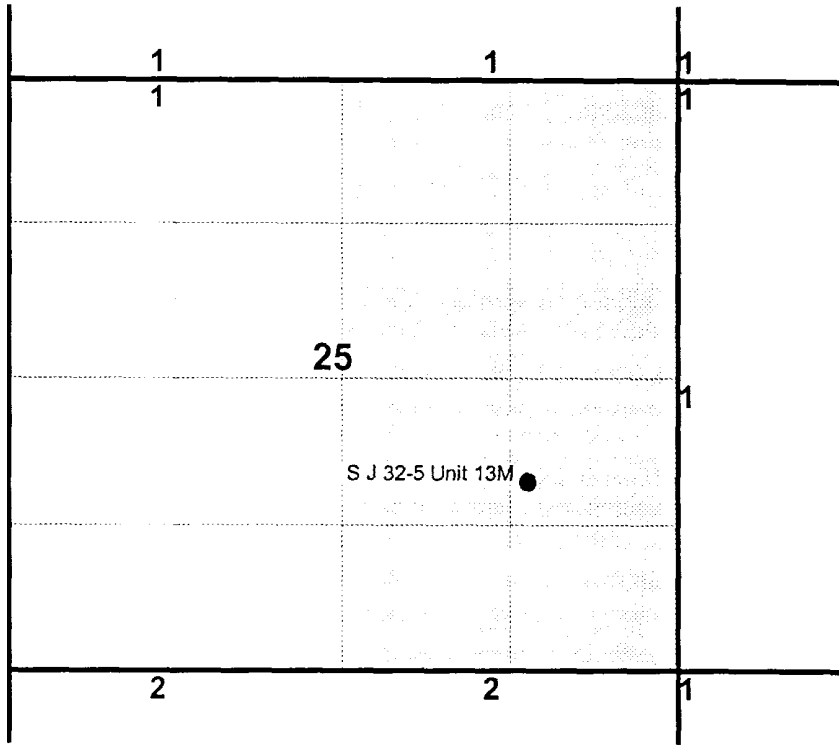

Resources Corporation
Production Co.
7-4
ns Center
k 74101

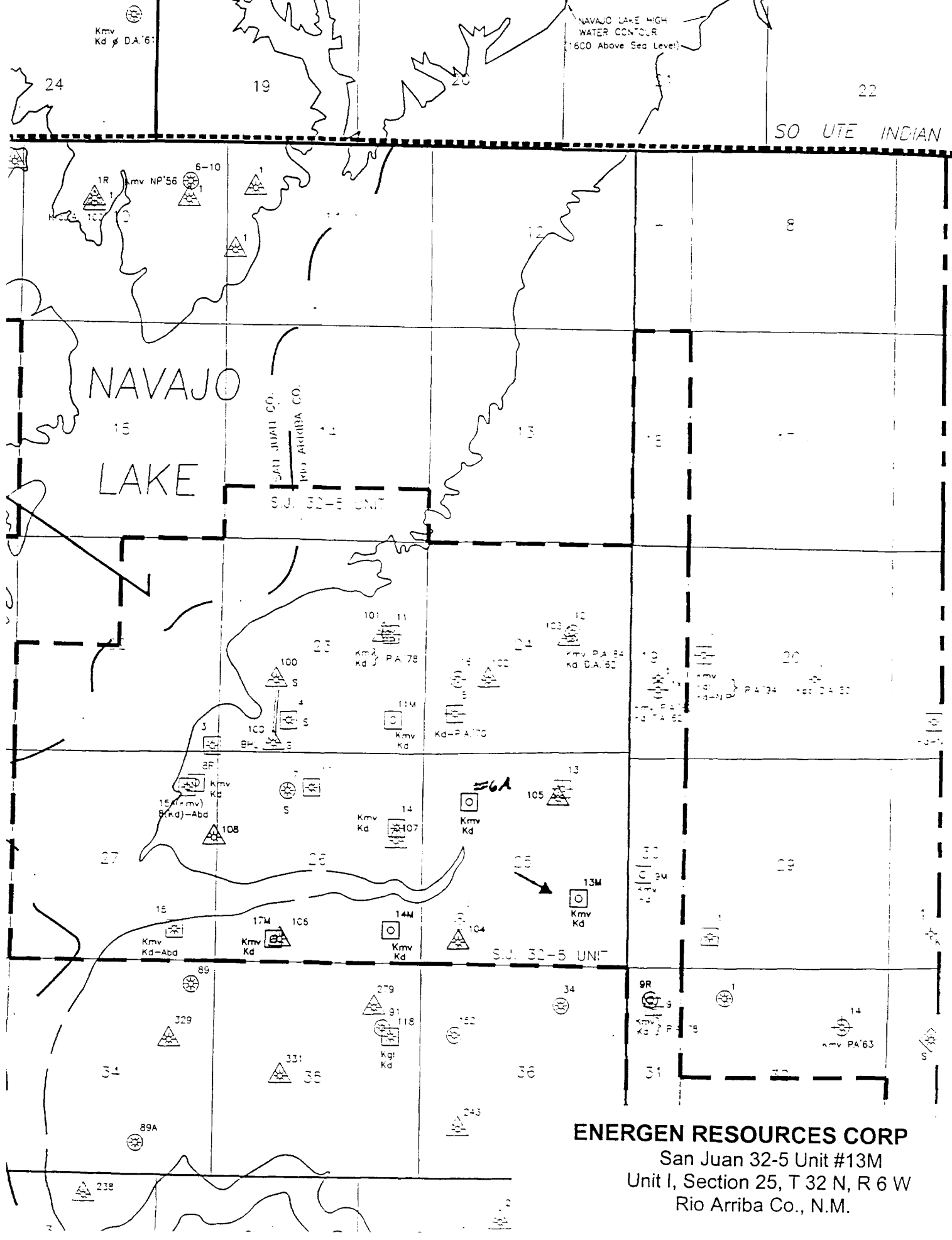

ENERGEN RESOURCES CORP
 San Juan 32-5 Unit #13M
 Unit I, Section 25, T 32 N, R 6 W
 Rio Arriba Co., N.M.

SAN JUAN 32 - 5 UNIT #13M

DAILY GAS PRODUCTION PLOT

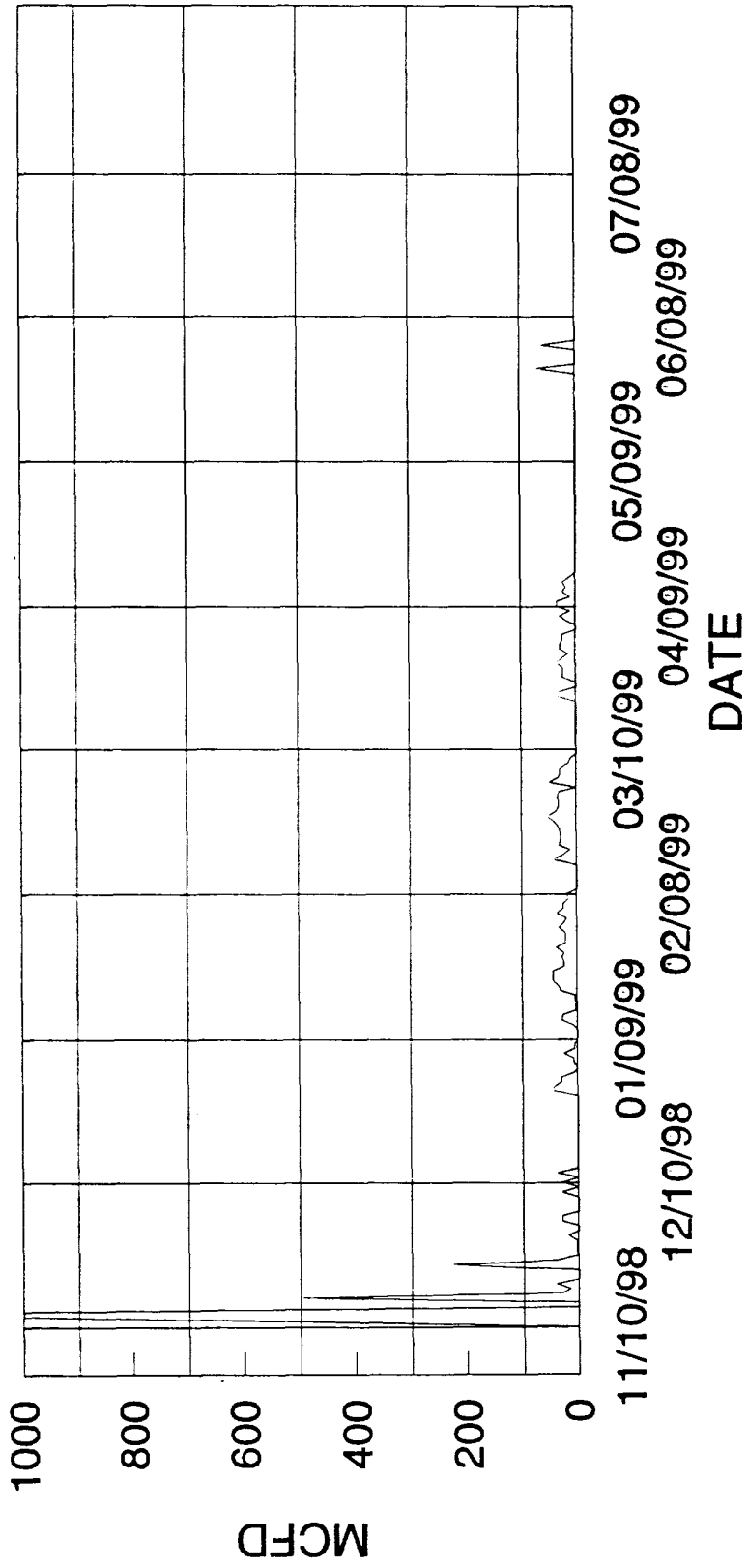

— DAKOTA

SAN JUAN 32 - 5 UNIT #6A

DAILY GAS PRODUCTION PLOT

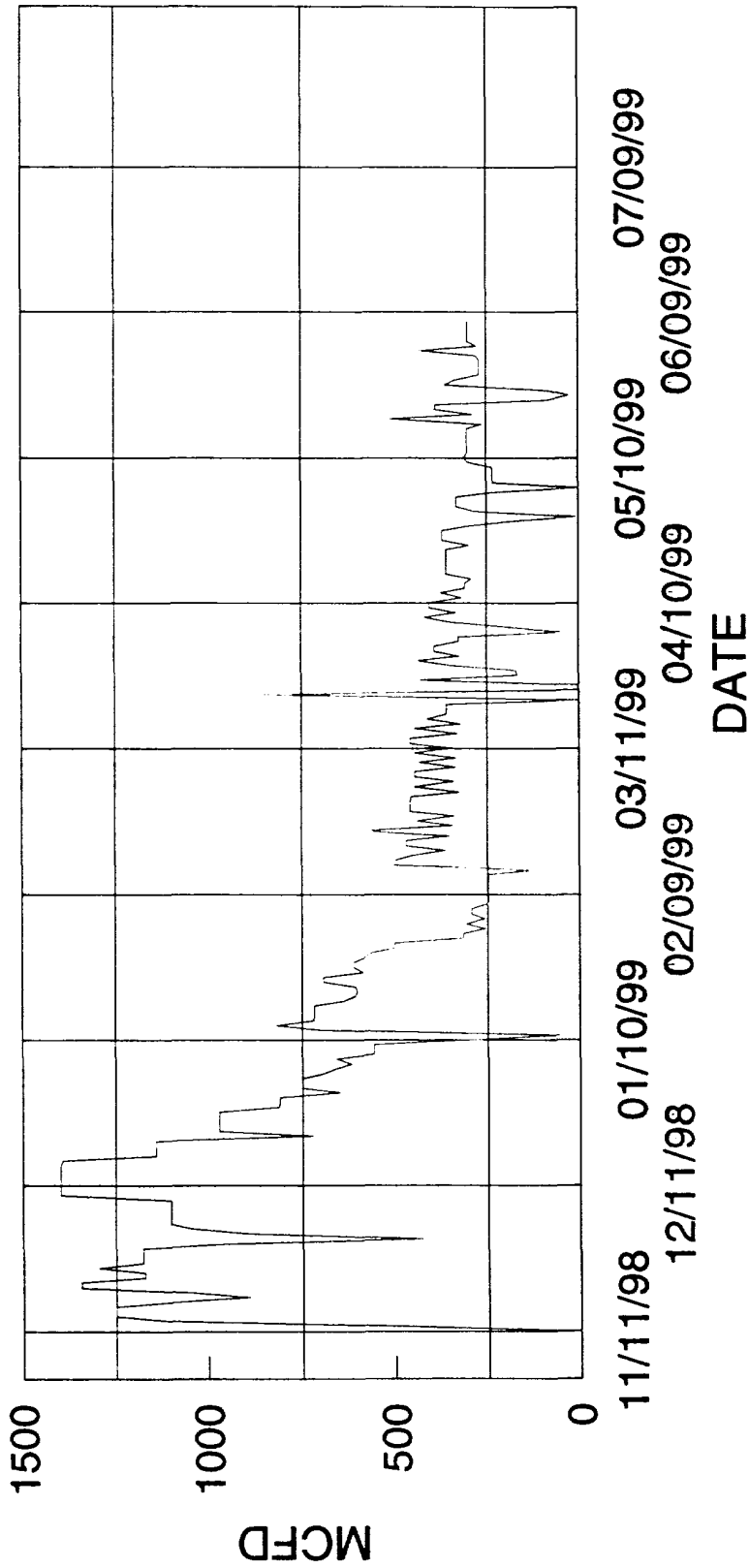

— MESAVERDE

San Juan 32-5 Unit #13M

Proposed Allocation Method

Produce total well stream for 30 days following Mesa Verde pay add
Pay Add projected to add 230 MCFD to Mesa Verde flow stream

Total Stream = X

Dakota Stabilized rate = 54 MCFD

DK Allocation = $54/X$ as a percentage

MV Allocation = $(X - 54)/X$ as a percentage

Oil Allocation- Neither pool produces oil in this area

Rates will be reported to NMOCD- Aztec for final allocation percentage determination

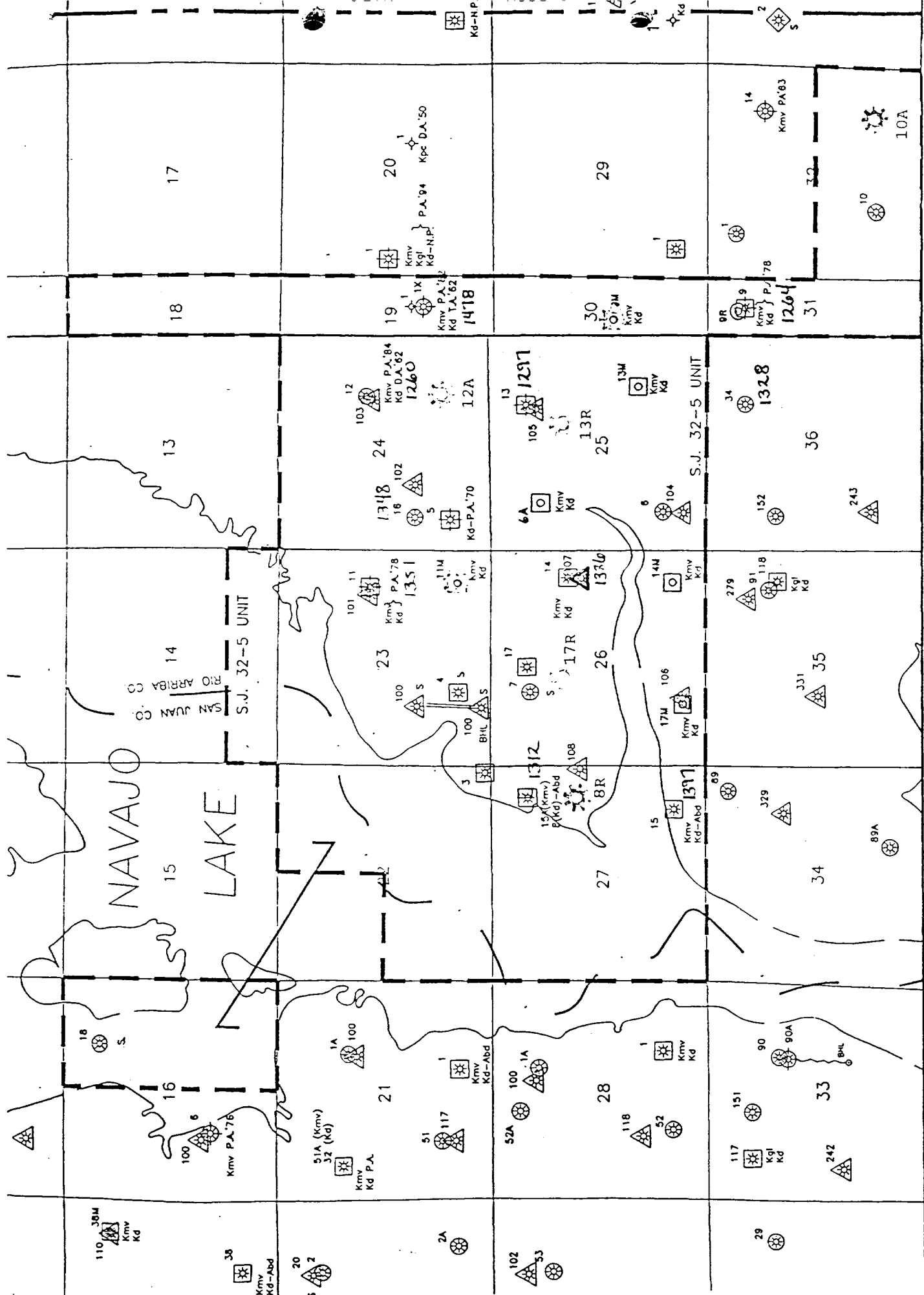

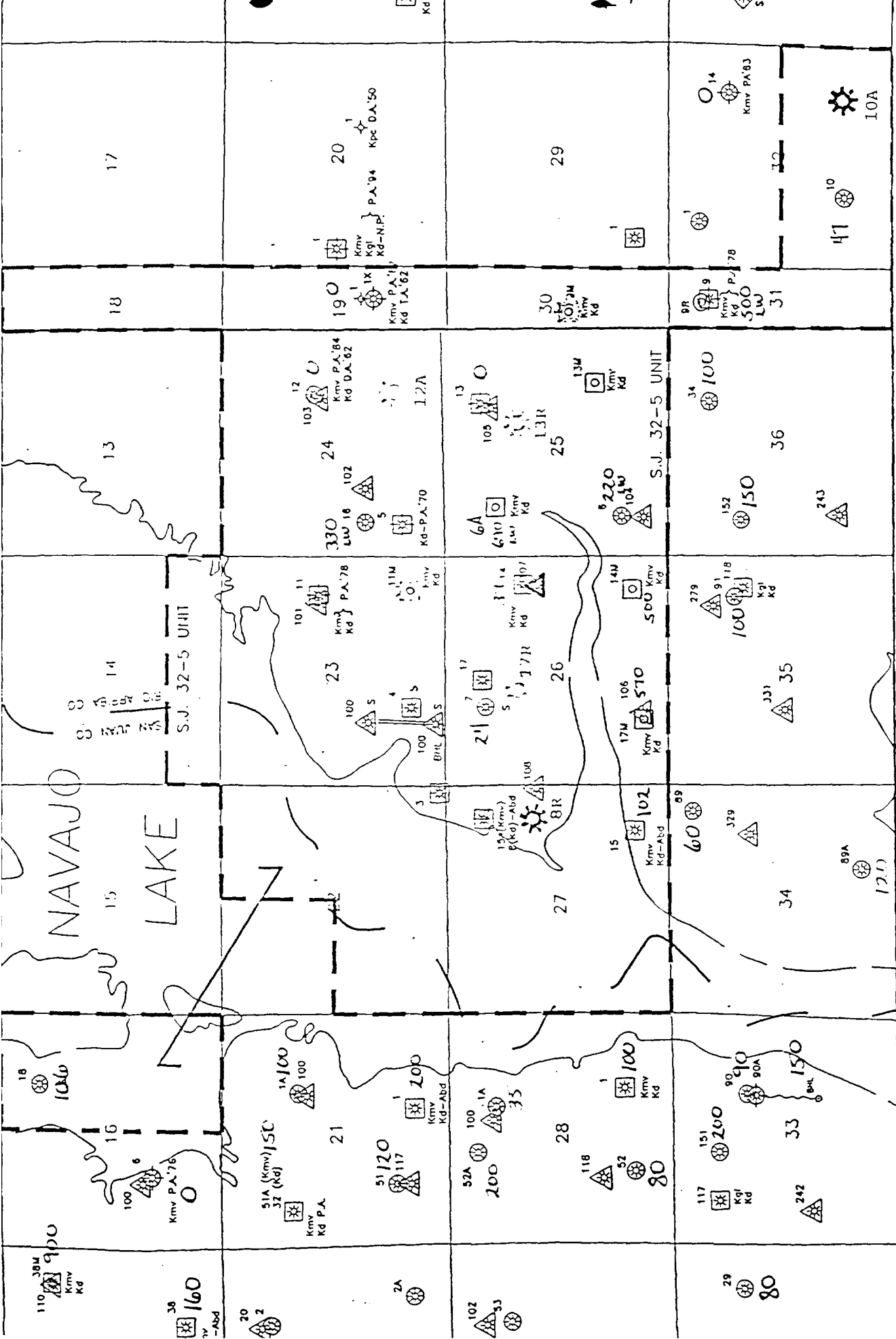

FISCAL 1999 DRILLING PROGRAM CUPPET MESAVERDE PRODUCTION PATES (MCD) REPORT CA

San Juan 32-5 Unit Working Interest Owners

Alan H Kolz Trustee
174 Westgate Circle
Santa Rosa, CA 95401

Antonio Jose Martinez
1612 South Glenmary
Aztec, NM 87410

Barbara Kaiser
7778 Dusk St.
Littleton, CO 80125

Benson Montin Greer
4900 College Blvd.
Farmington, NM 87402

Bonnie L. Hart
5737 E. 22nd Place
Tulsa, OK 74114

Carl Dellinger
3605 Britt NE
Albuquerque, NM 87111

Chase Oil Corporation
PO Box 1767
Artesia, NM 88211-1767

Chuck D. West
7882 S. Ogden Court
Littleton, CO 80122

David B. Quintana
RR 1 Box 315
Earth, TX 79031

Dorothea J. Caufield Trust
14647 Ranchview Terrace
Chino Hills, CA 91709-4345

Dorothy Dean Gibbons Estate
Rt 3, PO Box 281
Warsaw, MO 65355

Dr. Curtis Webb Caine
712 Forest Point Drive
Brandon, MS 39042

Dr. Frank Alton Wood
4026 Oakridge Drive
Jackson, MS 39216

Elizabeth Jeanne Calloway
JGT Estate
4801 St. Johns Drive
Dallas, TX 75205-3143

Elizabeth Calloway
4801 St. Johns Drive
Dallas, TX 75205-3143

Eugene E. Beatty
F/A/O Eugene E Beatty
PO Box 12019
Austin, TX 78711

Frederick Eugene Turner
Oil and Gas Investments
One Energy Square, Suite 852
4925 Greenville Ave.
Dallas, TX 75206-4079

Gayle K. Hamilton Agent
PO Box 1133
Shreveport, LA 71163-1133

Glen W. Johnson, Jr. Est
10 Friar Tuck Circle
Summit, NJ 07901

Hampton Young
PO Box 20186
Graeagle, CA 96103-1186

Henrietta E. Schultz
500 N. Akard St. #2160
Dallas, TX 75201

Inez Quintana
Trustee Under TR A
PO Box 51
Ignacio, CO 81137

J. Glenn Turner, Jr.
3131 Turtle Creek Blvd.
Suite 1201
Dallas, TX 75219-5415

John Lee Turner
PO Box 33610
Kerrville, TX 78029-3610

Jose N. Quintana
PO Box 652
Pagosa Springs, CO 81197

Laura Jean West Amman
3845 Dyanna Drive
Thornton, CO 80221

Lee Ross Allison
4135 Dogwood Drive
Jackson, MS 39211

San Juan 32-5 Unit Working Interest Owners

Linda D. Cundiff
2441 County Road 329
Ignacio, CO 81131

Lois Beatty
Attn: Louis Acevedo
4050 Alpha Rd. MC 5501 NWSAT
Farmers Branch, TX 75244

Louisa Quintana
PO Box 661
Ignacio, CO 81137

Mary Francis Pisareff
266 Granada Road
est Palm Beach, FL 33401-8018

Mary Francis Turner, JR TR
PO Box 200890
Houston, TX 77216-0890

Olivia Lawhead
716 Hall Street
Eaton Rapids, MI 48827

Ophelia Candelaria
PO Box 465
Blanco, NM 87412

Pete Millich and Della E
Joint Tenants
12084 Hwy 151
Ignacio, CO 81137

Sally Francis Ross Martin
PO Box 1096
Madison, MS 39130-1096

Sara B. Sanchez
1625 Bonforte Blvd, Apt B11
Pueblo, CO 81001-1667

Sheran N. Marron
5065 Arroyo Chamesa NE
Albuquerque, NM 87111

Turner Production Co.
4925 Greenville Ave.
Dallas, TX 75206

Wade E. Young
PO Box 1189
Magalia, CA 95954

William G. Webb
8226 Douglas Ave, Suite 709
Dallas, TX 75225-5929

Adela Mascarenas Quintana
1794 County Rd. 314
Ignacio, CO 81137

Aida Mascarenas
157 Cicotte
Ecorse, MI 48229

Albert Martinez
PO Box 4
Chromo, CO 81128

Angelina R. Shull
PO Box 268
Jeffrey City, WY 82310

Anthony Dominick Sanchez
PO Box 725
Ignacio, CO 81137

Arthur J. Sanchez
PO Box 725
Ignacio, CO 81137

Betty S. Lewis
4917 Greenbriar
Corpus Christi, TX 78413

Candido P. Mascarenaz
4813 W. Odell Drive
West Valley, UT 84120

Constance A. Kuncicky
4225 US Hwy A1A S
Saint Augustine, FL 32084-7422

Dale Branning
101 Colonial St.
Evenston, WY 82930

David A. Miller
Lot #64
Leesburg, VA 20175-3713

Eleanor Bennett
4408 W. 6060 S.
Salt Lake City, UT 84118

Eleanor D. Shira
2001 W. 2nd
Rifle, CO 81650

San Juan 32-5 Unit Working Interest Owners

Eleanor M. Calderon
PO Box 176
Hesperus, CO 81326

Elliott Industries
PO Box 1355
Roswell, NM 88202

Elliott Hall Company
PO Box 1231
Ogden, UT 84402

Enriques Espinosa Decd
PO Box 704
Pagosa Springs, CO 81147-0704

Eve E. Buchanan
956 Acapulco Court
Colorado Springs, CO 80910

Gayle O'Flattery
2003 Gorham Park Ave.
Billings, MT 59102

Georgia Chavez
PO Box 46
Pagosa Springs, CO 81147

Gerardo L. Sanchez
PO Box 229
Ignacio, CO 81137

H.F. Axtell & Freda Axtell
101 Rio Vista Circle
Durango, CO 81301

John M. Mascarenas
2849 Woodbine Ave.
Fullerton, CA 92635

John Tranquilino Mascarenas
29631 42nd Place S.
Auburn, WA 98001

Jose Salvador Martinez
PO Box 772
Pagosa Springs, CO 81147

Laurie Kramer
2240 Honda Ave.
Elko, NV 89801

Lawrence Mascarenaz
932 Kensington Ave.
Salt Lake City, UT 84115

Lidia M. Martinez
HC 3, Box 11
Pagosa Springs, CO 81147

Linda A. Seykora
2002 E. 4th St.
Greenville, NC 27834

Madeline M. Espinosa
718-154 Sycamore Ave.
Vista, CA 92083

Magdalena Espinosa
2001 W. 2nd St. Trlr 1
Rifle, CO 81650-2638

Marty Mascarenaz
3685 Alveron Drive
Bennion, UT 84118

Mary L. Selman
County Rd. 5173, Space 26
Farmington, NM 87401

Olive Campos
901 Storm Mountain Dr. #216
Salt Lake City, UT 84123-3444

Ramona Calder
4131 W. 5700 South
Kearns, UT 84118

Ray Thomas Sanchez
PO Box 1584
Durango, CO 81301

Raynel A. Martinez
15020 County Rd 500
Pagosa Springs, CO 81147

Robert W. Austin
PO Box 37
Cookeville, TN 38503

Ronald M. Miller
PO Box 112
Bayfield, CO 81122

Rosalie Martinez
2567 N. 400 W #15
Layton, UT 84041

San Juan 32-5 Unit Working Interest Owners

Sidwell Minerals Trust
621 17th St., Suite 805
Denver, CO 80293

Susan Nelson
4889 W. Niagra Way
Kearns, UT 84118

Teresa M. Salazar
7560 Misty Glenn
Boise, ID 83709

Tina Rose
5386 S. 5200 W.
Kearns, UT 84118

Trudy M. Padillo
7643 West 98th
Broomfield, CO 80020

Vera P. Maddy
718-154 Sycamore Ave.
Vista, CA 92083

Verna R. Espinosa
Rose A. Sanchez
803 La Plata Ave.
Aztec, NM 87410

Vernon Velasquez
PO Box 415
Glenrock, WY 82637

Viola Mascarenas Lucero
PO Box 841
Bloomfield, NM 87413

Wayde A. Espinosa
2538 Cindy Circle
Elko, NV 89801

Williams Production Co.
One Williams Center
PO Box 3102
Tulsa, OK 74101