

UNITED STATES
DEPARTMENT OF THE INTERIOR
BUREAU OF LAND MANAGEMENT

APPLICATION FOR PERMIT TO DRILL OR DEEPEN 5 21 12

1a. TYPE OF WORK DRILL <input checked="" type="checkbox"/> DEEPEN <input type="checkbox"/>		5. LEASE DESIGNATION AND SERIAL NO. NM 59704	
b. TYPE OF WELL OIL WELL <input type="checkbox"/> GAS WELL <input checked="" type="checkbox"/> OTHER <input type="checkbox"/>		6. IF INDIAN, ALLOTTEE OR TRIBE NAME 36	
2. NAME OF OPERATOR VASTAR RESOURCES, INC. 36619		7. UNIT AGREEMENT NAME 26249	
3. ADDRESS AND TELEPHONE NO. 1816 E. MOJAVE, FARMINGTON NM 87401 (505) 599-4300		8. FARM OR LEASE NAME, WELL NO. CARRACAS 36A #5	
4. LOCATION OF WELL (Report location clearly and in accordance with any State requirements.) At surface 1450' FNL & 910' FWL At proposed prod. zone SAME		9. API WELL NO. 30-039-26477	
14. DISTANCE IN MILES AND DIRECTION FROM NEAREST TOWN OR POST OFFICE* 40 MILES EAST-NORTHEAST OF BLOOMFIELD, NM		10. FIELD AND POOL, OR WILDCAT BASIN FRUITLAND COAL	
15. DISTANCE FROM PROPOSED* LOCATION TO NEAREST PROPERTY OR LEASE LINE, FT. (Also to nearest drlg. unit line, if any) 910'		11. SEC., T., R., M., OR BLK. AND SURVEY OR AREA E SEC. 36, T-32N, R-5W	
16. NO. OF ACRES IN LEASE 1760		12. COUNTY OR PARISH RIO ARRIBA	
17. NO. OF ACRES ASSIGNED TO THIS WELL 320		13. STATE NM	
18. DISTANCE FROM PROPOSED LOCATION* TO NEAREST WELL, DRILLING, COMPLETED, OR APPLIED FOR, ON THIS LEASE, FT. 7050'		19. PROPOSED DEPTH 3740'	
20. ROTARY OR CABLE TOOLS ROTARY		21. APPROX. DATE WORK WILL START* JULY, 2000	
21. ELEVATIONS (Show whether DF, RT, GR, etc.) 6902' GL			
23. PROPOSED CASING AND CEMENTING PROGRAM			

SIZE OF HOLE	GRADE, SIZE OF CASING	WEIGHT PER FOOT	SETTING DEPTH	QUANTITY OF CEMENT
12-1/4"	8-5/8"	24#	400'	300 sx (354 cf.) Circ. to Surf.
7-7/8"	5-1/2"	15.5#	3740' -	900 sx (1730 cf.) Circ. to Surf.

This action is subject to technical and procedural review pursuant to 43 CFR 3185.3 and appeal pursuant to 43 CFR 3185.4.



DRILLING OPERATIONS AUTHORIZED ARE
SUBJECT TO COMPLIANCE WITH ATTACHED
"GENERAL REQUIREMENTS"

IN ABOVE SPACE DESCRIBE PROPOSED PROGRAM: If proposal is to deepen, give data on present productive zone and proposed new productive zone. If proposal is to drill or deepen directionally, give pertinent data on subsurface locations and measured and true vertical depths. Give blowout preventer program, if any.

24. SIGNED Charles W. Knight, Jr. TITLE ENGINEER (505) 599-4308 DATE 6/12/00
(This space for Federal or State office use)

PERMIT NO. _____ APPROVAL DATE _____
Application approval does not warrant or certify that the applicant holds legal or equitable title to those rights in the subject lease which would entitle the applicant to conduct operations thereon.

CONDITIONS OF APPROVAL, IF ANY:
APPROVED BY /s/ Jim Lovato TITLE _____ DATE JUL 11 2000

*See Instructions On Reverse Side **HOLD C104 FOR NSL**

OIL CONSERVATION DIVISION

STATE OF NEW MEXICO
ENERGY AND MINERALS DEPARTMENTP. O. BOX 2088
SANTA FE, NEW MEXICO 87501Form C-102
Revised 10-1-78

All distances must be from the outer boundaries of the Section.

Operator Vastar Resources, Inc.			Lease Carracas 36 A		Well No. 5
Unit Letter E	Section 36	Township 32 North	Range 5 West	County Rio Arriba	
Actual Footage Location of Wells 1450 feet from the North line and 910 feet from the West line					
Ground Level Elev. 6902'	Producing Formation Fruitland Coal		Pool Basin Fruitland Coal	Dedicated Acreage (W/2) 320 Acres	

1. Outline the acreage dedicated to the subject well by colored pencil or hachure marks on the plat below.
2. If more than one lease is dedicated to the well, outline each and identify the ownership thereof (both as to working interest and royalty).
3. If more than one lease of different ownership is dedicated to the well, have the interests of all owners been consolidated by communitization, unitization, force-pooling, etc?

☐ Yes ☐ No If answer is "yes," type of consolidation _____

If answer is "no," list the owners and tract descriptions which have actually been consolidated. (Use reverse side of this form if necessary.) _____

No allowable will be assigned to the well until all interests have been consolidated (by communitization, unitization, forced-pooling, or otherwise) or until a non-standard unit, eliminating such interests, has been approved by the Division.

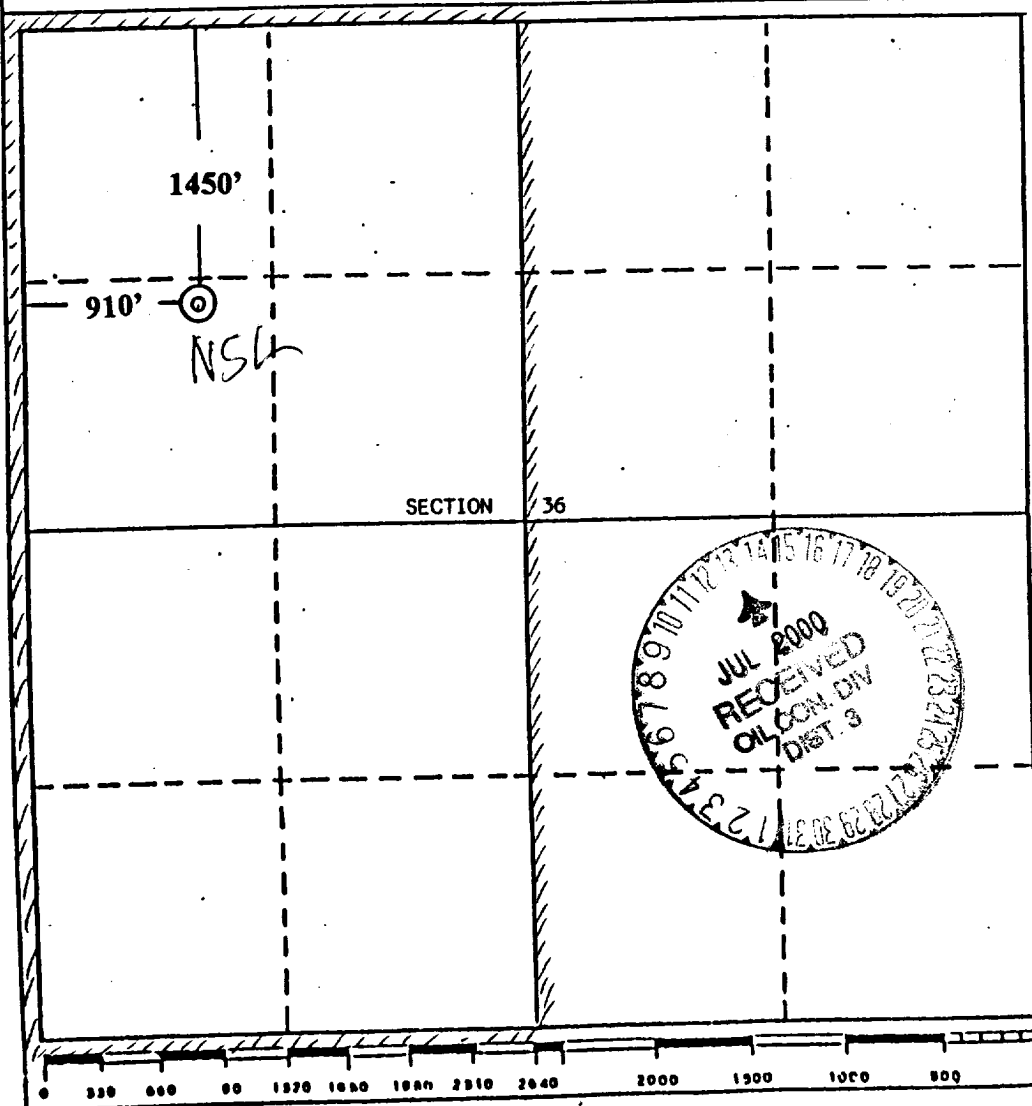

CERTIFICATION

I hereby certify that the information contained herein is true and complete to the best of my knowledge and belief.

Charles W. Knight, Jr.
Name **Charles W. Knight, Jr.**

Position **Engineer**

Company **Vastar Resources, Inc.**

Date **June 12, 2000**

EDGAR L. RISENHOVER
NEW MEXICO
5979
I hereby certify that the location shown on this plat was plotted from field notes of actual surveys made by me or under my supervision, and that the same are true and correct to the best of my knowledge and belief.

Date Surveyed **September 1, 1988**

Registered Professional Engineer and/or Land Surveyor

Edgar L. Risenhover
Certificate No. **5979**

Edgar L. Risenhover, L.S.

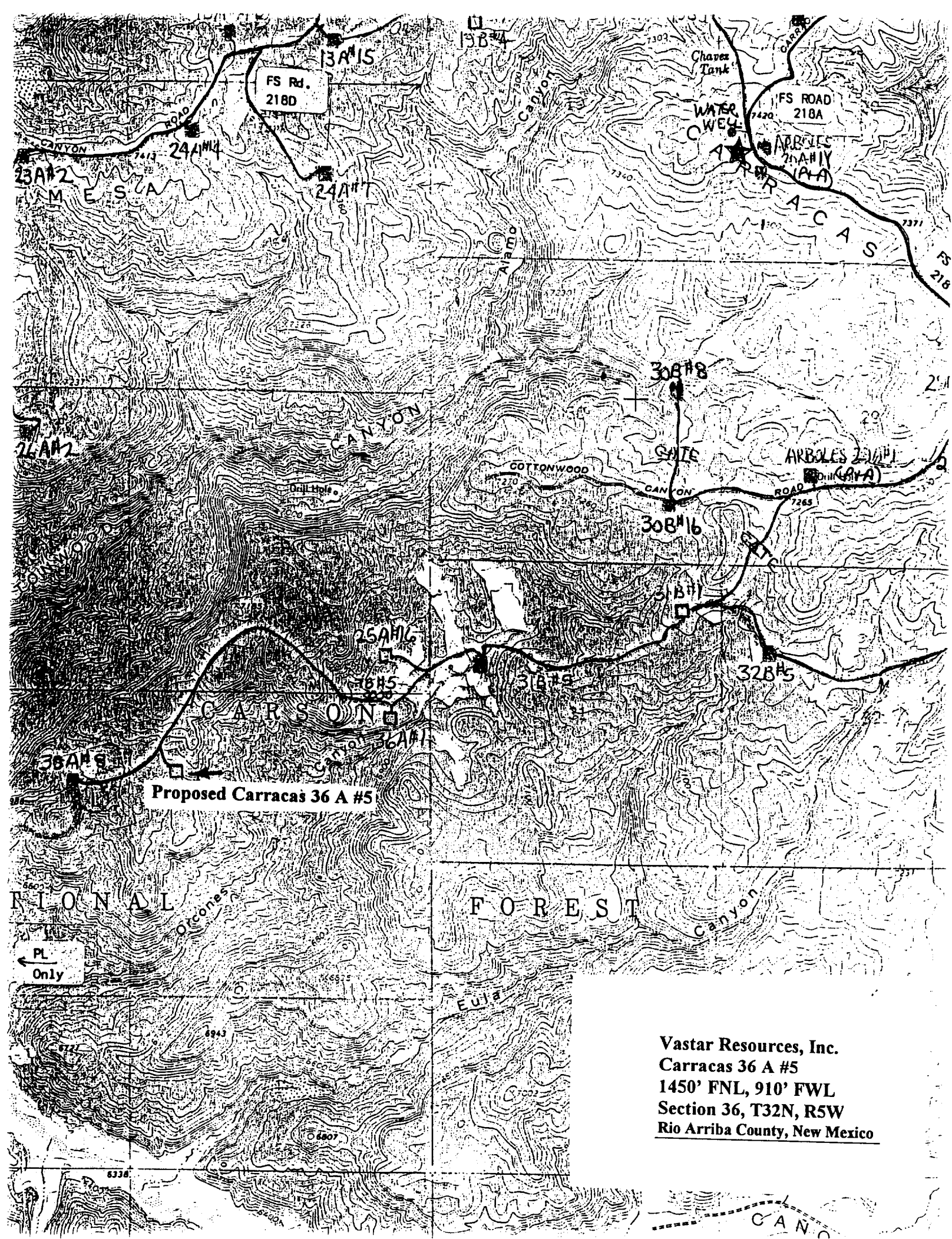

Vastar Resources, Inc.
Carracas 36 A #5
1450' FNL, 910' FWL
Section 36, T32N, R5W
Rio Arriba County, New Mexico

Vastar Resources, Inc.
Carracas 36 A #5
1450' FNL, 910' FWL
Sec 36, T32N, R5W
Rio Arriba County, New Mexico

Page 1

DRILLING PLAN

1. FORMATION TOPS: The estimated tops of geologic markers as follows:

Ojo Alamo	3057'
Kirkland	3147'
Fruitland	3476'

2. ANTICIPATED DEPTHS OF OIL, GAS, AND WATER:

Ojo Alamo	3057' - Water
Fruitland	3476' - Gas

All zones capable of oil, gas, or water production will be protected with 8 5/8" or 5 1/2" casing and cemented to surface.

3. BLOWOUT PREVENTOR REQUIREMENTS:

<u>Interval</u>	<u>Pressure Control Equipment</u>
Surface - 400'	No equipment necessary
400' - TD	10" 2000 psi Double Ram preventor, rotating head and choke manifold.

All BOPE will be hydraulically pressure tested when nipped up, after well control use and every thirty days. Pressure tests will be to the lesser of 2000 psi or to 70% of the minimum internal yield pressure of the casing.

Blind rams will be functioned on each trip out of the hole. All BOPE checks will be noted on the daily drilling reports.

Additional BOPE equipment includes a kelly cock, FO safety valve and an inside BOP.

SEE ATTACHED BOP DIAGRAM