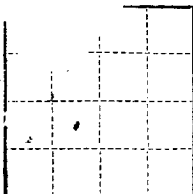

(SUBMIT IN TRIPLICATE)

Indian Agency

UNITED STATES
DEPARTMENT OF THE INTERIOR
GEOLOGICAL SURVEY

Ignacio

Allottee Ute Mtn. TribalLease No. 14-20-604-1950

SUNDRY NOTICES AND REPORTS ON WELLS

NOTICE OF INTENTION TO DRILL.....	<input checked="" type="checkbox"/>	SUBSEQUENT REPORT OF WATER SHUT-OFF.....	
NOTICE OF INTENTION TO CHANGE PLANS.....		SUBSEQUENT REPORT OF SHOOTING OR ACIDIZING.....	
NOTICE OF INTENTION TO TEST WATER SHUT-OFF.....		SUBSEQUENT REPORT OF ALTERING CASING.....	FEB 7 1961
NOTICE OF INTENTION TO REDRILL OR REPAIR WELL.....		SUBSEQUENT REPORT OF REDRILLING OR REPAIR.....	
NOTICE OF INTENTION TO SHOOT OR ACIDIZE.....		SUBSEQUENT REPORT OF ABANDONMENT.....	U.S. GEOLOGICAL SURVEY
NOTICE OF INTENTION TO PULL OR ALTER CASING.....		SUPPLEMENTARY WELL HISTORY.....	
NOTICE OF INTENTION TO ABANDON WELL.....			

(INDICATE ABOVE BY CHECK MARK NATURE OF REPORT, NOTICE, OR OTHER DATA)

January, 19 61

Well No. Ute #10 is located 1875 ft. from [S] line and 2010 ft. from [E] line of sec. 35NL/4 SW/4 Sec. 35
(1/4 Sec. and Sec. No.)T-31-N R-16-W
(Twp.) (Range)NMFM
(Meridian)Horsehoe Gallup
(Field)San Juan
(County or Subdivision)New Mexico
(State or Territory)The elevation of the ~~drilled~~ ^{ground} above sea level is 5503.0 ft.

DETAILS OF WORK

(State names of and expected depths to objective sands; show sizes, weights, and lengths of proposed casings; indicate mudding jobs, cementing points, and all other important proposed work)

We propose to drill a well at the above location to an approximate total depth of 1650'. 100' of 8 5/8" O.D. casing will be set and cemented to surface. Completion is contemplated in the Gallup formation. A 4 1/2" O.D. casing oil string will be used.



I understand that this plan of work must receive approval in writing by the Geological Survey before operations may be commenced.

Company The Atlantic Refining CompanyAddress P. O. Box 520Casper, WyomingBy B. J. SartainTitle District Drilling Superintendent

10

[illegible]

THE UNIVERSITY OF CHICAGO

Well Location and Acreage Dedication Plat

Section A.

Date **February 6, 1961**

Operator **THE ATLANTIC REFINING COMPANY** Lease **UTE**
 Well No. **10** Unit Letter **K** Section **35** Township **31 NORTH** Range **16 WEST**, NMPM
 Located **1875** Feet From **the SOUTH** Line, **2010** Feet From **the WEST** Line
 County **SAN JUAN** G. L. Elevation **5503.0** Dedicated Acreage **39.83** Acres
 Name of Producing Formation **Gallup** Pool **Horseshoe Gallup**

1. Is the Operator the only owner in the dedicated acreage outlined on the plat below?
 Yes ☒ No ☐
2. If the answer to question one is "no", have the interests of all the owners been consolidated by communitization agreement or otherwise? Yes ☐ No ☐ If answer is "yes", Type of Consolidation.
3. If the answer to question two is "no", list all the owners and their respective interests below:

Owner

Land Description

FEB 7 1961

U. S. GEOLOGICAL SURVEY

Section B.

Note: All distances must be from outer boundaries of section.

This is to certify that the information in Section A above is true and complete to the best of my knowledge and belief.

The Atlantic Refining Co.

(Operator)

L.B. Kelly

(Representative)

P. O. Box 520

(Address)

Casper, Wyoming

Ref: SJE plat of survey dated
October 1958

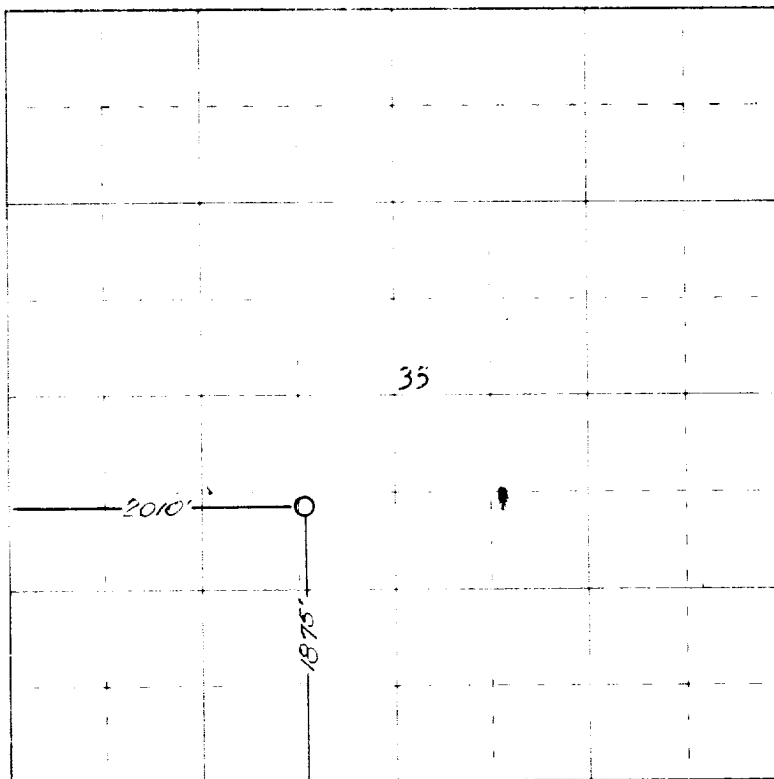

0 330 660 990 1320 1650 1980 2310 2640 2000 1500 1000 500 0

Scale 4 inches equal 1 mile



This is to certify that the above plat was prepared from field notes of actual surveys made by me or under my supervision and that the same are true and correct to the best of my knowledge and belief.

(Seal)

Date Surveyed **28 January 1961**

James P. Leese
 Registered Professional Engineer and/or Land Surveyor
 N. Mex. Reg. No 1463
 San Juan Engineering Company

Farmington, New Mexico