

State

APPROVED (SUBMIT IN TRIPLICATE)

AUG 1 1962

UNITED STATES
DEPARTMENT OF THE INTERIOR
GEOLOGICAL SURVEY

JERRY W. LONG
DISTRICT ENGINEER

Indian Agency _____
Ute Mountain Tribe

Allottee _____

Lease No. 14-20-604-90

SUNDRY NOTICES AND REPORTS ON WELLS

NOTICE OF INTENTION TO DRILL	<input checked="" type="checkbox"/>	SUBSEQUENT REPORT OF WATER SHUT-OFF
NOTICE OF INTENTION TO CHANGE PLANS	<input type="checkbox"/>	SUBSEQUENT REPORT OF SHOOTING OR ACIDIZING
NOTICE OF INTENTION TO TEST WATER SHUT-OFF	<input type="checkbox"/>	SUBSEQUENT REPORT OF ALTERING CASING
NOTICE OF INTENTION TO REDRILL OR REPAIR WELL	<input type="checkbox"/>	SUBSEQUENT REPORT OF REDRILLING OR REPAIR
NOTICE OF INTENTION TO SHOOT OR ACIDIZE	<input type="checkbox"/>	SUBSEQUENT REPORT OF ABANDONMENT
NOTICE OF INTENTION TO PULL OR ALTER CASING	<input type="checkbox"/>	SUPPLEMENTARY WELL HISTORY
NOTICE OF INTENTION TO ABANDON WELL	<input type="checkbox"/>	

RECEIVED
AUG 30 1962
U. S. GEOLOGICAL SURVEY
DURING 2010

(INDICATE ABOVE BY CHECK MARK NATURE OF REPORT, NOTICE, OR OTHER DATA)

July 27, 1962

Snow Flake

Well No. 1 is located 1850 ft. from N line and 2110 ft. from E line of sec. 32

NW 1/4 SE 1/4 sec 32 T-31N R-15W NMPM
(1/4 Sec. and Sec. No.) (Twp.) (Range) (Meridian)

Verde Gallup San Juan New Mexico
(Field) (County or Subdivision) (State or Territory)

The elevation of the ~~surface~~ ^{ground level} above sea level is 5383 ft.

DETAILS OF WORK

(State names of and expected depths to objective sands; show sizes, weights, and lengths of proposed casings; indicate mudding jobs, cementing points, and all other important proposed work)

Gallup 2230 ft. Will set 100 ft. 8 5/8, J-55, 24 lb surface casing with 60 sx cement. Rotary drill to 2230 ft. and set 5 1/2 in. J-55, 14.6 lb. casing with 125 sx cement. Air drill to TD, 2330. Remove rig and frac open hole with 1000 bbls of oil and 10,000 lbs. 10-20 sand. Run 2 3/8 in. tubing, J-55, 4.6 lb and 5/8 in. scrapped rods and place on pump.



I understand that this plan of work must receive approval in writing by the Geological Survey before operations may be commenced.

Company A. L. Duff, Jr.

Address 515 Simms Bldg.

Albuquerque, New Mexico

By Frank A. King
Title Landman

NEW MEXICO OIL CONSERVATION COMMISSION

Well Location and Acreage Dedication Plat

Section A.

Date July 27, 1962

Operator A. L. DUFF, JR. Lease (Well: ~~1850~~)
Well No. 2 Unit Letter I Section 32 Township 31 NORTH Range 15 WEST NMPM
Located 1850 Feet From the SOUTH Line, 2110 Feet From the EAST Line
County SAN JUAN G. L. Elevation 5383.5 Dedicated Acreage 80 Acres
Name of Producing Formation Gallup Pool Verde Gallup

- 1. Is the Operator the only owner in the dedicated acreage outlined on the plat below?
2. If the answer to question one is "no", have the interests of all the owners been consolidated by communitization agreement or otherwise?
3. If the answer to question two is "no", list all the owners and their respective interests below:

Owner Land Description

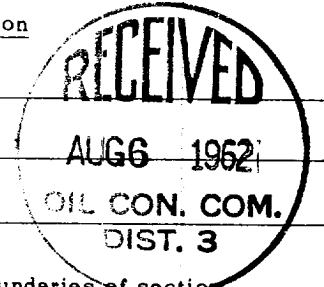

Section B.

Note: All distances must be from outer boundaries of section.

This is to certify that the information in Section A above is true and complete to the best of my knowledge and belief.

A. L. Duff, Jr. (Operator)
Frank A. King (Representative)
515 Sims Bldg. (Address)
Albuquerque, New Mexico

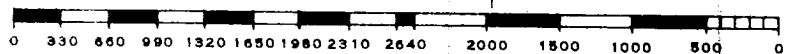
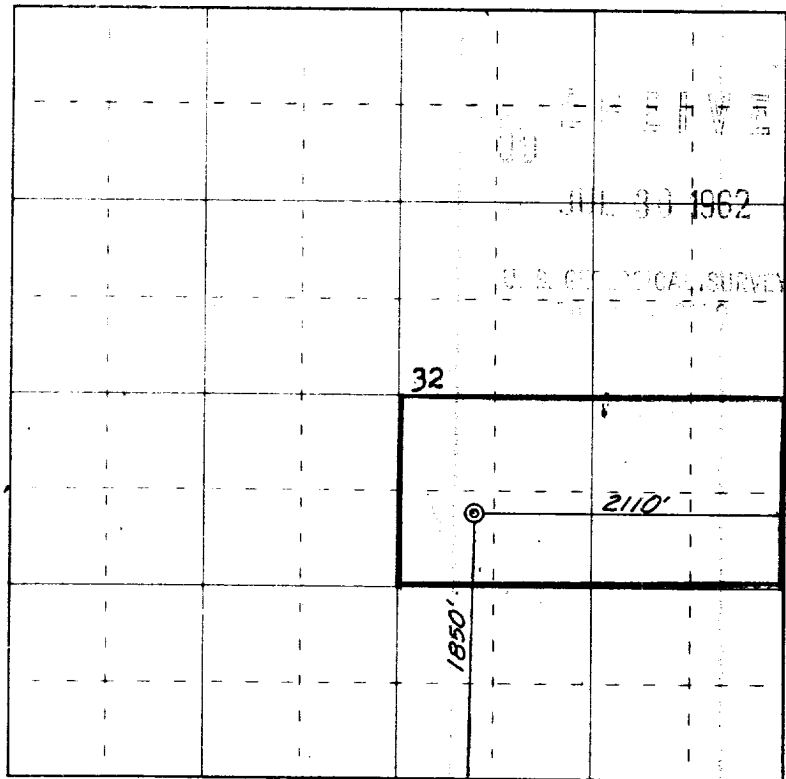

Scale 4 inches equal 1 mile

This is to certify that the above plat was prepared from field notes of actual surveys made by me or under my supervision and that the same are true and correct to the best of my knowledge and belief.

Date Surveyed 14 July 1962

James P. Leese Registered Professional Engineer and/or Land Surveyor
James P. Leese N. Mex. Reg. No. 1463
San Juan Engineering Company

(Seal)

Farmington, New Mexico