

(SUBMIT IN TRIPLICATE)

UNITED STATES
DEPARTMENT OF THE INTERIOR
GEOLOGICAL SURVEY

Land Office Farmington
Lease No. 8707839
Unit Johnston-Federal

SUNDRY NOTICES AND REPORTS ON WELLS

NOTICE OF INTENTION TO DRILL	<input checked="" type="checkbox"/>	SUBSEQUENT REPORT OF WATER SHUT-OFF	
NOTICE OF INTENTION TO CHANGE PLANS		SUBSEQUENT REPORT OF SHOOTING OR ACIDIZING	
NOTICE OF INTENTION TO TEST WATER SHUT-OFF		SUBSEQUENT REPORT OF ALTERING CASING	
NOTICE OF INTENTION TO RE-DRILL OR REPAIR WELL		SUBSEQUENT REPORT OF RE-DRILLING OR REPAIR	
NOTICE OF INTENTION TO SHOOT OR ACIDIZE		SUBSEQUENT REPORT OF ABANDONMENT	
NOTICE OF INTENTION TO PULL OR ALTER CASING		SUPPLEMENTARY WELL HISTORY	
NOTICE OF INTENTION TO ABANDON WELL			

(INDICATE ABOVE BY CHECK MARK NATURE OF REPORT, NOTICE, OR OTHER DATA)

August 19, 1963

Well No. 9 is located 1850 ft. from N line and 790 ft. from E line of sec. 35

SE NE Section 35 (1/4 Sec. and Sec. No.) 31N (Twp.) 9W (Range) 106M (Meridian)

Blanco Mesquite (Field) San Juan (County or Subdivision) New Mexico (State or Territory)

The elevation of the oil surface above sea level is 5975 ft.

DETAILS OF WORK

(State names of and expected depths to objective sands; show sizes, weights, and lengths of proposed casings; indicate mudding jobs, cementing points, and all other important proposed work)

It is planned to:

Drill 13-3/4" hole to approx. 200 ft. Set 10-3/4" 32.75# H-40 casing and cement to surface. Drill 9-7/8" hole to 3000 ft. with mud. Set 7" 20# J-55 casing at 3000 ft., cement with 750 sx inner cement. Drill 6-1/4" hole with gas to 3250 ft. Set 4-1/2" 9.5# J-55 casing, cement to a point above intermediate casing. Perforate Point Lookout and Cliff House zones of Mesquite, and sand-water free. Run 2-1/8" tubing, put well on production.

AUG 28 1963

I understand that this plan of work must receive approval in writing by the Geological Survey before operations may be commenced.

Company Union Texas Petroleum, A Division of Allied Chemical Corporation

Address Suite B-400, 1740 Broadway

Denver, Colorado 80202

By /s/ T. W. Adair, Jr.

Title Petroleum Engineer

NEW MEXICO OIL CONSERVATION COMMISSION
Well Location and Acreage Dedication Plat

SECTION A.

Date August 19, 1963

Operator Union Texas Petroleum Lease Johnston Federal
 Well No. 91-8 Unit Letter H Section 35 Township 31 North Range 9 West NMPM
 Located 1850 Feet From North Line, 790 Feet From East Line
 County San Juan G. L. Elevation 5975 Dedicated Acreage 300 Acres
 Name of Producing Formation Messavada Pool Messavada

1. Is the Operator the only owner* in the dedicated acreage outlined on the plat below? Yes _____ No X
2. If the answer to question One is "No," have the interests of all the owners been consolidated by communitization agreement or otherwise? Yes X No _____. If answer is "Yes," Type of Consolidation
Co-ownership of Lease
3. If the answer to question Two is "No," list all the owners and their respective interests below:

OWNER

LAND DESCRIPTION

SECTION B.

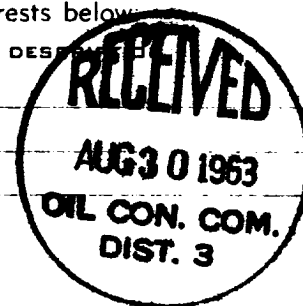
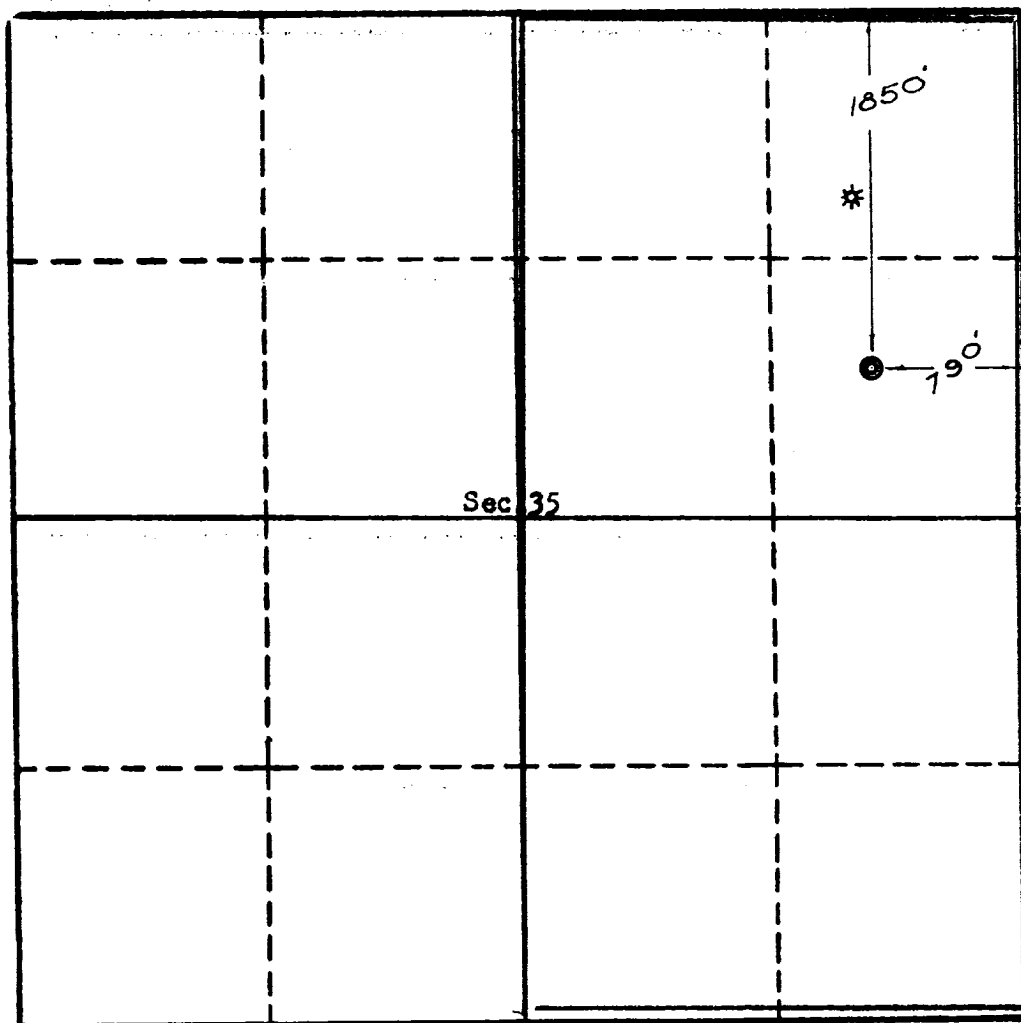

This is to certify that the information in Section A above is true and complete to the best of my knowledge and belief.

Union Texas Petroleum
(OPERATOR)

T. W. Mair, Jr.
(REPRESENTATIVE)

Suite B-400, 1740 Broadway
Denver, Colorado 80202
(ADDRESS)

STATE OF NEW MEXICO
 This is to certify that the well location shown on the plat in Section B was plotted from field notes of actual surveys made by me or under my supervision and that the same is true and correct to the best of my knowledge and belief.

Date Surveyed Feb. 15, 1963

FARMINGTON, NEW MEXICO

Emmett J. Cobb
REGISTERED ENGINEER OR
LAND SURVEYOR

Certificate No. 3602

NEW MEXICO OIL CONSERVATION COMMISSION
Well Location and Acreage Dedication Plat

SECTION A.

Date August 19, 1963

Operator Union Texas Petroleum Lease Johnston Federal
 Well No. 92-8 Unit Letter H Section 35 Township 31 North Range 9 West NMPM
 Located 1850 Feet From North Line, 790 Feet From East Line
 County San Juan G. L. Elevation 5975 Dedicated Acreage 320 Acres
 Name of Producing Formation Mesaverde Pool Blanco Mesaverde

1. Is the Operator the only owner* in the dedicated acreage outlined on the plat below? Yes _____ No X
2. If the answer to question One is "No," have the interests of all the owners been consolidated by communitization agreement or otherwise? Yes X No _____. If answer is "Yes," Type of Consolidation
Co-ownership of lease
3. If the answer to question Two is "No," list all the owners and their respective interests below:

OWNER

LAND DESCRIPTION

SECTION B.

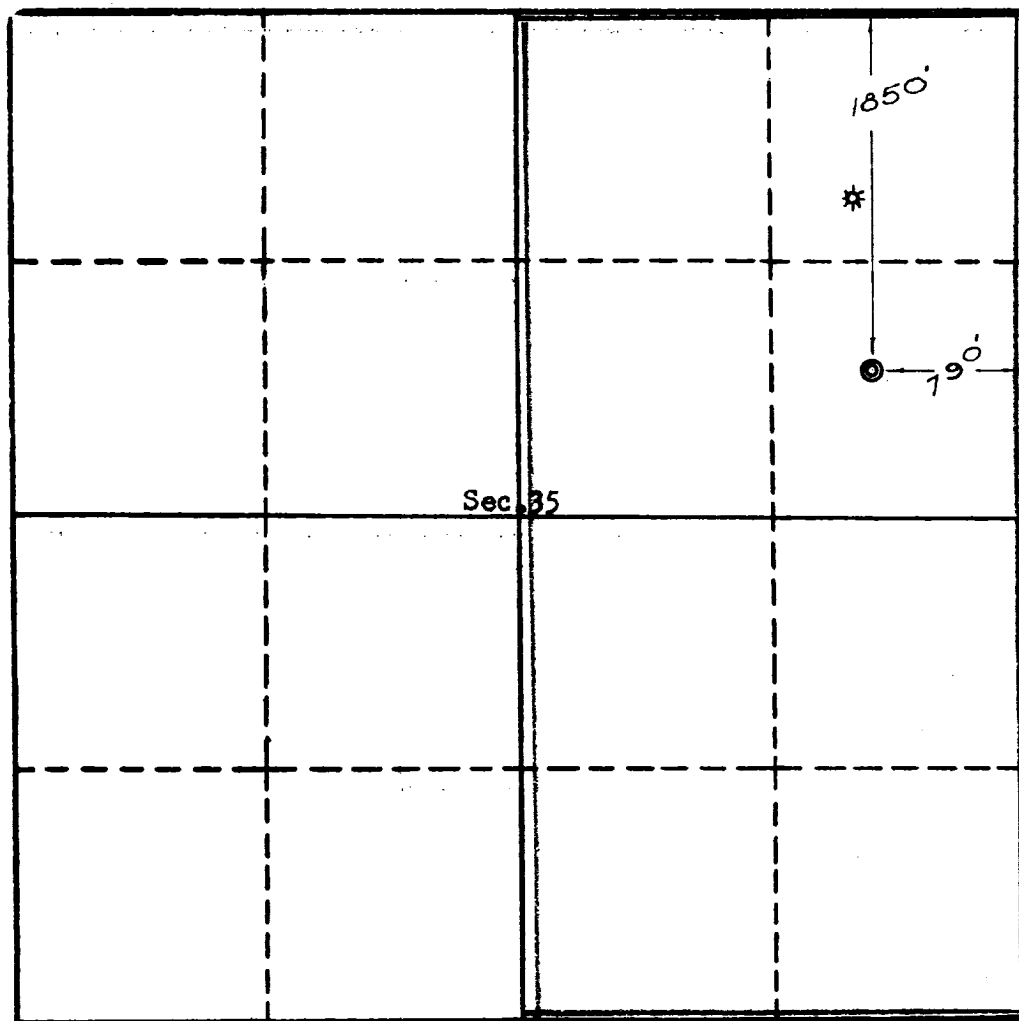

This is to certify that the information in Section A above is true and complete to the best of my knowledge and belief.

Union Texas Petroleum
 (OPERATOR)

T. W. Adair, Jr.

(REPRESENTATIVE)

Suite B-400, 1740 Broadway
Denver, Colorado 80202

(ADDRESS)

STATE OF NEW MEXICO
 This is to certify that the well location shown on the plat in Section B was plotted from field notes of actual surveys made by me or under my supervision and that the same is true and correct to the best of my knowledge and belief.

Date Surveyed Feb. 15, 1963

FARMINGTON, NEW MEXICO

Emmett C. Cook
 REGISTERED ENGINEER OR
 LAND SURVEYOR

Certificate No. 3602

