

(SUBMIT IN TRIPLICATE)

UNITED STATES
DEPARTMENT OF THE INTERIOR
GEOLOGICAL SURVEY

Budget Bureau No. 42-R359.4.
Approval expires 12-31-60.

Indian Agency _____

Allottee _____

Lease No. _____

SUNDRY NOTICES AND REPORTS ON WELLS

NOTICE OF INTENTION TO DRILL _____	SUBSEQUENT REPORT OF WATER SHUT-OFF _____
NOTICE OF INTENTION TO CHANGE PLANS _____	SUBSEQUENT REPORT OF SHOOTING OR ACIDIZING _____
NOTICE OF INTENTION TO TEST WATER SHUT-OFF _____	SUBSEQUENT REPORT OF ALTERING CASING _____
NOTICE OF INTENTION TO REDRILL OR REPAIR WELL _____	SUBSEQUENT REPORT OF REDRILLING OR REPAIR _____
NOTICE OF INTENTION TO SHOOT OR ACIDIZE _____	SUBSEQUENT REPORT OF ABANDONMENT _____
NOTICE OF INTENTION TO PULL OR ALTER CASING _____	SUPPLEMENTARY WELL HISTORY _____
NOTICE OF INTENTION TO ABANDON WELL _____	

(INDICATE ABOVE BY CHECK MARK NATURE OF REPORT, NOTICE, OR OTHER DATA)

February 21, 1961

Well No. 530-21 is located _____ ft. from N line and _____ ft. from E line of sec. 35

S. 1/4 N. 1/4 Sec. 35 (1/4 Sec. and Sec. No.) T. 51 N. R. 16 W. (Twp.) (Range) N. 1/2 E. (Meridian)

Horsehoe Gulch (Field) San Juan (County or Subdivision) New Mexico (State or Territory)

The elevation of the derrick floor above sea level is _____ ft.

DETAILS OF WORK

(State names of and expected depths to objective sands; show sizes, weights, and lengths of proposed casings; indicate mudding jobs, cementing points, and all other important proposed work)

We propose to drill a well at the above location to an approximate total depth of 1300'. 100' of 8 5/8" O.D. casing will be run and cemented to surface. Completion is contemplated in the Gallup formation. A 4 1/2" O.D. casing oil string will be used.

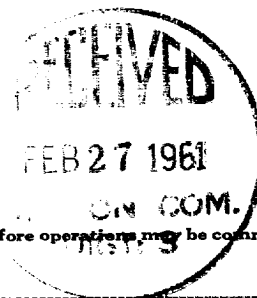

I understand that this plan of work must receive approval in writing by the Geological Survey before operations may be commenced.

Company The Atlantic Refining Company

Address P. O. Box 520

Casper, Wyoming

By A. D. Hobbs Regional Drilling Manager

Title Regional Drilling Manager

1940-00-00-00-00-00
U.S. Navy
Washington

1940-00-00-00-00-00

1940-00-00-00-00-00
U.S. Navy
Washington

NEW MEXICO OIL CONSERVATION COMMISSION

Well Location and Acreage Dedication Plat

Section A.

Date February 2, 1961

Operator THE ATLANTIC REFINING COMPANY Lease UTE
 Well No. 11 Unit Letter F Section 35 Township 31 NORTH Range 16 WEST, NMPM
 Located 2105 Feet From the NORTH Line, 2105 Feet From the WEST Line
 County SAN JUAN G. L. Elevation 5647.0 Dedicated Acreage 39.765 Acres
 Name of Producing Formation Gallup Pool Horseshoe-Gallup

1. Is the Operator the only owner in the dedicated acreage outlined on the plat below?

Yes ☒ No ☐2. If the answer to question one is "no", have the interests of all the owners been consolidated by communitization agreement or otherwise? Yes ☐ No ☐ If answer is "yes", Type of Consolidation.

3. If the answer to question two is "no", list all the owners and their respective interests below:

Owner

Land Description

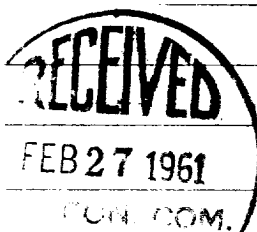

RECEIVED

FEB 23 1961

U. S. GEOLOGICAL SURVEY

Section B.

Note: All distances must be from outer boundaries of section.

This is to certify that the information
 in Section A above is true and complete
 to the best of my knowledge and belief.

The Atlantic Refining Co.

(Operator)

*L. B. Kelly*L. B. Kelly

(Representative)

P. O. Box 520

(Address)

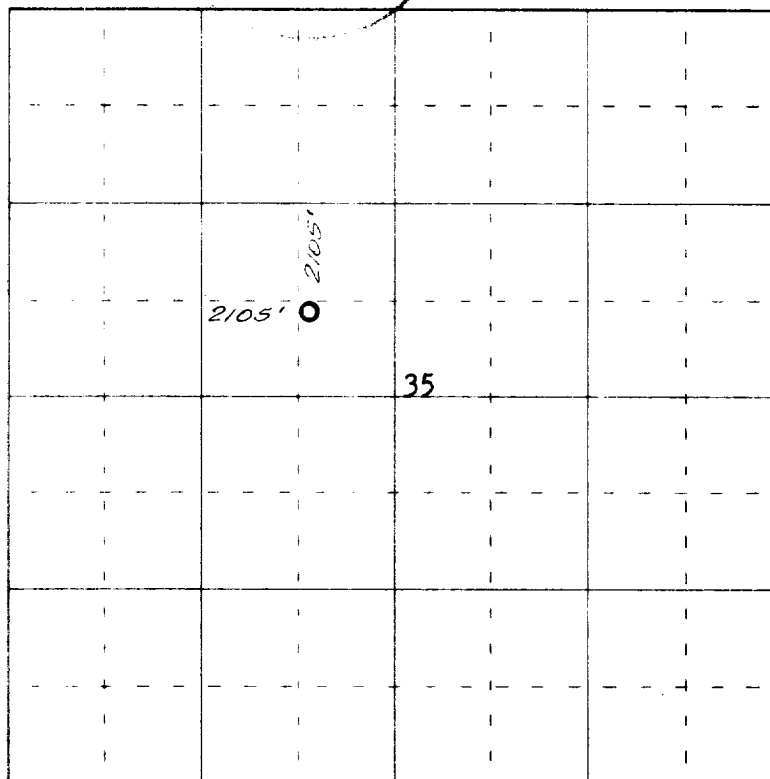
Casper, Wyoming

N

0 330 660 990 1320 1650 1980 2310 2640 2000 1500 1000 500 0

Scale 4 inches equal 1 mile

Ref: SJE survey dated October 1958

This is to certify that the above plat was prepared from field notes of actual surveys
 made by me or under my supervision and that the same are true and correct to the best
 of my knowledge and belief.

(Seal)

Date Surveyed 8 February 1961

James P. Leese
 Registered Professional Engineer and/or Land Surveyor
 James P. Leese N. Mex. Reg. No. 1463

Farmington, New Mexico