

(SUBMIT IN TRIPLICATE)

UNITED STATES
DEPARTMENT OF THE INTERIOR
GEOLOGICAL SURVEY

Indian Agency _____

Window Rock

Allottee Navajo Tribal

Lease No. 1b-20-603-73

SUNDRY NOTICES AND REPORTS ON WELLS

NOTICE OF INTENTION TO DRILL	<input checked="" type="checkbox"/>	SUBSEQUENT REPORT OF WATER SHUT-OFF	
NOTICE OF INTENTION TO CHANGE PLANS		SUBSEQUENT REPORT OF SHOOTING OR ACIDIZING	
NOTICE OF INTENTION TO TEST WATER SHUT-OFF		SUBSEQUENT REPORT OF ALTERING CASING	
NOTICE OF INTENTION TO REDRILL OR REPAIR WELL		SUBSEQUENT REPORT OF REDRILLING OR REPAIR	
NOTICE OF INTENTION TO SHOOT OR ACIDIZE		SUBSEQUENT REPORT OF ABANDONMENT	
NOTICE OF INTENTION TO PULL OR ALTER CASING		SUPPLEMENTARY WELL HISTORY	
NOTICE OF INTENTION TO ABANDON WELL			

(INDICATE ABOVE BY CHECK MARK NATURE OF REPORT, NOTICE, OR OTHER DATA)

RECEIVED
JAN 20 1959
U. S. GEOLOGICAL SURVEY
FARMINGTON, NEW MEXICO

January 19, 1959

Well No. Navajo 30 is located 620 ft. from N line and 701 ft. from W line of sec. 31

31 N Sec. 31 31 N 16 W N.M.P.M.
(34 Sec. and Sec. No.) (Twp.) (Range) (Meridian)

Horsesteele Gallup San Juan New Mexico
(Field) (County or Subdivision) (State or Territory)

The elevation of the ground above sea level is 5199 ft.

DETAILS OF WORK

(State names of and expected depths to objective sands; show sizes, weights, and lengths of proposed casings; indicate mudding jobs, cementing points, and all other important proposed work)

We propose to drill a well with rotary tools at the above location to an approximate total depth of 1500'. 100' of 8-5/8" O.D. casing will be set and cemented to surface. Completion is contemplated in the Gallup formation. Should the well prove productive a 4-1/2" O.D. oil string will be used.

I understand that this plan of work must receive approval in writing by the Geological Survey before operations may be commenced.

Company The Atlantic Refining Company

Address P. O. Box 520

Casper, Wyoming

By B. J. Sartain

Title Drilling Superintendent

Index

[illegible]

Should the well prove productive a 1-1/2" oil string will be used above the 11' string. The 1-1/2" oil string will be cemented and cemented to surface. Completion is recommended in the below formation. approximately 1000' to 1200' The casing will be set free of liner points and the above formation is to be drilled to a well with a 1-1/2" oil string.

135 2017 1 5

Figure 1 consists of two maps. Map (a) shows the location of the study area within the Iberian Peninsula, highlighting the Mediterranean Sea and the Atlantic Ocean. Map (b) shows the location of the study area within the Iberian Peninsula, highlighting the Mediterranean Sea and the Atlantic Ocean.

James O. B. E.
Director of the Bureau of the Census

NEW MEXICO OIL CONSERVATION COMMISSION

Well Location and Acreage Dedication Plat

Section A.

Date **January 12, 1959**Operator **ATLANTIC OIL & REFINING COMPANY**

Lease

Well No. **NAVAJO 30** Unit Letter **D** Section **31**Township **31 NORTH** Range **16 WEST**Located **620** Feet From **NORTH** Line **701**Foot From **WEST** LineCounty **SAN JUAN** G. L. Elevation **5499.12**Dedicated Acreage **12.00** AcresName of Producing Formation **Gallup**Pool **Horseshoe Gallup**

1. Is the Operator the only owner in the dedicated acreage outlined on the plat below?

Yes ☒ No ☐2. If the answer to question one is "no", have the interests of all the owners been consolidated by communitization agreement or otherwise? Yes ☐ No ☐ If answer is "yes", Type of Consolidation.

3. If the answer to question two is "no", list all the owners and their respective interests below:

Owner

Land Description

RECEIVED
JAN 20 1959
 U. S. GEOLOGICAL SURVEY
 FARMINGTON, NEW MEXICO

Section B.

Note: All distances must be from corner boundaries of section.

This is to certify that the information
 in Section A above is true and complete
 to the best of my knowledge and belief.

The Atlantic Refining Company

(Operator)

B. B. Sartin

(Representative)

P. O. Box 520

(Address)

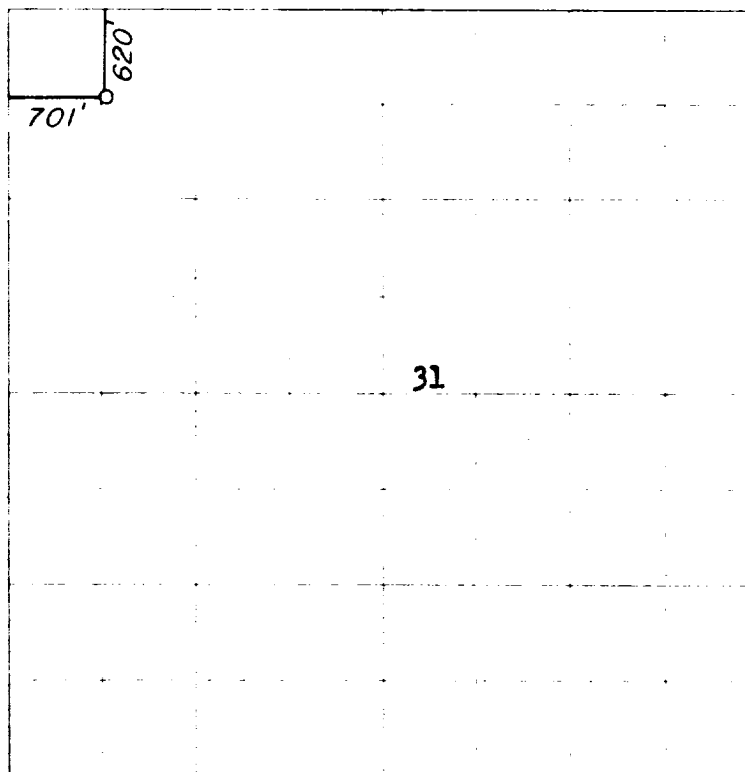
Casper, Wyoming

0 330 660 990 1320 1650 1980 2310 2640 2000 1500 1000 500 0

Scale 4 inches equal 1 mile



This is to certify that the above plat was prepared from field notes of actual surveys made by me or under my supervision and that the same are true and correct to the best of my knowledge and belief.

Date Surveyed **Jan 9, 1959**

James P. Leese
 Registered Professional Engineer and/or Land Surveyor
 James P. Leese N. Mex. Reg. No. 1463