

6 120
2 14pan Oil Co.
1 14pan Oil Co.
1 14pan Oil Co.
1 14pan Oil Co.

(SUBMIT IN TRIPLICATE)

Indian Agency _____
Oto Indian _____
Allottee _____
Lease No. 14-20-604-00

UNITED STATES
DEPARTMENT OF THE INTERIOR
GEOLOGICAL SURVEY

APPROVED

JUL 17 1962

JERRY W.
DISTRICT

SUNDRY NOTICES AND REPORTS ON WELLS

NOTICE OF INTENTION TO DRILL	<input checked="" type="checkbox"/>	SUBSEQUENT REPORT OF WATER SHUT-OFF	
NOTICE OF INTENTION TO CHANGE PLANS		SUBSEQUENT REPORT OF SHOOTING OR ACIDIZING	
NOTICE OF INTENTION TO TEST WATER SHUT-OFF		SUBSEQUENT REPORT OF ALTERING CASING	
NOTICE OF INTENTION TO REDRILL OR REPAIR WELL		SUBSEQUENT REPORT OF REDRILLING OR REPAIR	
NOTICE OF INTENTION TO SHOOT OR ACIDIZE		SUBSEQUENT REPORT OF ABANDONMENT	
NOTICE OF INTENTION TO PULL OR ALTER CASING		SUPPLEMENTARY WELL HISTORY	
NOTICE OF INTENTION TO ABANDON WELL			

(INDICATE ABOVE BY CHECK MARK NATURE OF REPORT, NOTICE, OR OTHER DATA)

July 16, 1962

Well No. 1 is located 1700 ft. from [S] line and 1990 ft. from [E] line of sec. 27
NW 1/4 Sec 27 (1/4 Sec. and Sec. No.) 31N (Twp.) 15W (Range) T12N (Meridian)
Wardle College (Field) San Juan (County or Subdivision) New Mexico (State or Territory)

The elevation of the ~~surface~~ ground level above sea level is 5560 ft.

DETAILS OF WORK

(State names of and expected depths to objective sands; show sizes, weights and lengths of proposed casings; indicate mudlogging jobs, cementing points, and all other important proposed work)

Plan to drill 12 1/4" surface hole to 130' run 5/8" surface csg cemented w/sufficient cement to circulate. Drill 7 7/8" hole to 200' run 1 1/2" csg. cemented w/100 cu. The well will then be drilled to a total depth of at max. 2775', the open hole will then be sand-oil free.



I understand that this plan of work must receive approval in writing by the Geological Survey before operations are commenced.

Company 14pan Oil Co.
Address P.O. Box 1072
San Angelo, Texas

By Original signed by T. A. Dugan
Title Consulting Engineer

NEW MEXICO OIL CONSERVATION COMMISSION

Well Location and Acreage Dedication Plat

Section A.

Date July 16, 1962

Operator LIPAN OIL COMPANY Lease Ute "C"
 Well No. 1 Unit Letter J Section 27 Township 31 NORTH Range 15 WEST, NMPM
 Located 1700 Feet From the SOUTH Line, 1990 Feet From the EAST Line
 County SAN JUAN G. L. Elevation 5560.0 Dedicated Acreage 40 Acres
 Name of Producing Formation Gallup Pool Verde Gallup

1. Is the Operator the only owner in the dedicated acreage outlined on the plat below?
 Yes X No _____
2. If the answer to question one is "no", have the interests of all the owners been consolidated by communitization agreement or otherwise? Yes _____ No _____. If answer is "yes", Type of Consolidation.
3. If the answer to question two is "no", list all the owners and their respective interests below:

Owner

Land Description

Section B.

This is to certify that the information in Section A above is true and complete to the best of my knowledge and belief.

Lipan Oil CompanyOriginal signed by T. A. Dugan

(Representative)

Consulting Engineer

(Address)

1007 E. DustinFarmington, New Mexico

Note: All distances must be from outer boundaries of section.

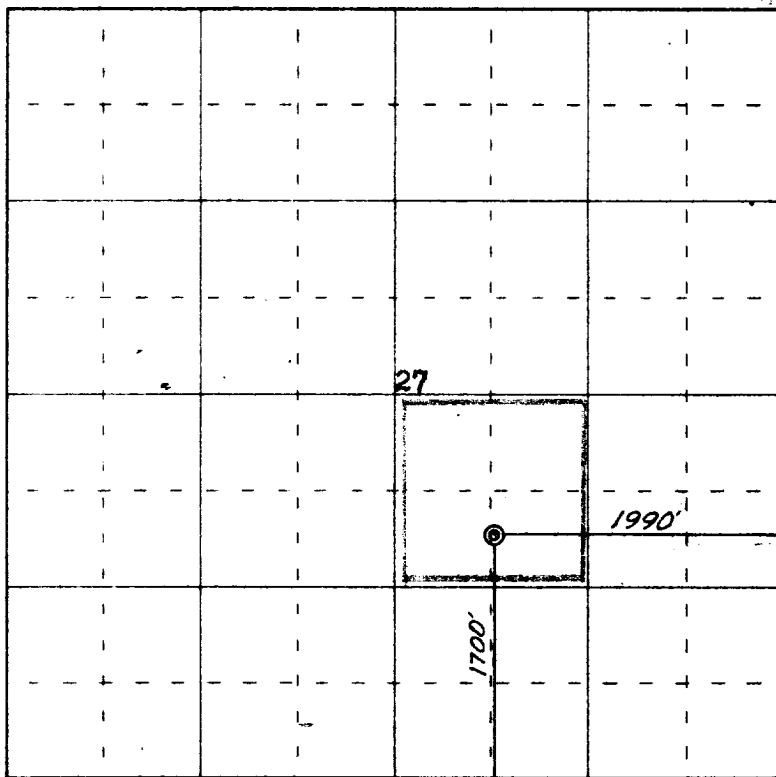

0 330 660 990 1320 1650 1980 2310 2640 2000 1500 1000 500 0

Scale 4 inches equal 1 mile



This is to certify that the above plat was prepared from field notes of actual surveys made by me or under my supervision and that the same are true and correct to the best of my knowledge and belief.

Date Surveyed 7 July 1962

James P. Leese
 Registered Professional Engineer and/or Land Surveyor
 James P. Leese N. Mex. Reg. No. 1463
 San Juan Engineering Company

(Seal)

Farmington, New Mexico