

(SUBMIT IN TRIPLICATE)

UNITED STATES
DEPARTMENT OF THE INTERIOR
GEOLOGICAL SURVEY

Indian Agency _____

Window Rock

Allottee Navajo Tribal

Lease No. 14-20-603-73

SUNDRY NOTICES AND REPORTS ON WELLS

NOTICE OF INTENTION TO DRILL	<input checked="" type="checkbox"/>	SUBSEQUENT REPORT OF WATER SHUT-OFF	
NOTICE OF INTENTION TO CHANGE PLANS		SUBSEQUENT REPORT OF SHOOTING OR ACIDIZING	
NOTICE OF INTENTION TO TEST WATER SHUT-OFF		SUBSEQUENT REPORT OF ALTERING CASING	
NOTICE OF INTENTION TO REDRILL OR REPAIR WELL		SUBSEQUENT REPORT OF REDRILLING OR REPAIR	
NOTICE OF INTENTION TO SHOOT OR ACIDIZE		SUBSEQUENT REPORT OF ABANDONMENT	
NOTICE OF INTENTION TO PULL OR ALTER CASING		SUPPLEMENTARY WELL HISTORY	
NOTICE OF INTENTION TO ABANDON WELL			

(INDICATE ABOVE BY CHECK MARK NATURE OF REPORT, NOTICE, OR OTHER DATA)

APR 15 1959

RECEIVED
GEOLOGICAL SURVEY
NEW MEXICO

April 14, 1959

Well No. 17 is located 1980 ft. from N line and 1980 ft. from E line of sec. 30

C 34 NE Sec. 30 T1 N R 26 W N.M.P.M.
(Sec. and Sec. No.) (Twp.) (Range) (Meridian)

Horseshoe Gallup San Juan New Mexico
(Field) (County or Subdivision) (State or Territory)

The elevation of the ~~drill hole~~ ^{ground} above sea level is 5553.6 ft.

DETAILS OF WORK

(State names of and expected depths to objective sands; show sizes, weights, and lengths of proposed casings; indicate mudding jobs, cementing points, and all other important proposed work)

We propose to drill a well at the above location to an approximate total depth of 1500'. 100' of 8-5/8" O.D. casing will be set and cemented to surface. Should the well prove productive a 4-1/2" O.D. oil string will be used. Completion is contemplated in the Gallup formation.

I understand that this plan of work must receive approval in writing by the Geological Survey before operations may be commenced.

Company The Atlantic Refining Company

Address P. O. Box 520

Casper, Wyoming

By A. D. Klopfer

Title Drilling Superintendent

NEW MEXICO OIL CONSERVATION COMMISSION

Well Location and Acreage Dedication Plat

Section A.

Date April 9, 1959

Operator THE ATLANTIC REFINING COMPANY Lease NAVAJO
 Well No. 47 Unit Letter G Section 30 Township 31 NORTH Range 16 WEST NMPM
 Located 1980 Feet From NORTH Line, 1980 Feet From EAST Line
 County SAN JUAN G. L. Elevation 5553.6 Dedicated Acreage 80 Acres
 Name of Producing Formation Gallup Pool Horseshoe Gallup

1. Is the Operator the only owner in the dedicated acreage outlined on the plat below?
 Yes X No _____
2. If the answer to question one is "no", have the interests of all the owners been consolidated by communitization agreement or otherwise? Yes _____ No _____. If answer is "yes", Type of Consolidation.
3. If the answer to question two is "no", list all the owners and their respective interests below:

OwnerLand Description

Section B.

This is to certify that the information in Section A above is true and complete to the best of my knowledge and belief.

The Atlantic Refining Company
 (Operator)

A. D. Florin
 (Representative)

P.O. Box 520
 (Address)

Casper, Wyoming

Note: All distances must be from outer boundaries of section.

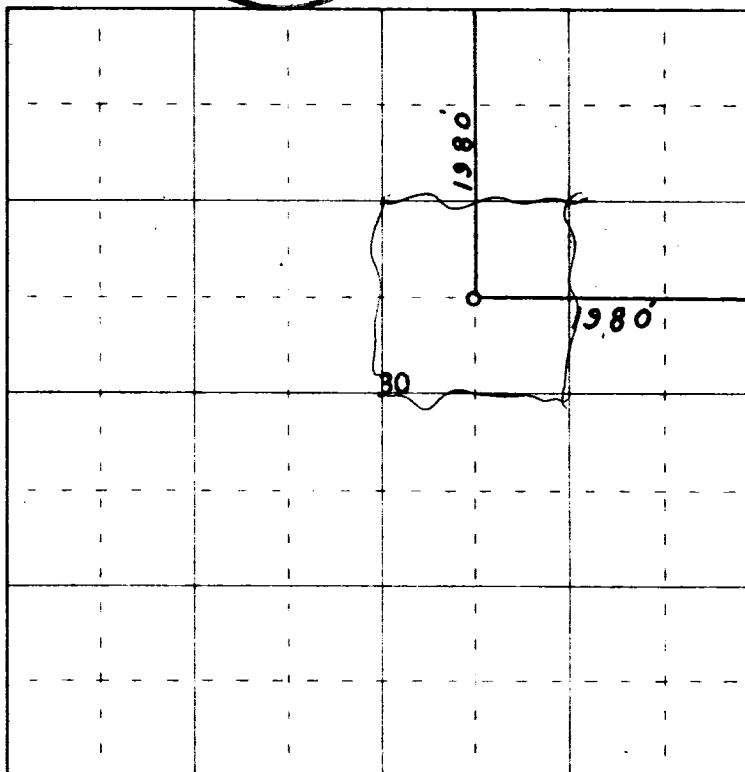

0 330 660 990 1320 1650 1980 2310 2640 2000 1800 1600 1400 1200 1000 800 600 400 200 0

Scale 4 inches equal 1 mile

This is to certify that the above plat was prepared from field notes of actual surveys made by me or under my supervision and that the same are true and correct to the best of my knowledge and belief.

Date Surveyed 8 April 1959

James B. Lease
 Registered Professional Engineer and/or Land Surveyor



1
2
3
4
5
6
7
8
9
10
11
12
13
14
15
16
17
18
19
20
21
22
23
24
25
26
27
28
29
30
31
32
33
34
35
36
37
38
39
40
41
42
43
44
45
46
47
48
49
50
51
52
53
54
55
56
57
58
59
60
61
62
63
64
65
66
67
68
69
70
71
72
73
74
75
76
77
78
79
80
81
82
83
84
85
86
87
88
89
90
91
92
93
94
95
96
97
98
99
100

1
2
3
4
5
6
7
8
9
10
11
12
13
14
15
16
17
18
19
20
21
22
23
24
25
26
27
28
29
30
31
32
33
34
35
36
37
38
39
40
41
42
43
44
45
46
47
48
49
50
51
52
53
54
55
56
57
58
59
60
61
62
63
64
65
66
67
68
69
70
71
72
73
74
75
76
77
78
79
80
81
82
83
84
85
86
87
88
89
90
91
92
93
94
95
96
97
98
99
100

1
2
3
4
5
6
7
8
9
10
11
12
13
14
15
16
17
18
19
20
21
22
23
24
25
26
27
28
29
30
31
32
33
34
35
36
37
38
39
40
41
42
43
44
45
46
47
48
49
50
51
52
53
54
55
56
57
58
59
60
61
62
63
64
65
66
67
68
69
70
71
72
73
74
75
76
77
78
79
80
81
82
83
84
85
86
87
88
89
90
91
92
93
94
95
96
97
98
99
100

1
2
3
4
5
6
7
8
9
10
11
12
13
14
15
16
17
18
19
20
21
22
23
24
25
26
27
28
29
30
31
32
33
34
35
36
37
38
39
40
41
42
43
44
45
46
47
48
49
50
51
52
53
54
55
56
57
58
59
60
61
62
63
64
65
66
67
68
69
70
71
72
73
74
75
76
77
78
79
80
81
82
83
84
85
86
87
88
89
90
91
92
93
94
95
96
97
98
99
100