

(SUBMIT IN TRIPLICATE)

Indian Agency **Navajo Tribal**

UNITED STATES
DEPARTMENT OF THE INTERIOR
GEOLOGICAL SURVEY

Allottee _____
Lease No. **14-20-603-2037**

		X

SUNDRY NOTICES AND REPORTS ON WELLS

NOTICE OF INTENTION TO DRILL	X	SUBSEQUENT REPORT OF WATER SHUT-OFF	
NOTICE OF INTENTION TO CHANGE PLANS		SUBSEQUENT REPORT OF SHOOTING OR ACIDIZING	
NOTICE OF INTENTION TO TEST WATER SHUT-OFF		SUBSEQUENT REPORT OF ALTERING CASING	
NOTICE OF INTENTION TO REDRILL OR REPAIR WELL		SUBSEQUENT REPORT OF REDRILLING OR REPAIR	
NOTICE OF INTENTION TO SHOOT OR ACIDIZE		SUBSEQUENT REPORT OF ABANDONMENT	
NOTICE OF INTENTION TO PULL OR ALTER CASING		SUPPLEMENTARY WELL HISTORY	
NOTICE OF INTENTION TO ABANDON WELL			

RECEIVED

JAN 26 1959

GEOLOGICAL SURVEY
NEW MEXICO

(INDICATE ABOVE BY CHECK MARK NATURE OF REPORT, NOTICE, OR OTHER DATA)

January 23, 1959

Chimney Rock
Well No. **8-A** is located **1863** ft. from **N** line and **630** ft. from **E** line of sec. **25**
SE NE/4 Sec. 25 **31N** **17W** **NMPM**
(1/4 Sec. and Sec. No.) (Twp.) (Range) (Meridian)
Horseshoe Gallup Ext. **San Juan** **New Mexico**
(Field) (County or Subdivision) (State or Territory)

The elevation of the derrick floor above sea level is **5774** ft.

DETAILS OF WORK

(State names of and expected depths to objective sands; show sizes, weights, and lengths of proposed casings; indicate mudding jobs, cementing points, and all other important proposed work)

It is intended to drill a well through the Lower-Gallup Formation using rotary tools and mud circulation. Possible productive intervals will be perforated and sandoil fractured.

Estimated Total Depth 1550'.

Casing Program:

8-5/8" at 100' with 100 sacks cement circulated to surface
5-1/2" at 1550' with 100 sacks cement.

The SE NE/4 of Section 25 is dedicated to this well.
SE NE/4 Section 25 Navajo Tribal 14-20-603-2037



I understand that this plan of work must receive approval in writing by the Geological Survey before operations may be commenced.

Company **El Paso Natural Gas Products Company**

Address **Post Office Box 1565**
Farmington, New Mexico

ORIGINAL SIGNED BY: WILLIAM K. GLAZENER

By _____
Title **Petroleum Engineer**

Well Location and Acreage Dedication Plat

Section A.

Date JANUARY 20, 1959

Navajo Tribal Contract

Operator EL PASO NATURAL GAS PRODUCTS CO.

Locality CHIMNEY ROCK 14-20-603-2037

Well No. 8-A Unit Letter H Section 25

Township 31 NORTH Range 17 WEST NMPM

Located 1863 Feet From NORTH Line 630

Feet From EAST Line

County SAN JUAN G. L. Elevation 5764.0

Dedicated Acreage 40

Acres

Name of Producing Formation Lower Gallup

Pool Horseshoe Gallup

1. Is the Operator the only owner in the dedicated acreage outlined on the plat below?

Yes ☒ No

2. If the answer to question one is "no", have the interests of all the owners been consolidated by communitization agreement or otherwise? Yes No If answer is "yes", Type of Consolidation.

3. If the answer to question two is "no", list all the owners and their respective interests below:

Owner

Land Description

Section B.

This is to certify that the information in Section A above is true and complete to the best of my knowledge and belief.

El Paso Natural Gas Products Co.

(Operator)

ORIGINAL SIGNED BY: JOSEPH E. KREGER

(Representative)

Post Office Box 1565

(Address)

Farmington, New Mexico

Note: All distances must be from outer boundaries of section.

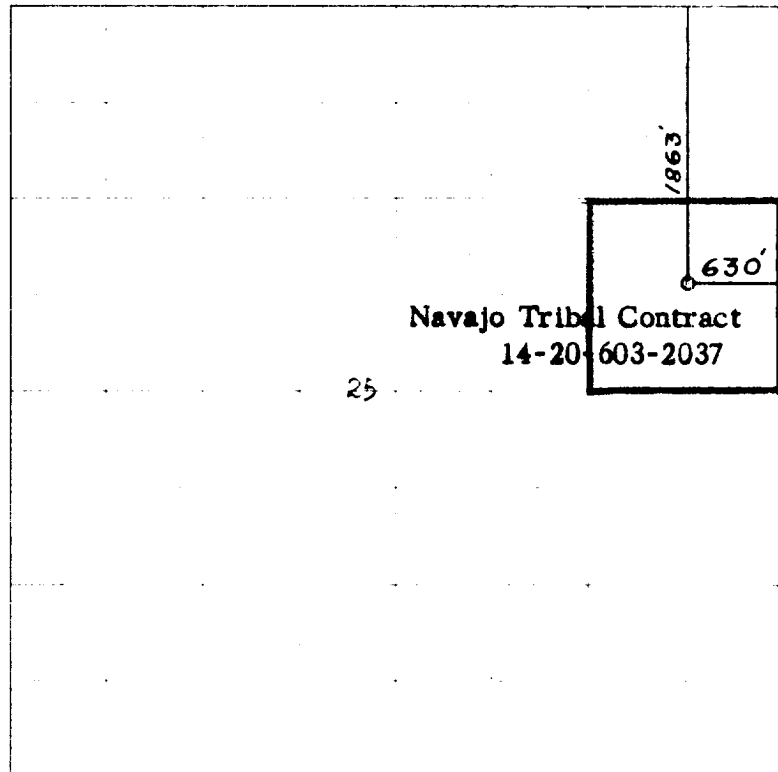

0 330 660 990 1320 57 198 231 264 297 330 363 396 429 462 495 528 561 594 627 660 693 726 759 792 825 858 891 924 957 990 1023 1056 1089 1122 1155 1188 1221 1254 1287 1320

Scale 4 inches equal 1 mile

This is to certify that the above plat was prepared from field notes of actual survey made by me or under my supervision and that the same are true and correct to the best of my knowledge and belief.

(Seal)

Farmington, New Mexico

Date Surveyed 20 JANUARY 1959

James P. Leese
 Registered Professional Engineer and/or Land Surveyor
 James P. Leese N. Mex. Reg. No. 1463