

(SUBMIT IN TRIPLICATE)

Indian Agency Ute Mtn

Tribe Lands

UNITED STATES
DEPARTMENT OF THE INTERIOR
GEOLOGICAL SURVEY

Allottee _____
Contract No. 14-00-604-57
Lease No. _____

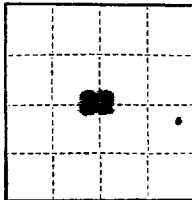

SUNDRY NOTICES AND REPORTS ON WELLS

NOTICE OF INTENTION TO DRILL	<input checked="" type="checkbox"/>	SUBSEQUENT REPORT OF WATER SHUT-OFF	
NOTICE OF INTENTION TO CHANGE PLANS		SUBSEQUENT REPORT OF SHOOTING OR ACIDIZING	
NOTICE OF INTENTION TO TEST WATER SHUT-OFF		SUBSEQUENT REPORT OF ALTERING CASING	
NOTICE OF INTENTION TO REDRILL OR REPAIR WELL		SUBSEQUENT REPORT OF REDRILLING OR REPAIR	
NOTICE OF INTENTION TO SHOOT OR ACIDIZE		SUBSEQUENT REPORT OF ABANDONMENT	
NOTICE OF INTENTION TO PULL OR ALTER CASING		SUPPLEMENTARY WELL HISTORY	
NOTICE OF INTENTION TO ABANDON WELL			

(INDICATE ABOVE BY CHECK MARK NATURE OF REPORT, NOTICE, OR OTHER DATA)

March 19, 19 57

Ute Mountain Tribe "A"

Well No. 6 is located 2310 ft. from N line and 330 ft. from E line of sec. 22

NE NE SE Sec. 22

(1/4 Sec. and Sec. No.)

T31N

(Twp.)

R13W

(Range)

T20N

(Meridian)

Verde-Gallup

(Field)

San Juan

(County or Subdivision)

New Mexico

(State or Territory)

The elevation of the derrick floor above sea level is 5604 ft.

DETAILS OF WORK

(State names of and expected depths to objective sands; show sizes, weights, and lengths of proposed casings; indicate mudding jobs, cementing points, and all other important proposed work)

We propose to drill a well at the above location through the Tertiary formation to an estimated total depth of 2430'. 2-5/8", 20#, 2-40 casing will be set at 130' and cemented to the surface with 40 sacks.

Estimated logs are as follows: Shinarump 1130, Tertiary 2400. 5-1/8", 15.2#, 4-7#. This casing will be run to 2370' and cemented with 100 sacks. The Tertiary will be cased with crude oil.

All work to be done in accordance with the Rules and Regulations of the U.S.G.S. and New Mexico Oil and Gas Conservation Commission.

I understand that this plan of work must receive approval in writing by the Geological Survey before operations are commenced.

Company TRANSMISSION GAS TRANSMISSION COMPANY

Address P. O. Box 1772

Casper, Wyoming

By Robertson Lay
Title District Superintendent

**NEW MEXICO
OIL CONSERVATION COMMISSION**

Form C-128

Well Location and/or Gas Proration Plat

Date.....

Operator **TENNESSEE GAS TRANSMISSION CO.** Lease **UTE MOUNTAIN TRIBE "A"**
Well No. **6** Section **22** Township **31 N** Range **15 W** NMPM
Located **2310** Feet From **south** Line, **330** Feet From **east** Line,
San Juan County, New Mexico, G. L. Elevation **5595**

Name of Producing Formation Pool Dedicated Acreage

(Note: All distances must be from outer boundaries of Section)

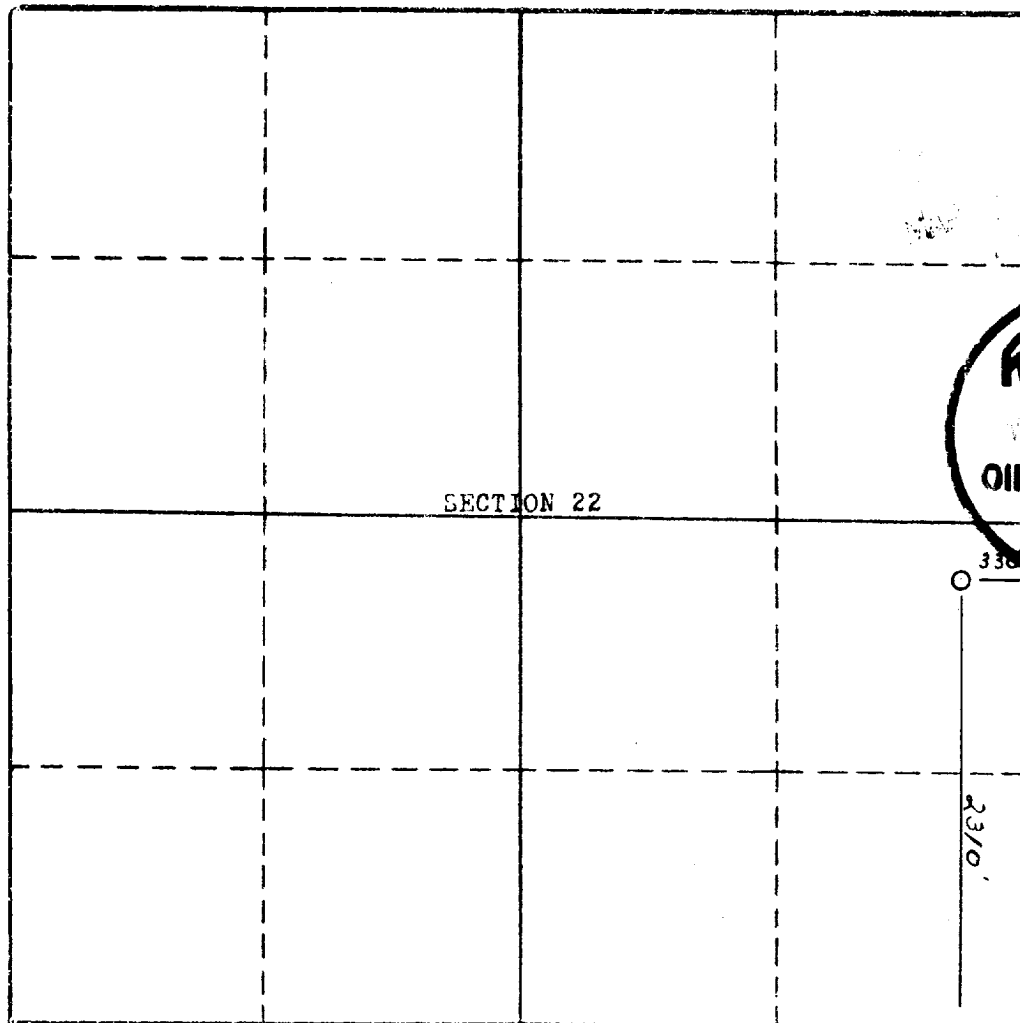

Scale—1 Inch Equals 1000 Feet

1. Is this Well a Dual Comp.? Yes ☐ No ☐
2. If the answer to Question 1 is yes, are there any other dually completed wells within the dedicated acreage? Yes ☐ No ☐

This is to certify that the above plat was prepared from field notes of actual surveys made by me or under my supervision and that the same are true and correct to the best of my knowledge and belief.

Name
Position
Representing
Address

Date Surveyed **March 8, 1957**

Stephen H. Kinney

STEPHEN H. KINNEY,
Registered Professional Engineer and Land Surveyor