

(SUBMIT IN TRIPLICATE)

UNITED STATES  
DEPARTMENT OF THE INTERIOR  
GEOLOGICAL SURVEY

Indian Agency \_\_\_\_\_  
Allottee \_\_\_\_\_  
Lease No. **11-80-603-2196**

SUNDRY NOTICES AND REPORTS ON WELLS

NOTICE OF INTENTION TO DRILL	<input checked="" type="checkbox"/>	SUBSEQUENT REPORT OF WATER SHUT-OFF	<div style="border: 2px solid black; padding: 5px; text-align: center;"> <b>RECEIVED</b>  <b>OCT 19 1961</b>  <b>U. S. GEOLOGICAL SURVEY</b>  <b>FARMINGTON, NEW MEXICO</b> </div>
NOTICE OF INTENTION TO CHANGE PLANS	<input type="checkbox"/>	SUBSEQUENT REPORT OF SHOOTING OR ACIDIZING	
NOTICE OF INTENTION TO TEST WATER SHUT-OFF	<input type="checkbox"/>	SUBSEQUENT REPORT OF ALTERING CASING	
NOTICE OF INTENTION TO REDRILL OR REPAIR WELL	<input type="checkbox"/>	SUBSEQUENT REPORT OF REDRILLING OR REPAIR	
NOTICE OF INTENTION TO SHOOT OR ACIDIZE	<input type="checkbox"/>	SUBSEQUENT REPORT OF ABANDONMENT	
NOTICE OF INTENTION TO PULL OR ALTER CASING	<input type="checkbox"/>	SUPPLEMENTARY WELL HISTORY	
NOTICE OF INTENTION TO ABANDON WELL	<input type="checkbox"/>		

(INDICATE ABOVE BY CHECK MARK NATURE OF REPORT, NOTICE, OR OTHER DATA)

October 16, 1961

**Core Hole**

Well No. **23** is located **660** ft. from **SW** line and **1900** ft. from **W** line of sec. **24**

**SE 34 Section 24** (1/4 Sec. and Sec. No.)      **24** (Twp.)      **19W** (Range)      **106N** (Meridian)

**Wilcox** (Field)      **San Juan** (County or Subdivision)      **New Mexico** (State or Territory)

The elevation of the derrick floor above sea level is \_\_\_\_\_ ft. **4789' ungraded ground.**

DETAILS OF WORK

(State names of and expected depths to objective sands; show sizes, weights, and lengths of proposed casings; indicate mudding jobs, cementing points, and all other important proposed work)

Rotary drilling equipment will be used to drill to approximately 105' to the San Juan Formation. If production is found, casing will be set and cemented with required amount of cement. Native mud and water will be used in drilling. Shows will be tested and electric logs will be run prior to setting casing or abandonment. Stimulation treatments may be employed in completion.

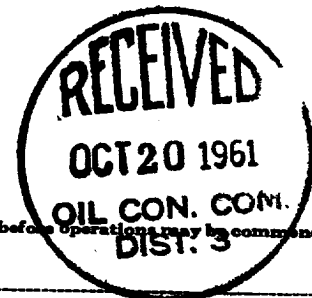

I understand that this plan of work must receive approval in writing by the Geological Survey before operations may be commenced.

Company **Pueblo Oil & Refining Company**

Address **P. O. Box 1082, Durango, Colorado**

By **COPY (ORIGINAL SIGNED) B. M. BRADLEY**  
**B. M. Bradley**  
Title **Dist. Eng.**

NUMBER OF COPIES RECEIVED	
DISTRIBUTION	
SALE PRICE	
FILE	
U.S.G.S.	
LAND OFFICE	
TRANSPORTER	OIL GAS
PRODUCTION OFFICE	
OPERATOR	

**NEW MEXICO OIL CONSERVATION COMMISSION**  
**WELL LOCATION AND ACREAGE DEDICATION PLAT**  
 SEE INSTRUCTIONS FOR COMPLETING THIS FORM ON THE REVERSE SIDE

FORM C-128  
 Revised 5/1/57

**SECTION A**

Operator <b>Humble Oil &amp; Refining Company</b>		Lease <b>Core Hole</b>		Well No. <b>23</b>
Unit Letter <b>N</b>	Section <b>24</b>	Township <b>31 N</b>	Range <b>19 W</b>	County <b>San Juan</b>
Actual Footage Location of Well: <b>660</b> feet from the <b>South</b> line and <b>1980</b> feet from the <b>West</b> line				
Ground Level Elev. <b>4789'</b>	Producing Formation		Pool <b>Wildcat</b>	Dedicated Acreage: Acres

1. Is the Operator the only owner in the dedicated acreage outlined on the plat below? YES ☒ NO \_\_\_\_\_. ("Owner" means the person who has the right to drill into and to produce from any pool and to appropriate the production either for himself or for himself and another. (65-3-29 (e) NMSA 1935 Comp.)
2. If the answer to question one is "no," have the interests of all the owners been consolidated by communitization agreement or otherwise? YES \_\_\_\_\_. If answer is "yes," Type of Consolidation \_\_\_\_\_
3. If the answer to question two is "no," list all the owners and their respective interests below:

Owner	Land Description

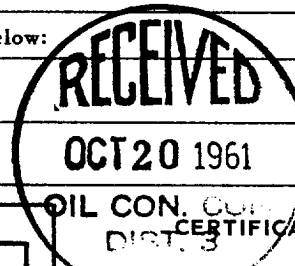

**SECTION B**

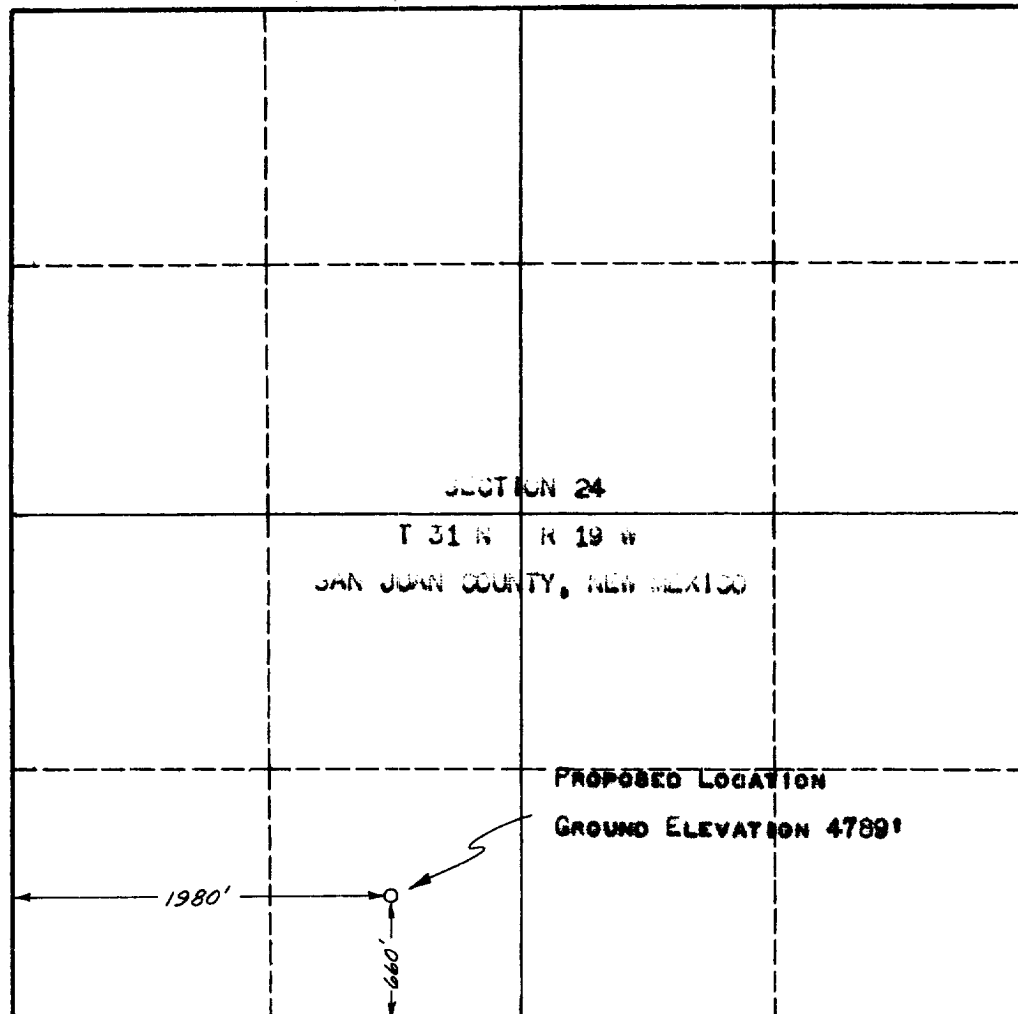

I hereby certify that the information in SECTION A above is true and complete to the best of my knowledge and belief.

<b>COPY (ORIGINAL SIGNED)</b>	<b>B. M. BRADLEY</b>
Position	<b>B. M. Bradley</b> <b>Dist. Supt.</b>
Company	<b>Humble Oil &amp; Refining Co.</b>
Date	<b>October 16, 1961</b>

I hereby certify that the well location shown on the plat in SECTION B was plotted from field notes of actual surveys made by me or under my supervision, and that the same is true and correct to the best of my knowledge and belief.

Date Surveyed	<b>OCTOBER 14, 1961</b>
Registered Professional Engineer and/or Land Surveyor	<i>Edman M. Plank</i>
Certificate No.	<b>NEW MEXICO 3169</b>

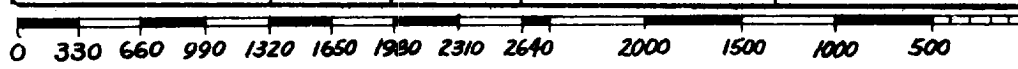

## INSTRUCTIONS FOR COMPLETION OF FORM C-128

1. Operator shall furnish and certify to the information called for in Section A.
2. Operator shall outline the dedicated acreage for *both* oil and gas wells on the plat in Section B.
3. A registered professional engineer or land surveyor registered in the State of New Mexico or approved by the Commission shall show on the plat the location of the well and certify this information in the space provided.
4. All distances shown on the plat must be from the outer boundaries of the Section.
5. If additional space is needed for listing owners and their respective interests as required in question 3 of Section A, please use space below.