

(SUBMIT IN TRIPLICATE)

Indian Agency Navajo

UNITED STATES  
DEPARTMENT OF THE INTERIOR  
GEOLOGICAL SURVEY

Allottee 14-20-603-2037  
Lease No. \_\_\_\_\_

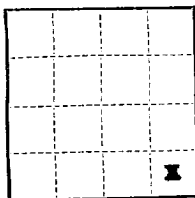

SUNDRY NOTICES AND REPORTS ON WELLS

NOTICE OF INTENTION TO DRILL _____	<input checked="" type="checkbox"/>	SUBSEQUENT REPORT OF WATER SHUT-OFF _____	
NOTICE OF INTENTION TO CHANGE PLANS _____		SUBSEQUENT REPORT OF SHOOTING OR ACIDIZING _____	
NOTICE OF INTENTION TO TEST WATER SHUT-OFF _____		SUBSEQUENT REPORT OF ALTERING CASING _____	
NOTICE OF INTENTION TO REDRILL OR REPAIR WELL _____		SUBSEQUENT REPORT OF REDRILLING OR REPAIR _____	
NOTICE OF INTENTION TO SHOOT OR ACIDIZE _____		SUBSEQUENT REPORT OF ABANDONMENT _____	
NOTICE OF INTENTION TO PULL OR ALTER CASING _____		SUPPLEMENTARY WELL HISTORY _____	
NOTICE OF INTENTION TO ABANDON WELL _____			

(INDICATE ABOVE BY CHECK MARK NATURE OF REPORT, NOTICE, OR OTHER DATA)

December 1, 1958

**Chimney Rock**  
Well No. 2-A is located 1875 ft. from N line and 1900 ft. from E line of sec. 24  
NE/4 SE/4, Sec. 24 31 North 17 West NMPM  
(1/4 Sec. and Sec. No.) (Twp.) (Range) (Meridian)  
Undesignated San Juan New Mexico  
(Field) (County or Subdivision) (State or Territory)

The elevation of the derrick floor above sea level is 5682 ft.

DETAILS OF WORK

(State names of and expected depths to objective sands; show sizes, weights, and lengths of proposed casings; indicate mudding jobs, cementing points, and all other important proposed work)

It is intended to drill a well through the Lower-Gallup formation using rotary tools and mud circulation. Possible productive intervals will be perforated and sandoil fractured.

Estimated Total Depth - 1490'

Casing Program:

8-3/8 at 100' with 100 sacks cement circulated to surface.

5-1/2 @ 1490' with 100 sacks cement.

The NE/4 SE/4 of Section 24 is dedicated to this well.

NE/4 SE/4, Section 24, Navajo Tribal Contract 14-20-603-2037.

I understand that this plan of work must receive approval in writing by the Geological Survey before operations may be commenced.

Company El Paso Natural Gas Products Company

Address Post Office Box 1565  
Farmington, New Mexico

By William K. Dwyer  
Title Petroleum Engineer



## NEW MEXICO OIL CONSERVATION COMMISSION

## Well Location and Acreage Dedication Plat

Section A.

Date **December 1, 1958**Operator **EL PASO NATURAL GAS PRODUCTS CO.**Locality **CHIMNEY ROCK**Well No. **2-A** Unit Letter **J** Section **24**Township **31 NORTH** Range **17 WEST**, NMPMLocated **1875** Feet From **THE SOUTH** Line, **1900**Feet From **THE EAST** LineCounty **SAN JUAN** G. L. Elevation **5674.2**Dedicated Acreage **40** AcresName of Producing Formation **Gallup**Pool **Undesignated**

1. Is the Operator the only owner in the dedicated acreage outlined on the plat below?

Yes ☒ No ☐2. If the answer to question one is "no", have the interests of all the owners been consolidated by communitization agreement or otherwise? Yes ☐ No ☐ If answer is "yes", Type of Consolidation

Ref: S.J.E. Plat dated 15 Nov. 1958

3. If the answer to question two is "no", list all the owners and their respective interests below:

Owner

Land Description

## Section B.

Note: All distances must be from outer boundaries of section.

This is to certify that the information in Section A above is true and complete to the best of my knowledge and belief.

**El Paso Natural Gas Products Co.**

*William K. Glynn*  
(Operator)  
(Representative)

**P. O. Box 1545**

(Address)

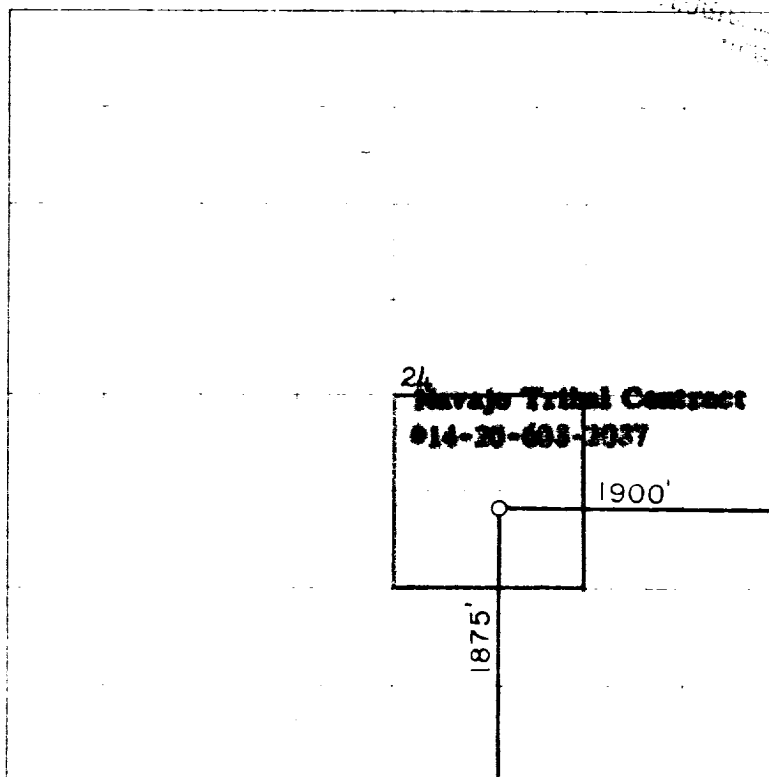
**Farmington, New Mexico**

0 210 55 11 21 170 190 231 2643 2711 15 0 17 1 4 5

Scale: 1 inch equals 1 mile

This is to certify that the above plat was prepared from field notes of actual survey made by me or under my supervision and that the same are true and correct to the best of my knowledge and belief.

(Seal)

Farmington, New Mexico

Date Surveyed **27 November 1958**

*James P. Lease*  
Registered Professional Engineer and/or Land Surveyor  
**James P. Lease, N. Mex. Reg. No. 1463**