

(SUBMIT IN TRIPLICATE)

UNITED STATES
DEPARTMENT OF THE INTERIOR
GEOLOGICAL SURVEY

Land Office

Lease No. NM048376

Unit SF 078464

SUNDRY NOTICES AND REPORTS ON WELLS

NOTICE OF INTENTION TO DRILL.....	X	SUBSEQUENT REPORT OF WATER SHUT-OFF.....
NOTICE OF INTENTION TO CHANGE PLANS.....		SUBSEQUENT REPORT OF SHOOTING OR ACIDIZING.....
NOTICE OF INTENTION TO TEST WATER SHUT-OFF.....		SUBSEQUENT REPORT OF ALTERING CASING.....
NOTICE OF INTENTION TO RE-DRILL OR REPAIR WELL.....		SUBSEQUENT REPORT OF RE-DRILLING OR REPAIR.....
NOTICE OF INTENTION TO SHOOT OR ACIDIZE.....		SUBSEQUENT REPORT OF ABANDONMENT.....
NOTICE OF INTENTION TO PULL OR ALTER CASING.....		SUPPLEMENTARY WELL HISTORY.....
NOTICE OF INTENTION TO ABANDON WELL.....		

(INDICATE ABOVE BY CHECK MARK NATURE OF REPORT, NOTICE, OR OTHER DATA)

July 30, 1963

Williams

Well No. 1-24 is located 1550 ft. from {N
S} line and 790 ft. from {E
W} line of sec. 24NE 24
(1/4 Sec. and Sec. No.)31N
(Twp.)13W
(Range)NMPM
(Meridian)Basin Dakota
(Field)San Juan
(County or Subdivision)New Mexico
(State or Territory)

Blanco Mesaverde

The elevation of the derrick floor above sea level is 5850 ft. GL
5862 KB

DETAILS OF WORK

(State names of and expected depths to objective sands; show sizes, weights, and lengths of proposed casings; indicate mudding jobs, cementing points, and all other important proposed work)

Drill 13" hole to 300'. Set 9-5/8" surface casing at 300', cement to surface with 250 sacks. Drill 7-7/8" hole with mud to total depth of 6780' KB. Run 5-1/2" casing to total depth, cement through casing shoe to isolate Dakota formation, and through a stage collar to isolate Mesaverde formation. Selectively perforate and sand frac Dakota and Mesaverde and effect an approved type dual completion using a packer and two tubing strings.

I understand that this plan of work must receive approval in writing by the Chief Engineer before operations may be commenced.

Company Consolidated Oil & Gas, Inc.

Address 4150 East Mexico Avenue

Denver 22, Colorado

By

Title Chief Engineer

NEW MEXICO OIL CONSERVATION COMMISSION

Well Log and Acreage Dedication Plat

Section A.

Date July 30, 1963

Operator CONSOLIDATED OIL AND GAS INCORPORATED WILLIAMS
 Well No. 1-24 Unit Letter H Section 24 Township 31 NORTH Range 13 WEST NMPN
 Located 1550 Feet From the NORTH Line 790 Feet From the EAST Line
 County SAN JUAN G. L. Elevation 5850.1 Dedicated Acreage 320 Acres
 Name of Producing Formation Mesaverde Pool Blanco

1. Is the Operator the only owner in the dedicated acreage outlined on the plat below?
 Yes _____ No X
2. If the answer to question one is "no", have the interests of all the owners been consolidated by communitization agreement or otherwise? Yes X No ____ If answer is "yes", Type of Consolidation.

Communitization Agreement

3. If the answer to question two is "no", list all the owners and their respective interests below:

OwnerLand Description

Section B.

Note: All distances must be from outer boundaries of section.

This is to certify that the information in Section A above is true and complete to the best of my knowledge and belief.

Consolidated Oil & Gas, Inc.

(Operator).

William

(Representative)

Chief Engineer

(Address)

4150 East Mexico AvenueDenver 22, Colorado

Ref: GLO plat dated 9 July 1954

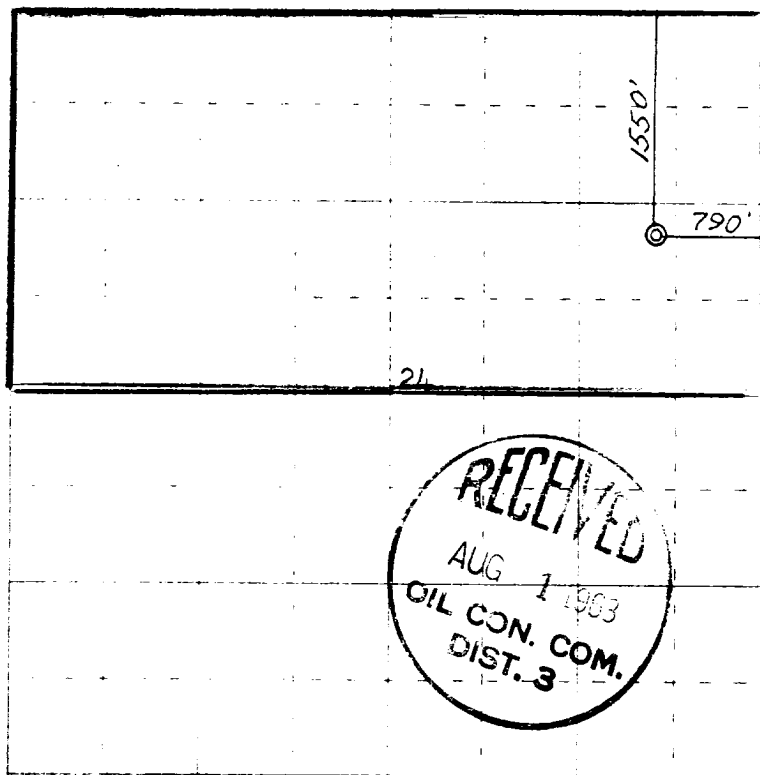

0 330 660 990 1320 1650 1980 2310 2640 2000 1500 1000 500 0

Scale 4 inches equal 1 mile

This is to certify that the above plat was prepared from field notes of actual surveys made by me or under my supervision and that the same are true and correct to the best of my knowledge and belief.

Date Surveyed 22 July 1963

James P. Leese
 Registered Professional Engineer and/or Land Surveyor
 James P. Leese, N. Mex. Reg. No. 1463

July 30, 1963

Consolidated Oil and Gas Incorporated

WILLIAMS

Well No. 1-24 Unit Letter H Section 24

Location 1550 Feet From the NORTH Line 790

County SUT JUNE G. L. Elevation 5350.1

Name of Producing Formation Dakota

31 NORTH 13 EAST

Feet From the EAST Line 320

Basin

1. Is the Operator the only owner in the designated area outlined on the plan below?

Yes ☒ No ☐

2. If not answer to question one is "No", is the interest in the designated area owned by one or more parties in agreement or otherwise? Yes ☒ No ☐ If "Yes", specify type of co-ownership.

Communitization Agreement

3. In the answer to question one is "No", specify the interests in the designated area below:

Owner Description

Section B.

Note: All measurements must be from outer boundaries of section.

This is to certify that the information in Section A above is true and complete to the best of my knowledge and belief.

Consolidated Oil & Gas, Inc.

W. Williams
(Signature)
Chief Engineer

(Address)
4150 East Mexico Avenue

Denver 22, Colorado

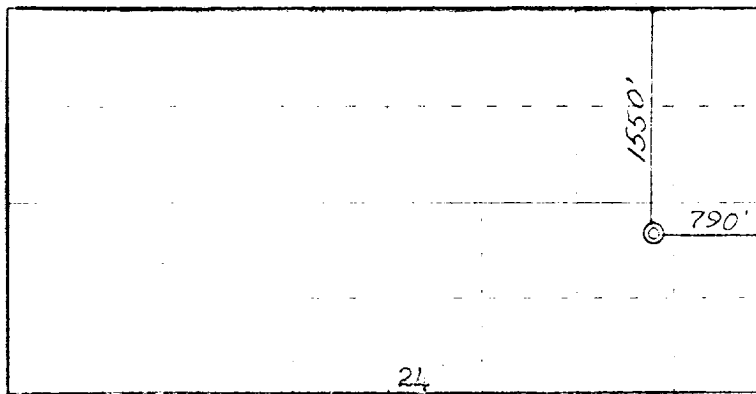

Ref: LSC, Inc. dated 9 July 1954

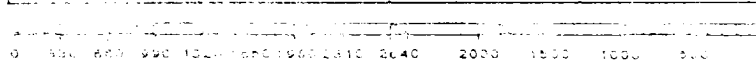
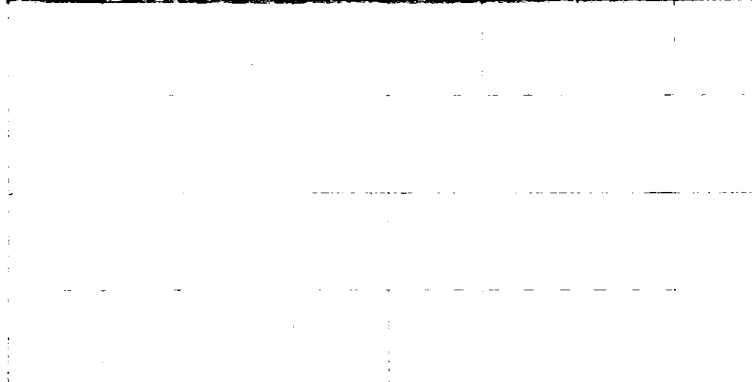

This is to certify that the above plan was prepared from field notes of actual surveys made by me or under my supervision and that the same are true and correct to the best of my knowledge and belief.

Date Surveyed 22 July 1963

James P. Loese
Registered Professional Engineer and a Licensed Surveyor
James P. Loese, R. Lic. Reg. No. 1483