

NEW MEXICO OIL CONSERVATION COMMISSION

NOTICE OF INTENTION TO DRILL

See Rules 101 and 1104.

If changes in the proposed plan are considered advisable, a copy of this notice showing such changes will be returned to the sender. Submit this notice in triplicate. One copy will be returned following approval.

Farmington, New Mexico

September 23, 1952

Place

Date

Notice hereby is given that it is our intention to commence the drilling of a well to be known as.....

El Paso Natural Gas Company Hudson Pool Unit

well No. 1 in SW¹/₄

Company or Operator

Lease

of Sec. 17, T. 31, R. 10W, N. M., P. M., Blanco Pool, San Juan County.

N

The well is 790 feet from ~~NE~~ (S.) line and 1850 feet from

(~~NE~~) (W.) line of the above section. Elevation 6020' Gr.

(Give location from section lines. Cross out wrong directions.)

If state land the oil and gas lease is No. Assignment No.

If patented land the owner is Karl Hudson

Address Aztec, New Mexico

If government land the permittee is.....

Address

The lessee is Stanolind Oil & Gas Company

Address Farmington, New Mexico

We propose to drill well with drilling equipment as follows: Rotary Tools

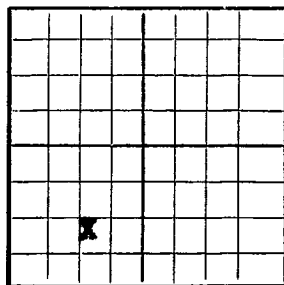

AREA 640 ACRES

LOCATE WELL CORRECTLY

The status of a bond for this well in conformance with Rule 101 of the General Rules and Regulations of the Commission is as follows: State Wide Bond

We propose to use the following strings of casing and to land or cement them as indicated:

Size of Hole	Size of Casing	Weight Per Foot	New or Second Hand	Depth	Landed or Cemented	Sacks Cement
12-1/4	9-5/8	25.4	N	150	Cemented	150
8-3/4	7	20	N	4440	Cemented	300

If changes in the above plans become advisable we will notify you before cementing or landing casing. We estimate that the first productive oil or gas sand should occur at a depth of about 5170 feet. W¹/₂ of Sec. 17 Unit.

Additional information: (Unit-Federal Lease SF 073604, T. B. Scott, E¹/₂ NW¹/₄, SW¹/₄ NW¹/₄, NW¹/₄ SW¹/₄; Beaver Lodge Corp., NW¹/₄ NW¹/₄; Stanolind O & G Co., E¹/₂ SW¹/₄; Federal Lease SF 078314, Southern Union Gas Co., SW¹/₄ SW¹/₄). (Commitment agreement to be filed within 10 days).

1. To drill through Mesa Verde.
2. To use gas circulation in pay.
3. To shoot Mesa Verde with 2 quarts per foot of S.N.G.

Approved....., 19.....

except as follows

SEP 29 1952

EL PASO NATURAL GAS COMPANY

Company or Operator

By..... ORIGINAL SIGNED E. J. COEL

Position..... Petroleum Engineer

Send communications regarding well to:

Name..... E. J. Coel

Address..... P.O. Box 997, Farmington, New Mexico

OIL CONSERVATION COMMISSION,

By.....

Title..... Oil and Gas Inspector Dist. #3.

COMPANY El Paso Natural Gas Company
Well Name & No. Hudson Pool Unit No. 1 Lease No. Fee Land
Location 1850 feet from the West line 790 feet from the South line
Being in The SE⁴ of the SW⁴
Sec. 17, T 31N., R 10W., N.M.P.M., San Juan County, New Mexico
Ground Elevation 6020.23

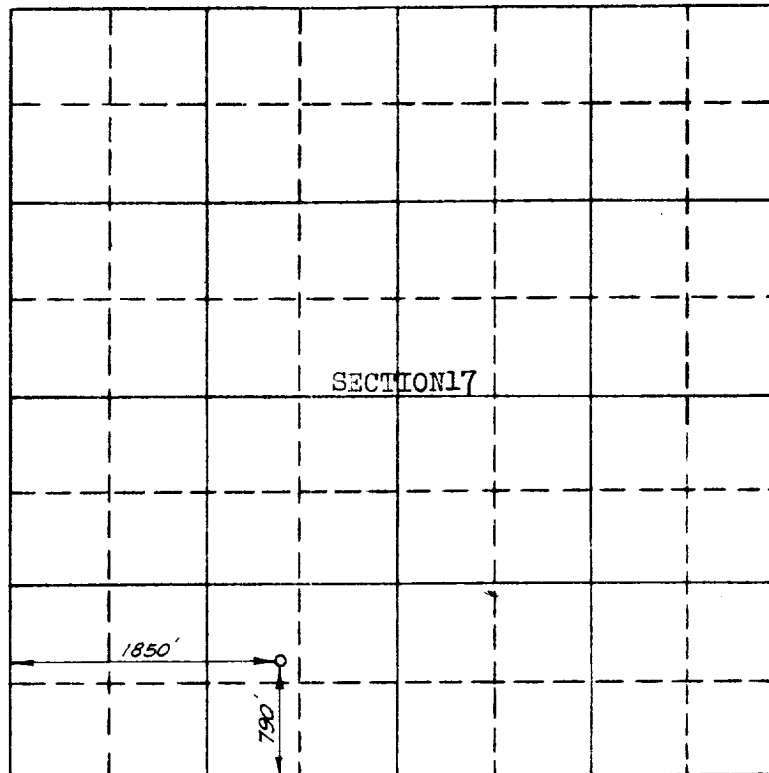

Scale -- 4 inches equals 1 mile

Surveyed February 26, 19 52

This is to certify that the above plat was prepared from field notes of actual surveys made by me or under my supervision and that the same are true and correct to the best of my knowledge and belief.

C. O. Walker
Registered Professional
Engineer and Land Surveyor.

Seal:

Farmington, New Mexico

OIL CONSERVATION COMMISSION
AZTEC DISTRICT OFFICE

No. Copies Received 5

DISTRIBUTION

	NO. FURNISHED	
Operator	<u>1</u>	
Santa Fe	<u>1</u>	
Proration Office		
State Land Office		
U. S. G. S.	<u>2</u>	✓
Transporter		
File	<u>1</u>	✓