

(SUBMIT IN TRIPLICATE)

UNITED STATES  
DEPARTMENT OF THE INTERIOR  
GEOLOGICAL SURVEY

Indian Agency Consolidated Ute  
Agency, Ignacio, Colorado  
Allottee Mountain Ute Tribe  
Lease No. 14-20-60-119

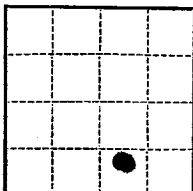

SUNDRY NOTICES AND REPORTS ON WELLS

NOTICE OF INTENTION TO DRILL	<input checked="" type="checkbox"/>	SUBSEQUENT REPORT OF WATER SHUT-OFF	
NOTICE OF INTENTION TO CHANGE PLANS		SUBSEQUENT REPORT OF SHOOTING OR ACIDIZING	
NOTICE OF INTENTION TO TEST WATER SHUT-OFF		SUBSEQUENT REPORT OF ALTERING CASING	
NOTICE OF INTENTION TO REDRILL OR REPAIR WELL		SUBSEQUENT REPORT OF REDRILLING OR REPAIR	
NOTICE OF INTENTION TO SHOOT OR ACIDIZE		SUBSEQUENT REPORT OF ABANDONMENT	
NOTICE OF INTENTION TO PULL OR ALTER CASING		SUPPLEMENTARY WELL HISTORY	
NOTICE OF INTENTION TO ABANDON WELL			

(INDICATE ABOVE BY CHECK MARK NATURE OF REPORT, NOTICE, OR OTHER DATA)

May 21, 1957

Pueblo Mountain  
Well No. Ute #18-15 is located 660 ft. from S line and 1980 ft. from E line of sec. 18  
Sec. 18 31N 14W N.M.P.M.  
(1/4 Sec. and Sec. No.) (Twp.) (Range) (Meridian)  
San Juan New Mexico  
(Field) (County or Subdivision) (State or Territory)

The elevation of the ground level ~~surface~~ above sea level is 9700 ft.

DETAILS OF WORK

(State names of and expected depths to objective sands; show sizes, weights, and lengths of proposed casings; indicate mudding jobs, cementing points, and all other important proposed work)

It is proposed to drill with rotary tools to a depth of 100+ feet, set 9-5/8" casing and cement to surface w/100 san. Thereafter to drill with rotary tools to the top of the producing zone, run electric log and run 5-1/2" casing at approximately 2,500 feet and cement w/90 san. It is then proposed to drill in with cable tools, run GHI log, free through casing w/20,000 gallons of crude and 20,000 sand; run and test well with cable tool rig until daily rate of production is established, and complete. The surface of the section, containing 40 acres, more or less, is dedicated to the well site. Estimated total depth: 2,600+ feet.

I understand that this plan of work must receive approval in writing by the Geological Survey before operations may be commenced.

Company FURCO FRENCHMAN CORPORATION  
Address Post Office Box 1419  
Albuquerque, New Mexico

By Frank E. Gorman, Jr.  
Title Vice President

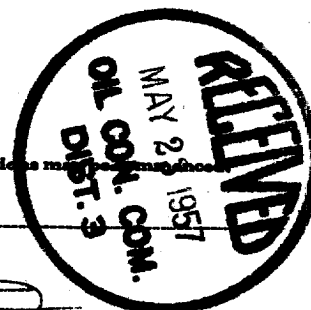

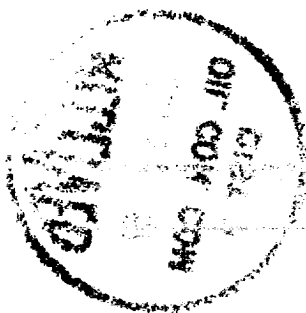

# NEW MEXICO OIL CONSERVATION COMMISSION

*Well Location and/or Gas Proration Plat*

Form C 123

Date **May 21, 1957**

Operator **PUECO PETROLEUM CO.**

Lease **MOUNTAIN UTE**

Well No. **18-15** Section **18** Township **31 N** Range **14 W** NMPM

Located **660** Feet From **south** Line **1980** Feet From **east** Line

**San Juan** County, New Mexico, G. L. Elevation **5700**

Name of Producing Formation **Gallup** Pool **Verde-Gallup** Dedicated Acreage **54.25 (40 ac)**

(Note: All distances must be from outer boundaries of Section)

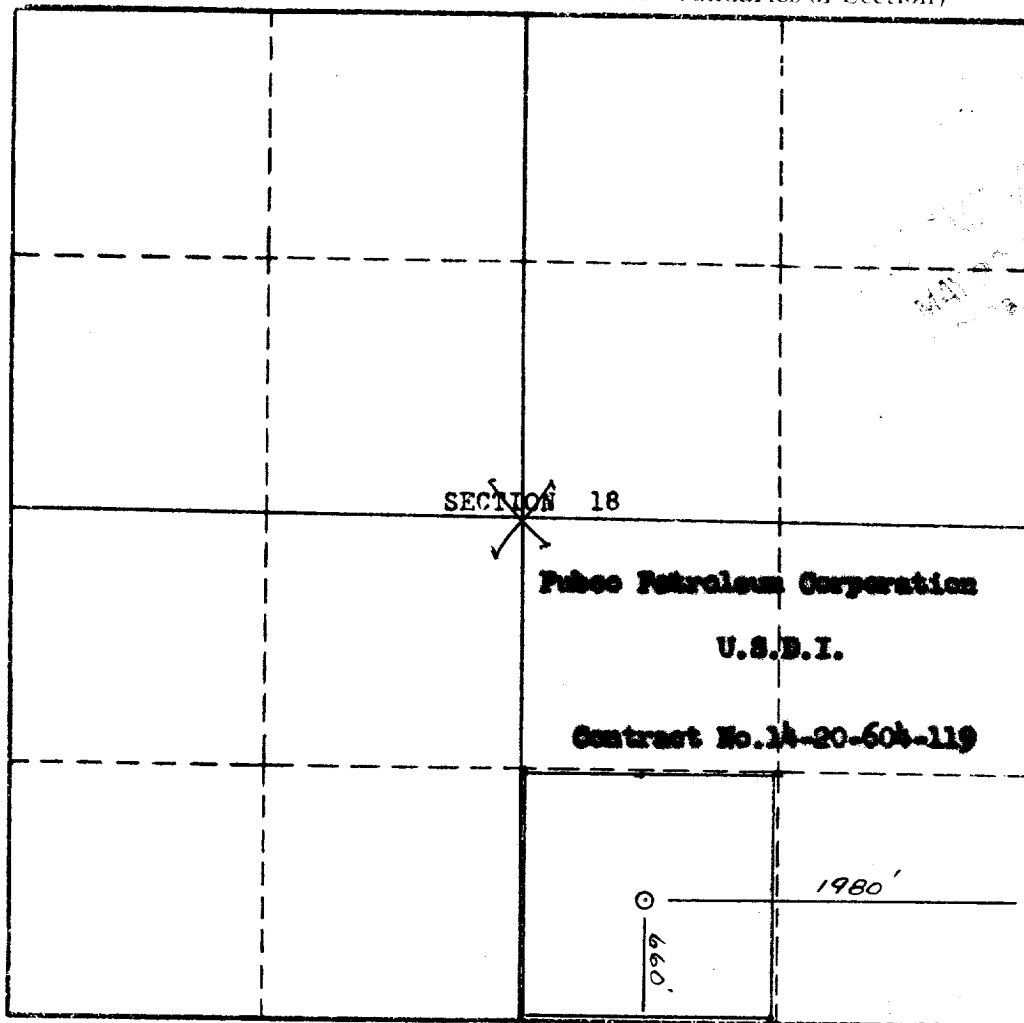

Scale—1 Inch Equals 1000 Feet

1. Is this Well a Dual Comp.? Yes ☐ No ☒
2. If the answer to Question 1 is yes, are there any other dually completed wells within the dedicated acreage? Yes ☒ No ☐

Name **Frank D. Gersham, Jr.**

Position **Vice President**

Representing **Pubco Petroleum Corporation**

Address **Box 1419, Albuquerque, New Mexico**

This is to certify that the above plat was prepared from field notes of actual surveys made by me or under my supervision and that the same are true and correct to the best of my knowledge and belief.

Date Surveyed **May 16, 1957**

*Stephen H. Kinney*

STEPHEN H. KINNEY,

Registered Professional Engineer and Land Surveyor