

| | | | |
|---|--|--|--|
| | | | |
| | | | |
| | | | |
| X | | | |

(SUBMIT IN TRIPLICATE)

UNITED STATES
DEPARTMENT OF THE INTERIOR
GEOLOGICAL SURVEY

Land Office _____
Lease No. **MM 021124**
Unit _____

SUNDRY NOTICES AND REPORTS ON WELLS

| | | | |
|--|-------------------------------------|--|--|
| NOTICE OF INTENTION TO DRILL | <input checked="" type="checkbox"/> | SUBSEQUENT REPORT OF WATER SHUT-OFF | |
| NOTICE OF INTENTION TO CHANGE PLANS | | SUBSEQUENT REPORT OF SHOOTING OR ACIDIZING | |
| NOTICE OF INTENTION TO TEST WATER SHUT-OFF | | SUBSEQUENT REPORT OF ALTERING CASING | |
| NOTICE OF INTENTION TO RE-DRILL OR REPAIR WELL | | SUBSEQUENT REPORT OF RE-DRILLING OR REPAIR | |
| NOTICE OF INTENTION TO SHOOT OR ACIDIZE | | SUBSEQUENT REPORT OF ABANDONMENT | |
| NOTICE OF INTENTION TO PULL OR ALTER CASING | | SUPPLEMENTARY WELL HISTORY | |
| NOTICE OF INTENTION TO ABANDON WELL | | | |

RECEIVED
NOV 17 1960
U. S. GEOLOGICAL SURVEY
FARMINGTON, NEW MEXICO

(INDICATE ABOVE BY CHECK MARK NATURE OF REPORT, NOTICE, OR OTHER DATA)

Kenazzy Federal

November 15, 19 **60**

Well No. **#1** is located **930** ft. from **NS** line and **990** ft. from **EW** line of sec. **17**

SW/4 SW/4 Sec. 17
(1/4 Sec. and Sec. No.)

S1N
(Twp.)

12N
(Range)

R10W
(Meridian)

Basin Dakota
(Field)

San Juan
(County or Subdivision)

New Mexico
(State or Territory)

The elevation of the derrick floor above sea level is **5943.3** ft. **G.L.**

RECEIVED
NOV 18 1960
U.S. GEOLOGICAL SURVEY

DETAILS OF WORK

(State names of and expected depths to objective sands; show sizes, weights, and lengths of proposed casings; indicate mudding jobs, cementing points, and all other important proposed work)

Propose to drill with rotary tools to an approximate depth of 7,000' or to test the Dakota formation. Casing program will be as follows:

- 10 3/4" 32.75# surface casing set at approximately 300' with 250 sz cement.
- 5 1/2" 17# casing set at total depth, with 400 sz cement.

Designation of operator to be filed by **El Paso Natural Gas Company**.

I understand that this plan of work must receive approval in writing by the Geological Survey before operations may be commenced.

Company **Southwest Production Company**

Address **162 Petr. Center Bldg.**

Farmington, New Mexico

By *M. J. Jewell*

Title **Production Accountant**

| | |
|---------------------------|-----|
| NUMBER OF COPIES RECEIVED | |
| DISTRIBUTION | |
| SANTA FE | |
| FILE | |
| U.S.G.S. | |
| LAND OFFICE | |
| TRANSPORTER | OIL |
| | GAS |
| PRODUCTION OFFICE | |
| OPERATOR | |

FORM C-128
Revised 5/1/57

NEW MEXICO OIL CONSERVATION COMMISSION
WELL LOCATION AND ACREAGE DEDICATION PLAT
SEE INSTRUCTIONS FOR COMPLETING THIS FORM ON THE REVERSE SIDE

SECTION A

| | | | | |
|--|--------------------------------------|--|--|---------------------------|
| Operator SOUTHWEST PRODUCTION COMPANY | | Lease NEWBERRY FEDERAL NM 021124 | | Well No. #1 |
| Unit Letter M | Section 17 | Township 31 NORTH | Range 12 WEST | County SAN JUAN |
| Actual Footage Location of Well: 930 feet from the SOUTH line and 990 feet from the WEST line | | | | |
| Ground Level Elev. 5943.3 | Producing Formation DAKOTA | Pool BASIN-DAKOTA | Dedicated Acreage: W/320 Acres | |

Ref. GEO Plat dated 18 November 1953

1. Is the Operator the only owner in the dedicated acreage outlined on the plat below? YES NO ("Owner" means the person who has the right to drill into and to produce from any pool and to appropriate the production either for himself or for himself and another. (65-3-29 (e) NMSA 1935 Comp.)
2. If the answer to question one is "no," have the interests of all the owners been consolidated by commutation agreement or otherwise? YES NO . If answer is "yes," Type of Consolidation _____
3. If the answer to question two is "no," list all the owners and their respective interests below:

| Owner | Land Description |
|-------|------------------|
| | |

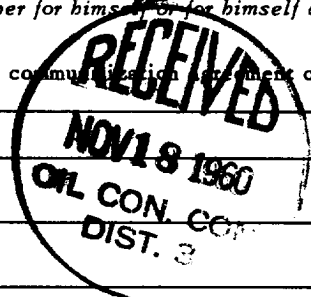

SECTION B

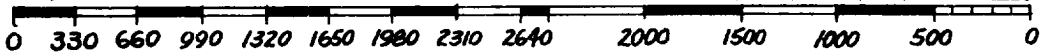
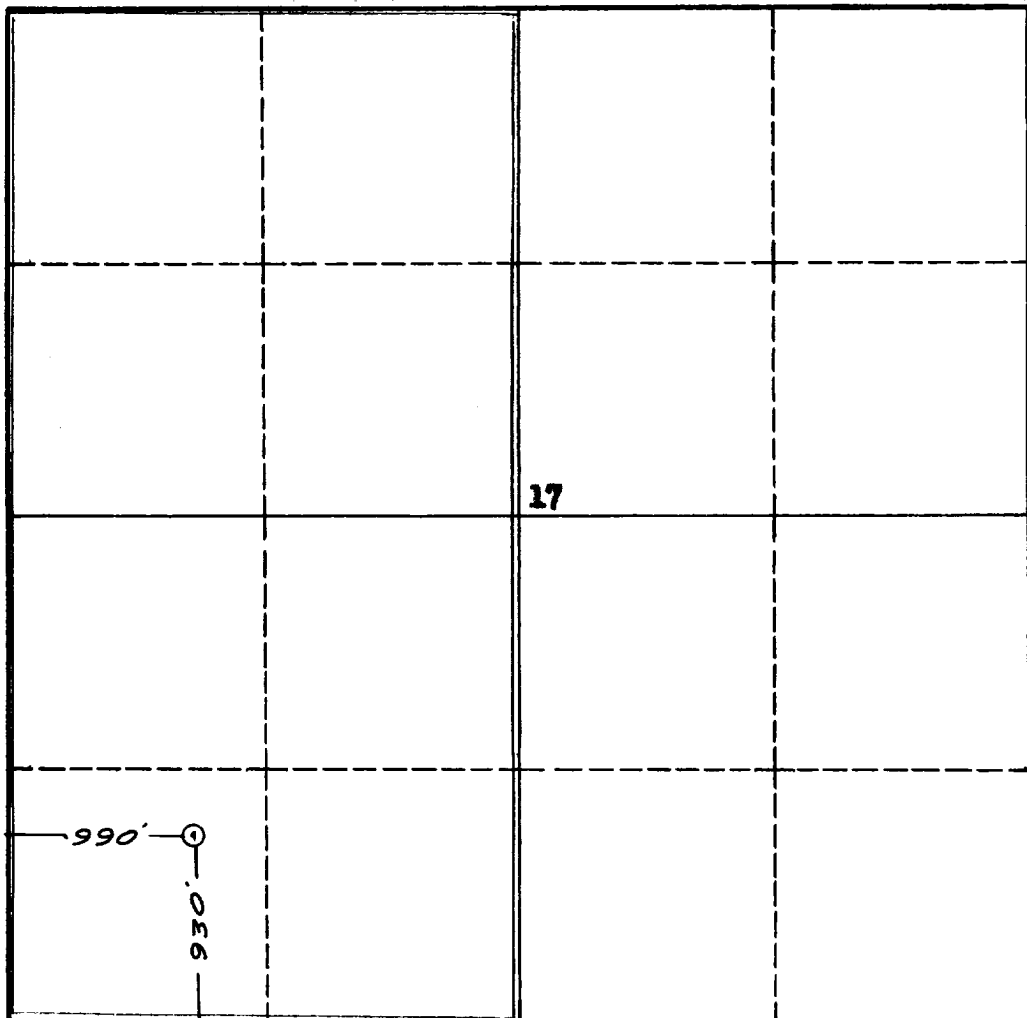

CERTIFICATION

I hereby certify that the information in SECTION A above is true and complete to the best of my knowledge and belief.

| | |
|----------|---------------------------------|
| Name | <i>James P. Leese</i> |
| Position | Production Accountant |
| Company | Southwest Production Co. |
| Date | 11/15/60 |

I hereby certify that the well location shown on the plat in SECTION B was plotted from field notes of actual surveys made by me or under my supervision, and that the same is true and correct to the best of my knowledge and belief.

| | |
|---|--|
| Date Surveyed | 10 November 1960 |
| Registered Professional Engineer and/or Land Surveyor | <i>James P. Leese</i> James P. Leese |
| Certificate No. | 1463 |

INSTRUCTIONS FOR COMPLETION OF FORM C-128

1. Operator shall furnish and certify to the information called for in Section A.
2. Operator shall outline the dedicated acreage for *both* oil and gas wells on the plat in Section B.
3. A registered professional engineer or land surveyor registered in the State of New Mexico or approved by the Commission shall show on the plat the location of the well and certify this information in the space provided.
4. All distances shown on the plat must be from the outer boundaries of the Section.
5. If additional space is needed for listing owners and their respective interests as required in question 3 of Section A, please use space below.