

NEW MEXICO OIL CONSERVATION COMMISSION

NOTICE OF INTENTION TO DRILL

See Rules 101 and 1104.

If changes in the proposed plan are considered advisable, a copy of this notice showing such changes will be returned to the sender. Submit this notice in triplicate. One copy will be returned following approval.



Aztec Oil & Gas Company

Dallas, Texas

February 25, 1952

Notice hereby is given that it is our intention to commence the drilling of a well to be known as.....

Aztec Oil & Gas Company

Company or Operator

Harper

Lease

well No. 1

in NE 1/4 SE 1/4

of Sec. 14, T. 31 N., R. 12 W., N. M., P. M. Blanco-LaPlata Pool, San Juan County.

The well is 1650 feet from (N) (S.) line and 840 feet from

(E.) (W.) line of the above section.

(Give location from section lines. Cross out wrong directions.)

If state land the oil and gas lease is No. Assignment No.

If patented land the owner is Maria I. and Aaron B. Harper

Address

If government land the permittee is

Address

The lessee is

Address

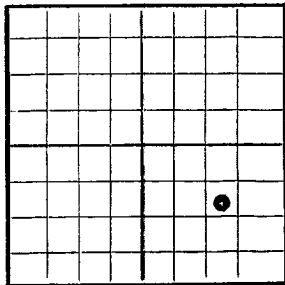

AREA 640 ACRES

LOCATE WELL CORRECTLY

We propose to drill well with drilling equipment as follows: With Rotary Tools. Top of Cliff House approximately 4450', and complete with natural gas to a total depth of approx. 5400'.

The status of a bond for this well in conformance with Rule 101 of the General Rules and Regulations of the Commission is as follows: Company maintains blanket bond

We propose to use the following strings of casing and to land or cement them as indicated:

Size of Hole	Size of Casing	Weight Per Foot	New or Second Hand	Depth	Landed or Cemented	Sacks Cement
	9-5/8"			200'	Cemented	75 sacks
	7" O.D.			4450'	"	200 "
	2" tubing			5400'		

If changes in the above plans become advisable we will notify you before cementing or landing casing. We estimate that the first productive oil or gas sand should occur at a depth of about 4450 feet.

Additional information: Well will be shot with approximately 1800 quarts of nitro from 4500' to total depth.

COMMUNITIZED UNIT: E 1/2 of Section 14. Fee Land: M. H. McGrail, SE 1/4 NE 1/4 Sec. 14, T-31-N., R-12-W.

Fee Land: Maria I. & Aaron B. Harper, E 1/4 SE 1/4 Sec. 14., T-31-N., R-12-W, N. M. P. M.

Federal Land: S.F.077648, Q. B. Davis, NE 1/4 NE 1/4 Sec. 14 " " "

Federal Land: S.F.077652, Vivian East, W 1/2 E 1/4 Sec. 14 " " "

Approved 19.....

except as follows:

FEB 28 1952

AZTEC OIL & GAS COMPANY

Company or Operator

By

Van Thompson

Position

Manager, Exploration Dept.

Send communications regarding well to:

Name Aztec Oil & Gas Company

Address 1104 Burt Bldg., Dallas 1, Texas

By

OIL CONSERVATION COMMISSION,

Title Oil and Gas Inspector Dist. #3



Company AMERICAN OIL FIELD COMPANY

Lease Harper Well No 1

Sec. 14 T. 31 N., R. 12 W., N.M.P.M.

Location 1650' from the South line and 840' from the East line.

San Juan County

New Mexico

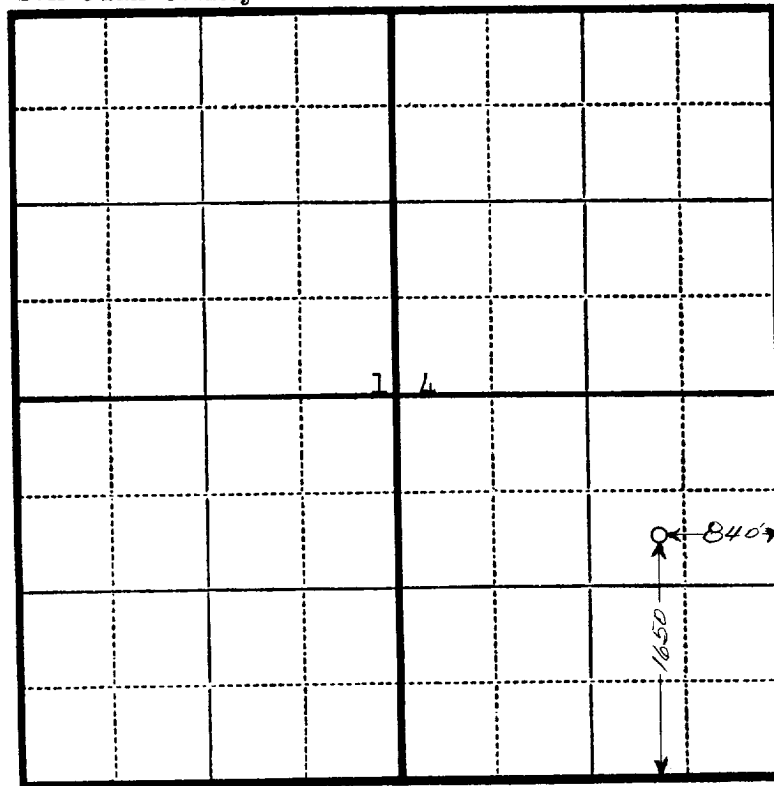

Scale—4 inches equals 1 mile.

This is to certify that the above plat was prepared from field notes of actual surveys made by me or under my supervision and that the same are true and correct to the best of my knowledge and belief.

Charles J. Finklea

Seal:

Registered Professional Charles J. Finklea
Engineer and Land Surveyor. N. Mex. Reg. No. 1302

Surveyed January 12, 1952.