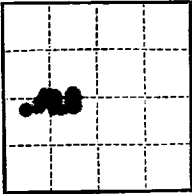

Sec. 13

(SUBMIT IN TRIPLICATE)

Indian Agency Navajo Tribal
Center. 21-00-003-0002
Allottee Trust 210
Lease No. Navajo #1UNITED STATES
DEPARTMENT OF THE INTERIOR
GEOLOGICAL SURVEY

SUNDRY NOTICES AND REPORTS ON WELLS

NOTICE OF INTENTION TO DRILL	SUBSEQUENT REPORT OF WATER SHUT-OFF
NOTICE OF INTENTION TO CHANGE PLANS	SUBSEQUENT REPORT OF SHOOTING OR ACIDIZING
NOTICE OF INTENTION TO TEST WATER SHUT-OFF	SUBSEQUENT REPORT OF ALTERING CASING
NOTICE OF INTENTION TO REDRILL OR REPAIR WELL	SUBSEQUENT REPORT OF REDRILLING OR REPAIR
NOTICE OF INTENTION TO SHOOT OR ACIDIZE	SUBSEQUENT REPORT OF ABANDONMENT
NOTICE OF INTENTION TO PULL OR ALTER CASING	SUPPLEMENTARY WELL HISTORY
NOTICE OF INTENTION TO ABANDON WELL	

RECEIVED
AUG 7 1959
U. S. GEOLOGICAL SURVEY
FARMINGTON, NEW MEXICO

(INDICATE ABOVE BY CHECK MARK NATURE OF REPORT, NOTICE, OR OTHER DATA)

August 4, 1959

Well No. 28 is located 2075 ft. from S line and 600 ft. from W line of sec. 13
SW 1/4 Sec. 13 33 17N 109W
 (1/4 Sec. and Sec. No.) (Twp.) (Range) (Meridian)
Navajo County San Juan New Mexico
 (Field) (County or Subdivision) (State or Territory)

The elevation of the derrick floor above sea level is 5036 ft.

DETAILS OF WORK

(State names of and expected depths to objective sands; show sizes, weights, and lengths of proposed casings; indicate mudding jobs, cementing points, and all other important proposed work)

Propose to drill the above well to a total depth of approximately 1800'. To test Gallup Formation at approximately 1700' and any other zones that appear productive of oil or gas.

Casing Pattern: 200' of 8 5/8" cas w/120 lbs.
 1800' of 5 1/2" cas w/100 lbs.

If necessary propose to cement oil zone.



I understand that this plan of work must receive approval in writing by the Geological Survey before operations may be commenced.

Company Magellan Petroleum CompanyAddress Box 2104, Hobbs, N. Mex.By [Signature]
Title District Superintendent



NEW MEXICO OIL CONSERVATION COMMISSION
Well Location and Acreage Dedication Plat

Section A.

Date Aug. 3, 1959

Operator MAGNOLIA PETROLEUM COMPANY Lease Navajo "A"
Well No. 18 Unit Letter L Section 13 Township 31N Range 17W NMPM
Located 1975 Feet From South Line, 670 Feet From West Line
County San Juan G. L. Elevation 5636 Dedicated Acreage 40 Acres
Name of Producing Formation Gallup Pool Horseshoe Gallup

1. Is the Operator the only owner* in the dedicated acreage outlined on the plat below?
Yes X No .
2. If the answer to question one is "no," have the interests of all the owners been consolidated by communitization agreement or otherwise? Yes No . If answer is "yes," Type of Consolidation
3. If the answer to question two is "no," list all the owners and their respective interests below:

Owner

Land Description

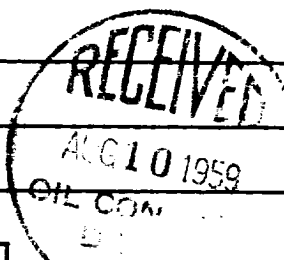

Section B

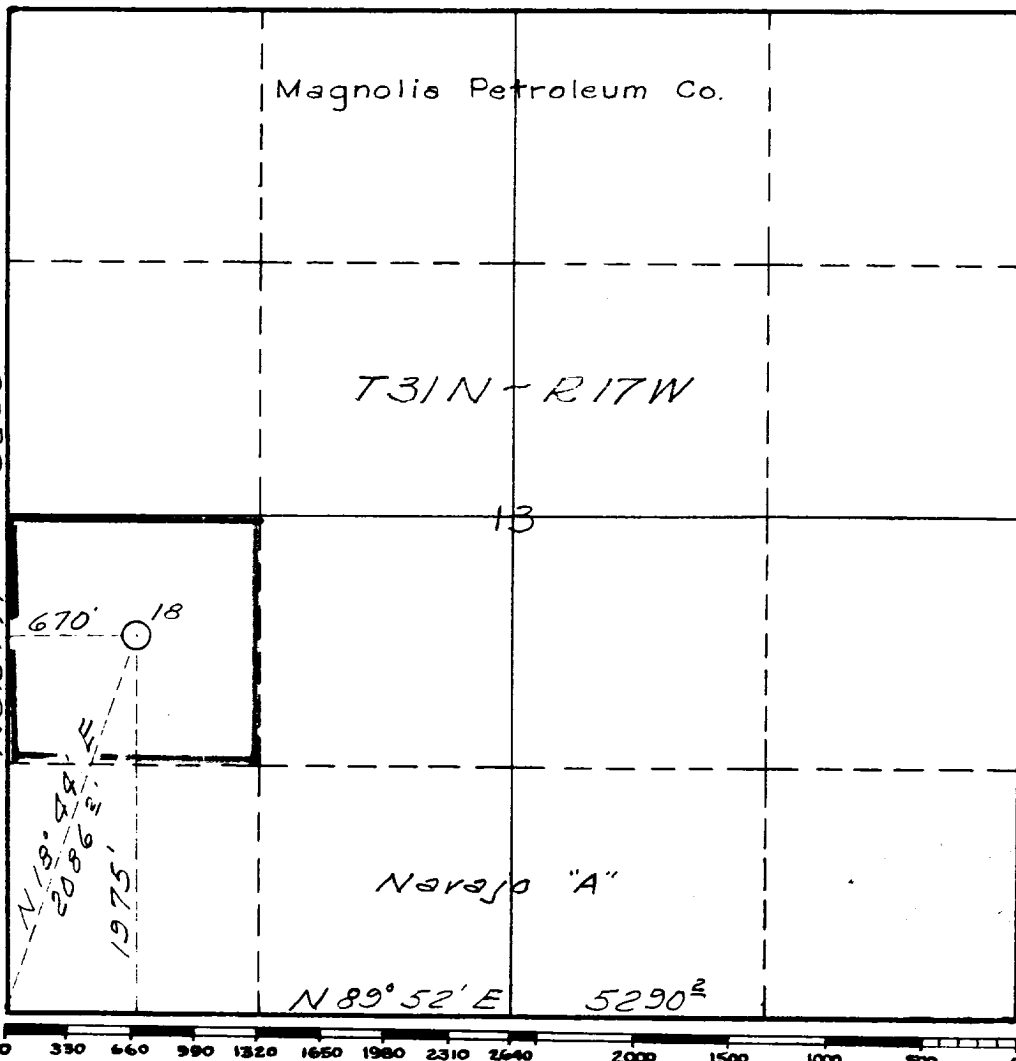

This is to certify that the information in Section A above is true and complete to the best of my knowledge and belief.

Magnolia Petroleum Company
(Operator)

E. Young, Jr.
(Representative)

Box 2406, Hobbs, New Mexico
Address

This is to certify that the well location shown on the plat in Section B was plotted from field notes of actual surveys made by me or under my supervision and that the same is true and correct to the best of my knowledge and belief.

Date Surveyed July 31, 1959

Carl E. Turner
Registered Professional
Engineer and/or Surveyor.

Certificate No. _____

INSTRUCTIONS FOR COMPLETION:

1. Operator shall furnish and certify to the information called for in Section A.
2. Operator shall outline the dedicated acreage for both oil and gas wells on the plat in Section B.
3. A registered professional engineer or land surveyor registered in the State of New Mexico or approved by the Commission shall show on the plat the location of the well and certify this information in the space provided.
4. All distances shown on the plat must be from the outer boundaries of Section.
5. If additional space is needed for listing owners and their respective interests as required in question 3, Section A, please use space below

* "Owner" means the person who has the right to drill into and to produce from any pool and to appropriate the production either for himself or for himself and another. (65-3-29 (e) NMSA 1953 Comp.)